

NOTES
 FOR DETAIL PLANS PLEASE REFER TO THE FOLLOWING DRAWINGS
 BLOCK F-G : 809_04_06_155
 BLOCK H : 809_04_06_175

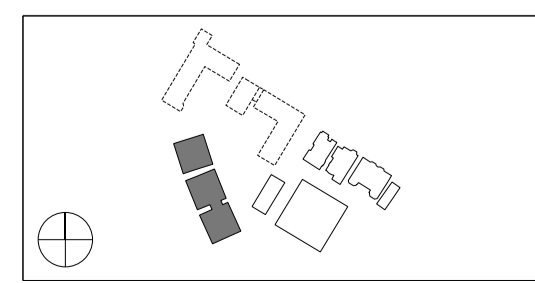

Do not scale from this drawing. Use figured dimensions only. Figured dimensions are in millimetres. All levels are in metres. All dimensions and levels shall be verified on site before proceeding with works. Detailed site survey to be carried out to verify positions and level relationships with site features and ordnance survey. Boundaries are indicative only and are to be verified by others. The architect must be notified of any discrepancy. Where building components are described in the specification as contractor designed, "construction" information relating to those components on this drawing represents design intent only.

REV	DATE	DESCRIPTION	CD
P1	11.02.2014	ISSUED FOR COORDINATION	NR
P2	14.03.2014	ISSUED FOR COORDINATION	NR
P3	15.04.2014	ISSUED FOR COORDINATION	NR
P4	01.07.2014	ISSUED FOR COORDINATION	NR

KEY
 = Extent of extensive living roof

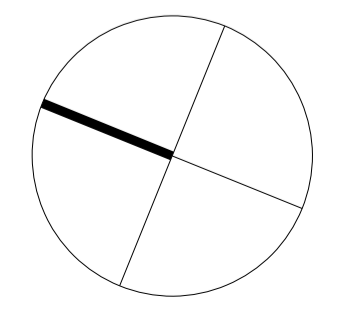

Allies and Morrison
 85 Southwark Street
 London SE1 0HX
 telephone 020 7921 0100
 facsimile 020 7921 0101
 email info@alliesandmorrison.co.uk
 A&M JOB NO: 809

KIDDERPORE AVENUE
BLOCK F-H : ROOF LEVEL
GENERAL ARRANGEMENT
809_04_06_105
 SCALE 1:100@A1 1:200@A3

P4
 Revision