

06	
05	
04	
03	
02	
01	
00	
-1	

Notes

1. BASED ON DSDHA DRAWING NO: 205\_20\_106T5\_SF

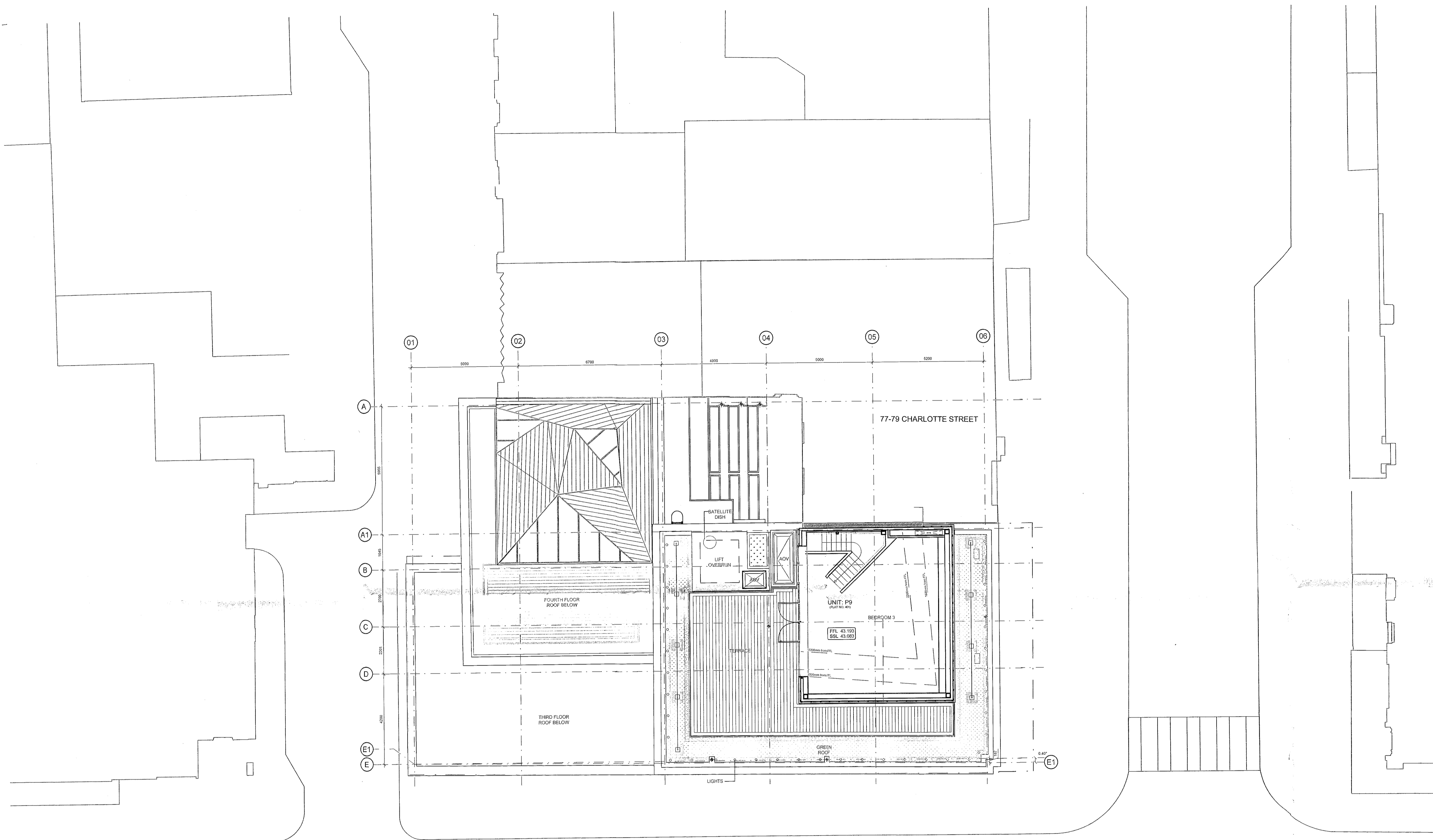

C	18/08/2014	NOTES ADDED	SF
B	14/08/2014	TERRACE DECKING UPDATED	SF
A	07/08/2014	ROOFLIGHT MOVED TO 4TH FLOOR PAVILION ROOF. NOTE CHANGED TO LIVING/BEDROOM 3	SF

Revisors By / Authorised

**Important note**  
All dimensions in millimetres. Where dimensions are not given, drawings must not be scaled and the matter referred back to Veretec Limited.  
All dimensions and conditions are to be checked on site by the contractor prior to preparing drawings or commencing any work. The contractor is responsible for checking that there is no conflict between site dimensions and drawn dimensions.  
In the event of any detail or dimensional conflict between Veretec Limited drawings, the matter must be referred back to Veretec Limited for clarification.

Veretec Limited.  
36-40 York Way  
London N1 9AB  
Tel: +44 (0)20 7843 3199  
Fax: +44 (0)20 7843 3001  
Email: london@veretec.co.uk  
Web: www.veretec.co.uk

Client  
**KNIGHT HARWOOD**

Project  
**73 CHARLOTTE STREET**

Title  
**PROPOSED FIFTH FLOOR**

Date	Drawn	Checked	Authorised
MAY 2014	OG	SF	KM

Scale  
1:100@A1 1:200 @A3

Issue status

**PLANNING**

Drawing number	Rev
<b>21164-09-AR-07-105</b>	<b>C</b>
Client Drawing number	

01 Proposed Fifth Floor Plan  
Scale 1:50

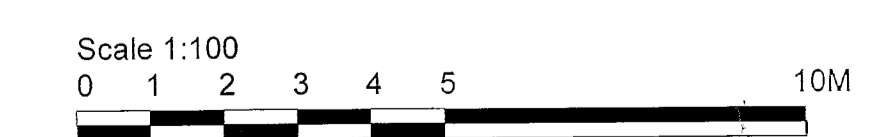

XREF: P01164-09-AR-07-105-PLAN  
P01164-09-AR-07-105-PLAN  
P01164-09-AR-07-105-PLAN  
P01164-09-AR-07-105-PLAN  
P01164-09-AR-07-105-PLAN  
P01164-09-AR-07-105-PLAN  
P01164-09-AR-07-105-PLAN  
P01164-09-AR-07-105-PLAN  
P01164-09-AR-07-105-PLAN  
P01164-09-AR-07-105-PLAN