

Elevation

**ODONI-ELWELL CYCLE RACK TYPE 9 WITH HOOP**

- SPECIFICATION**
- Close spacing of 305mm ensures maximum use of available space
  - Suitable to store all types of cycle - from racing cycles to mountain bikes and cycles with extra wide tyres
  - Available to store any number of cycles
  - 50% of storage spaces are available for cycles with extra wide tyres
  - Fully locates both wheels in a custom designed tapered steel trough to BS1716/51
  - Manufactured from RHS sectional solid steel tube and rolled steel angle
  - Fully welded and prefabricated
  - All steelwork is fully hot dipped galvanised to ISO1461
- OPTIONS**
- Polyester powder coating to BS6497 (over galvanized coating)
- ASSEMBLY**
- Supplied as a kit for easy assembly

1 CYCLE STORE IN BLOCK H LEVEL-03  
Capacity: 18 cycle spaces

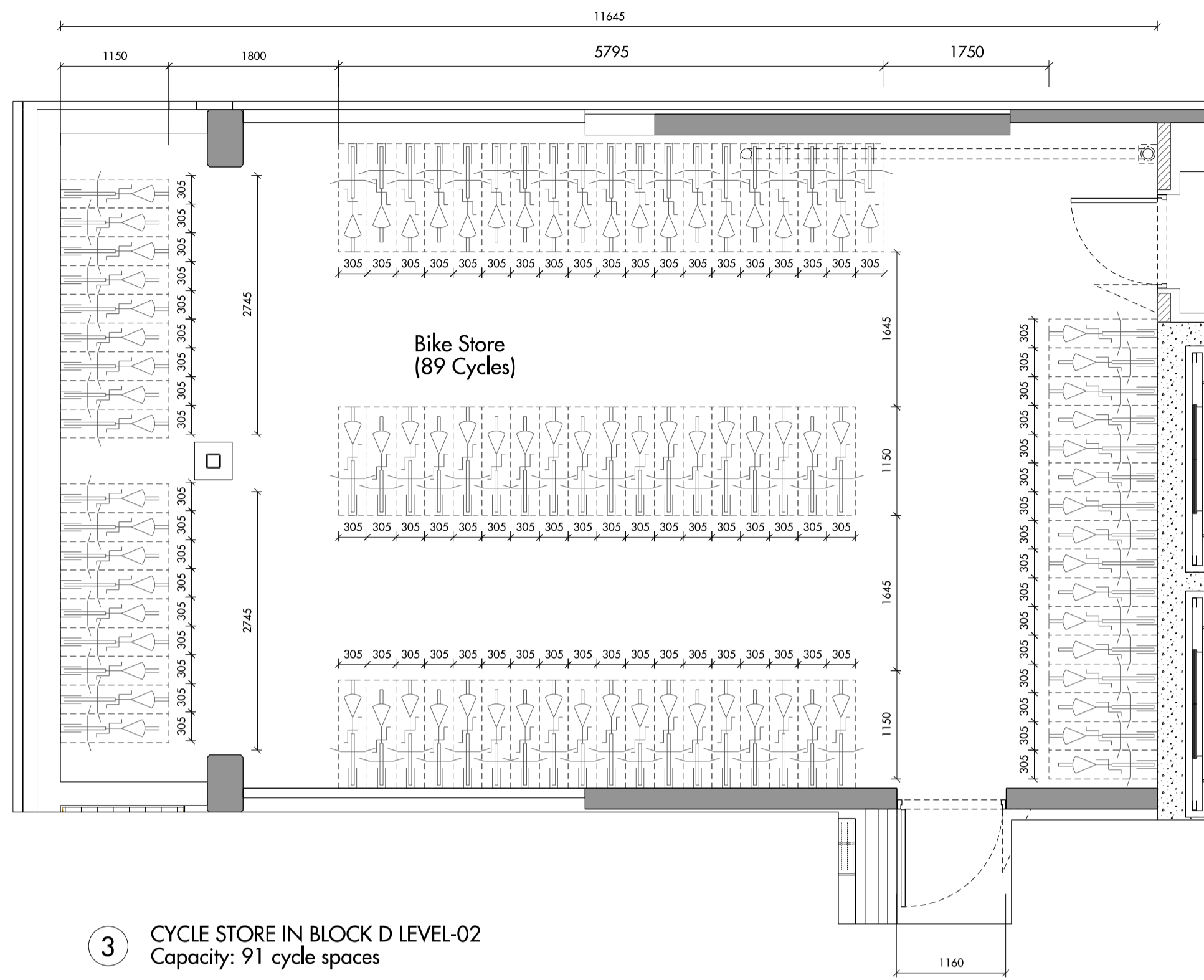

3 CYCLE STORE IN BLOCK D LEVEL-02  
Capacity: 91 cycle spaces

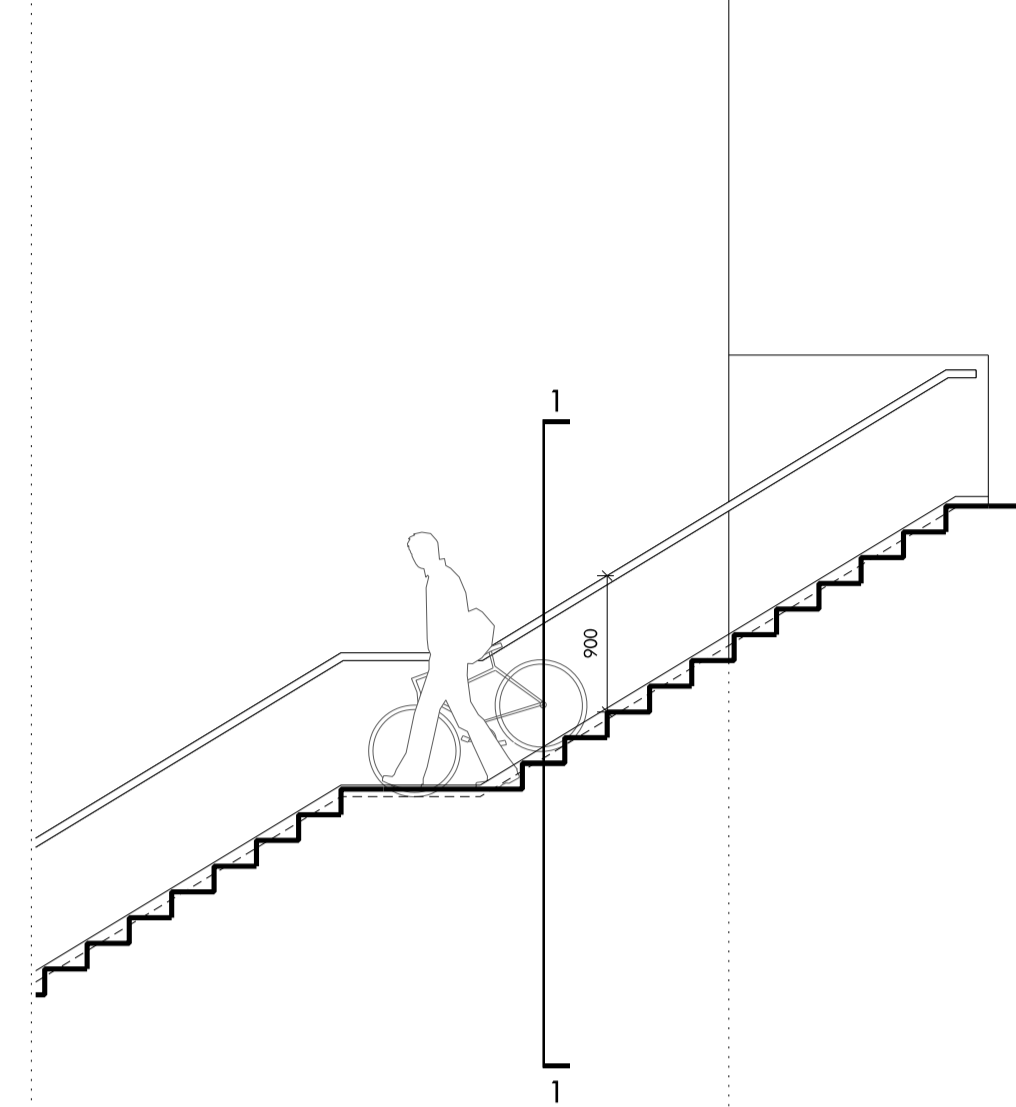

5 CYCLE CHANNEL

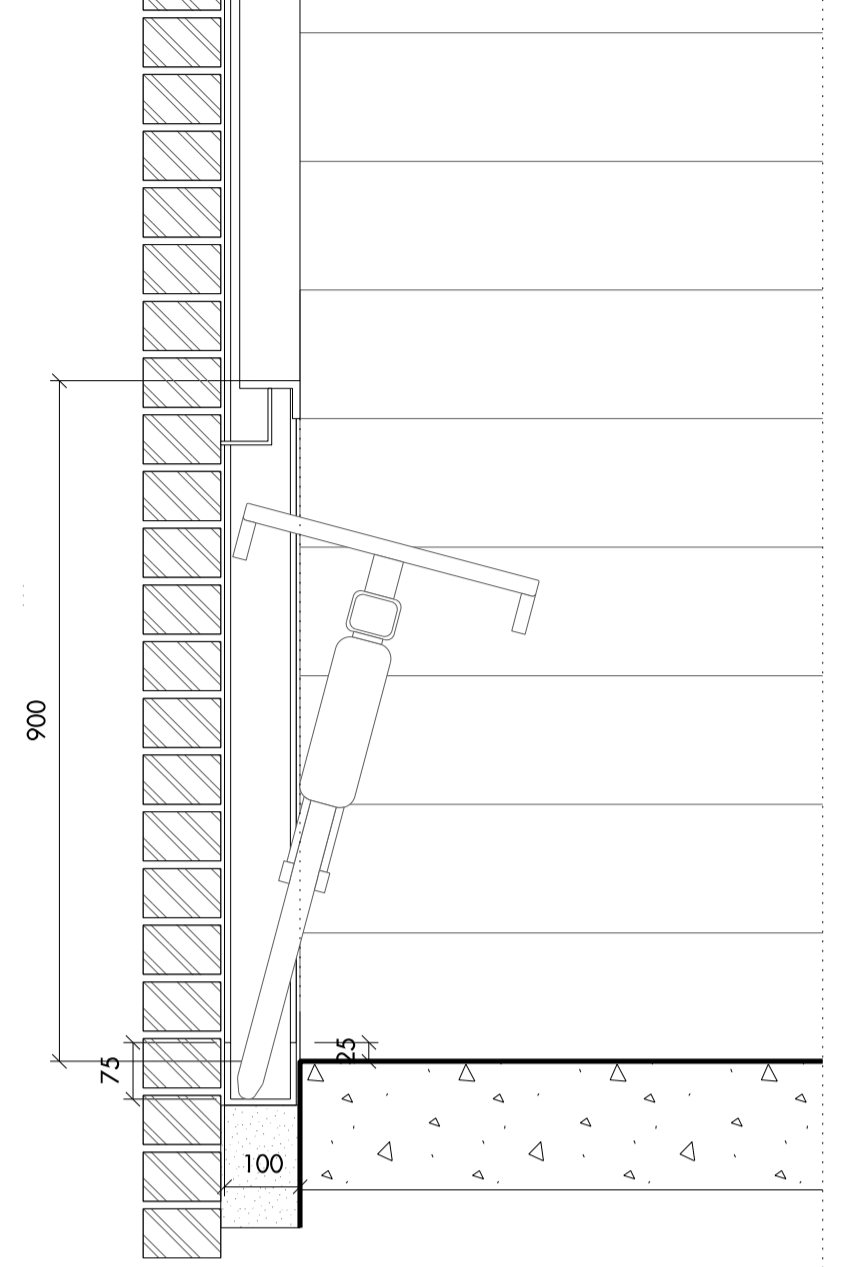

SECTION 1-1  
1:10 @ A1 1:20 @ A3

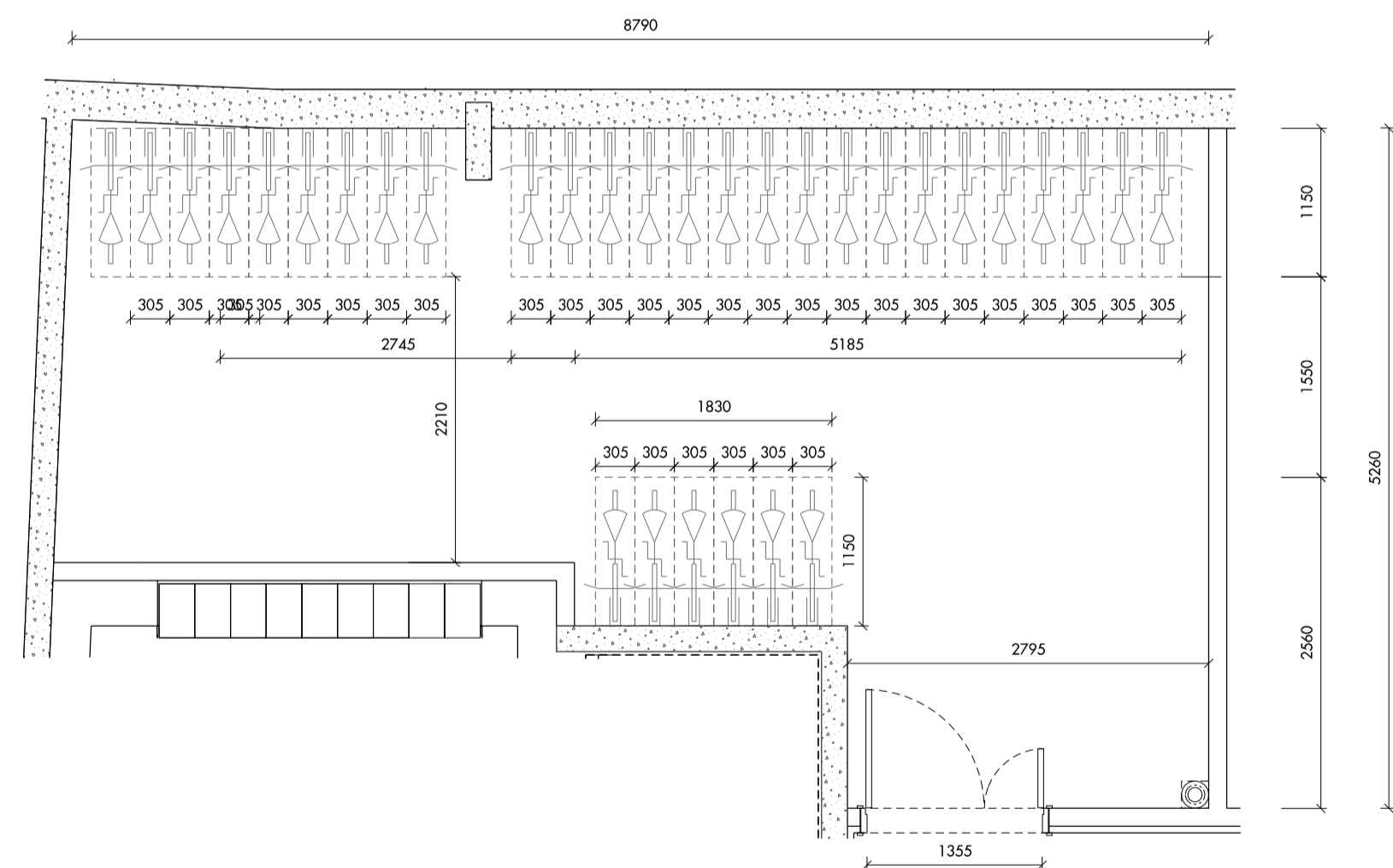

2 CYCLE STORE IN BLOCK F LEVEL-03  
Capacity: 32 cycle spaces

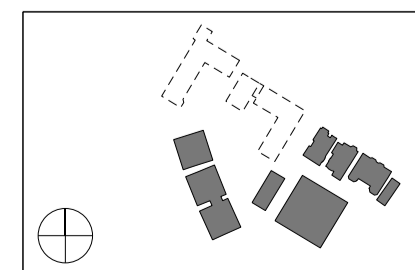

Do not scale from this drawing. Use figured dimensions only. Figured dimensions are in millimetres. All levels are in metres. All dimensions and levels shall be verified on site before proceeding with works. Detailed site survey to be carried out to verify positions and level relationships with site features and ordnance survey. Boundaries are indicative only and are to be verified by others. The architect must be notified of any discrepancy. Where building components are described in the specification as contractor designed, "construction" information relating to those components on this drawing represents design intent only.

REV	DATE	DESCRIPTION	CKD
P1	18.08.2014	Issued for Planning	NR

Allies and Morrison  
85 Southwark Street  
London SE1 0HX  
020 7921 0100  
020 7921 0101  
info@alliesandmorrison.co.uk  
A&M JOB NO: 809

KIDDERPORE AVENUE  
CYCLE STRATEGY  
CYCLE STORE AND CYCLE CHANNELS  
809\_00\_02\_041  
SCALE 1:50 @A1 1:100@A3