

HAMPSTEAD ROAD

COUNCIL SCHOOL
(Under construction, April '15)

SEE SHEET C6

C40

C41

C42

C44

C46

HAMPSTEAD ROAD

COUNCIL SCHOOL
(Under construction April '15)

C41

C42

C43

C40

C44

C46

SEE SHEET C6

ENGINEERS (E.M.)

HOPTON & SONS

STURTEVANT & CO LTD
NICKLE PLATING WORKS

TIMBER STORE EAST
CABINET FAC OVER

MAPLE & CO LTD
DYEING BAST

MAPLE & CO LTD
CABINET FAC OVER



Site 122 Drummond Street, London, NW1 2HN

Client Julia Pyper

Engineer Michael Alexander

Job Number
J14127

Sheet
1 / 1

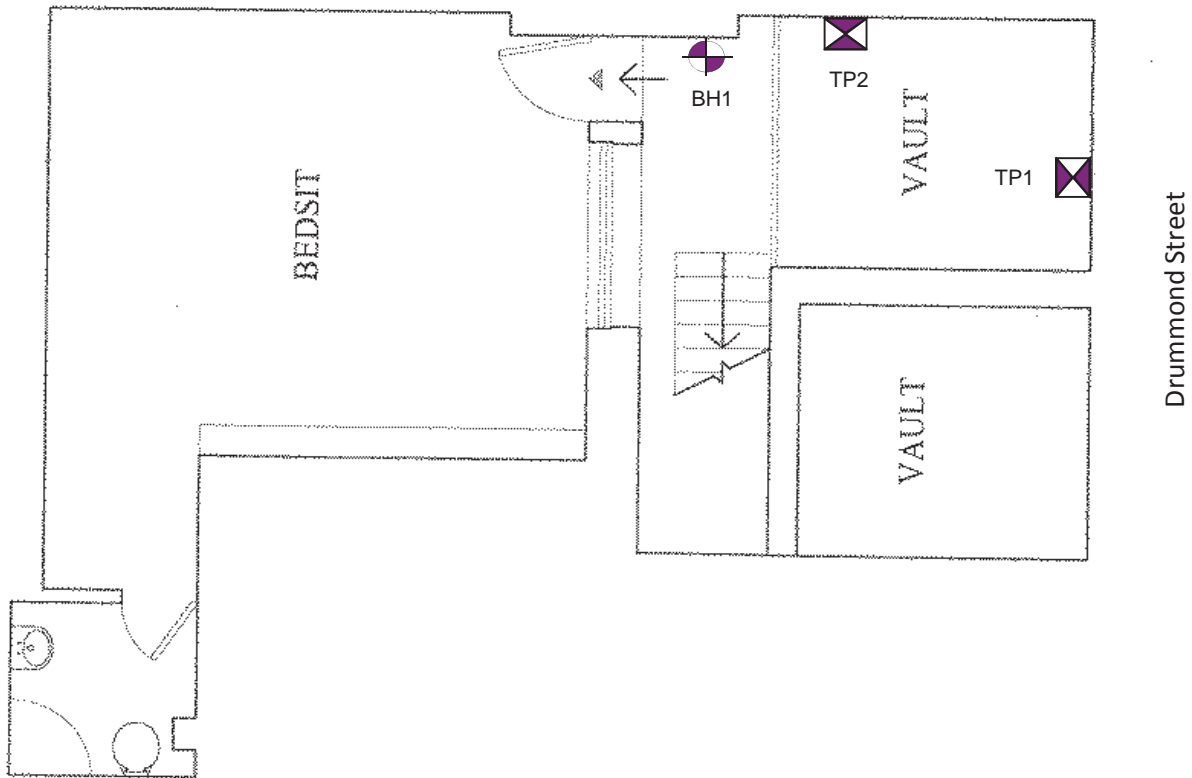

Note: Not to scale

Geotechnical & Environmental Associates (GEA) is an engineer-led and client-focused independent specialist providing a complete range of geotechnical and contaminated land investigation, analytical and consultancy services to the property and construction industries.

We have offices at

Tythenhanger House
Coursers Road
St Albans
AL4 0PG
tel 01727 824666
mail@gea-ltd.co.uk



and

Church Farm
Gotham Road
Kingston on Soar
Notts
NG11 0DE
tel 01509 674888
midlands@gea-ltd.co.uk



Enquiries can also be made on-line at www.gea-ltd.co.uk where information can be found on all of the services that we offer.