

KEY

- Existing tree retained
1.8m high
see Spec. Ref Q40.310
- Existing tree removed
1.8m high
see Spec. Ref. Q40.570
- Extra heavy standard tree
see Detail 862.10
- Ornamental shrub/herbaceous planting
see Planning Plans 862.03 & 04
& Spec. Ref. Q31
- Turf
see Spec. Ref. Q30
- Area of no-dig construction
- Metal edging
see Spec. Ref. Q22.210A
- Conservation kerb by Marshalls
145 x 255 x 914mm
see Spec. Ref. Q10.110
- Single row of clay pavers (200mm wide)
see Spec. Ref. Q25.325A
- Clay pavers laid in a herringbone pattern
see Spec. Ref. Q25.325A
- Resin bound gravel paving by SureSet
see Spec. Ref. Q22.175A
- Compass Point in resin bound gravel paving
by SureSet
see Spec. Ref. Q22.175A
- Conservation Slabs by Marshalls
900 x 600 x 50mm Colour: Silver Grey
see Spec. Ref. Q25.315A
- Asphalt concrete
(formerly known as bitmac)
to engineers specification

Risk Assessment:
This drawing has been reviewed for risks with the following assessment -

- No foreseeable residual risks have been identified with the information provided by this drawing.
- Foreseeable residual risks have been identified in the information contained within this drawing and as such please refer to the CA Risk File held on site by the Principle Contractor
- This information is issued for Preliminary information and Risk Assessments are currently being carried out

Assessment Date: 21.05.2012
Drawing Revision A
Reviewed by G. Bell

NOTES
1) Drawing based on GMA Architects Drawing Wellesley plan W100 & Broad Oak, Tree Consultants Ltd Tree report & Tree constraint plan, JS9.24/01

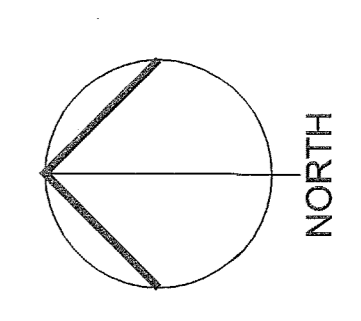

see BFLA dwg. no. 862.02

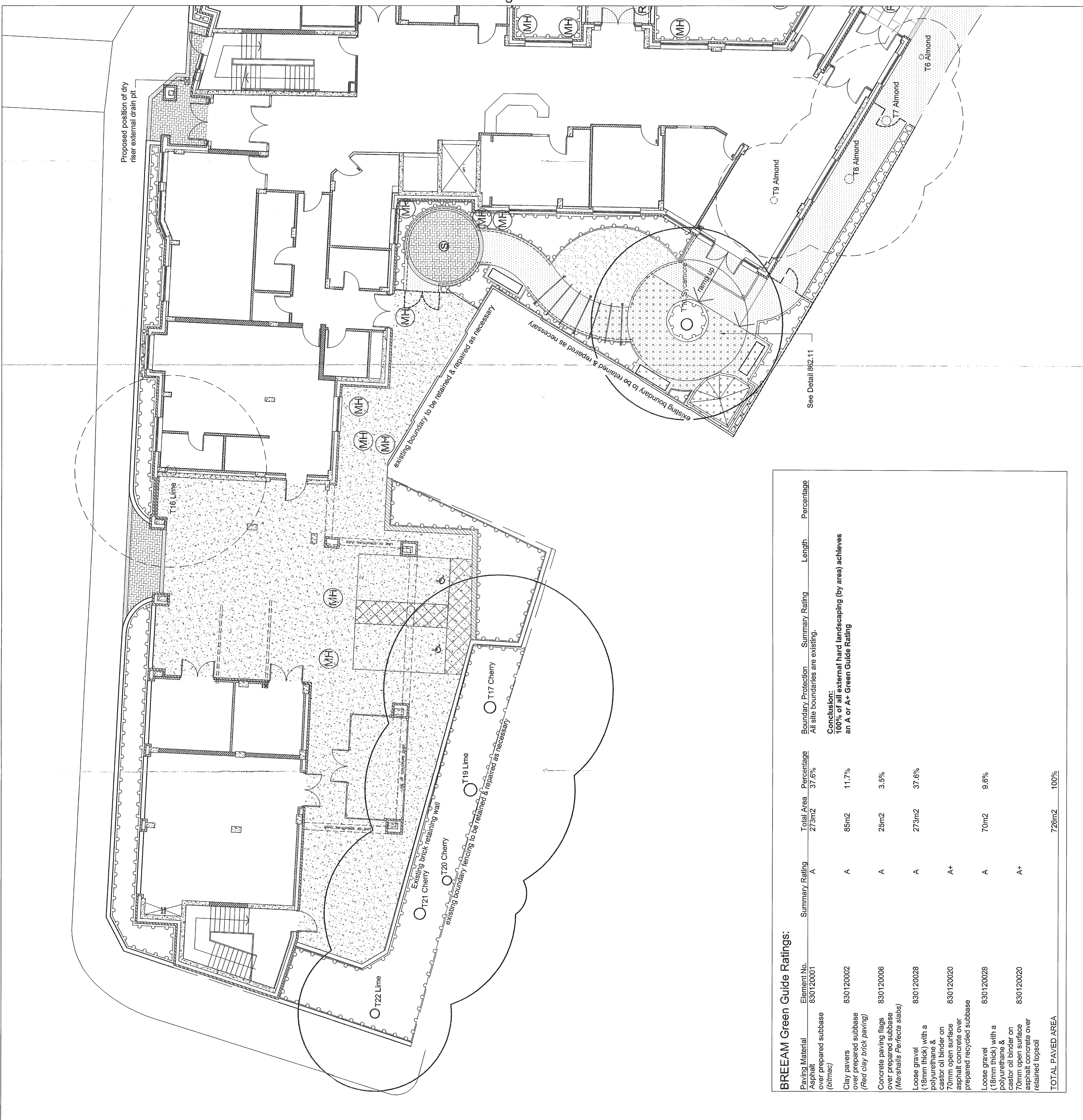

BREEAM Green Guide Ratings:

Paving Material	Element No.	Summary Rating	Total Area	Percentage	Boundary Protection	Summary Rating	Length	Percentage
Asphalt (bitmac)	830120001	A	273m ²	37.6%	All site boundaries are existing.	A		
Clay pavers over prepared subbase (Red clay brick paving)	830120002	A	85m ²	11.7%		A		
Concrete paving flags over prepared subbase (Marshalls Perfecta slabs)	830120006	A	25m ²	3.5%		A		
Loose gravel (18mm thick) with a polyurethane & castor oil binder on 70mm open surface asphalt concrete over prepared recycled subbase	830120028	A	273m ²	37.6%		A		
Loose gravel (18mm thick) with a polyurethane & castor oil binder on 70mm open surface asphalt concrete over retained topsoil	830120020	A+	70m ²	9.6%		A+		
TOTAL PAVED AREA			726m²	100%				

Conclusion:
100% of all external hard landscaping (by area) achieves an A or A+ Green Guide Rating

- Close boarded timber fence
1.8m high
see Spec. Ref Q40.310
- Close boarded timber gate
1.8m high
see Spec. Ref. Q40.570
- Boundary wall 1.8 m high
to architect's detail
- Raised brick planter
see Detail 862.12
- Raised water feature
see Details 862.13
- Statue
see Spec. Ref. Q50.345
- Straight timber seat with arms
see Spec. Ref. Q50.225
- Curved timber seat with arms
see Spec. Ref. 225A
- Timber pergola
see Detail 862.14
- Timber arbor
see Detail 862.15
- Proposed summerhouse
see Spec. Ref. Q50.250A
- Handrail
see Detail 862.16
- Timber Sleeper Wall
see Detail 862.17
- Recessed manhole covers
to engineers details
- Manhole covers
to engineers details

PRELIMINARY

ELG 00
ELG 01
ELG 02
ELG 03
ELG 04
ELG 05
ELG 06
ELG 07
ELG 08
ELG 09
ELG 10
ELG 11
ELG 12
ELG 13
ELG 14
ELG 15
ELG 16
ELG 17
ELG 18
ELG 19
ELG 20
ELG 21
ELG 22
ELG 23
ELG 24
ELG 25
ELG 26
ELG 27
ELG 28
ELG 29
ELG 30
ELG 31
ELG 32
ELG 33
ELG 34
ELG 35
ELG 36
ELG 37
ELG 38
ELG 39
ELG 40
ELG 41
ELG 42
ELG 43
ELG 44
ELG 45
ELG 46
ELG 47
ELG 48
ELG 49
ELG 50
ELG 51
ELG 52
ELG 53
ELG 54
ELG 55
ELG 56
ELG 57
ELG 58
ELG 59
ELG 60
ELG 61
ELG 62
ELG 63
ELG 64
ELG 65
ELG 66
ELG 67
ELG 68
ELG 69
ELG 70
ELG 71
ELG 72
ELG 73
ELG 74
ELG 75
ELG 76
ELG 77
ELG 78
ELG 79
ELG 80
ELG 81
ELG 82
ELG 83
ELG 84
ELG 85
ELG 86
ELG 87
ELG 88
ELG 89
ELG 90
ELG 91
ELG 92
ELG 93
ELG 94
ELG 95
ELG 96
ELG 97
ELG 98
ELG 99
ELG 100



PROJECT
Camden HOP
Wellesley Road

DRAWING
Layout Plan
Sheet 1 of 2

DRAWN
ELG
CHECKED
KID
DATE
April 2012
SCALE
1:100@A1
REV
862.01 E

BELL FISCHER BFLA
180 Chiltern Drive, Surbiton Surrey KT5 6LS
020 8390 6477 | 020 8390 7900
www.bellfisher.co.uk
LANDSCAPE ARCHITECTS

6