

**DORMER SECTION**

**FLAT ROOFS ~ DORMERS**  
 Code 5 lead with all necessary rolls formed over mopstick and drips in accordance with lead workers code on sheathing felt to BS 747 on 19mm marine plywood decking on firings to fall @ 1:40 minimum from front face back towards pitched roof & then to sides on timber joists. Refer to section for sizes & c/c. Spans as indicated. Turn lead & decking up minimum 300mm behind pitched roof covering. Insulate over joists with 120mm Celotex.

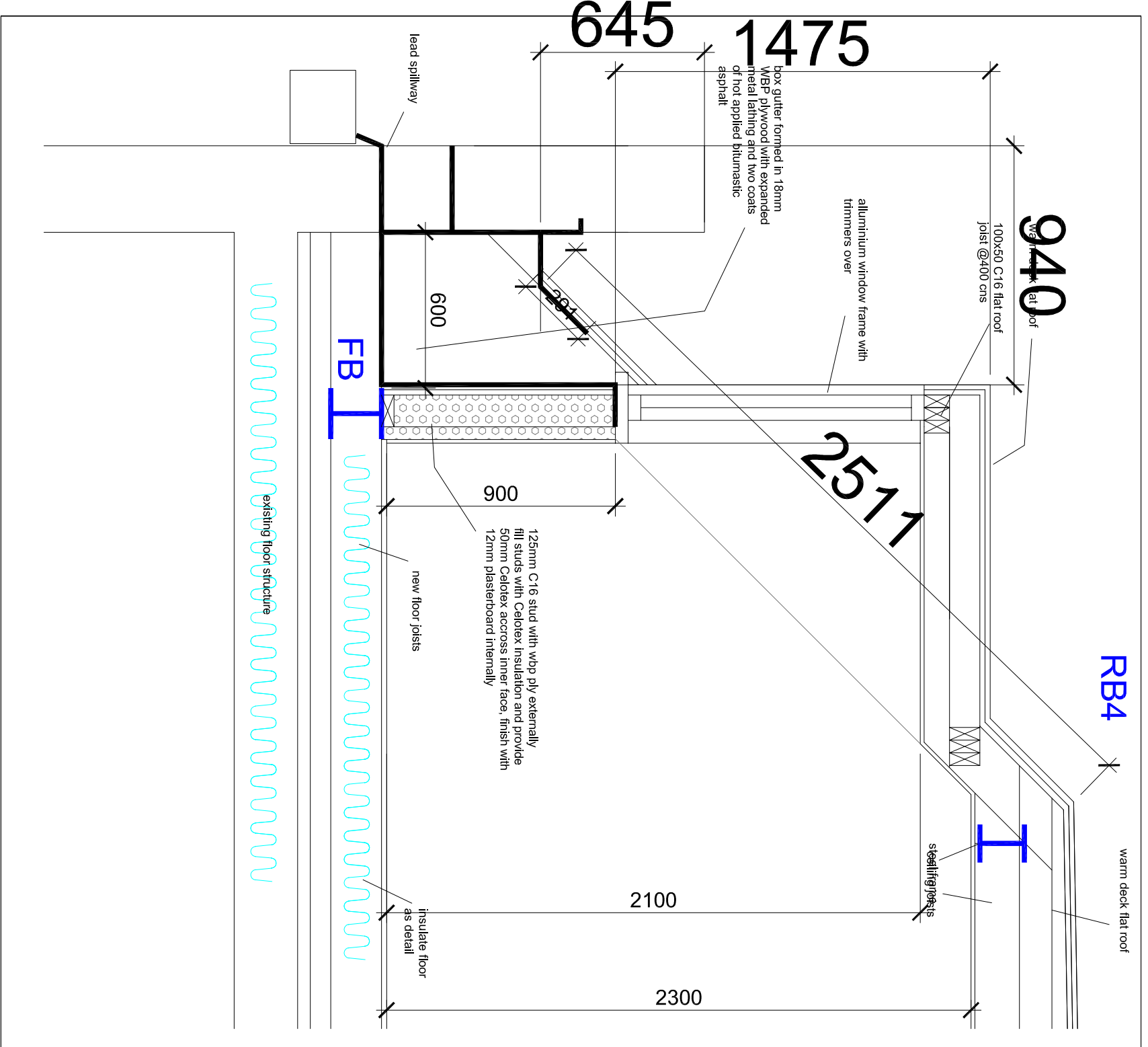

**DORMER SECTION AS DESIGNED**

TITLE AS DESIGNED DORMER DETAILS REAR ADDRESS LINBURN HOUSE, 340-354 KILBURN HIGH ROAD, LONDON, NW6 2QJ  
 CLIENT RAINBOW PROPERTIES LTD. SCALE 1:20 @ A3 DATE JULY 2011  
 DRAWING NO. 03 REV. B