

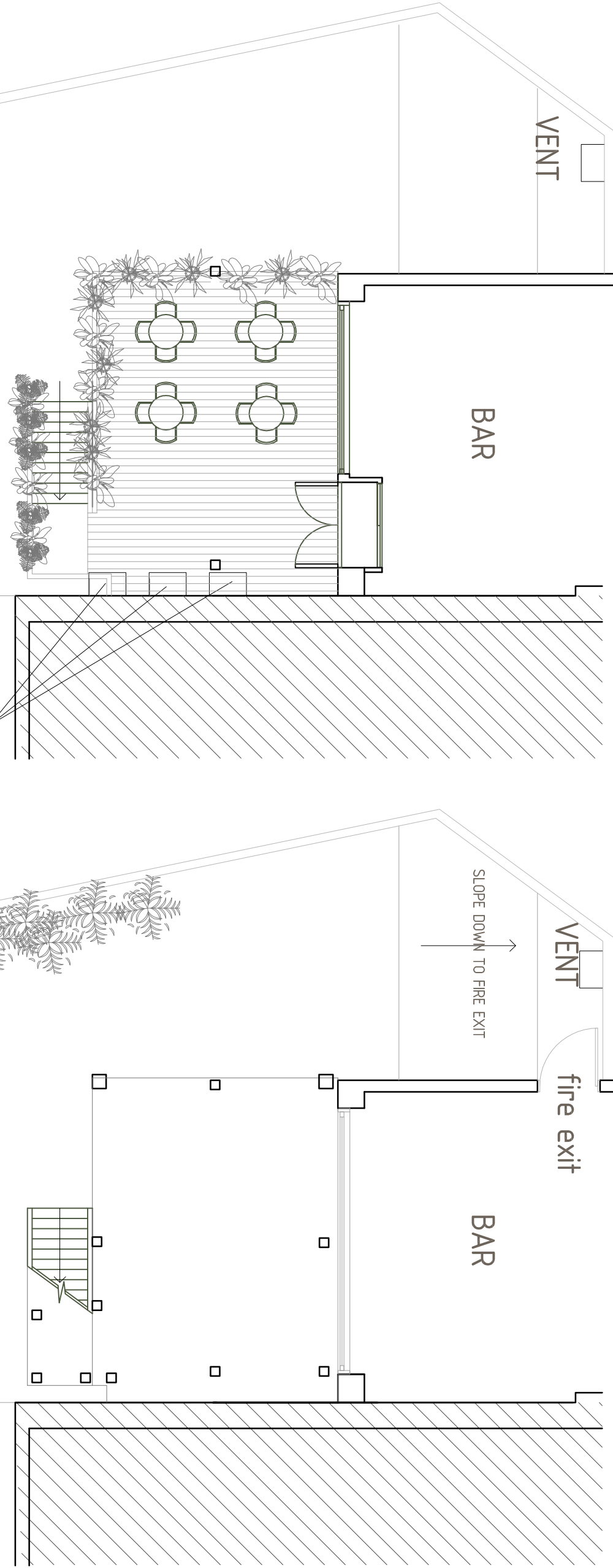

© This Drawing remains the property of Albion Ltd, trading name as ENK Design, and shall not be reproduced in part or whole without the written consent of ENK Design.
Do not Scale this drawing.
All Dimensions to be verified on site by Main Contractor before Report all discrepancies to Architect Immediately.
This drawing is to be read with all related Architects and Engineers drawings and other relevant information.



VENTS

CAR PARK

fire exit

UPDATED EXISTING GROUND FLOOR PLAN



SLOPE DOWN TO FIRE EXIT

VENT

fire exit

BAR

fire exit

UPDATED EXISTING BASEMENT PLAN

NOTE: Air conditioning/extractor units do not form part of the application.

Rev	Description	Date	By

enkdesign
187b Cavendish Rd, London, N4, 1RR
Tel: +44(0) 2083407014
info@enkdesign.co.uk
www.enkdesign.co.uk

AS EXISTING

Purpose	PLANNING
Project Address	183 Tottenham Court Road
Project Title	RETROSPECTIVE
Drawing Title	EXISTING BASEMENT & GR. FLOORS

Client	Date Drawn	
Mehmet Coskun	25.04.14	
Project No	Drawn By	
12149	GA	
Drawing No	Rev	Scale
12149-A100-BF	2	1:100@A3