

- 1 Existing masonry leadwork with roof cast render replaced to match existing frame
  - 2 Replace front 12 panes glass entrance - 600mm high (12 panes) to match existing main house roof
  - 3 Replace roof to new extension - side gable roof with existing main house roof
  - 4 New Entrance porch - 'Shug' oak, concrete frame & floor in grey, side gable roof, 12 panes glass door, 12 panes glass side window & panelled glass screen.
  - 5 Double glazed 12 panes front door, side gable roof, 12 panes glass side window & panelled glass screen.
  - 6 Double glazed 12 panes front door, side gable roof, 12 panes glass side window & panelled glass screen.
  - 7 Double glazed 12 panes front door, side gable roof, 12 panes glass side window & panelled glass screen.
  - 8 Double glazed 12 panes front door, side gable roof, 12 panes glass side window & panelled glass screen.
  - 9 Timber framed leadwork
  - 10 High light beam (existing) replaced with double glazed front door, side gable roof, 12 panes glass side window & panelled glass screen.
  - 11 Low profile roof addition by 'shug' or 'shug'
  - 12 weathered metal roof structure
- NEW WALLS
- DEMOLITIONS

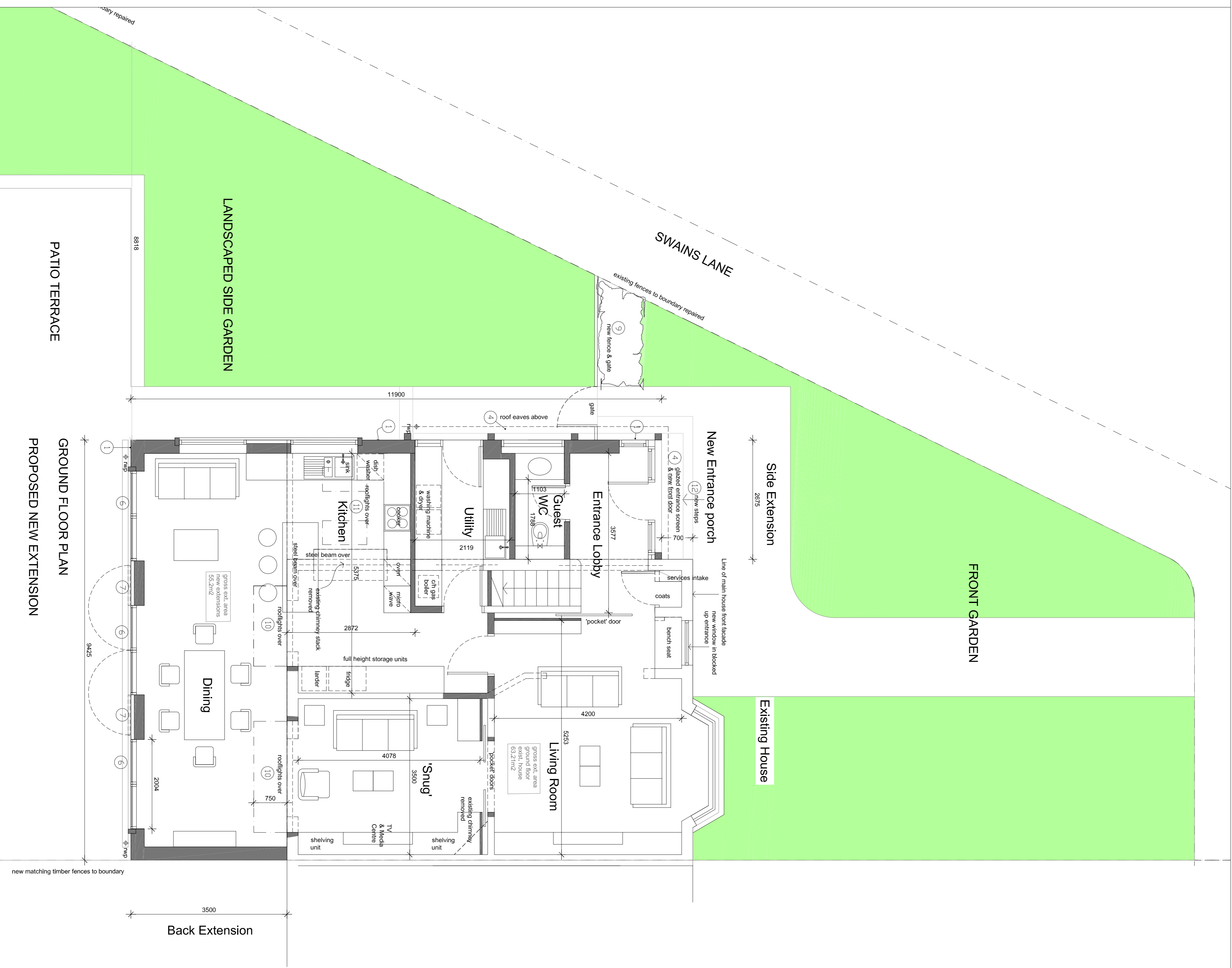
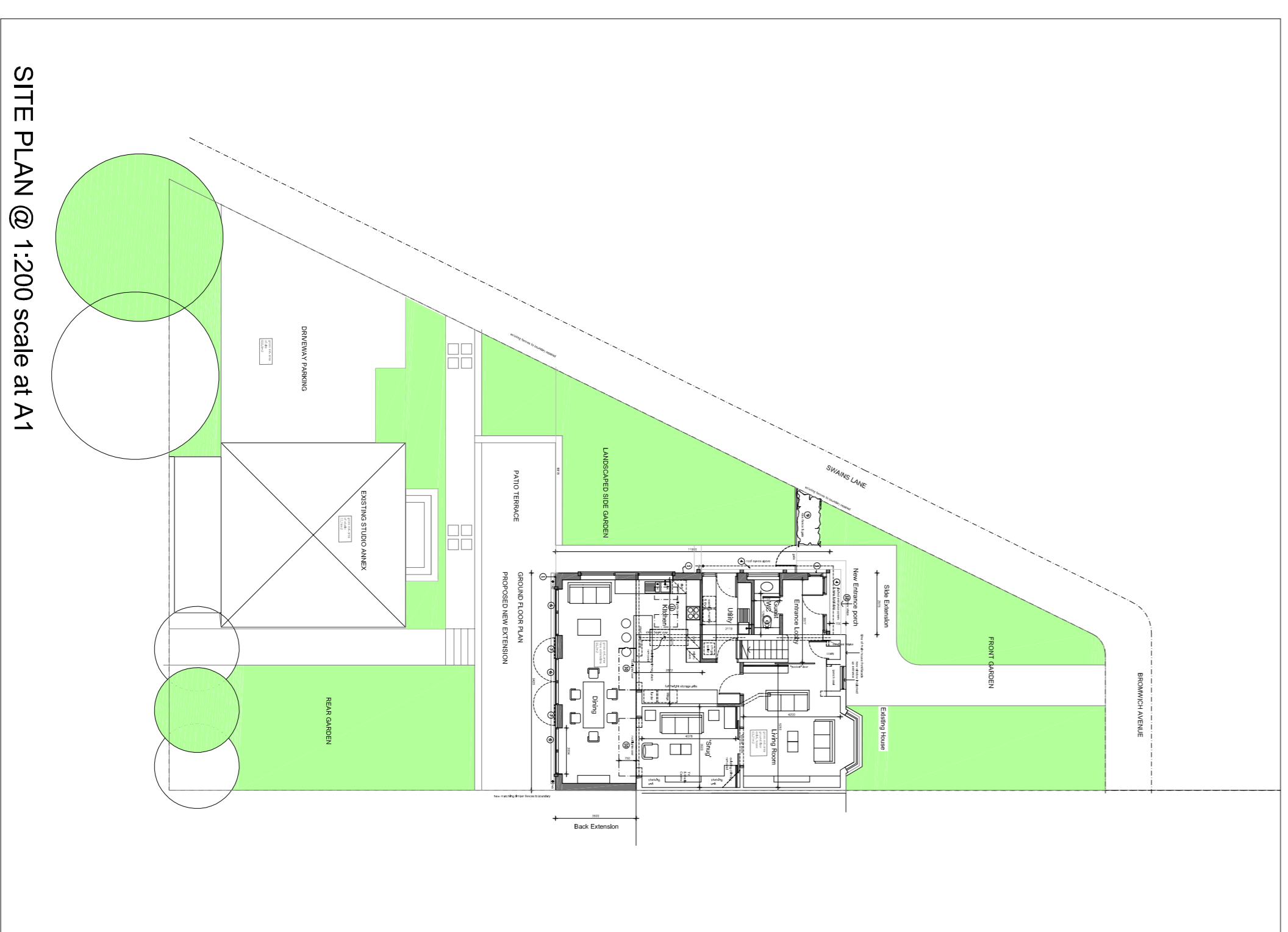

D09 12.06.14 Side extension porch set back from main house front facade as Camden Planning guide

D08 07.04.14 Pre-Application Proposals submission

D07 14.02.14 Revised rear extension plans doors & windows

D05 20.01.14 Pre-Application Proposals

D04 20.12.13 Plan revised as meeting of 13.12.13

D03 02.12.13 Plan revised as meeting of 30.11.13

D02 20.09.13 Plan revised to 3.5m depth

D01 03.01.13 1st Issue

Rev	Date	Comment	By
		Do not scale from this drawing	
		All dimensions are to be checked on site	
		Any discrepancies are to be reported immediately to the Architect or Main Contractor	

**COPYRIGHT © 2014**  
 FRANCIS BIRCH ARCHITECTS  
 DESIGN AND VISUAL ARTS TEAM, HAVE BEEN GENERALLY ASSIGNED

Client: Paul & Julia Cox  
 23 Bonnich Avenue  
 London N6

Project: Rear Extension  
 23 Bonnich Avenue N6

Drawings:  
 Outline Proposals  
 Ground Floor Plan

Project No.	Drawing No.	Issue	Status
PC 2012 1012	D09	I	

Scale	Date	Drawn By	Checked By
1:50 @ A1	Dec 2012	FB	FB

**Francis Birch Architect**  
 Francis Birch Architects, 23 Bonnich Avenue, London N6 4JZ  
 T: +44 (0)20 8342 8022  
 F: +44 (0)20 8342 8023  
 E: francis@francisbirch.co.uk