

Rev.	Date	Description	Init.

Client  
147 Kentish Town Ltd.

Project Title  
147 Kentish Town Road

Drawing Title  
EXISTING FIRST FLOOR PLAN

Cad File	Sheet Size	Scale
140915	A3	1:100
Drawn by	Drawing Date	Approved by
-	14.09.15	DW

Project No.	Drawing No.	Revision
1344	GA_P_07	-

**DARIA WONG ARCHITECTS**  
MAGDALEN HOUSE  
148 TOOLEY STREET  
LONDON  
SE1 2TU  
M : 07801 803421  
T : 01923 840077

This drawing is property of Daria Wong Architects © and must not be copied or otherwise reproduced. All dimensions must be checked on site before commencing work. No dimensions to be scaled from this drawing. This drawing was produced using AutoCad LT.

**PLANNING ISSUE**

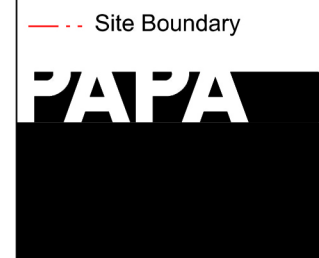
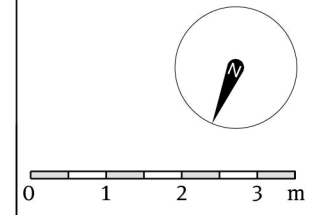

Papa Architects Ltd.  
222 Archway Road, Highgate,  
London N6 5AX  
Phone. +44(0)20 8348 8411  
Fax. +44 (0)20 8348 7411  
www.papaarchitects.co.uk

Client  
Ringley

Address  
147 Kentish Town Road  
London  
NW1 8PB

Drawing title  
Existing  
First Floor

Project No.	Date	Scale
1319	July 13	1:100 @ A3
Drawing No.	Current Rev	
98-203	P00	

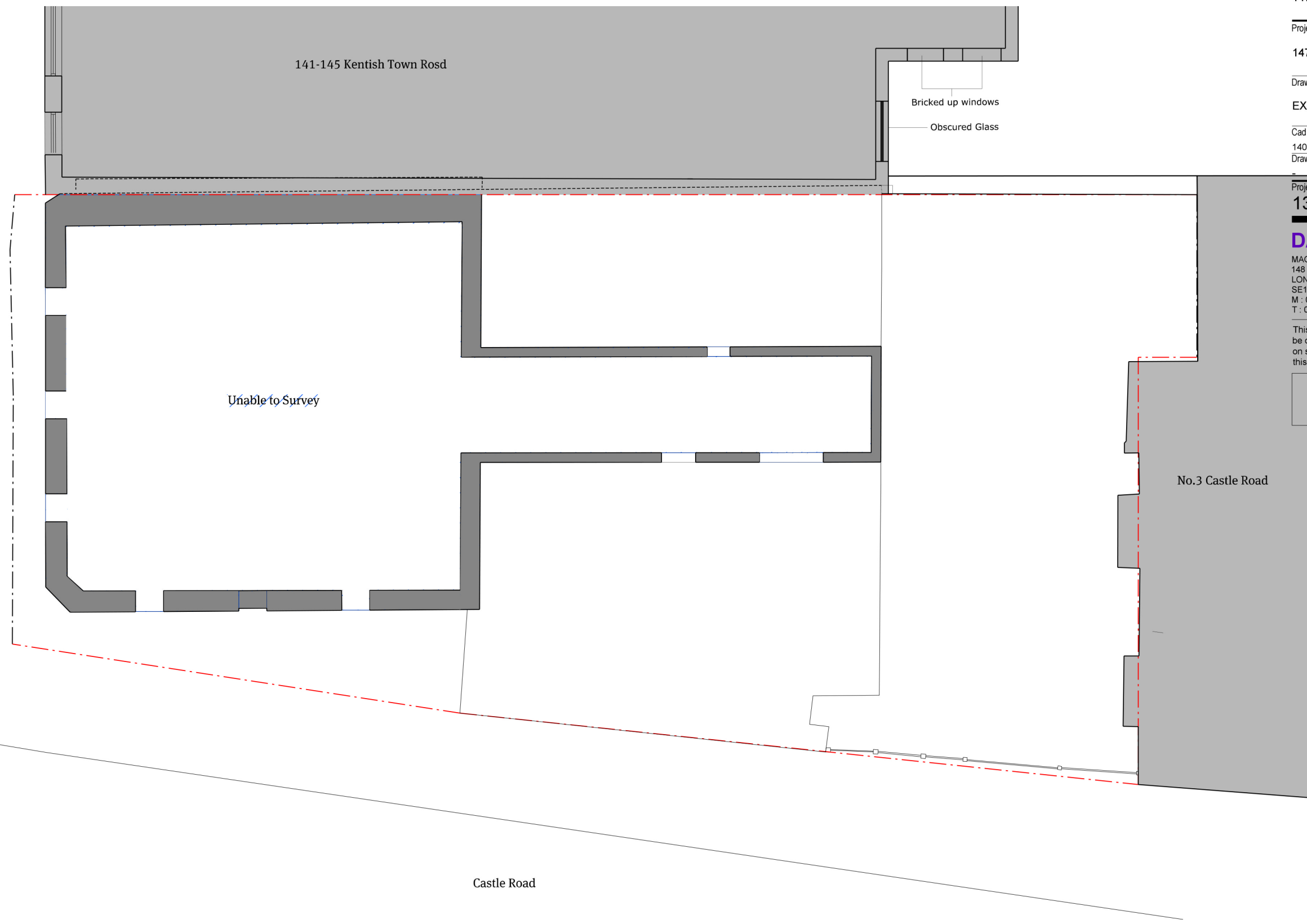

**BASED ON PAPA ARCHITECTS DRAWING 98-203**

**01** Existing First Floor  
1:100@A3