

Notes
 All dimensions must be checked and Papa Architects are to be informed of any discrepancies prior to construction. Any DWG's issued by PAPA architects are to be read in conjunction with the associated PDF versions. This drawing and any of the details therein remain the copyright of Papa Architects Ltd.

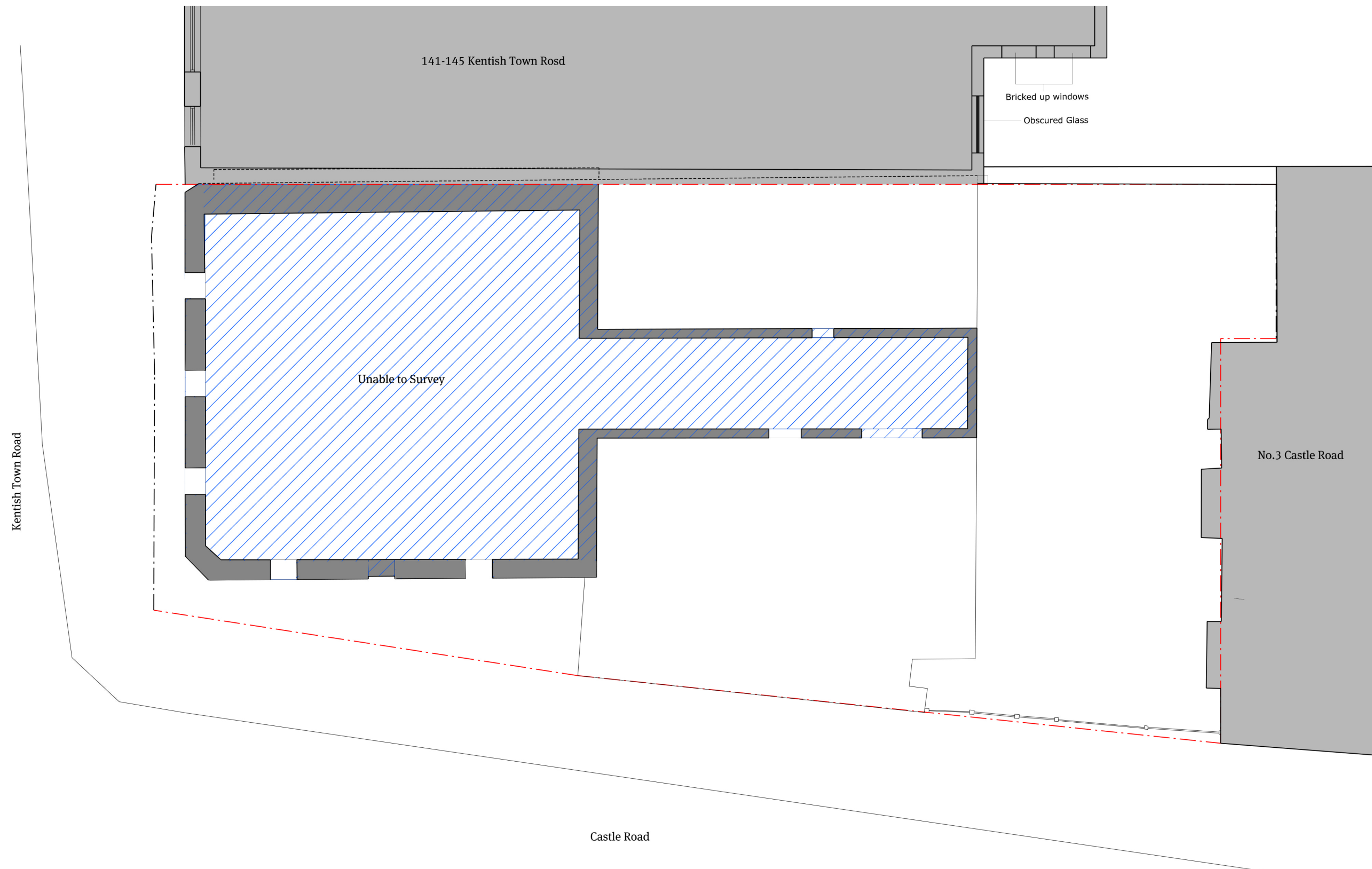

Rev	Date	Reason For Issue	Chk
P00	16.08.13	Planning submission	NP

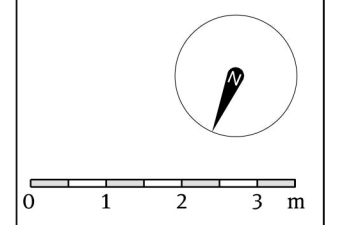

- Demolition area
- Excavation area
- Site Boundary

PAPA

Papa Architects Ltd.
 222 Archway Road, Highgate,
 London N6 5AX
 Phone. +44(0)20 8348 8411
 Fax. +44 (0)20 8348 7411
 www.papaarchitects.co.uk

Client
Ringley

Address
**147 Kentish Town Road
 London
 NW1 8PB**

Drawing title
**Existing
 First Floor**

Project No.	Date	Scale
1319	July 13	1:100 @ A3
Drawing No.	Current Rev	
98-203	P00	