

BARRIER FOR ROOT PROTECTION ZONE

Tree protection area to be constructed with standard scaffold pole and weldmesh panels, secured together with standard clamps, in line with BS5837:2012

Uprights to be driven @ 600mm into ground

Panels secured to uprights with wire ties and where necessary standard scaffold clamps
welmesh wired to uprights and horizontals, with wire twisted and secured on inside face of fencing to avoid easy dismantling.

Notes*
This drawing has been produced in line with BS5837:2012 Trees In relation to construction recommendations.
All root protection areas have been calculated based on the following formula:

$$RPA = \frac{(\text{Stem diameter (mm)} \times 12) \times \pi}{1000} \times 3.142 = xM^2$$

The stem diameter is taken 1.5m above ground level.

All protection areas include trees to be retained and trees to be retained for replanting. Subsequent revisions of this drawing may have to be issued as phased works progress, taking into account replanted trees and their new position.
All areas have been drawn to encompass multiple RPA's and along the lines of best fit for ease of installation and cost effectiveness.
Where adjacent to a public highways retained in use RPA's should be as close as possible to the public highway boundary.
No works should be carried out within the RPA without prior consultation with the landscape architect and written consent for the works to proceed

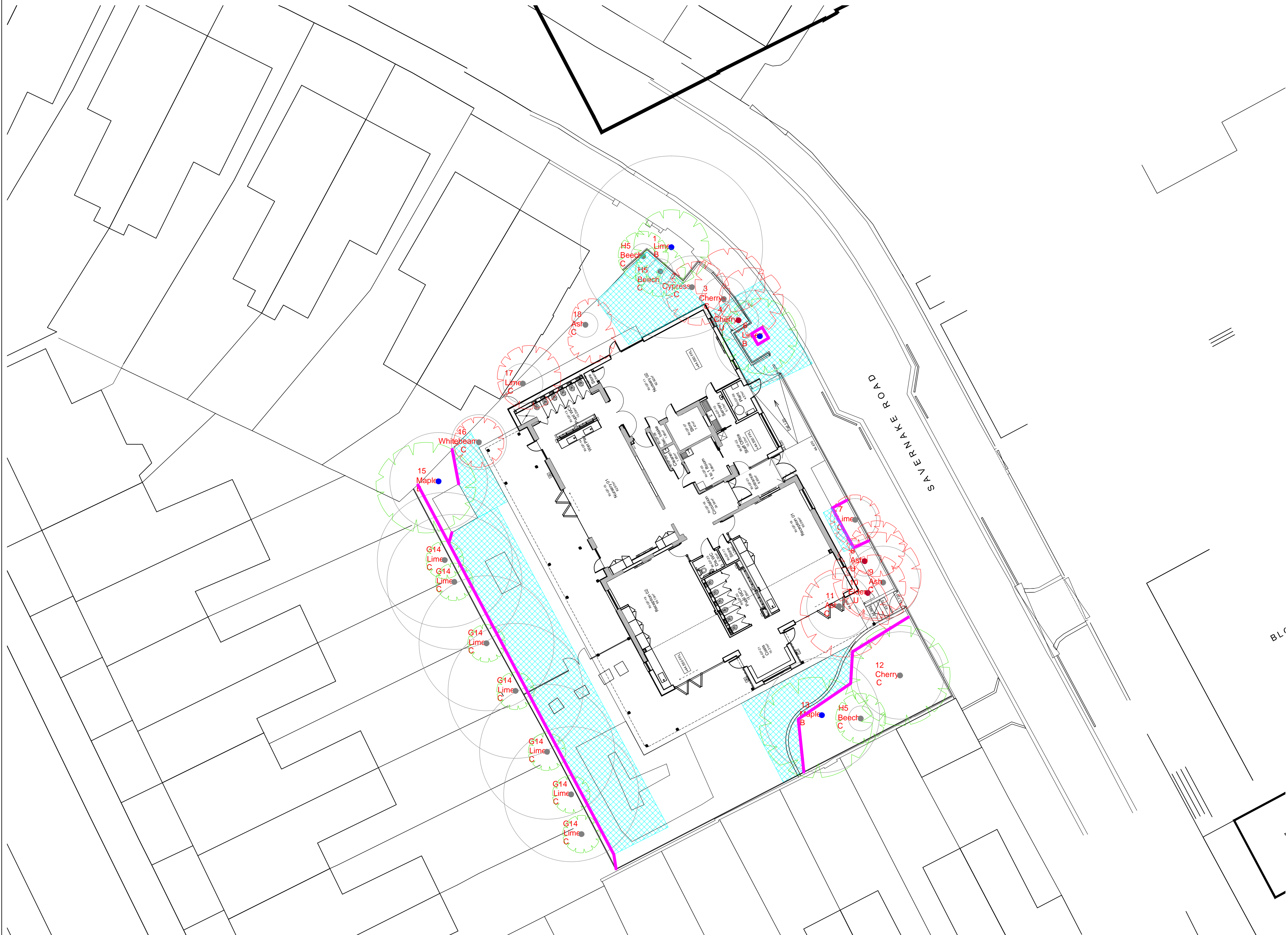

NO-DIG CONSTRUCTION TO BE
POROUS PAVING ABOVE ROOT
PROTECTION ZONE AS BS 5837:2012
Open textured concrete asphalt
50mm 2-6mm clean stone
Geotextile - Terram 700 or equal and similar

DEPTHS TO BE ADJUSTED FOR
INDIVIDUAL TREES TO ENSURE NO
DAMAGE TO EXISTING ROOT SYSTEM

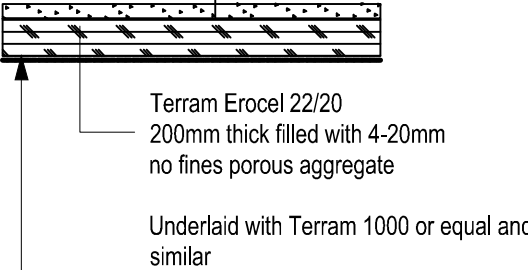

Rev A : 15.9.14 BS reference changed to 2012

NOTE:
This survey is of a preliminary nature. The trees were inspected from the ground only on the basis of the Visual Tree Assessment method. No samples were taken for analysis. No decay detection equipment was employed. The survey does not cover the arrangements that may be required in connection with the laying or removal of underground services.

Branch spread in metres is taken at the four cardinal points to derive an accurate representation of the crown.

Root Protection Areas (RPA) are derived from stem diameter measured at 1.5 m above adjacent ground level (taken on sloping ground on the upslope side of the tree base).

Landmark Trees
20 Broadwick Street, London, W1F 8HT
Tel: 0207 851 4544 Mobile: 07812 989928
e-mail: info@landmarktrees.co.uk Web: www.landmarktrees.co.uk

Site: Gospel Oak Primary
Drawing Title: Tree Protection Plan
1:200@ A1
November 2013

Key:

- Category A High Quality
- Category B Moderate Quality
- Category C Low Quality
- Category U Trees Unsuitable for Retention
- Tree Protection Fencing
- Precautionary area: assumed no-dig construction. All excavation subject to arboricultural supervision: limits of which to be hand-dug; hard-surfacing retained as ground protection where practicable

Category

- Crown Spread
- Tree Number
- Species
- Category
- Tree Position Approximate (not shown on original survey)
- Tree To Be Felled