

- NOTES:
1. This drawing is to be read in conjunction with all relevant contract documentation from the design team, with any conflicting information to be brought to the attention of Turkington Martin Landscape Architects in writing before commencing on site.
 2. The contractor is to check and verify all levels and dimensions before construction. Any discrepancies are to be brought to the attention of Turkington Martin Landscape Architects in writing before commencing on site.
 3. All dimensions in mm, unless otherwise stated.
 4. Do not scale from this drawing.
 5. All sub base and concrete design and specification to engineer's details. All diagrams provided here are purely indicative.
 6. Waterproofing of any element to be specified by others.
 7. All proprietary products shall be installed in accordance with manufacturers written instructions.
 8. Plant numbers are an indication only and plants should be ordered to suit site areas in accordance with scheduled plant densities.
 9. Any proposed plant substitution shall be agreed with the landscape architect prior to ordering.

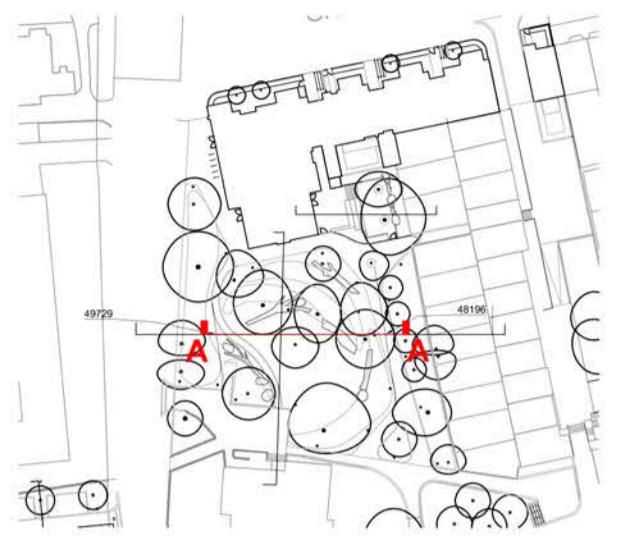

Informal gravel path through the Glade

Reclaimed timber logs and boulders for informal play

New herbaceous and evergreen shade tolerant planting through the Glade

Existing mature trees to be retained

TRA Community Garden with artistic railing to create secure line

New resin bound gravel footpath

Proposed flowering 'Kanzan' Cherry trees

New lighting column to match existing

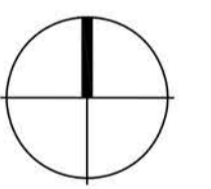

DATE	DRAWN	DESCRIPTION OF REVISION	REVISION LETTER	CHECKED BY

Section AA

turkington martin

36-40 York Way, London, N1 9AB
 T: (+44) 020 7843 3170
 E: studio@turkingtonmartin.com

DRAWING STATUS:
FOR INFORMATION

CLIENT:
**CAMDEN COUNCIL
 EC HARRIS**

PROJECT TITLE:
Maitland Park Estate

DRAWING TITLE:
Landscape Sections

DRAWING SCALE:	DRAWN BY:	DRAWN DATE:
1:50	AD	25/03/14
PAPER SIZE:	CHECKED BY:	CHECKED DATE:
A1	TS	25/03/14

DRAWING NUMBER:
122-LS07

REVISION:
#