

Application for tree works: works to trees subject to a tree preservation order (TPO) and/or notification of proposed works to trees in a conservation area.

Town and Country Planning Act 1990

You can complete and submit this form electronically via the Planning Portal by visiting www.planningportal.gov.uk/apply

Publication of applications on planning authority websites

Please note that the information provided on this application form and in supporting documents may be published on the Authority's website. If you require any further clarification, please contact the Authority's planning department.

Please complete using block capitals and black ink.

You must use this form if you are applying for work to trees protected by a tree preservation order (TPO). (You may also use it to give notice of works to trees in a conservation area).

It is important that you read the accompanying guidance notes before filling in the form. Without the correct information, your application / notice cannot proceed.

1. Applicant Name and Address			
Title:	<input type="text" value="MRS"/>	First name:	<input type="text" value="KAREN"/>
Last name:	<input type="text" value="ANDREW"/>		
Company (optional):	<input type="text" value="CAMDEN & ISLINGTON COMMUNITY SOLUTIONS"/>		
Unit:	<input type="text" value="10"/>	House number:	<input type="text"/>
		House suffix:	<input type="text"/>
House name:	<input type="text" value="CHANCERY EXCHANGE"/>		
Address 1:	<input type="text" value="FURNIVAL STREET."/>		
Address 2:	<input type="text"/>		
Address 3:	<input type="text"/>		
Town:	<input type="text" value="LONDON"/>		
County:	<input type="text"/>		
Country:	<input type="text" value="UK"/>		
Postcode:	<input type="text" value="EC4A 1AB"/>		

2. Agent Name and Address			
Title:	<input type="text"/>	First name:	<input type="text"/>
Last name:	<input type="text"/>		
Company (optional):	<input type="text"/>		
Unit:	<input type="text"/>	House number:	<input type="text"/>
		House suffix:	<input type="text"/>
House name:	<input type="text"/>		
Address 1:	<input type="text"/>		
Address 2:	<input type="text"/>		
Address 3:	<input type="text"/>		
Town:	<input type="text"/>		
County:	<input type="text"/>		
Country:	<input type="text"/>		
Postcode:	<input type="text"/>		

3. Trees Location

If all trees stand at the address shown in Question 1, go to Question 4. Otherwise, please provide the full address/location of the site where the tree(s) stand (including full postcode where available)

Unit: House number: House suffix:

House name:

Address 1:

Address 2:

Address 3:

Town:

County:

Postcode (if known):

If the location is unclear or there is not a full postal address, either describe as clearly as possible where it is (for example, 'Land to the rear of 12 to 18 High Street' or 'Woodland adjoining Elm Road') or provide an Ordnance Survey grid reference:

Description:

FRONTING BARTHOLOMEW ROAD ALONG THE BOUNDARY WITH BARTHOLOMEW ROAD AND HEALTH CENTRE.
BOUNDARY BETWEEN HEALTH CENTRE AND 10 BARTHOLOMEW ROAD

4. Trees Ownership

Is the applicant the owner of the tree(s): Yes No
If 'No' please provide the address of the owner (if known and if different from the trees location)

Title: First name:

Last name:

Company (optional):

Unit: House number: House suffix:

House name:

Address 1:

Address 2:

Address 3:

Town:

County:

Country:

Postcode:

Telephone numbers

Country code:	National number:	Extension number:
<input type="text"/>	<input type="text"/>	<input type="text"/>
Country code:	Mobile number (optional):	
<input type="text"/>	<input type="text"/>	
Country code:	Fax number (optional):	
<input type="text"/>	<input type="text"/>	

Email address (optional):

5. What Are You Applying For?

Are you seeking consent for works to tree(s) subject to a TPO? Yes No

Are you wishing to carry out works to tree(s) in a conservation area? Yes No

6. Tree Preservation Order Details

If you know which TPO protects the tree(s), enter its title or number below.

7. Identification Of Tree(s) And Description Of Works

Please identify the tree(s) and provide a full and clear specification of the works you want to carry out. Continue on a separate sheet if necessary. You might find it useful to contact an arborist (tree surgeon) for help with defining appropriate work. Where trees are protected by a TPO, please number them as shown in the First Schedule to the TPO where this is available. Use the same numbers on your sketch plan (see guidance notes).

Please provide the following information below: tree species (and the number used on the sketch plan) and description of works. Where trees are protected by a TPO you must also provide reasons for the work and, where trees are being felled, please give your proposals for planting replacement trees (including quantity, species, position and size) or reasons for not wanting to replant.

E.g. Oak (T3) - fell because of excessive shading and low amenity value. Replant with 1 standard ash in the same place.

TPO C569 FRONTING BARTHOLOMEW ROAD AND AROUND THE BOUNDARY OF KENTISH TOWN HEALTH CENTRE. LONDON PLANE TREES. PRUNE BACK AS THE LONDON PLANE TREES ARE DAMAGING ROOF COPING STONES ON HEALTH CENTRE. PRUNE LONDON PLANE TREE ON BOUNDARY WITH 10 BARTHOLOMEW ROAD TO GIVE 2 METER CLEARANCE FROM N° 10.

7. Identification Of Tree(s) And Description Of Works continued ...

8. Trees - Additional Information

Additional information may be attached to electronic communications or provided separately in paper format.

For all trees

A sketch plan clearly showing the position of trees listed in Question 7 must be provided when applying for works to trees covered by a TPO. A sketch plan is also advised when notifying the LPA of works to trees in a conservation area (see guidance notes). It would also be helpful if you provided details of any advice given on site by an LPA officer.

For works to trees covered by a TPO

Please indicate whether the reasons for carrying out the proposed works include any of the following. If so, your application must be accompanied by the necessary evidence to support your proposals. (See guidance notes for further details)

1. **Condition of the tree(s)** - e.g. it is diseased or you have fears that it might break or fall: Yes No
If YES, you are required to provide written arboricultural advice or other diagnostic information from an appropriate expert.

2. **Alleged damage to property** - e.g. subsidence or damage to drains or drives. Yes No
If YES, you are required to provide for:

Subsidence

A report by an engineer or surveyor, to include a description of damage, vegetation, monitoring data, soil, roots and repair proposals. Also a report from an arboriculturist to support the tree work proposals.

Other structural damage (e.g. drains, walls and hard surfaces)

Written technical evidence from an appropriate expert, including description of damage and possible solutions.

Documents and plans (for any tree)

Are you providing separate information (e.g. an additional schedule of work for Question 7)? Yes No

If YES, please provide the reference numbers of plans, documents, professional reports, photographs etc in support of your application. If they are being provided separately from this form, please detail how they are being submitted.

PREVIOUS PLANNING DECISION 2008/2878/T. DATED 4/8/2008

9. Authority Employee / Member

With respect to the Authority, I am:

- (a) a member of staff (c) related to a member of staff
(b) an elected member (d) related to an elected member

Do any of these statements apply to you?

Yes

No

If Yes, please provide details of the name, relationship and role

PROPERTY MANAGER EMPLOYED BY CAMDEN & ISLINGTON COMMUNITY SOLUTIONS LTD (LANDLORD)

10. Application For Tree Works - Checklist

Only one copy of the application form and additional information (Question 8) is required. Please use the guidance and this checklist to make sure that this form has been completed correctly and that all relevant information is submitted. Please note that failure to supply precise and detailed information may result in your application being rejected or delayed. You do not need to fill out this section, but it may help you to submit a valid form.

Sketch Plan

- A sketch plan showing the location of all trees (see Question 8)

For all trees

(see Question 7)

- Clear identification of the trees concerned
- A full and clear specification of the works to be carried out

For works to trees protected by a TPO

(see Question 7)

Have you:

- stated reasons for the proposed works?
- provided evidence in support of the stated reasons? in particular:
 - if your reasons relate to the condition of the tree(s) - written evidence from an appropriate expert
 - if you are alleging subsidence damage - a report by an appropriate engineer or surveyor and one from an arboriculturist.
 - in respect of other structural damage - written technical evidence
- included all other information listed in Question 8?

11. Declaration - Trees

I/we hereby apply for planning permission/consent as described in this form and the accompanying plans/drawings and additional information. I/we confirm that, to the best of my/our knowledge, any facts stated are true and accurate and any opinions given are the genuine opinions of the person(s) giving them.

Sign:

[Redacted Signature]

Or signed - Agent:

[Redacted Signature]

Date (DD/MM/YYYY):

16/09/2014

(This date must not be before the date of sending or hand-delivery of the form)

12. Applicant Contact Details

Telephone numbers

[Redacted Contact Details]

13. Agent Contact Details

Telephone numbers

Country code: National number: Extension number:

[Redacted]

[Redacted]

[Redacted]

Country code: Mobile number (optional):

[Redacted]

[Redacted]

Country code: Fax number (optional):

[Redacted]

[Redacted]

Email address (optional):

[Redacted]

(Please see guidance notes)

The LPA may communicate with you in the same manner.

Scanned & e-mailed

to Malaika. (KL)



Urban Design & Renewal Service
Planning

London Borough of Camden
Town Hall
Argyle Street
London WC1H 8ND

Tel 020 7278 4444
Fax 020 7974 1930
Textlink 020 7974 6866

urban.design@camden.gov.uk
www.camden.gov.uk/planning

Solent Community Solutions Ltd
Raebarn House
Hulbert Road
WATERLOOVILLE
HAMPSHIRE
PO7 7GP

Application Ref: **2008/2878/T**
Please ask for: **Kevin Fisher**
Telephone: 020 7974 **5616**

04 August 2008

Dear Sir/Madam

DECISION

Town and Country Planning Acts 1990 (as amended)
Town and Country Planning (Tree Preservation Order) Regulations 1999

PART APPROVAL / REFUSAL OF WORKS TO TREE/S UNDER A TREE PRESERVATION ORDER

Address: **Kentish Town Health Centre, 2 Bartholomew Road, London, NW5 2BX**

Proposal:

(TPO Ref: C569) FRONTING BARTHOLOMEW ROAD, ALONG THE BOUNDARY WITH
10 BARTHOLOMEW ROAD: 1 x London Plane - [Option 1] Remove. [Option 2] Severe
pruning/pollarding.

1 x London Plane - Prune back to give 2m clearance to 10 Bartholomew Road.

The Council has considered your application dated 09 June 2008 and decided the following:

a) to REFUSE :

Plane closest to No.10: Option 1 Fell Option 2 Severely Prune or Pollard (See Informative)

Reasons for Refusal

- 1 The Plane tree is considered to be of particular amenity value and contributes to the character of the Conservation Area. The proposed works would be detrimental to the trees' amenity value and contribution it makes to the character of the Conservation Area.



b) to GRANT APPROVAL for:

Plane furthest from 10 Bartholomew Road: Prune to give 2m clearance of No.10

Informative(s):

- 1 The Council would allow pruning of the Plane closest to NO.10 to give 2m clearance of the building. No further consent would be required for this work.

If you are unhappy with the Council's decision you may appeal within 28 days of the date of this notice by writing to The Environment Team, Room 4/04, Kite Wing, Temple Quay House, 2 The Square, Temple Quay, Bristol BS1 6PN.

Yours faithfully



Rachel Stopard
Director of Culture & Environment

Project No	501 -
Client	AP
Scale	1:100 @ A1; 1:200 @ A3
Discipline	Planning
Drawn by	
Checked by	
Approved by	
Project Name	EXISTING SITE PLAN
Client Name	KENTISH TOWN HEALTH CENTRE
Client Address	ALLFORD HALL MONAGHAN MORRIS 2ND FLOOR, BLOCK 10, 10000 RIVERVIEW ROAD, KENTISH TOWN, KENT, TN11 9AA TEL: 020 7251 1200 FAX: 020 7251 1201 WWW.AMM.CO.UK
Location	
Notes	

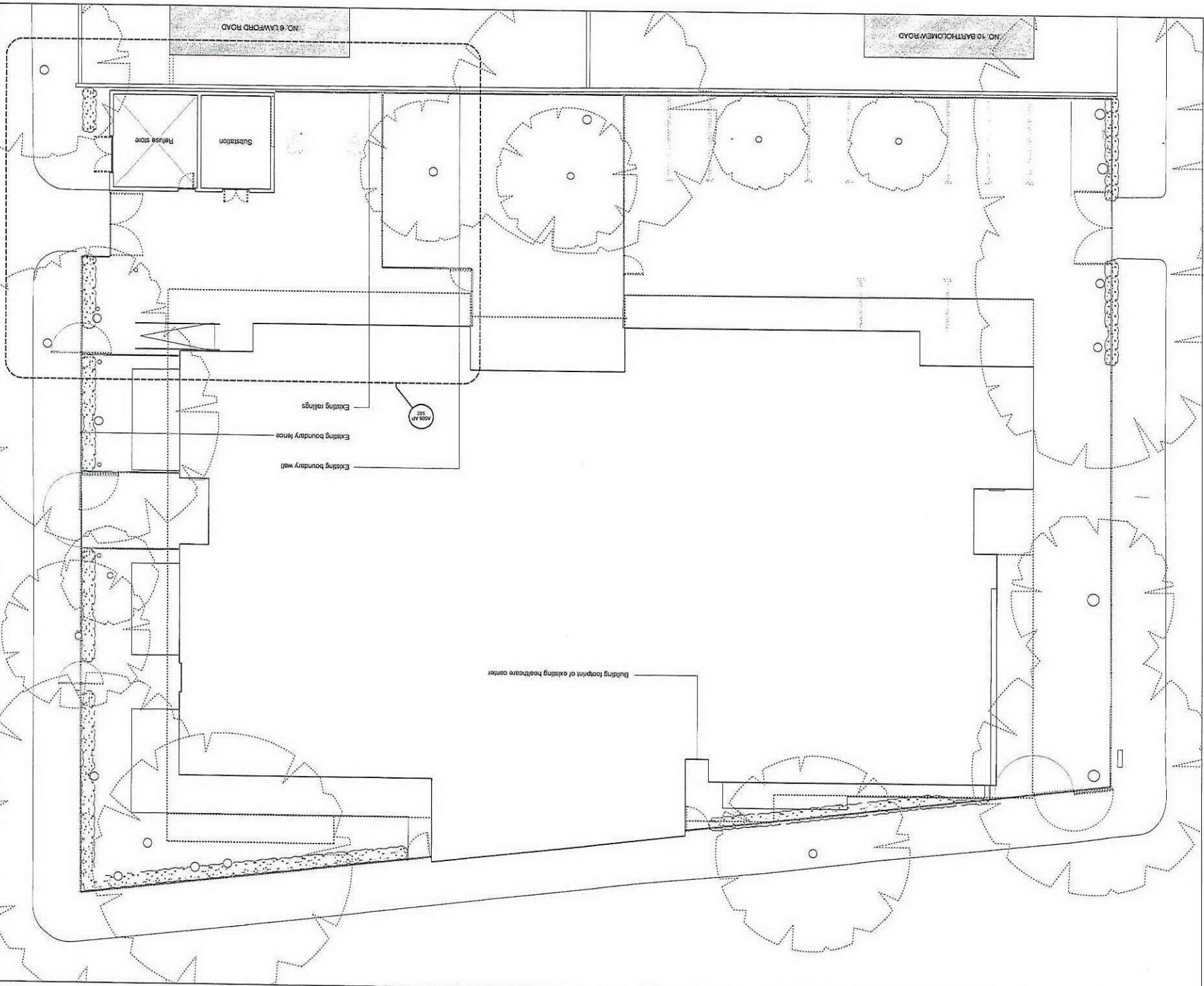

KEY

NOTE

