

NOTE :
See also demolition plan

floor to the vaults to be lowered following Structural engineers' designs and calculations where vaults and supporting walls will be underpinned as normally

Floor to this vault to remain as existing

SECTION A - A

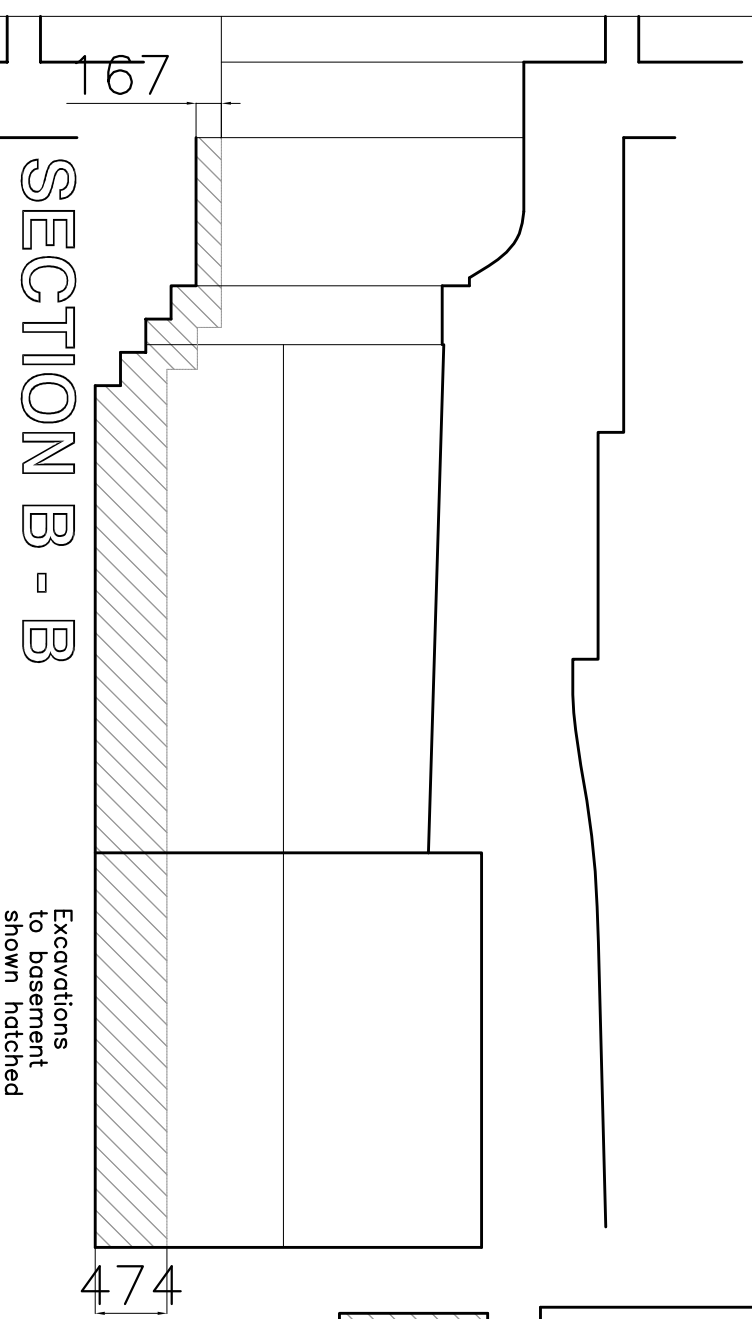

SECTION B - B

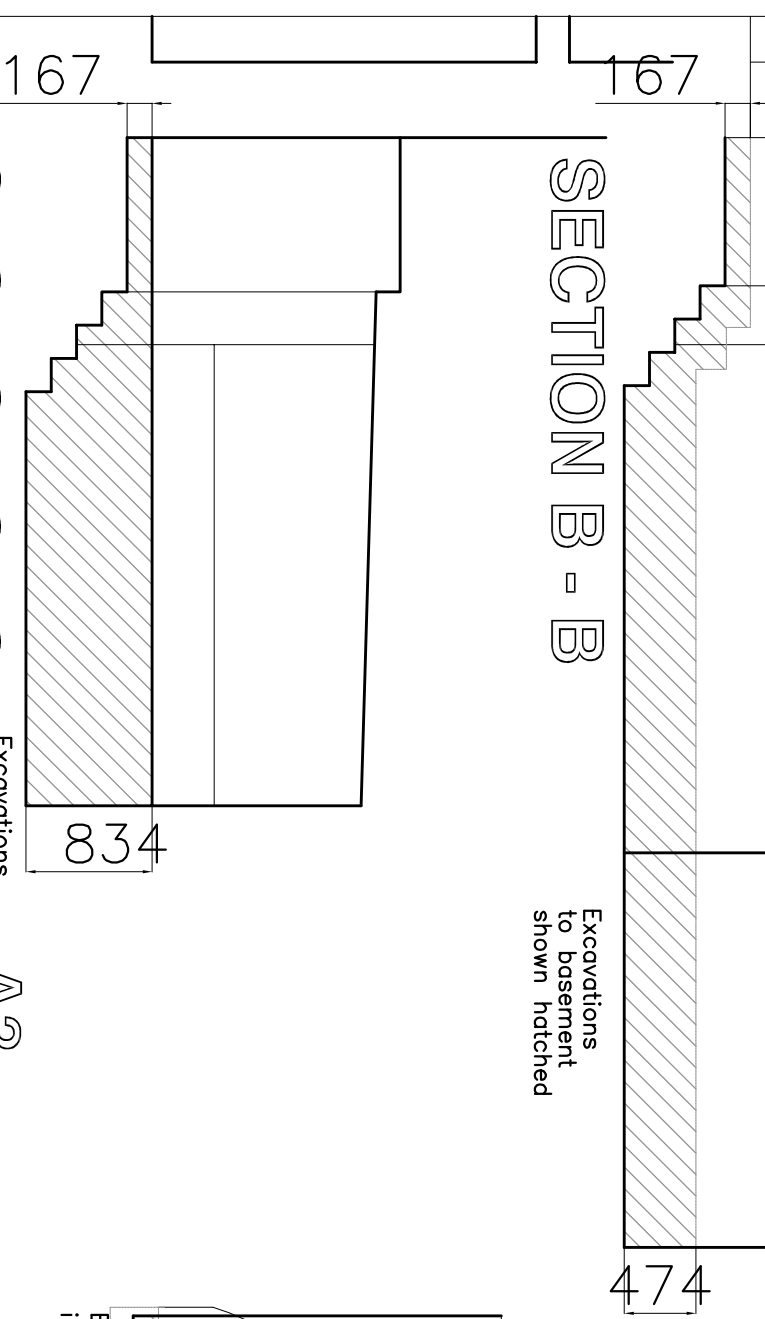

SECTION C - C

Excavations to basement shown hatched

834

A

B

C

Floor to this vault to remain as existing

Bicycle store

Excavations to basement shown hatched

Relocate Gas meters in Basement Store

A

Courtyard

replace door with glass door panel

B

glazed-section over door

C

WC

Study

Utility Room

474

BASEMENT PLAN

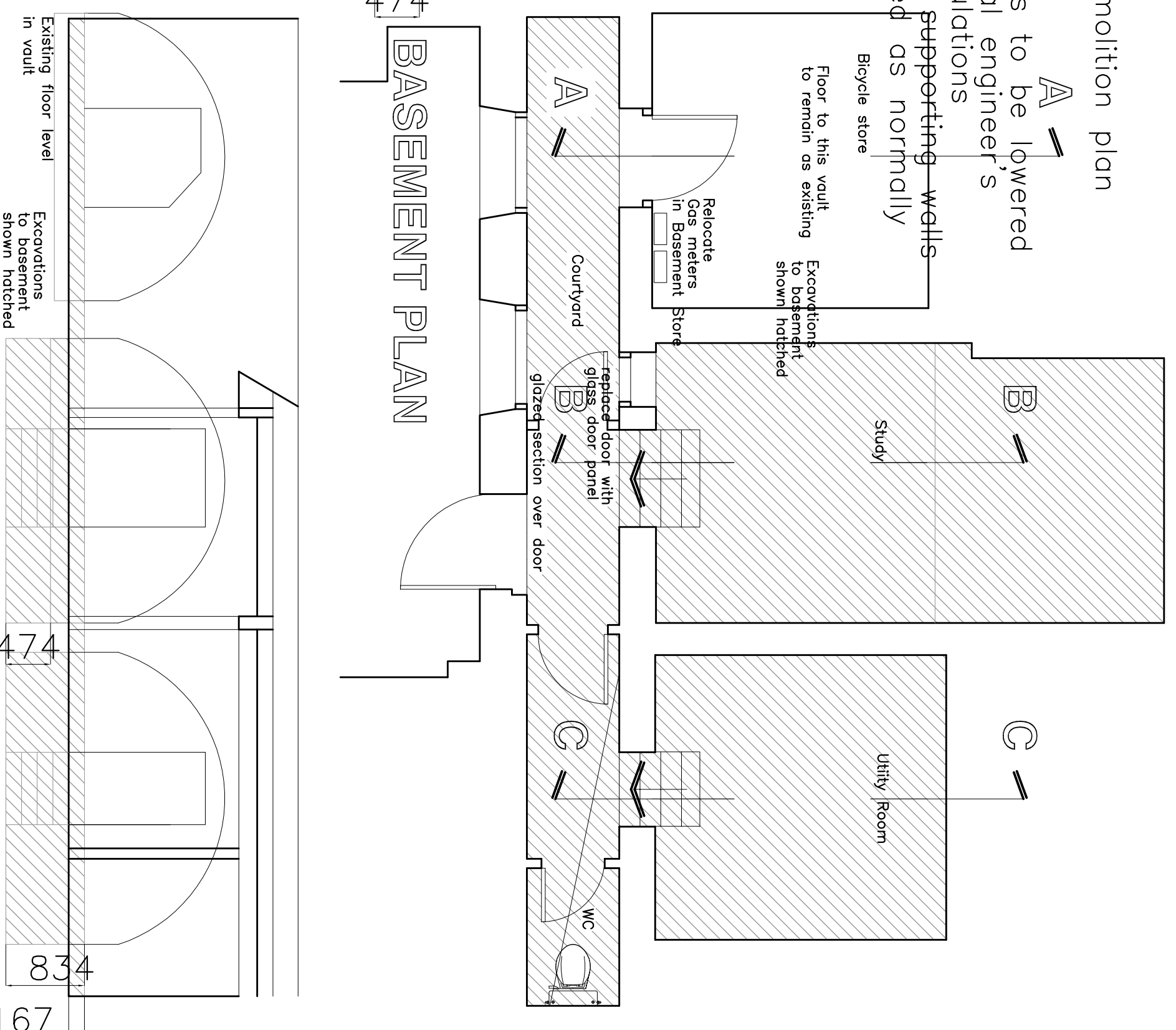

Existing floor level in vault

Excavations to basement shown hatched

474

834

167

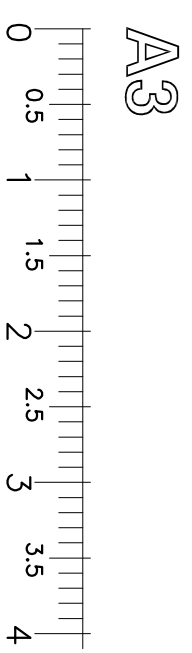

Yiannis Pareas Chartered Architects
82 Mill Lane
London NW6 1NL
Tel 020 7431 5022

28 CHURCH ROW
LONDON NW3 6UP

VAULTS PLAN
AS PROPOSED
DRAWING NO 508/13

fax 020 7435 6571 SCALE 1:50