

All discrepancies to be reported to TTSP.

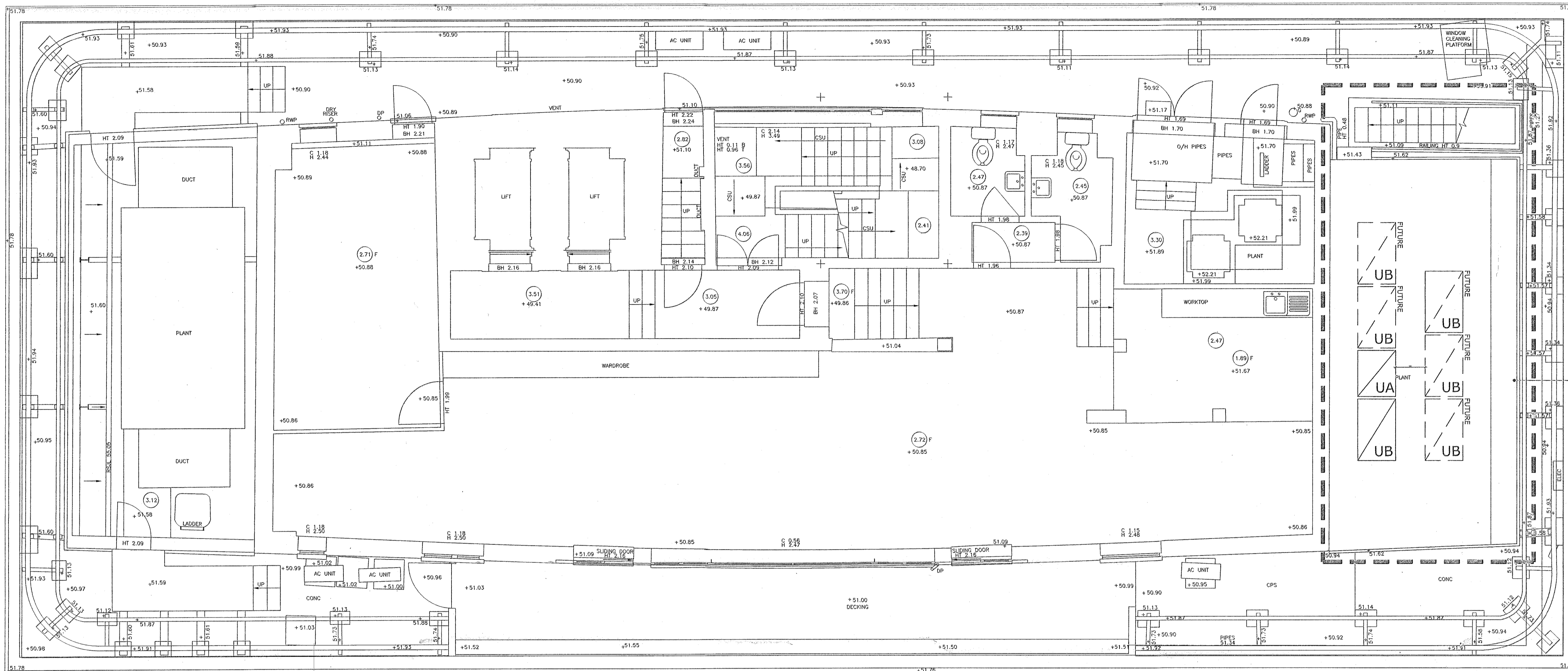

1 Proposed 11th Floor Roof
Scale 1:50

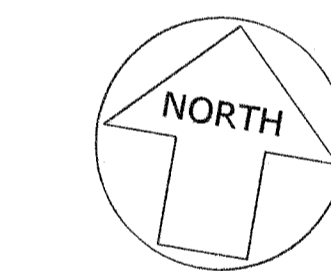
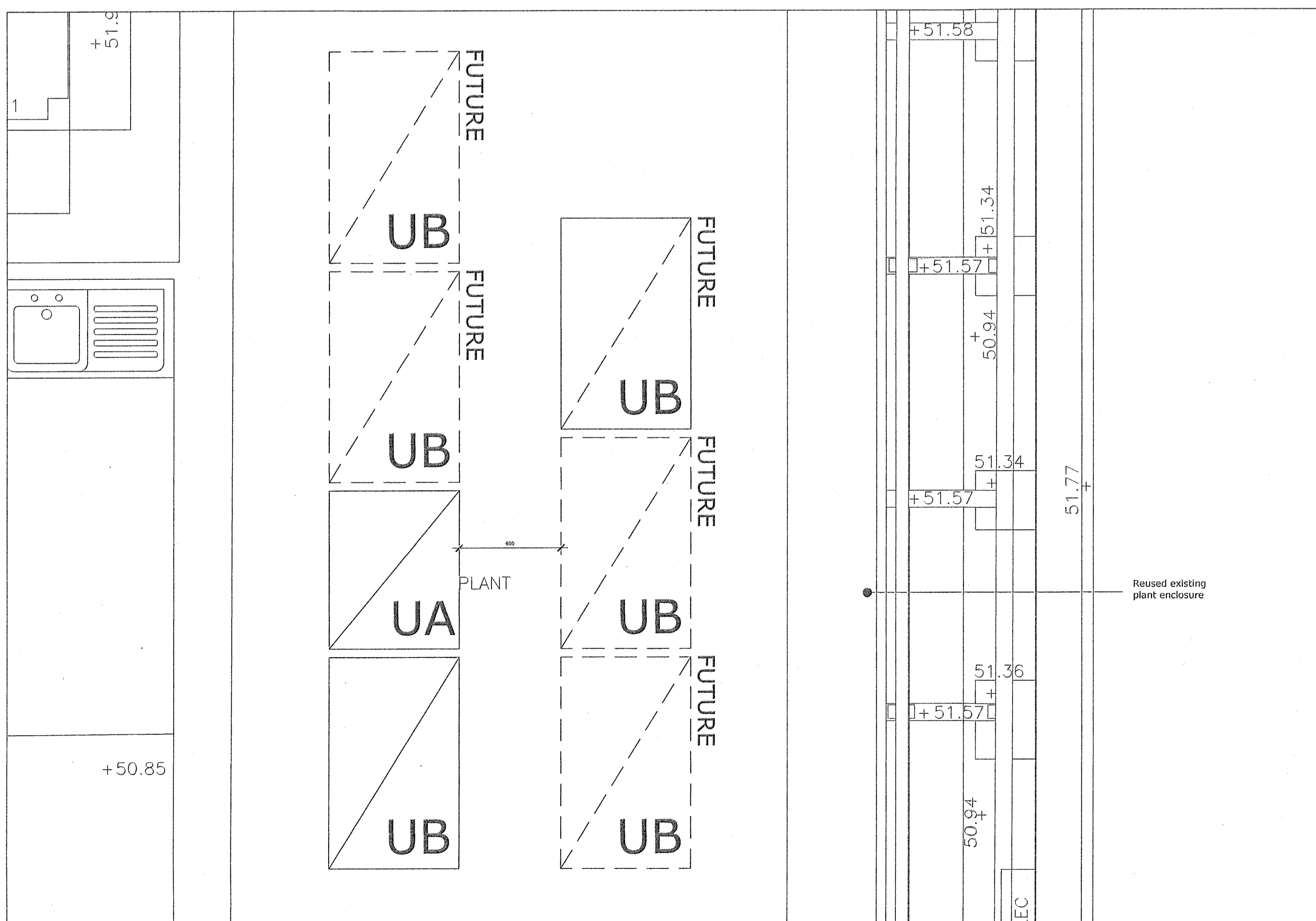

- Notes
- Unit A Dimensions
Height = 1685mm
Width = 930mm
Depth = 765mm
Weight = 198kg
 - Unit B Dimensions
Height = 1685mm
Width = 1240mm
Depth = 765mm
Weight = 319kg
 - Outdoor units to be mounted on suitable load spreading structure
 - Unit Model
UB = Daikin REYQ14T
UA = Daikin REYQ8T

2 Proposed 11th Floor Roof Detail
Scale 1:20

Rev	Date	Revisions	By	Ch'd
Drawing Status				
FOR PLANNING				
Project Title				
Holborn Tower 137-144 High Holborn				
London WC1V 6PL				
Drawing title				
Proposed Split Unit Location				
11th Floor				
Planning Application				
Sheet	Scale	Date	Drawn	Ch'd
A1	As Shown	21.08.14	AS	SW
Project no				
2959				
Drawing no				
A05706				
Rev				
-				

FOR PLANNING

Project Title
Holborn Tower 137-144 High Holborn
London WC1V 6PL

Drawing title
Proposed Split Unit Location
11th Floor
Planning Application

Sheet Scale Date Drawn Ch'd
A1 As Shown 21.08.14 AS SW

Project no
2959

Drawing no
A05706

