

4/12

Planning Services
Camden Town Hall
Argyle Street
London WC1H 8EQ

Email (enquiries only): planning@camden.gov.uk
Telephone : 020 7974 4444
Fax : 020 7974 1680

For online use
Date: _____
Page: _____
App. No: _____



Application for tree works: ~~works to trees subject to a tree preservation order (TPO)~~
~~and/or~~ notification of proposed works to trees in a conservation area.

Town and Country Planning Act 1990

You can complete and submit this form electronically via the Planning Portal by visiting www.planningportal.gov.uk/apply

Publication of applications on planning authority websites

Please note that the information provided on this application form and in supporting documents may be published on the Authority's website. If you require any further clarification, please contact the Authority's planning department.

Please complete using block capitals and black ink.

You must use this form if you are applying for work to trees protected by a tree preservation order (TPO). (You may also use it to give notice of works to trees in a conservation area).

It is important that you read the accompanying guidance notes before filling in the form. Without the correct information, your application / notice cannot proceed.

Joint Application from: 2nd Applicant

1. Applicant Name and Address	2. Agent Name and Address
Title: MR First name: CHARLES	Title: MR First name: STEFAN
Last name: MORRIS	Last name: SAMEK
Company (optional):	Company (optional):
Unit: 2B House number: 105 House suffix:	Unit: 1 House number: 105 House suffix:
House name:	House name:
Address 1: CANFIELD GARDENS	Address 1: CANFIELD GARDENS
Address 2:	Address 2:
Address 3:	Address 3:
Town: LONDON	Town: LONDON
County:	County:
Country:	Country:
Postcode: NW6 3DY	Postcode: NW6 3DY

2013/8001/T

3. Tree Location

If all trees stand at the address shown in Question 1, go to Question 4. Otherwise, please provide the full address/location of the site where the tree(s) stand (including full postcode where available)

Unit: Land 2B House number: House suffix:

House name:

Address 1:

Address 2:

Address 3:

Town:

County:

Postcode (if known):

If the location is unclear or there is not a full postal address, either describe as clearly as possible where it is (for example, 'Land to the rear of 12 to 18 High Street' or 'Woodland adjoining Elm Road') or provide an Ordnance Survey grid reference:

Description:

The six Leylandii trees are at the rear of the gardens of Flats 1 and 2B - three per garden - hence the joint application from the owners of Flats 1 and 2B.

4. Trees Ownership

Is the applicant the owner of the tree(s): Yes No
If 'No' please provide the address of the owner (if known and if different from the trees location)

Title: First name:

Last name:

Company (optional):

Unit: 1 House number: House suffix:

House name:

Address 1:

Address 2:

Address 3:

Town:

County:

Country:

Postcode:

Telephone numbers

Country code:	National number:	Extension number:
<input type="text"/>	<input type="text"/>	<input type="text"/>
Country code:	<input type="text"/>	
<input type="text"/>	<input type="text"/>	
Country code:	Fax number (optional):	
<input type="text"/>	<input type="text"/>	

Email address (optional):

5. What Are You Applying For?

- Are you seeking consent for works to tree(s) subject to a TPO? Yes No
- Are you wishing to carry out works to tree(s) in a conservation area? Yes No

6. Tree Preservation Order Details

If you know which TPO protects the tree(s), enter its title or number below.

7. Identification Of Tree(s) And Description Of Works

Please identify the tree(s) and provide a full and clear specification of the works you want to carry out. Continue on a separate sheet if necessary. You might find it useful to contact an arborist (tree surgeon) for help with defining appropriate work. Where trees are protected by a TPO, please number them as shown in the First Schedule to the TPO where this is available. Use the same numbers on your sketch plan (see guidance notes).

Please provide the following information below: tree species (and the number used on the sketch plan) and description of works. Where trees are protected by a TPO you must also provide reasons for the work and, where trees are being felled, please give your proposals for planting replacement trees (including quantity, species, position and size) or reasons for not wanting to replant.

E.g. Oak (T3) - fell because of excessive shading and low amenity value. Replant with 1 standard ash in the same place.

My neighbours Stefan and Sue Samek (Flat 1) and I (Charles Morris, Flat 2B, Tel.) seek permission to trim six Leylandii trees at the rear of our respective gardens (three per garden). The trees

7. Identification Of Tree(s) And Description Of Works continued ...

are approximately 40 feet high, and we wish to reduce them to 20 feet high in order to let more light into our homes and gardens, and maintain the look and health of the trees. This is a repeat of our previous, successful application of 16/4/2007, approved on 15/5/2007, reference no. 2007/1717/T. The tree surgeon would also trim branches where appropriate for the health of the trees.

In addition, I also seek permission to fell one Leylandii tree in my garden (2B), the one on the extreme left (see sketch). This is because the tree is hindering the growth of a tree next to it and the adjoining ~~and~~ Leylandii, which will grow over to fill the space. Part of this tree (the one I wish to fell) is dying because of the confined space. Felling it would also let more light

8. Trees - Additional Information

and rainfall on to the garden beneath, and prevent moss growing at the rear of the lawn.

Additional information may be attached to electronic communications or provided separately in paper format.

For all trees

A sketch plan clearly showing the position of trees listed in Question 7 must be provided when applying for works to trees covered by a TPO. A sketch plan is also advised when notifying the LPA of works to trees in a conservation area (see guidance notes). It would also be helpful if you provided details of any advice given on site by an LPA officer.

For works to trees covered by a TPO

Please indicate whether the reasons for carrying out the proposed works include any of the following. If so, your application must be accompanied by the necessary evidence to support your proposals. (See guidance notes for further details)

1. **Condition of the tree(s)** - e.g. it is diseased or you have fears that it might break or fall:

If YES, you are required to provide written arboricultural advice or other diagnostic information from an appropriate expert.

Yes No

2. **Alleged damage to property** - e.g. subsidence or damage to drains or drives.

If YES, you are required to provide for:

Yes No

Subsidence

A report by an engineer or surveyor, to include a description of damage, vegetation, monitoring data, soil, roots and repair proposals. Also a report from an arboriculturist to support the tree work proposals.

Other structural damage (e.g. drains, walls and hard surfaces)

Written technical evidence from an appropriate expert, including description of damage and possible solutions.

Documents and plans (for any tree)

Are you providing separate information (e.g. an additional schedule of work for Question 7)?

Yes No

If YES, please provide the reference numbers of plans, documents, professional reports, photographs etc in support of your application. If they are being provided separately from this form, please detail how they are being submitted.

Sketch plan enclosed.

9. Authority Employee / Member

With respect to the Authority, I am:

- (a) a member of staff (c) related to a member of staff
(b) an elected member (d) related to an elected member

Do any of these statements apply to you?

Yes

No

If Yes, please provide details of the name, relationship and role

10. Application For Tree Works - Checklist

Only one copy of the application form and additional information (Question 8) is required. Please use the guidance and this checklist to make sure that this form has been completed correctly and that all relevant information is submitted. Please note that failure to supply precise and detailed information may result in your application being rejected or delayed. You do not need to fill out this section, but it may help you to submit a valid form.

Sketch Plan

- A sketch plan showing the location of all trees (see Question 8)

For all trees

(see Question 7)

- Clear identification of the trees concerned
- A full and clear specification of the works to be carried out

For works to trees protected by a TPO

(see Question 7)

Have you:

- stated reasons for the proposed works?
- provided evidence in support of the stated reasons? in particular:
 - if your reasons relate to the condition of the tree(s) - written evidence from an appropriate expert
 - if you are alleging subsidence damage - a report by an appropriate engineer or surveyor and one from an arboriculturist.
 - in respect of other structural damage - written technical evidence
- included all other information listed in Question 8?

11. Declaration - Trees

I/we hereby apply for planning permission/consent as described in this form and the accompanying plans/drawings and additional information. I/we confirm that, to the best of my/our knowledge, any facts stated are true and accurate and any opinions given are the genuine opinions of the person(s) giving them.

Signed - Agent:

Or signed - Agent:

Date (DD/MM/YYYY):

04/12/2013

(This date must not be before the date of sending or hand-delivery of the form)

12. Applicant Contact Details

Telephone numbers

Country code: National number:

Extension number:

Country code:

Country code:

Email address (optional):

13. Agent Contact Details

Telephone numbers

Country code: National number:

Extension number:

Country code: Mobile number (optional):

Country code: Fax number (optional):

Email address (optional):

* TREE TO BE FELLED

ADJOINING GARDENS

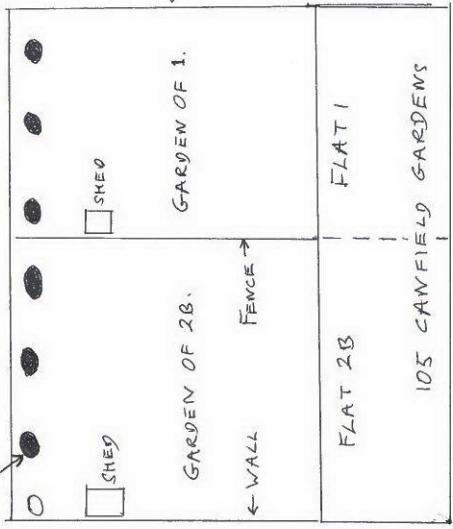

- TREES TO BE TRIMMED
- TREE NOT TO BE TRIMMED

CANFIELD GARDENS NW6