

REV	DATE	DESCRIPTION
01.10.14		Application of details reserved by condition

CONSULTANTS	
CLIENT:	Stanley Sidings
SCHOOL CLIENT TEAM:	Hawley School
	SCABAL
	Camden Children, Schools and Families
LANDSCAPE ARCHITECTS:	Fabrik
PLANNING CONSULTANTS:	Gerald Eve
STRUCTURAL ENGINEER:	Walsh Group
MECHANICAL ENGINEER, FIRE, BREEAM, ENERGY, ACOUSTICS:	Waterman Building Services
COST CONSULTANT:	Gardiner and Theobald
TRANSPORT CONSULTANT:	Ansp
CDM CO-ORDINATOR:	MSA Safety

NOTE

- Do not scale from this drawing.
- All dimensions to be checked on site by the contractor and such dimensions to be his responsibility. Report all drawing errors, omissions and discrepancies to the architect.
- This document may be issued in an uncontrolled CAD format to enable others to use it as background information to make alterations and/or additions. In that instance the file will be accompanied by a PDF version. It is for those making such alterations and additions to ensure that they make use of current background information.
- AHMM Ltd accepts no liability for any such alterations or additions to the background information or arising out of changes to background information which occur prior to alterations of additions being made.

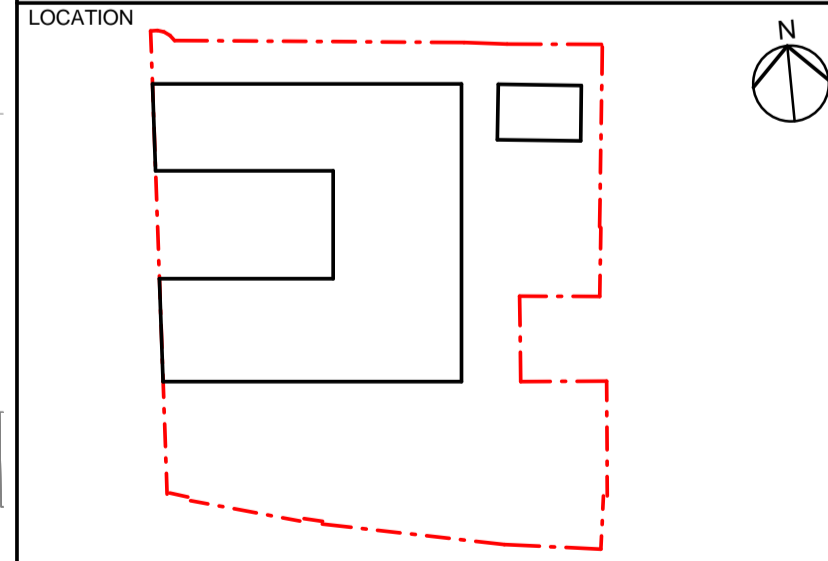

ALLFORD HALL MONAGHAN MORRIS
 ARCHITECTS Ltd
 2ND FLOOR, BLOCK C, 5-23 OLD STREET LONDON EC1V 9HL
 TEL 020 7251 5261 FAX 020 7251 5123 WEB WWW.AHMM.CO.UK

job title
Hawley Primary School
 drawing title / location
General Arrangement Ground Floor Plan

drawn by	checked	scale	status	
MM	DM	1 : 125 @ A1	Planning	
project	zone	building element	drawing no.	revision
12160		10	305	