

THE LONDON BOROUGH OF CAMDEN
PLANNING (LISTED BUILDINGS AND CONSERVATION AREAS) ACT 1990
(AS AMENDED)

LISTED BUILDING ENFORCEMENT NOTICE

OF **Wildwood Lodge**
9 North End
London
NW3 7HH

1. **THIS IS A FORMAL NOTICE**, which is issued by the Council being the Local Planning Authority for the purposes of Section 38 of the above Act because it appears to them that there has been a contravention of Section 8 of the Act, in respect of the building within a conservation area described below. The Council considers it necessary to issue this notice for the reasons set out in paragraph 4 below.

2. **THE LISTED BUILDING.**

Land at: Wildwood Lodge, 9 North End, London NW3 7HH
as shown, for the purposes of identification only, outlined in black on the attached plan.

3. **THE CONTRAVENTION ALLEGED.**

Without listed building consent: excavation of additional basement accommodation, plus an external staircase and opening to the rear garden, as a rear extension to the existing and approved basements under the house.

4. **REASONS FOR ISSUING THIS NOTICE**

- a) The work outlined above has been carried out to this Grade II listed building without the benefit of Listed Building Consent.
- b) The unauthorised excavation of additional basement accommodation under the house plus an external staircase, by reason of their size, footprint and location, are detrimental to the special architectural and historic interest of the building, contrary to policy CS14 of the London Borough of Camden Local Development Framework Core Strategy and policy DP25 of the London Borough of Camden Local Development Framework Development Policies.

5. **WHAT YOU ARE REQUIRED TO DO**

Within a period of **2 months** of the Notice taking effect:

- 1) the works to be carried out fully in accordance with the approved basement plan as granted under planning permission and listed building consent on 31.10.12 (refs 2012/4611/P & 2012/4615/L) (drawing no. 025/A/P/B1/D200); and
- 2) the extended basement area and the external staircase void to be infilled with earth and brick retaining walls.

6. **WHEN THIS NOTICE TAKES EFFECT**

This notice takes effect on **26 June 2014**, unless an appeal is made against it beforehand.

DATED: 15 May 2014

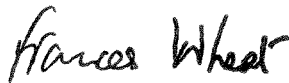

Signed.....

Head of service, Development Management, Culture and Environment on behalf of the London Borough of Camden, Town Hall, Judd Street, London WC1H 9LP

EXPLANATORY NOTE

YOUR RIGHT OF APPEAL

You can appeal against this notice, but any appeal must be received, or posted in time to be received, by the Secretary of State by **26 June 2014**.

- (a) Send a copy of your appeal to the Secretary of State if you decide to appeal, together with a copy of this enforcement notice.
- (b) Send a second copy of the appeal form and notice to the Council at:

**Planning Services
Culture and Environment Department
London Borough of Camden
Town Hall
Argyle Street
London WC1H 8EQ**

Alternatively you can submit an appeal online at <http://www.planningportal.gov.uk/planning/appeals/online/makeanappeal>. Please note that a separate appeal form must be completed for each individual person or organisation.

WHAT HAPPENS IF YOU DO NOT APPEAL

If you do not appeal against this listed building enforcement notice, it will take effect on **26 June 2014** and you must then ensure that the required steps for complying with it, for which you may be held responsible, are taken within the period specified in the notice. Failure to comply with a listed building enforcement notice, which has taken effect, can result in prosecution and/or remedial action by the Council.

THIS LISTED BUILDING ENFORCEMENT NOTICE HAS BEEN SERVED ON:

1.	The Owner/Occupier Wildwood Lodge 9 North End London NW3 7HH
2.	Allanton Limited 441 Edgware Road London W2 1TH
3.	Allanton Limited Swiss House, Beckenham Street Tolleshunt Manor Maldon Essex CM9 8LZ
4.	Investec Bank Plc 2 Gresham Street London EC2V 7QP

If you believe that there is someone else who should be served or any of those listed above has not received a copy of the notice or any other document please let that person and the Council know of this omission as soon as possible.

WILDWOOD LODGE, 9 NORTH END, LONDON
NW3 7HH

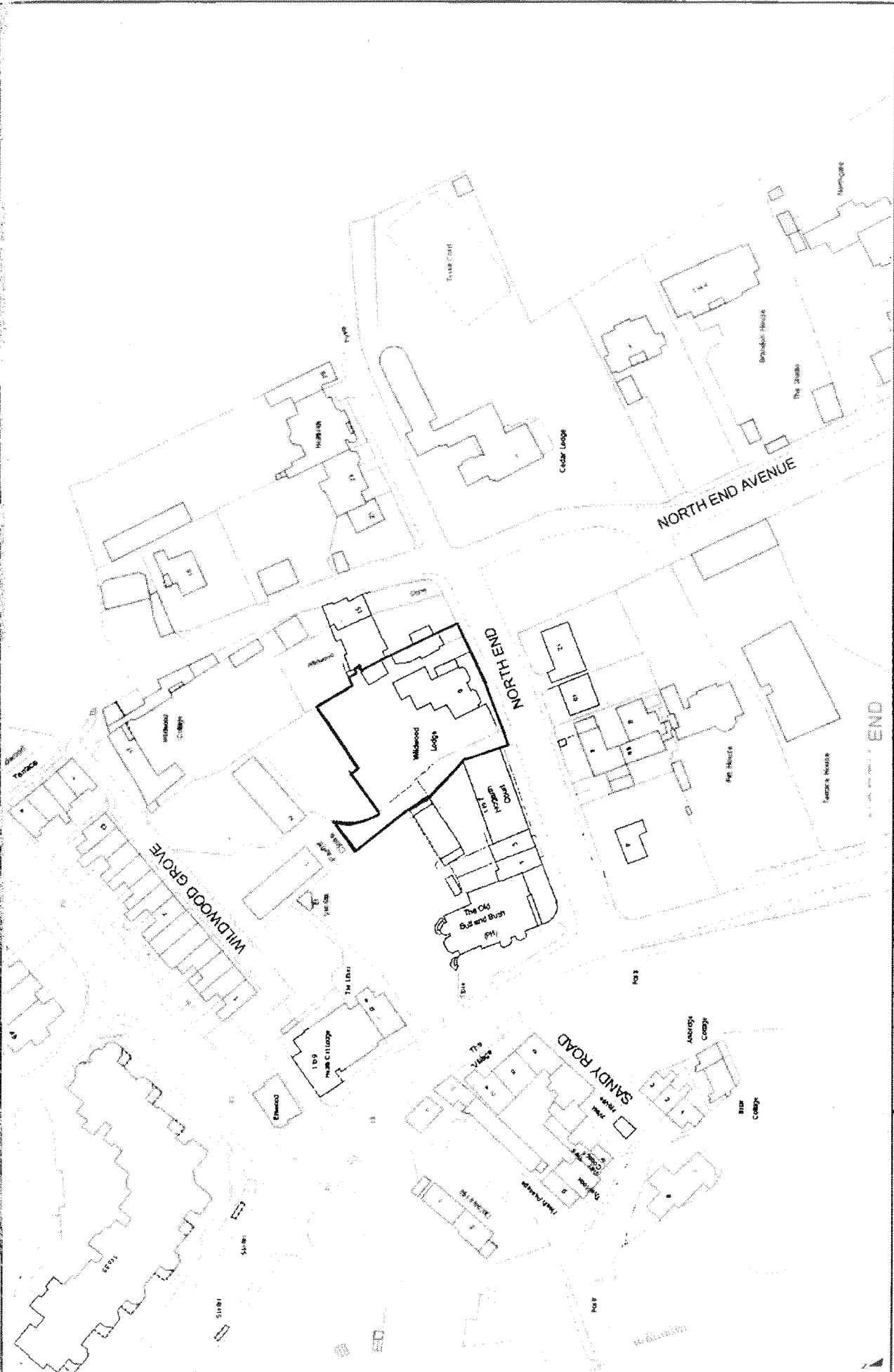

Date 17/02/2014

Scale 1/1250
Centre = 526115 E 186984 N

Reproduced by permission of Ordnance Survey on behalf of HMSO. © Crown copyright and database right 2014. Ordnance Survey Licence number 100019726.



Punjabi
ਜ਼ਰੂਰੀ: ਇਹ ਫਾਰਮ ਸਾਡੇ ਕੋਲ ਭੇਜਣ ਲਈ ਖਾਸ ਮਿਆਦ ਹੈ। ਇਸ ਮਿਆਦ ਦਾ ਸਮਾਂ ਪੂਰਾ ਹੋ ਜਾਣ ਤੋਂ ਪਹਿਲਾਂ ਇਹ ਫਾਰਮ ਸਾਡੇ ਕੋਲ ਲਾਜ਼ਮੀ ਤੌਰ ਤੇ ਪਹੁੰਚ ਜਾਣਾ ਚਾਹੀਦਾ ਹੈ। ਜੇ ਤੁਹਾਨੂੰ ਇਹ ਫਾਰਮ ਭਰਨ ਲਈ ਮਦਦ ਦੀ ਲੋੜ ਹੈ, ਤਾਂ ਅਸੀਂ ਤੁਹਾਨੂੰ ਸੁਝਾਉਂਦੇ ਹਾਂ ਕਿ ਤੁਸੀਂ ਇਹਦੇ ਬਾਰੇ ਕਿਸੇ ਤੋਂ ਸਲਾਹ ਲਓ।

Gujarati
મહત્વનું : અમને આ ફોર્મ મોકલવા માટે સમય મર્યાદા છે. આ સમય મર્યાદા પૂરી થાય તે પહેલાં અમને તે મળી જવું જ જોઈએ. જો તમને આ ફોર્મ ભરવા માટે મદદની જરૂર હોય તો અમે તમને સલાહ મેળવવાનું સૂચન કરીએ છીએ.

Hindi
आवश्यक : इस फॉर्म को हमारे पास भिजवाने की एक समय-सीमा है। उस समय-सीमा के चीतने से पहले हमें यह फॉर्म अवश्य मिल जाना चाहिए। यदि आपको इस फॉर्म को भरने में सहायता चाहिए, तो हमारा सुझाव है कि आप किसी की सलाह लें। -

Urdu
اہم: اس فارم کو ہمیں بھیجنے کے لئے وقت کی ایک مہیاد ہے۔ اس مہیاد کے گزرنے سے پہلے پہلے ہمیں یہ لازمی طور پر مل جانا چاہیے۔ اگر اس فارم کو بھرنے میں آپ کو مدد کی ضرورت ہے تو ہماری رائے ہے کہ آپ مشورہ حاصل کریں۔

Bengali
জরুরী: এই ফর্ম আমাদের কাছে পাঠানোর একটা সময়সীমা আছে। এই সময়সীমা শেষ হবার আগেই এটা অবশ্যই আমাদের কাছে পৌঁছাতে হবে। এই ফর্ম পূরণ করায় যদি আপনার সাশাযোর দরকার হয় তাহলে আমাদের পুস্তাব, কারো পরামর্শ লিন।

Chinese
重要通知: 把这份表格寄回给我们是有时间限制的。我们必须在规定时间内收到这份表格。假若你需要别人帮助你填写这份表格, 我们建议你寻求指导。

English
IMPORTANT: There is a time limit for sending this form to us. We must receive it before the time expires. If you need help filling in this form, we suggest you get advice.

