

No.17 Monmouth Street

Do not scale from this drawing, except for town planning purposes.
 Work to figured dimensions only.
 This drawing is the property of Brimelow McSweeney Architects and copyright is reserved by them.
 This drawing is issued on condition that it is not copied, used or disclosed by or to any unauthorised person without the prior written consent of Brimelow McSweeney Architects.
 The areas on the drawing have been measured directly from a CAD drawing and have no tolerances added or subtracted.
 The areas have been calculated in accordance with the Code of Measuring Practice, 6th Edition (2007) using the stated options N/A, G/A, GEA. They are approximate and relate to the likely areas of the building at the current state of the design. Any decisions to be made on the basis of these predictions, whether as to project viability, pre-letting, lease agreements and the like, should make allowance for the following:
 - Design development
 - Accurate site survey, site levels and dimensions need to be fully evaluated
 - Allowance for construction methods and building tolerances.
 - Local authority consents

rev	date	drawn by	chkd	description
/	05.12.13	DPF	SE	PLANNING ISSUE
A	28.01.14	DPF	SE	Opening to terrace amended to be within existing dormer openings, keep metal railings, Re-issued for planning
B	02.04.14	DPF	SE	Sliding folding doors amended to be full width of roof opening, Issued for planning minor amendment.

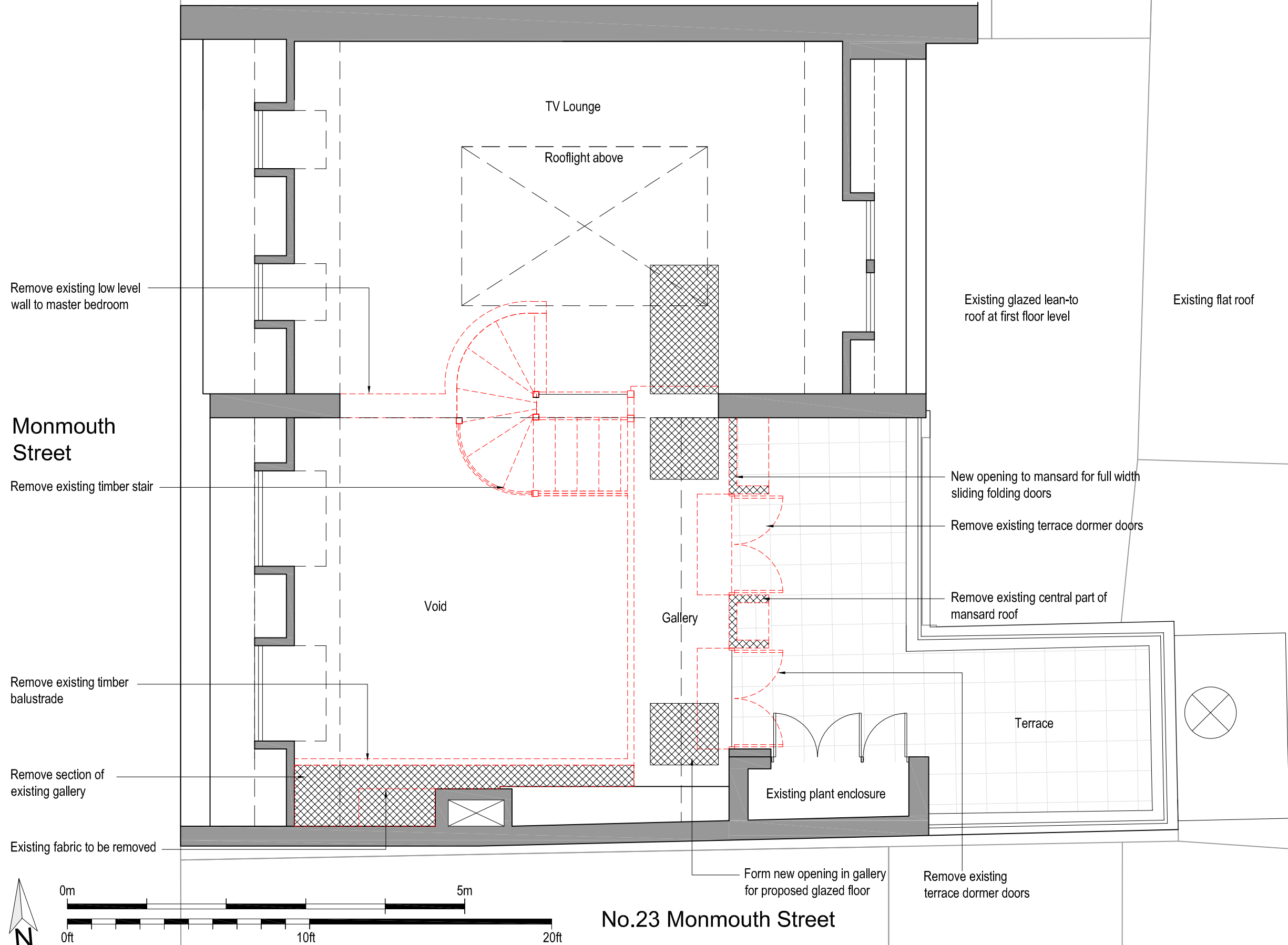

Demolition Key

- Fabric to be removed
- Formation of new opening
- Fabric to be reinstated

status **FOR PLANNING**

BRIMELOW McSWEENEY ARCHITECTS

28 Great Queen Street, Covent Garden, London WC2B 5SL
 tel: 020 7831 7835 - fax: 020 7831 7839 - email: admin@brim-architects.co.uk

project
 19-21 Monmouth Street
 WC2H 9DD

title
 Fourth Floor Plan
 Demolition

scale	date	drawn
1:50@A3	05-12-13	DPF

drawing no.	revision
1341-0901	B

Remove full width of rear part of mansard for installation of full width sliding folding doors.

Remove central element of dormer to create new opening for sliding folding doors

Remove existing dormer terrace doors



Note.
Floors below 2nd floor not within demise and not surveyed

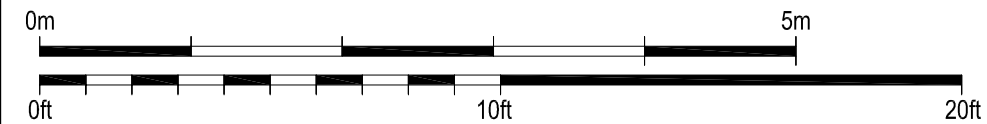

Do not scale from this drawing, except for town planning purposes.
Work to figured dimensions only.
This drawing is the property of Brimelow McSweeney Architects and copyright is reserved by them.
This drawing is issued on condition that it is not copied, used or disclosed by or to any unauthorised person without the prior written consent of Brimelow McSweeney Architects.
The areas on the drawing have been measured directly from a CAD drawing and have no tolerances added or subtracted.
The areas have been calculated in accordance with the Code of Measuring Practice, 6th Edition (2007) using the stated options N/A, GIA, GEA. They are approximate and relate to the likely areas of the building at the current state of the design. Any decisions to be made on the basis of these predictions, whether as to project viability, pre-letting, lease agreements and the like, should make allowance for the following:
- Design development
- Accurate site survey, site levels and dimensions need to be fully evaluated
- Allowance for construction methods and building tolerances.
- Local authority consents

rev	date	drawn by	checked	description
/	05.12.13	DPF	SE	PLANNING ISSUE
A	28.01.14	DPF	SE	Opening to terrace amended to be within existing dormer openings, keep metal railings. Re-issued for planning
B	02.04.14	DPF	SE	Sliding folding doors amended to be full width of roof opening, issued for planning minor amendment.

Demolition Key

- Fabric to be removed
- Formation of new opening
- Fabric to be reinstated

status **FOR PLANNING**

BRIMELOW McSWEENEY ARCHITECTS
28 Great Queen Street, Covent Garden, London WC2B 5SL
tel: 020 7631 7835 - fax: 020 7631 7830 - email: admin@brim-architects.co.uk



project
19-21 Monmouth Street
WC2H 9DD

site
Rear Elevation
Demolition

scale 1:50@A3 date 05-12-13 drawn DPF

drawing no. 1341-0904 revision B