

Existing Basement Plan

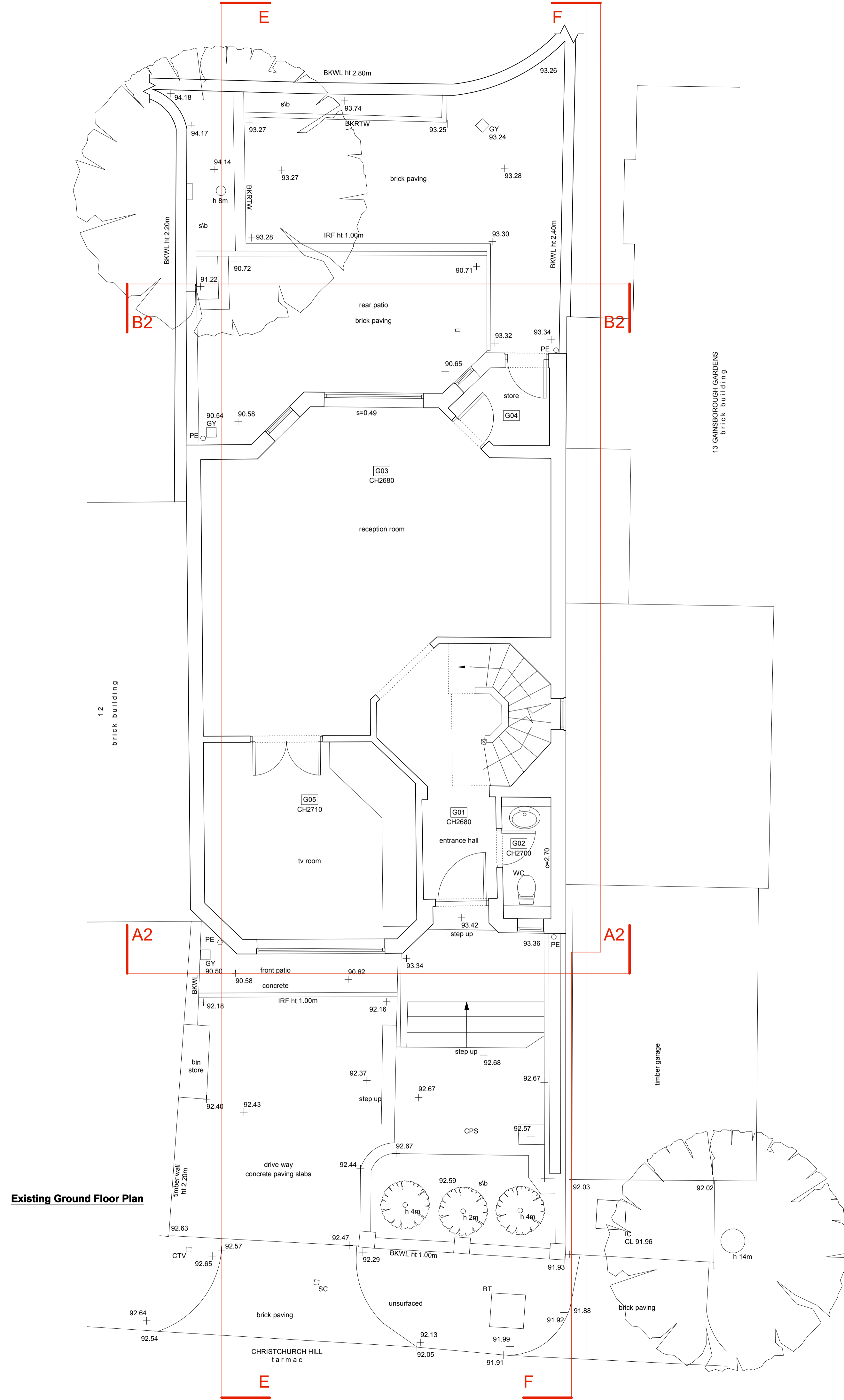

Existing Ground Floor Plan

NOTES:

- Do not scale from this drawing.
- The contractor to check all dimensions on site.
- All discrepancies to be reported to the contract administrator.

PROJECT:	Alteration & Extension 10 Christchurch Hill NW3 1LB	WORK STAGE:	Planning
CLIENT:	Mr Nadir Khamissa 10 Christchurch Hill London NW3 1LB	JOB No:	1208A
DRAWING TITLE:	Existing Basement & Ground Floor Plans	DATE:	09.04.14
		DRAWN BY:	AG
		CHECKED BY:	AP
		SCALE:	1:50@A1
		DRAWING No:	PL_E001
		REVISION No:	A
		Issue to:	CL

ashton porter
architects

11 second avenue
bush hill park
enfield
middlesex
en1 1bt
t: 020 8372 1619
f: 020 8372 1629

© ashton porter. All rights reserved.