

Proposed Ground Floor Plan

Scale 1:100

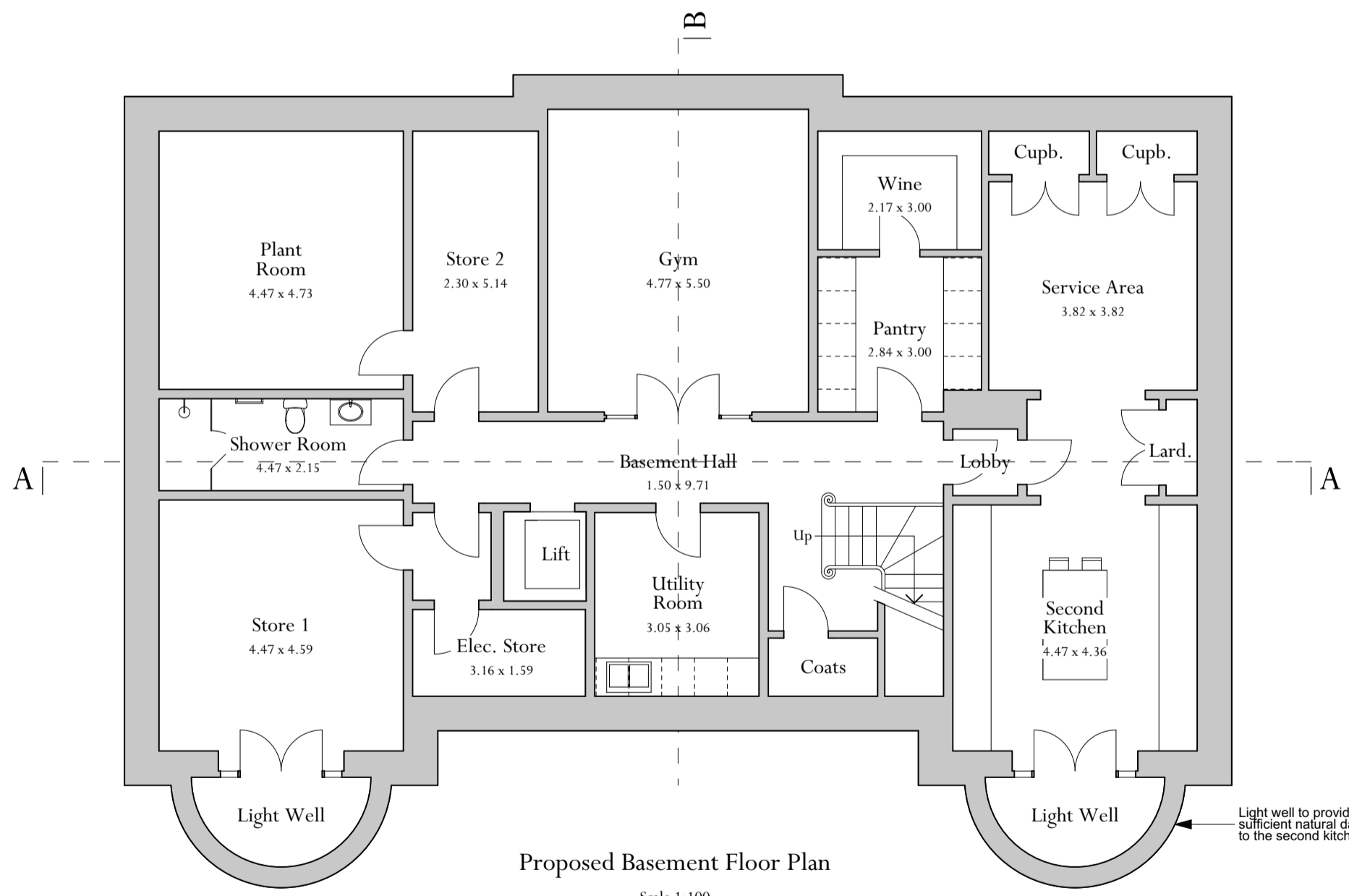

Proposed Basement Floor Plan

Scale 1:100

Light well to provide sufficient natural daylight to the second kitchen

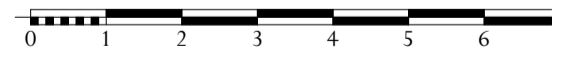

Scale 1:100

| Rev. | Date       | Description    | Initials |
|------|------------|----------------|----------|
| C    | 16.04.2014 | PLANNING ISSUE | WR       |

Adjacent Properties and Boundaries are shown for illustrative purposes only and have not been surveyed unless otherwise stated.  
 All areas shown are approximate and should be verified before forming the basis of a decision.  
 Do not scale other than for Planning Application purposes.  
 All dimensions must be checked by the contractor before commencing work on site.  
 No deviation from this drawing will be permitted without the prior written consent of the Architect.

The copyright of this drawing remains with the Architect and may not be reproduced in any form without prior written consent.  
 Ground Floor Slabs, Foundations, Sub-Structures, etc. All work below ground level is shown provisionally. Inspection of ground condition is essential prior to work commencing.  
 Reassessment is essential when the ground conditions are apparent, and redesign may be necessary in the light of soil conditions found. The responsibility for establishing the soil and sub-soil conditions rests with the contractor.

PROJECT: 18-20 Lancaster Grove  
 Belsize Park, London  
 TITLE: Proposed Floor Plans  
 1 of 2  
 SCALE: 1:100 @A3  
 DATE: March 2014  
 DRAWING No: 5754/PL/06 C  
 DRAWN BY: WR

ADAM ARCHITECTURE

OLD HYDE HOUSE, 75 HYDE STREET  
 WINCHESTER, HAMPSHIRE, SO23 7DW  
 TELEPHONE: 01962 843843 FACSIMILE: 01962 843303  
 www.adamarchitecture.com contact@adamarchitecture.com

LONDON OFFICE: 6 QUEEN SQUARE, WC1N 3AT  
 TELEPHONE: 020 7841 0140 FACSIMILE: 01962 843303  
 ADAM ARCHITECTURE IS A TRADING NAME OF ROBERT ADAM ARCHITECTS LIMITED