

01 SECTION A-A (VAULTS OMITTED)
As Existing with Demolitions

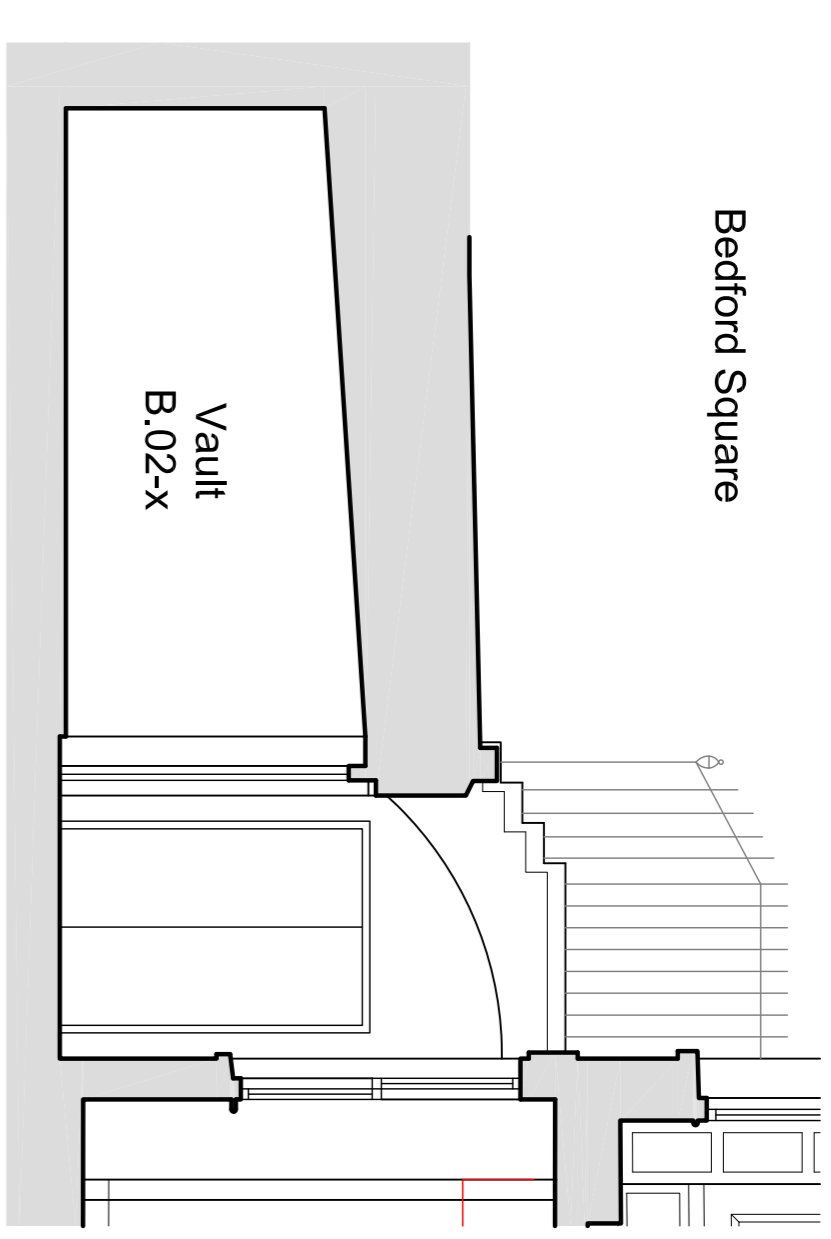

02 SECTION A-A VAULTS EXCERPT
As Existing with Demolitions

Bedford Square

Vault
B.02-x

- KEY**
- Existing Structure
 - Demolitions in Section
 - Demolitions in Elevation

GENERAL NOTES

Where existing partitions are removed adjacent surfaces are to be made good with finish to match existing

Existing cornices, skirting boards and dado rails are to be retained and any that are affected by the demolition works are to be made good to match adjacent existing.

New partitions are to be plasterboard on new timber stud work with skimcoat and paint finish

Access to existing beams for strengthening works is to be via the floorboards above

Where strengthening works to existing walls occurs, the ceiling below is to be made good and repaired to match existing. Refer to reflected ceiling plans for extents or repair works to ceilings.

All non-original boxing to redundant services removed.

REV	ISSUE DATE	REVISION NOTES
A	29.03.2014	Issued for Planning

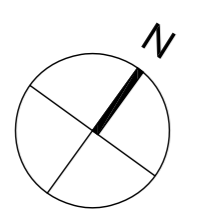

GENERAL NOTES

Do not scale. All window dimensions must be checked on site before work commences on site or in shop. Figure dimensions take preference over those scaled. Discrepancies, where identified, must be reported to the Architects immediately.

Any areas indicated on this drawing are for guidance purposes only. No responsibility is taken for their accuracy.

All work must be carried out in accordance with the Building Regulations and to the satisfaction of the local authority.

PLANNING

GARNETT + PARTNERS

architects / planners / designers

Garrett+Partners LLP
Holborn Hall
195 High Holborn
London WC1V 7BD
Tel: +44 (0)20 7604 7577
Fax: +44 (0)20 7604 6648
mail@garnettpartners.com
www.garnettpartners.com

CLIENT
The Bedford Estate

PROJECT
No. 18 Bedford Square
WC1

DRAWING TITLE
Section A-A
As Existing with Demolitions

SCALE
1:500 @ A1 (1:100 @ A3)

DATE
March 2014

792 (PL)300 A