

NO.	DESCRIPTION	DATE
10	Issue of Lobby Update	22 Aug 2011
9	Issue of Shopfront Update	22 Aug 2011
8	Issue of Program Issues	02 Mar 2011
7	Construction of Sub-structure	13 Jan 2011
6	Construction of Shopfront	02 Mar 2011
5	Issue of Shopfront & Shopfront Shop Front	02 Mar 2011
4	Issue of Shopfront & Shopfront Shop Front	02 Mar 2011
3	Issue of Shopfront & Shopfront Shop Front	02 Mar 2011
2	Issue of Shopfront & Shopfront Shop Front	02 Mar 2011
1	Issue of Shopfront & Shopfront Shop Front	02 Mar 2011

FOR CONSTRUCTION

Dimensions must be reported immediately to the Architect if they are found to be incorrect. Contractors must check all dimensions on site. The drawing is protected by copyright.
ALL DIMENSIONS ARE SHOWN IN METRIC.

CONSULTANTS
 Design Architect
 Adamson Architects International Limited
 111 Market Street
 Level 11, Singapore
 Tel: +65 6339 8888
 Fax: +65 6339 8889
 Email: info@adamson.com.sg

CLIENT
 Kings Cross Central B1
 111 Market Street
 Level 11, Singapore
 Tel: +65 6339 8888
 Fax: +65 6339 8889
 Email: info@adamson.com.sg

ADAMSON ARCHITECTS INTERNATIONAL LIMITED
 111 Market Street
 Level 11, Singapore
 Tel: +65 6339 8888
 Fax: +65 6339 8889
 Email: info@adamson.com.sg

GENERAL ARRANGEMENT PLAN UPPER GROUND LEVEL

FRL + 20.950
 DRAWN: Adair
 CHECKED: FHB
 SCALE @ A0: 1:100
 DATE: 23 JAN 2011
 PROJECT NO.: 1050-00
 DRAWING NO.: A1000

LOCATION:	B1
REVISION:	10

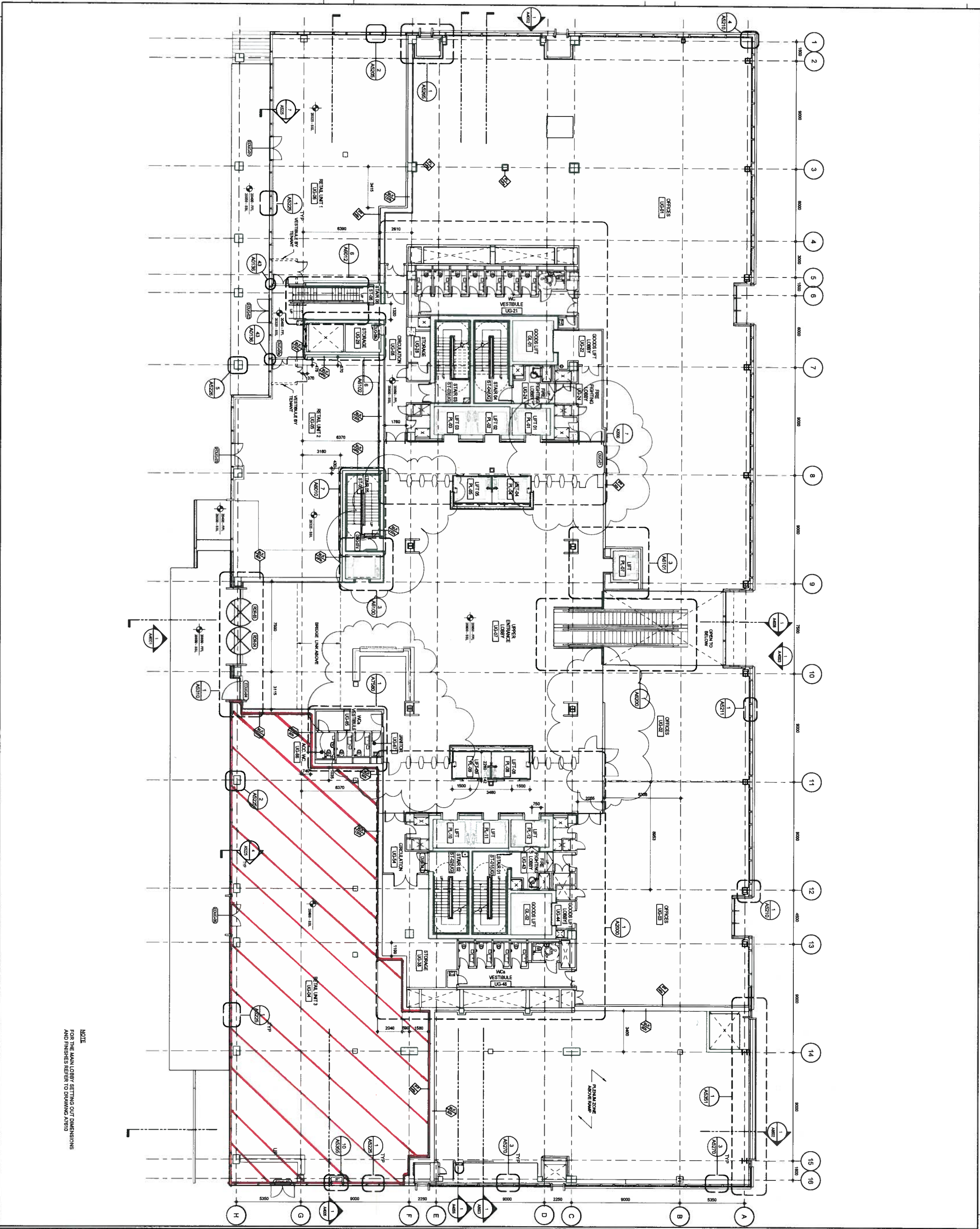

NOTE
 FOR THE MAIN LOBBY SETTING OUT DIMENSIONS AND FINISHES REFER TO DRAWING A7B10