

OUTSIDE ELEVATIONS

FIXING PROCEDURE FOR W20 WINDOWS:

2. WINDOW FRAMES SHOULD BE REMOVED FROM THEIR CRATES AND CHECKED OFF AGAINST THE PACKING OR PARTS LIST BEFORE THEY ARE CAREFULLY STACKED ON WOODEN BATONS WITH PACKING SUCH AS CARDBOARD BETWEEN FRAMES. IF THE FRAMES ARE NOT TO BE STORED UNDER COVER THEY SHOULD BE COVERED WITH WATERPROOF SHEETING.
3. SOME ANCILLARY COMPONENTS, SUCH AS DOOR HANDLES AND FIXINGS ETC ARE PACKED IN POLYTHENE BAGS OR CARDBOARD BOXES. CRATES SHOULD BE CHECKED TO ENSURE EVERYTHING HAS BEEN REMOVED BEFORE DISPOSAL.
3. BEFORE COMMENCING INSTALLATION, OPENINGS SHOULD BE CHECKED TO ENSURE THEY ARE THE CORRECT SIZE. ANY COUPLED ASSEMBLIES SHOULD BE SET OUT, CHECKED FOR SQUARENESS & OPERATION AND THAT THE FITTINGS OPERATE CORRECTLY.
4. WHERE PRESSED METAL ITEMS ARE SPECIFIED, THESE MUST BE CENTRALISED IN THE OPENING AND CHECKED FOR LINE AND LEVEL BEFORE FIXING.
5. WHEN FIXING COUPLED ASSEMBLIES, MULLION BAR POSITIONS MUST BE SET OUT PRIOR TO THE INSTALLATION OF THE WINDOW FRAMES. THIS ENSURES ANY VARIATION BETWEEN WINDOW UNIT SIZE AND THE OPENING SIZE IS EQUALISED. POSITION MULLIONS ENSURING THEY ARE PLUMB IN BOTH PLANES.
6. APPLY UNIVERSAL BEDDING COMPOUND TO THE PERIMETER OF FRAMES AND TO THE COUPLING BARS—ALTERNATIVELY, IF NO BEDDING COMPOUND IS SPECIFIED ENSURE ALL PERIMETER HOLES IN THE FRAME ARE SEALED WITH SILICONE, WITH PARTICULAR REGARD TO FIXED LIGHTS & THE HEAD BARS OF SASH FRAMES. NYLON WASHERS ARE USED AT THE SILL FIXINGS OF OPENING VENTS. ALSO ENSURE GLAZING BARS ARE SEALED AT FENESTRA JOINTS AND AT THEIR JUNCTION WITH THE FRAME PERIMETER. SEE DETAILS FOR SPECIFIC REQUIREMENTS.
- INSERT WINDOWS BETWEEN STRUCTURE AND MULLIONS, ENSURING HOLES IN THE WINDOW FRAME ALIGN WITH THOSE IN THE MULLION (WHERE APPLICABLE). SHIM TIGHT. CHECK FRAMES ARE POSITIONED FOR LINE LEVEL & PLUMB BEFORE BOLTING FRAMES AND MULLIONS LOOSELY TOGETHER. SECURE FRAMES TO STRUCTURE – BEFORE FULLY TIGHTENING SCREWS, MAKE FINAL CHECK FOR LINE LEVEL & PLUMB.
7. 'HOLE IN THE WALL' WINDOWS SHOULD BE CENTRALISED IN THE OPENING. SHIM AS REQUIRED TO ENSURE WINDOW IS PLUMB, LEVEL AND SQUARE AND SECURED TO THE STRUCTURE. EMBEDMENT OF SCREWS MUST BE A MINIMUM OF 25mm.
- DIFFERENT FIXINGS ARE USED FOR DIFFERING STRUCTURAL MATERIALS – WOODSCREWS INTO TIMBER, PLUGS AND WOODSCREWS INTO MASONRY/BRICKWORK, SELF TAPPING SCREWS INTO PRESSINGS AND MACHINE SCREWS INTO SOLID METAL. REFER TO INDIVIDUAL FIXING DETAILS FOR PRECISE SCREW REQUIREMENTS.
- TO ENSURE THE PRODUCT CONFORMS TO THE STRUCTURAL REQUIREMENTS OF THE SPECIFICATION, SHIM THICKNESS SHOULD NOT EXCEED 1.5 x FIXING DIAMETER. WHERE GAPS ARE IN EXCESS OF THIS, SOLID BLOCKING MUST BE USED.
8. WHERE GLAZING BARS OCCUR IN ADJACENT FRAMES IT IS ESSENTIAL THAT THESE ARE CHECKED TO ENSURE THEY LINE THROUGH.
9. PRIOR TO GLAZING, MAKE SURE THAT THE GLASS IS SQUARE AND FITS PROPERLY. ENSURE ALL SWarf AND DIRT IS REMOVED FROM THE GLAZING AREA BY WIPING WITH A CLEAN RAG. NOTE THAT GLAZING BEADS ARE ATTACHED TO THEIR PARTICULAR PANE AND ARE NOT INTERCHANGEABLE.
10. REFER TO GLAZING DETAIL AT RIGHT. APPLY GLAZING TAPE TO HEAD AND SILL FIRST, TAPE AT JAMBS SHOULD BUTT BETWEEN. SEAL JOINT WITH COMPATIBLE SEALANT. ALL GLASS SHOULD BE BLOCKED IN ACCORDANCE WITH BS6262 – SEE ILLUSTRATION. POSITION GLASS CENTRALLY IN FRAME AND PRESS FIRMLY ONTO THE GLAZING TAPE. IT IS ESSENTIAL TO 'TOE AND HEEL' ALL SIDE HINGED WINDOWS AND DOORS. APPLY STUDS FOR SNAP-ON BEADS.
11. APPLY HEAD AND SILL BEADS, ENSURING THEY ARE CENTRALISED IN THE REBATE. SHORT LENGTHS OF VISION STRIP CAN BE USED TO LOCK IN POSITION UNTIL CONTINUOUS LENGTHS ARE INSERTED. APPLY JAMB BEADS, CENTRALISING BETWEEN HORIZONTALS. ANY GAPS AT THE CORNERS SHOULD BE EQUALISED AROUND THE FRAME, WITH THE MAXIMUM ALLOWABLE GAP SPECIFIED IN BS 6510:2005 OF 3mm.
12. IF SPECIFIED IN THE RELEVANT GLAZING DETAIL, APPLY VISION STRIP – IF TIGHT, COAT IN SOAPY WATER.
13. IF SPECIFIED ON THE RELEVANT GLAZING DETAIL, APPLY SILICONE CAPPING.
14. PERIMETER AND COUPLING POINTING CAN NOW BE CARRIED OUT. CLEAN AREAS TO BE SEALED FIRST AND APPLY PRIMER WHERE NECESSARY – CONSULT SEALANT MANUFACTURER.
15. LOOSE FITTINGS, IE DOOR HANDLES, WEATHERBARS ETC. CAN NOW BE FITTED.
16. REMOVE LABELS FROM GLASS AND CLEAN DOWN.

IMPORTANT:

THESE DRAWINGS COVER ONLY THE WORK IN CRITTALL WINDOWS LIMITED CONTRACT. WE DO NOT ASSUME OR ACCEPT ANY RESPONSIBILITY FOR MEASUREMENTS AFFECTING THE WORK OF OTHER CONTRACTORS.

DETAILS OF MASONRY, STRUCTURAL STEEL AND OTHER MATERIALS RELATED TO OUR WORK BUT NOT FURNISHED BY CRITTALL WINDOWS LIMITED HAVE BEEN INDICATED ON OUR SHOP DRAWINGS TO THE BEST OF OUR ABILITY AND REFLECT OUR INTERPRETATION OF THE ARCHITECTURAL DRAWINGS AND OUR CONTRACT REQUIREMENTS.

TO ENSURE PROPER FITTING AND COORDINATION OF OUR WORK WITH OTHER TRADES, THESE DRAWINGS MUST BE CHECKED BY THE CONTRACTOR AND/OR ARCHITECT AGAINST INFORMATION PROVIDED BY SUPPLIERS OF OTHER MATERIALS THAT RELATE TO OUR WORK, BUT WHICH ARE NOT FURNISHED BY CRITTALL WINDOWS LIMITED.

DO NOT SCALE

SPECIFICATION FOR W20 PROFILE:

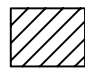
SECTION	W30 RANGE, 'GENUINE' FENESTRA TEE BARS SIDE HUNG OPEN OUT. SIDE HUNG OPEN IN. TOP HUNG OPEN OUT. SINGLE DOOR OPEN OUT/IN. DOUBLE DOOR OPEN OUT/IN. FIXED LIGHT AS SHOWN.
FINISH	- HOT-DIP GALVANISED STEEL PPC RAL COLOUR: RAL 9911 (CRITTALL WHITE) MATT
GLASS/GLAZING	- TO BE INTERNALLY SITE GLAZED WITH: W20 - 'WET GLAZED' SYSTEM & ALUMINIUM CLIP-ON BEAD TO SUIT 16mm.
	DOUBLE GLAZED UNITS: OUTER - 4 mm CLEAR FLOAT CAVITY - 8 mm KRYPTON CAVITY WITH BLACK SPACER BAR INNER - 4 mm SOFT COAT LOW 'E' OUTER - 4 mm CLEAR FLOAT TOUGHENED CAVITY - 8 mm KRYPTON CAVITY WITH BLACK SPACER BAR INNER - 4 mm CLEAR TOUGHENED SOFT COAT LOW 'E'
TI	CLIP ON BEADS & STEEL STUDS WITH INTUMESCENT/RETARDANT GLAZING MATERIALS TO SUIT 16 mm DOUBLE GLAZED UNITS: OUTER - 6 mm 30/0 PYROCELT *(INTEGRITY ONLY)* CAVITY - 6 mm XENON FILLED CAVITY & BLACK STEEL SPACER BAR INNER - 4 mm CLEAR TOUGHENED SOFT COAT LOW 'E' (CENTRE PANE 'U' VALUE 1.2W/m²/K).
	 PRESSED METAL PANELS MANUFACTURED FROM 2 mm THICK SHEET METAL PPC COLOUR: RAL 9911 (CRITTALL WHITE) MATT.
FITTINGS	- SIDE HUNG OPEN OUT - HUNG ON WELD ON NON-PROJECTING HINGES 'SWF' RANGE 'ROTO TONED' SWF B158F NON-LOCKING HANDLE HANDLE/S STRIKE (NATURAL BRASS) FINISH 'SWF' RANGE 'ROTO TONED' SWF B59 SLIDING STAY. SIDE HUNG OPEN IN - HUNG ON WELD ON NON-PROJECTING HINGES 'SWF' RANGE 'ROTO TONED' SWF B158F NON-LOCKING HANDLE HANDLE/S HOOK PLATE (RTD) FINISH FRICTION TOP ARM. TOP HUNG OPEN OUT - HUNG ON WELD ON NON-PROJECTING HINGES 'SWF' RANGE 'ROTO TONED' SINGLE FOLDING OPENER. NOTE: 'SWF' RANGE 'ROTO TONED' SWF B375 PEGSTAY (WHERE SPECIFIED ON ELEVATION DRAWING F5&F6) SINGLE DOOR, OPEN OUT/IN - HUNG ON WELD ON SELF ALIGNING HINGES (WHERE SPECIFIED ON ELEVATIONS 4 HINGES, 2ND OFFSET) 'FRANK ALLART' (FS 5255) LEVER HANDLES IN IBUL FINISH MORTICE LOCK WITH EURO PROFILE CYLINDER FRICTION TOP ARM DOUBLE THUMB TURN DOUBLE DOOR, OPEN OUT/IN - HUNG ON WELD ON SELF ALIGNING HINGES 'FRANK ALLART' (FS 5255) LEVER HANDLES IN IBUL FINISH MORTICE LOCK WITH EURO PROFILE CYLINDER FRICTION TOP ARM TO EACH LEAF CONCEALED BOLTS TO HEAD AND CILL (RTD) FINISH DOUBLE THUMB TURN DOUBLE DOOR - OPEN OUT (ITEM 16, TYPE M) HUNG ON WELD ON SELF ALIGNING HINGES EXIDOR 200 SERIES (285A) PANIC BOLT EXIT FURNITURE INTERNALLY.
FIXING	- SUPPLY, FIX & GLAZE BY CRITTALL WINDOWS.
DESIGN LOAD	- 1200 Pa
POINTING (& COLOUR)	- FOR BRICKWORK USE ADSEAD RATCLIFFE ARBOSIL 1096 (COLOUR TBC) FOR STONEMWORK USE ADSEAD RATCLIFFE ARBOSIL XL 1099 (COLOUR TBC) ADSEAD RATCLIFFE 2650 PRIMER (TO STONE IF APPLICABLE). FOR FIRE RATED USE ADSEAD RATCLIFFE ARBOSIL 1070 (COLOUR TBC)
FINISHES	- BY MAIN CONTRACTOR (JASPAR MANAGEMENT LTD).

NOTE: FOLDING OPENER/S REQUIRE POLE & HOOK TOTAL 32 REQD AT 750 mm.

RECOMMENDED POSITIONS OF SETTING & LOCATION BLOCKS FOR THE SITE GLAZING OF SOME TYPES OF SURROUNDS

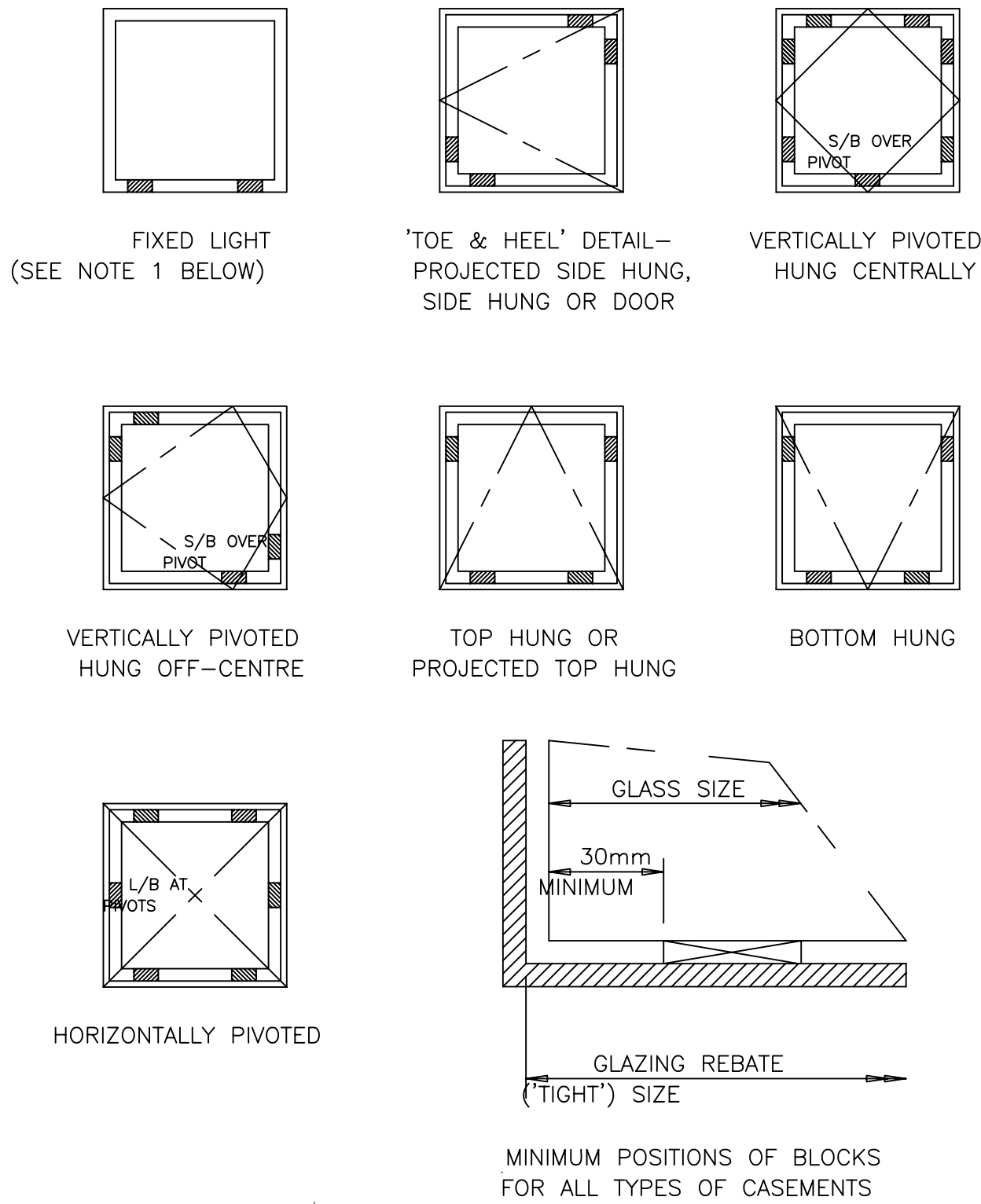

NOTE 1. SETTING BLOCKS FOR FIXED LIGHTS SHOULD PREFERABLY BE AT THE QUARTER POINTS, BUT CAN BE POSITIONED AS SHOWN ABOVE IF NECESSARY.

NOTE 2. FOR DESIGNS WHERE THE ACTUAL POSITIONS ARE CRITICAL, BLOCK POSITIONS WILL BE STATED ON THE RELEVANT DRAWINGS.

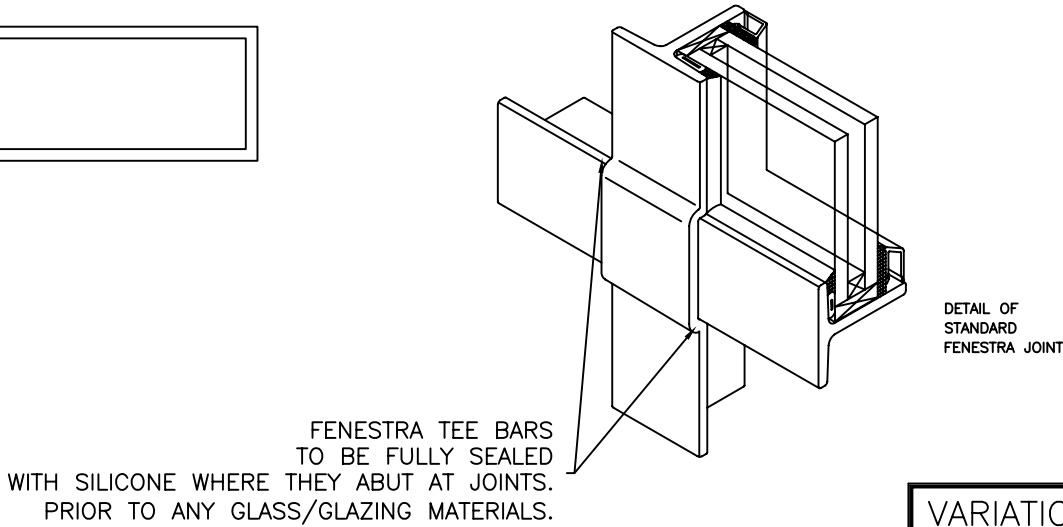
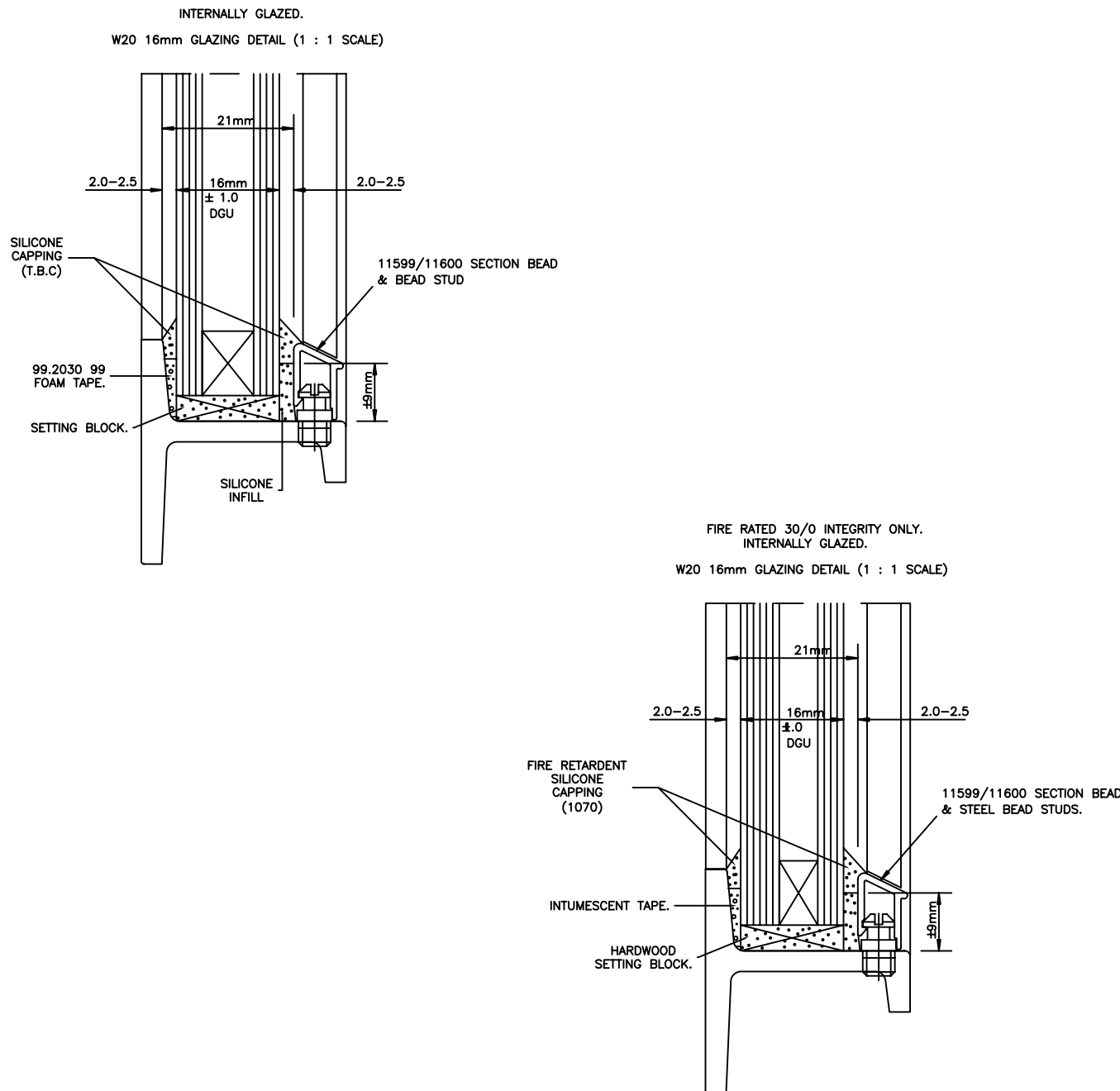

VARIATIONS TO CONTRACT

Final approval of this drawing by the specifier will be deemed to accept payment liability for any time and/or cost variation in accordance with the contract

'BI-METALLIC CORROSION'

The content of this design has taken into consideration bi-metallic corrosion (Galvanic action) effects for the materials used therein and by following the advice given in PD 6484 : 1979 published by B.S.I.







SPECIFICATION

* DETAILER'S SIGNATURE AUTHORISES RELEASE FOR PRODUCTION/INSTALLATION *		
Rev	REVISIONS TO ESTIMATE	Date
1	POLE AND HOOK REQUIREMENTS (SEE SPECIFICATION) FOOTNOTE.	04.03.14
C	'U' VALUE NOTED TO GLASS SPEC.	18.03.14
B	RAL COLOUR (9911 MATT) CONFIRMED.	12.03.14
A	TOP HUNG/OPEN OUT SPEC AMENDED.	04.03.14
Rev	REVISIONS TO DRAWING	Date

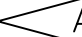
TOLERANCES.

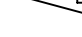
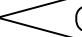
OUR PRICES ARE BASED ON OPENINGS FOR WINDOWS
BEING SUFFICIENTLY ACCURATE IN SIZE, POSITION
SQUARENESS AND STRAIGHTNESS TO ENABLE WINDOWS
TO BE FIXED WITH A MAXIMUM 6mm CLEARANCE BETWEEN
WINDOWS, FIXING BRACKETS AND BUILDERS WORK

LEGEND ON SPECIAL DETAILS

	External pointing by CRITTALL/others
	_____ plugs by CRITTALL
	Holes by General Contractor/CRITTALL.
	Polyurethane foam infill by CRITTALL
	Polyurethane foam/waterproof cement infill NOT WITHIN CRITTALL SCOPE OF WORKS
	Brickwork etc. to be flush pointed 12mm. (1/2") forward of external face of windows
	Detail Number
	Drawing Number



Job Title									
HAINES HOUSE									
Drawing Title									
SPECIFICATIONS									
Contractor		JASPAR MANAGEMENT LTD 15-19 CHURCH ROAD STANMORE, MIDDLESEX							
Architect		N/A							
Reason For Issue									
ISSUE FOR APPROVAL.									
DRAWN		B. SIDHU		DATE		JAN 2014			
Examined by				SCALES		N.T.S. @ A1			
EST./CONTRACT/DRWG.Nº				Sht.Nº		ITEMS			
9227G2B				S1					
Latest Amendment as Last Letter		A	B	C					
Detail DO issue No.									
Detailed by				Date			Dist.		
Finish				Fix Region					

OUTSIDE ELEVATIONS

DO NOT SCALE

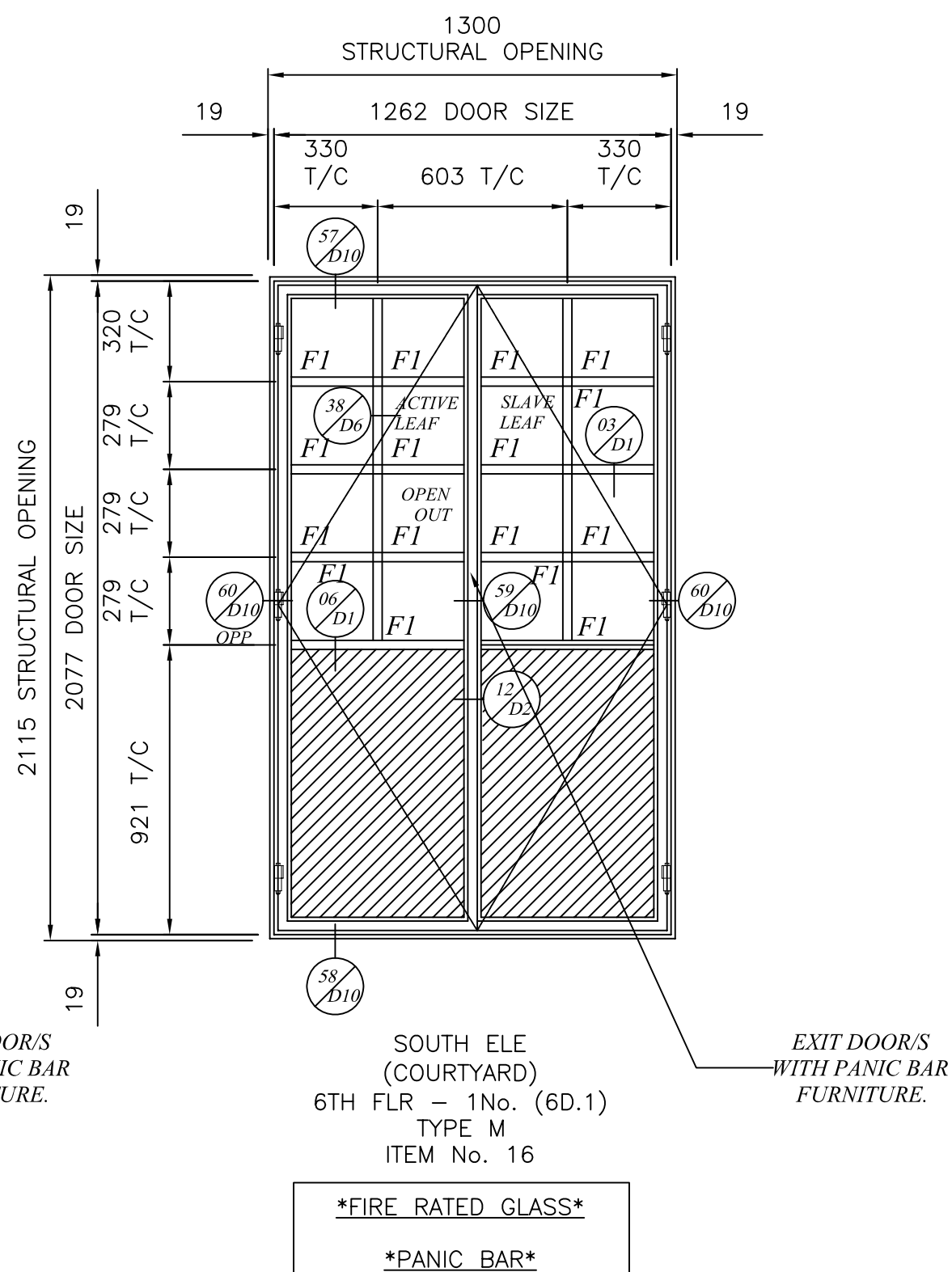
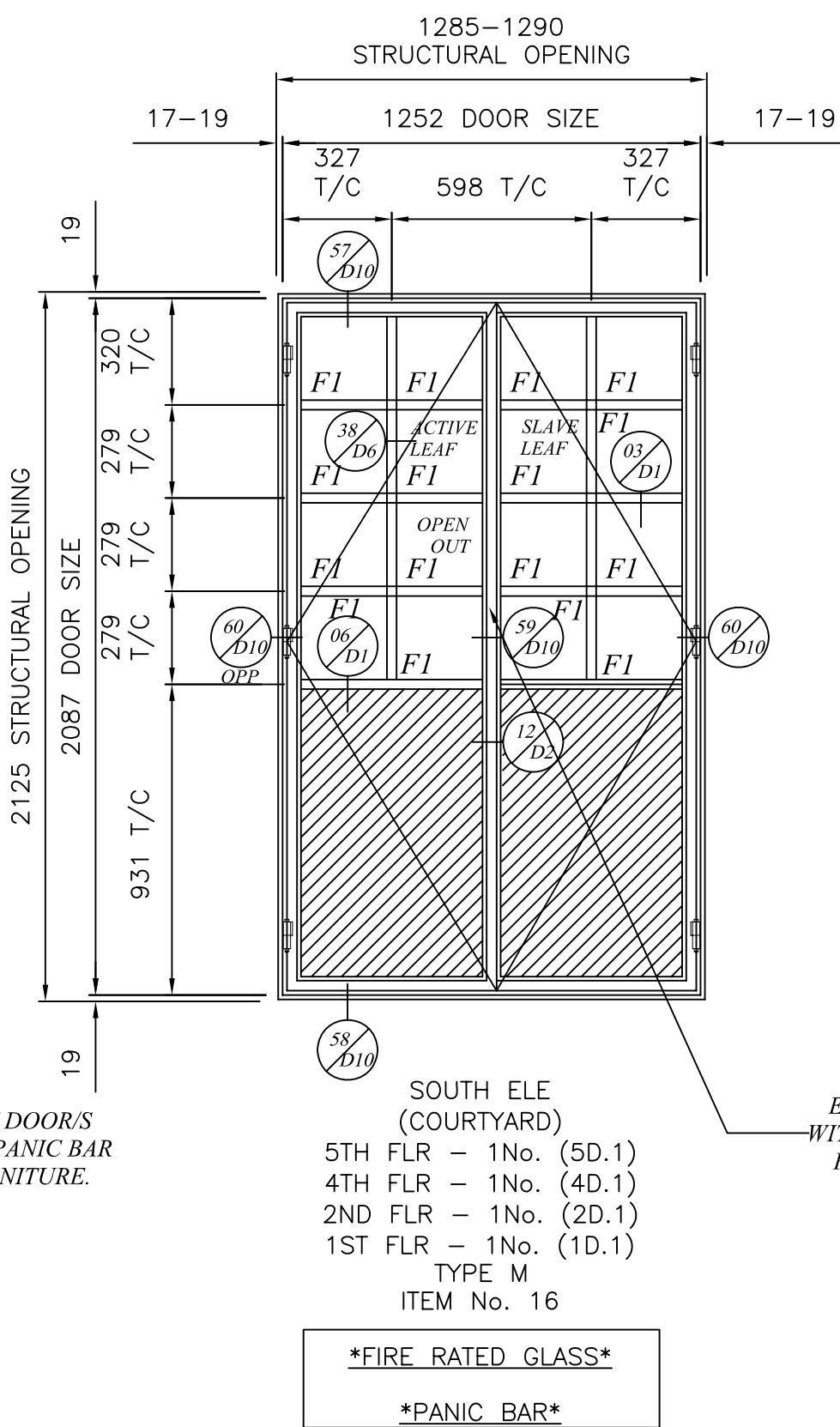
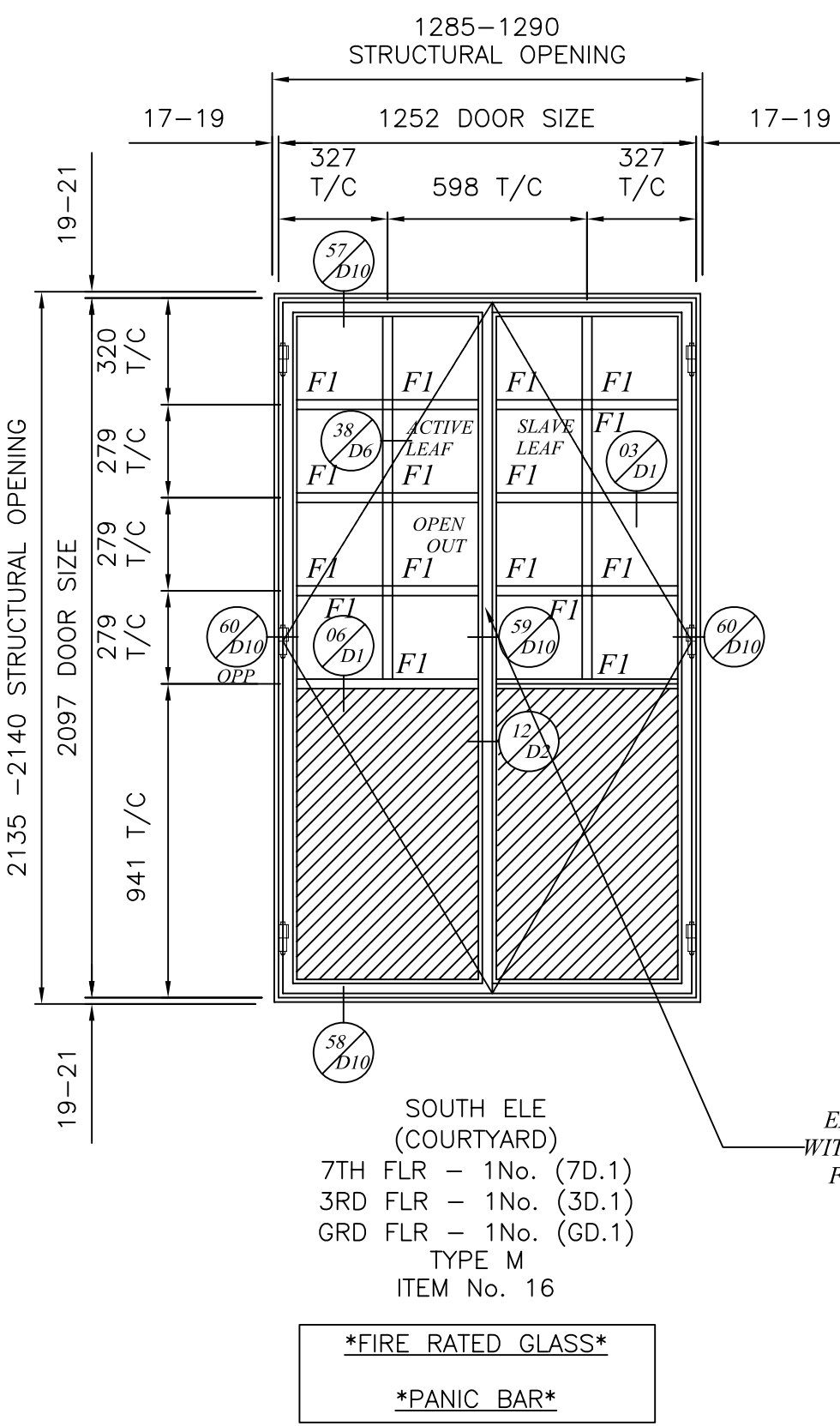
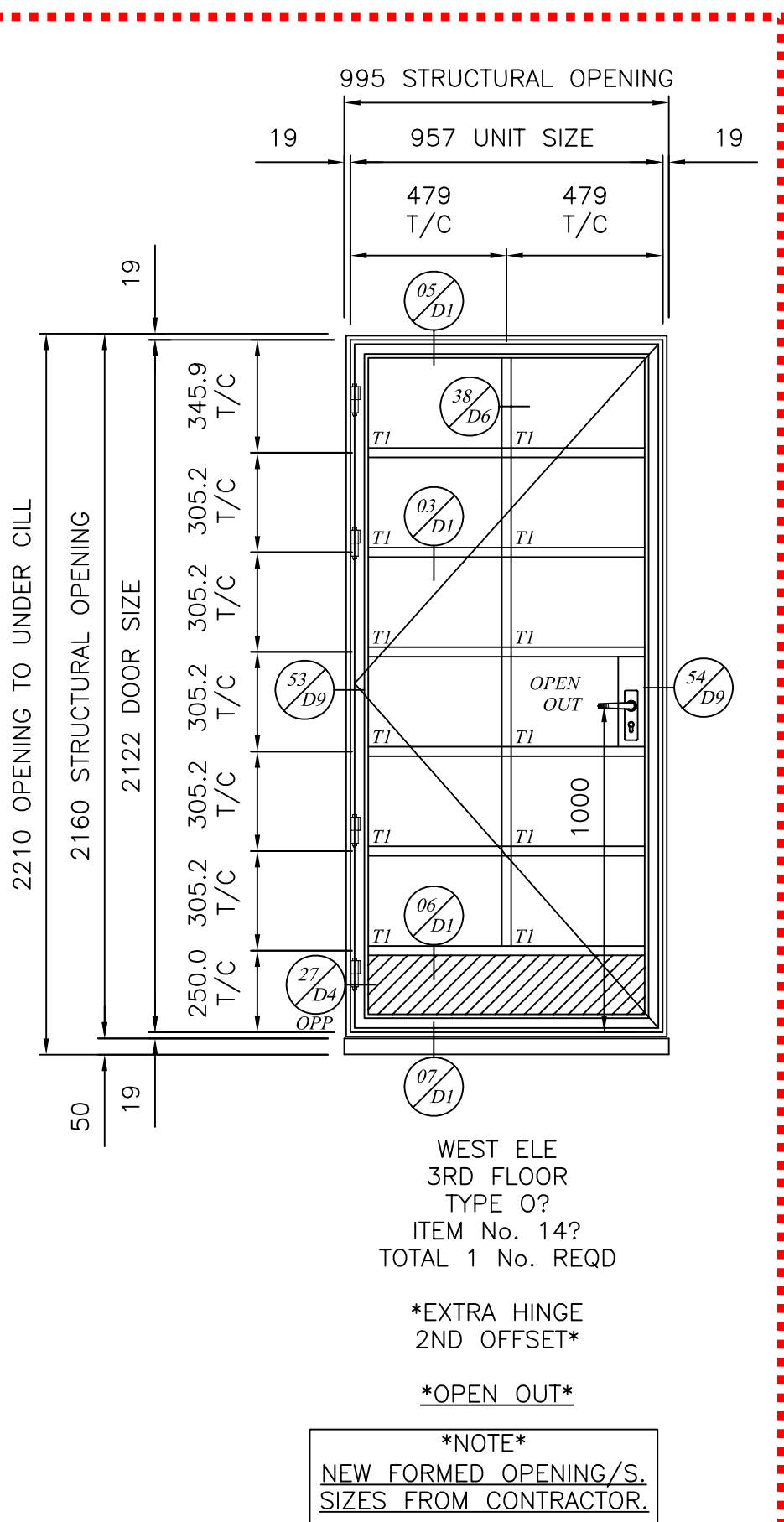
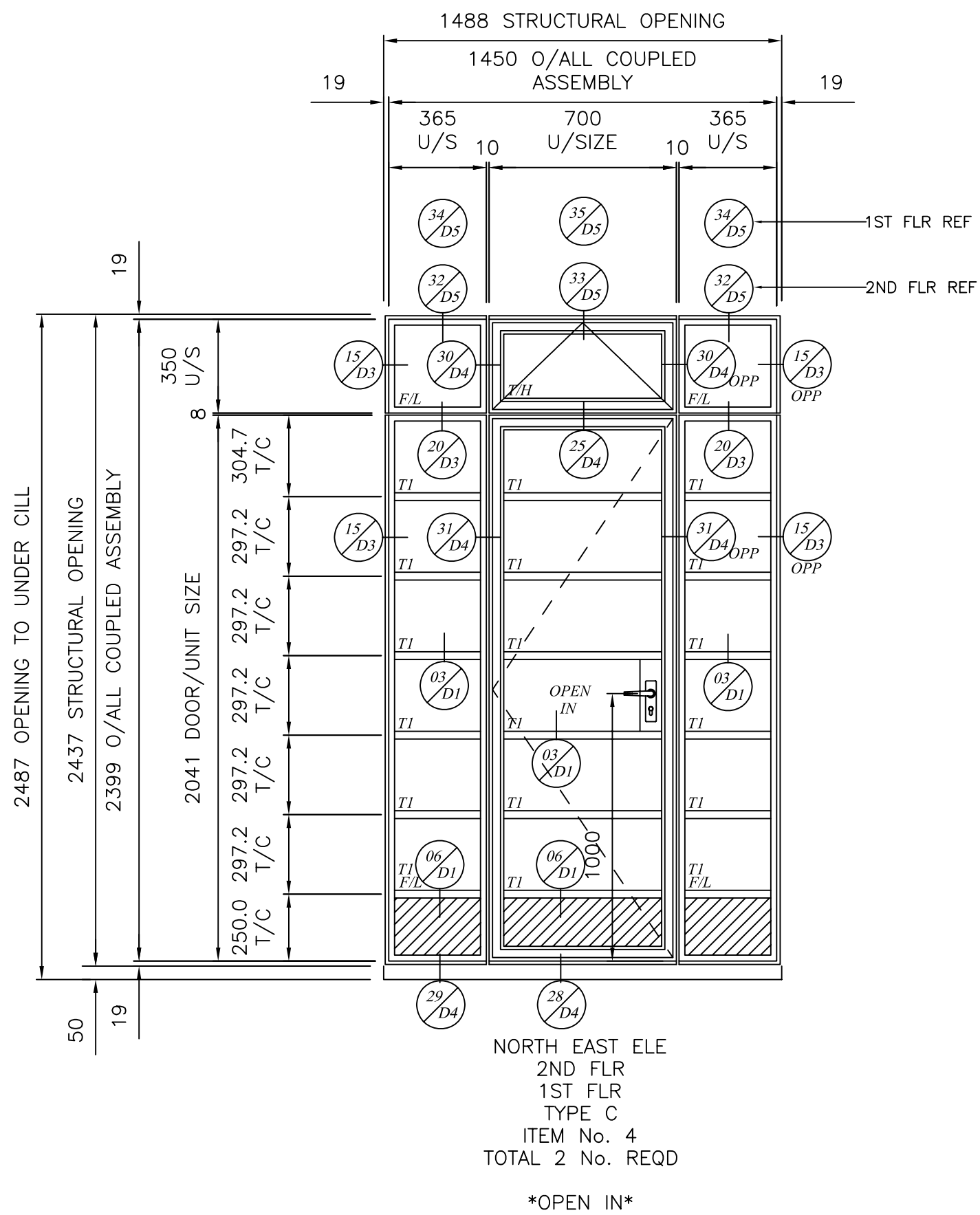
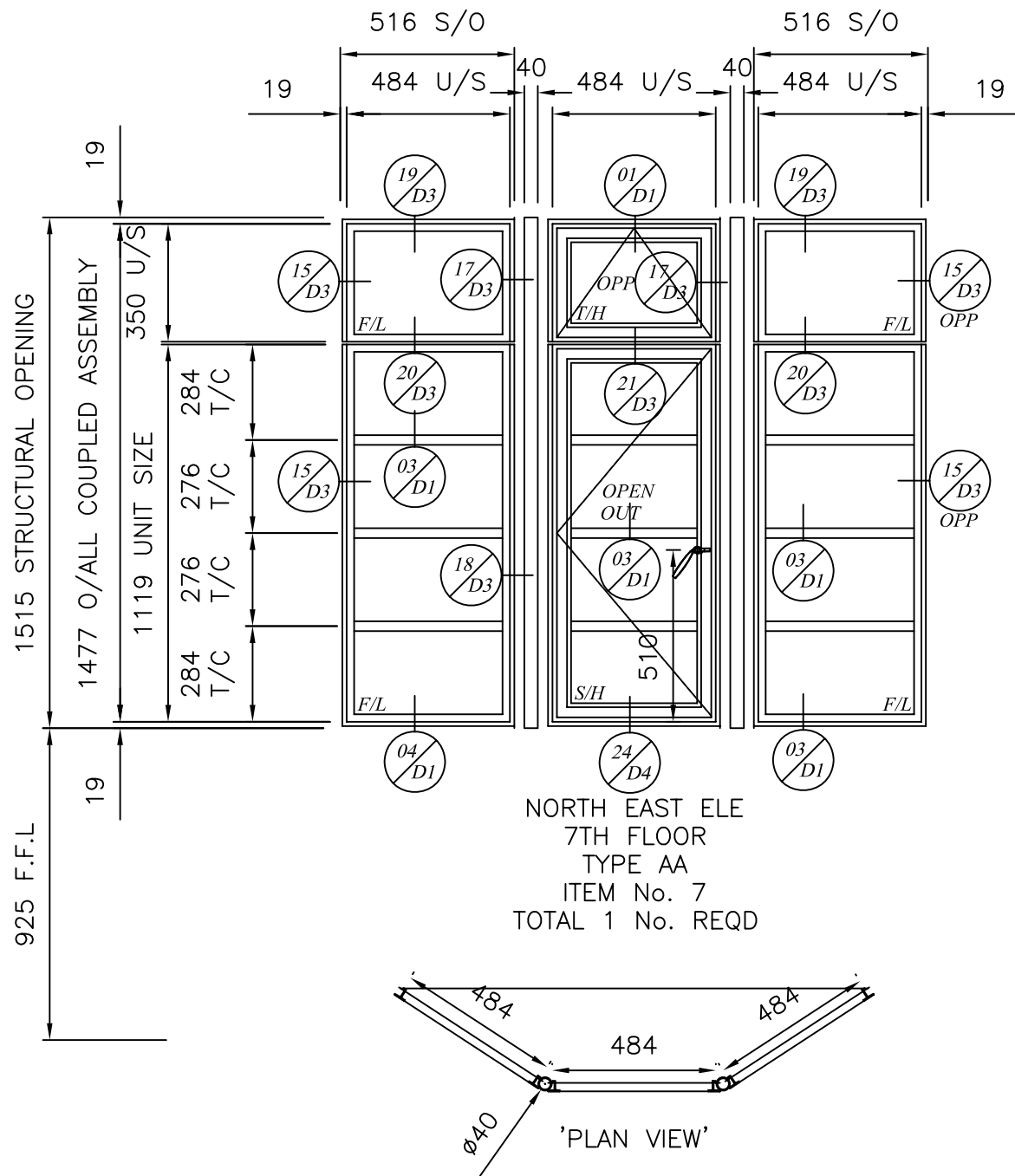

SPECIFICATION

* DETAILER'S SIGNATURE AUTHORIZES RELEASE FOR PRODUCTION/INSTALLATION

Rev	REVISIONS TO ESTIMATE	Date
-----	-----------------------	------





B	SOUTH ELE COURTYARD, (EXIT DOORS) LOCK HOUSING REMOVED.	08.04.14
A	TYPE M DOORS SIZES REVISED.	21.02.14

Rev	REVISIONS TO DRAWING	Date
-----	----------------------	------

TOLERANCES

OUR PRICES ARE BASED ON OPENINGS FOR WINDOWS
BEING SUFFICIENTLY ACCURATE IN SIZE, POSITION
SQUARENESS AND STRAIGHTNESS TO ENABLE WINDOWS
TO BE FIXED WITH A MAXIMUM 6mm CLEARANCE BETWEEN
WINDOWS, FIXING BRACKETS AND BUILDERS WORK

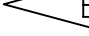
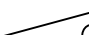
LEGEND ON SPECIAL DETAILS

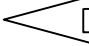
	External pointing by CRITTALL/others
	-----plugs by CRITTALL
	Holes by General Contractor/CRITTALL.
	Polyurethane foam infill by CRITTALL
	Polyurethane foam/waterproof cement infill NOT WITHIN CRITTALL SCOPE OF WORKS
	Brickwork etc. to be flush pointed 12mm. (1/2") forward of external face of windows
	Detail Number Drawing Number



Job Title

HAINES HOUSE

Contractor
JASPAR MANAGEMENT LTD

DRAWN B. SIDHU	DATE JAN 2014
Examined by	SCALES 1:20 @ A1

EST./CONTRACT/DRWG.N				E	Sht.N °	ITEMS			
9227G2B					E1				
Latest Amendment as Last Letter		A	B						
Detail DO issue No.									

Detailed by	Date	Dist.
Finish	Fix Region	

'BI-METALLIC CORROSION'

The content of this design has taken into consideration bi-metallic corrosion (Galvanic action) effects for the materials used therein and by following the advice given in PD 6484 : 1979 published by B.S.I.

VARIATIONS TO CONTRACT

Final approval of this drawing by the specifier will be deemed to accept payment liability for any time and/or cost variation in accordance with the contract

DO NOT SCALE

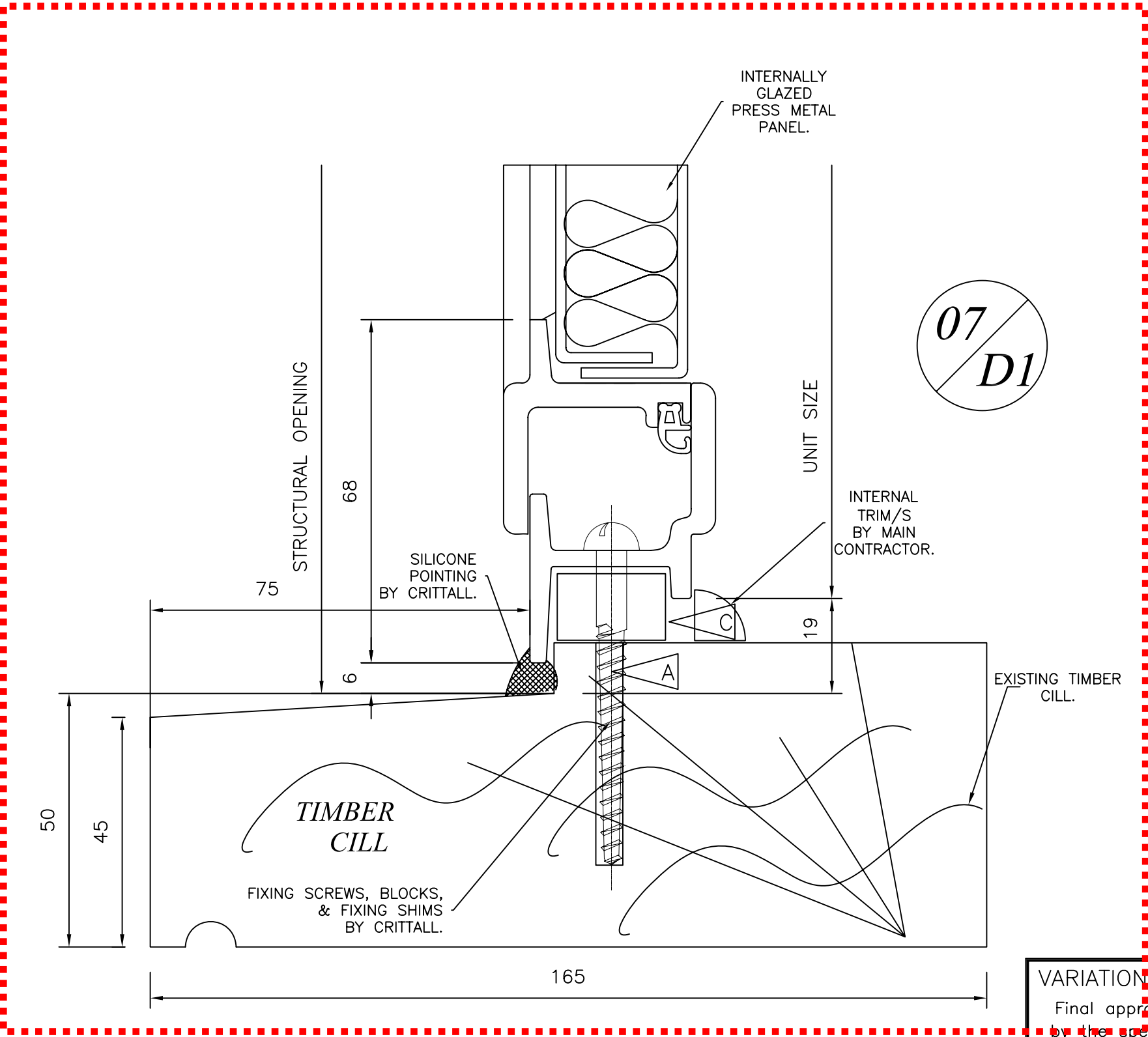
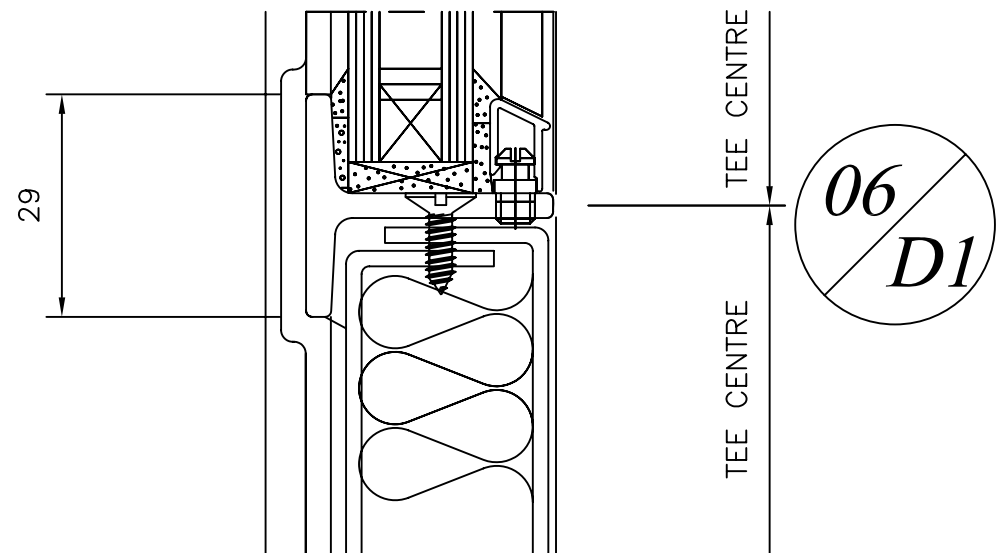
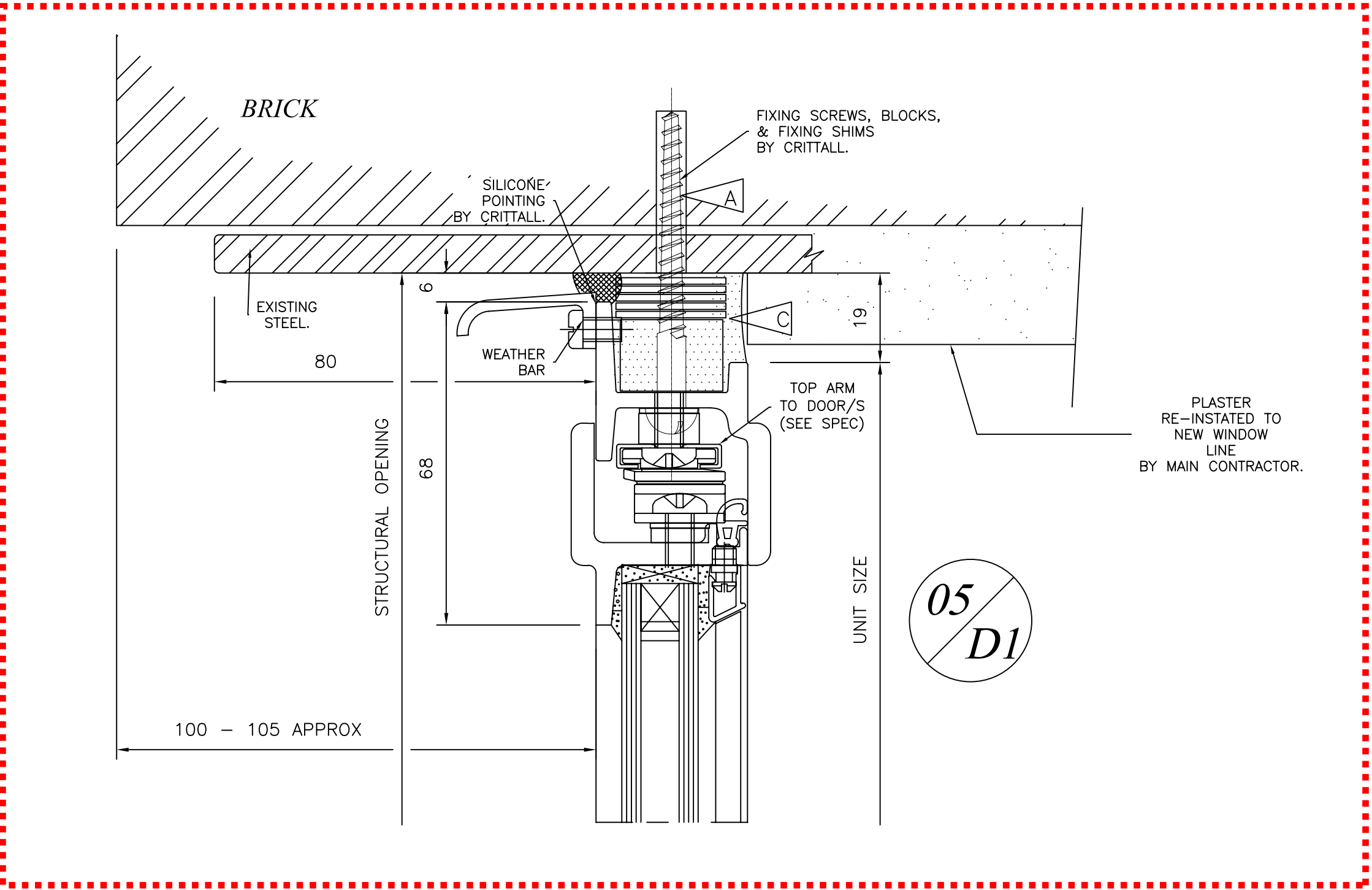

'BI-METALLIC CORROSION'
The content of this design
has taken into consideration
bi-metallic corrosion (Galvanic
action) effects for the materials
used therein and by following the
advice given in PD 6484 : 1979
published by B.S.I.

© CRITTALL WINDOWS LTD. 2001

DO NOT SCALE

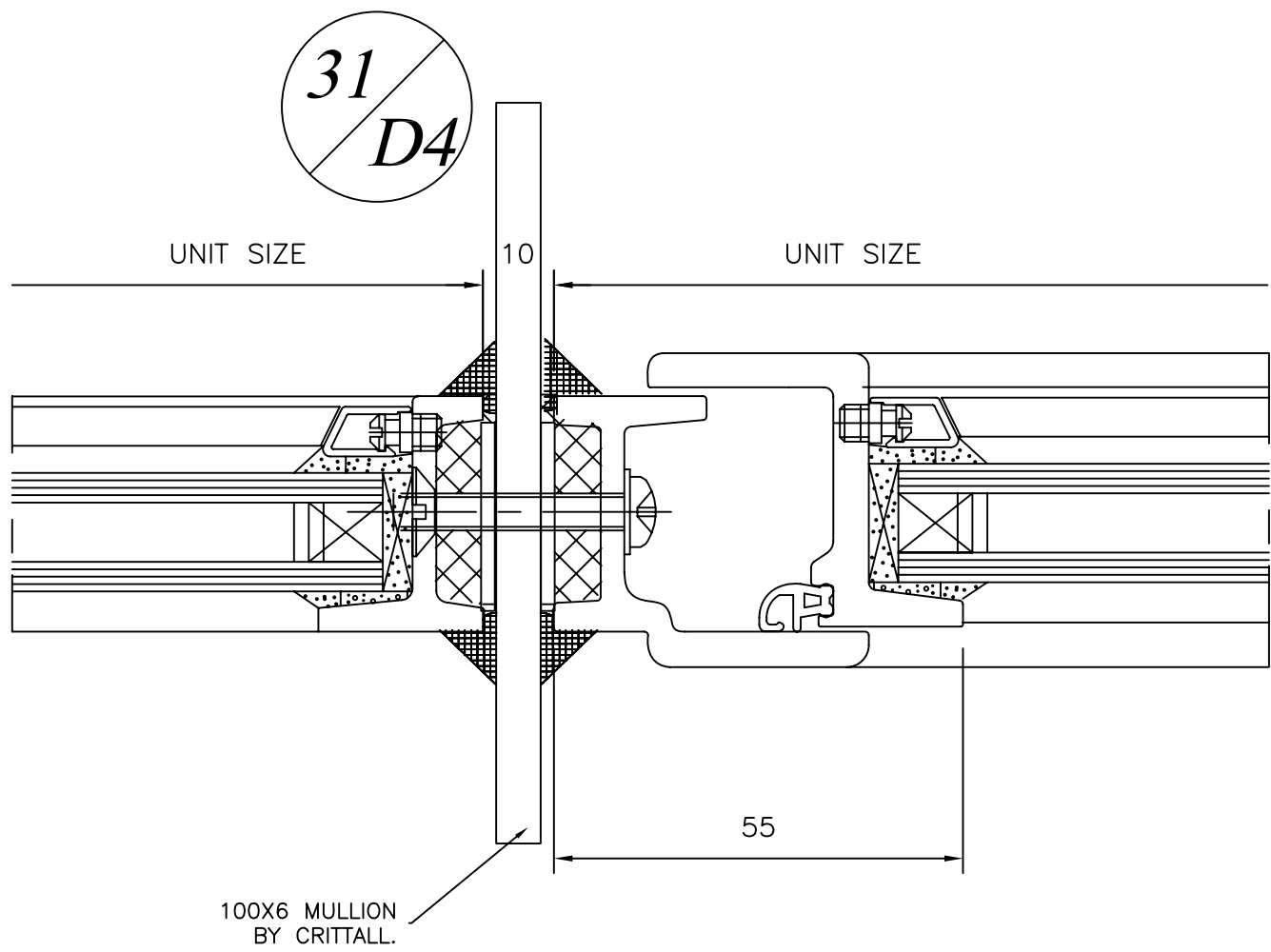
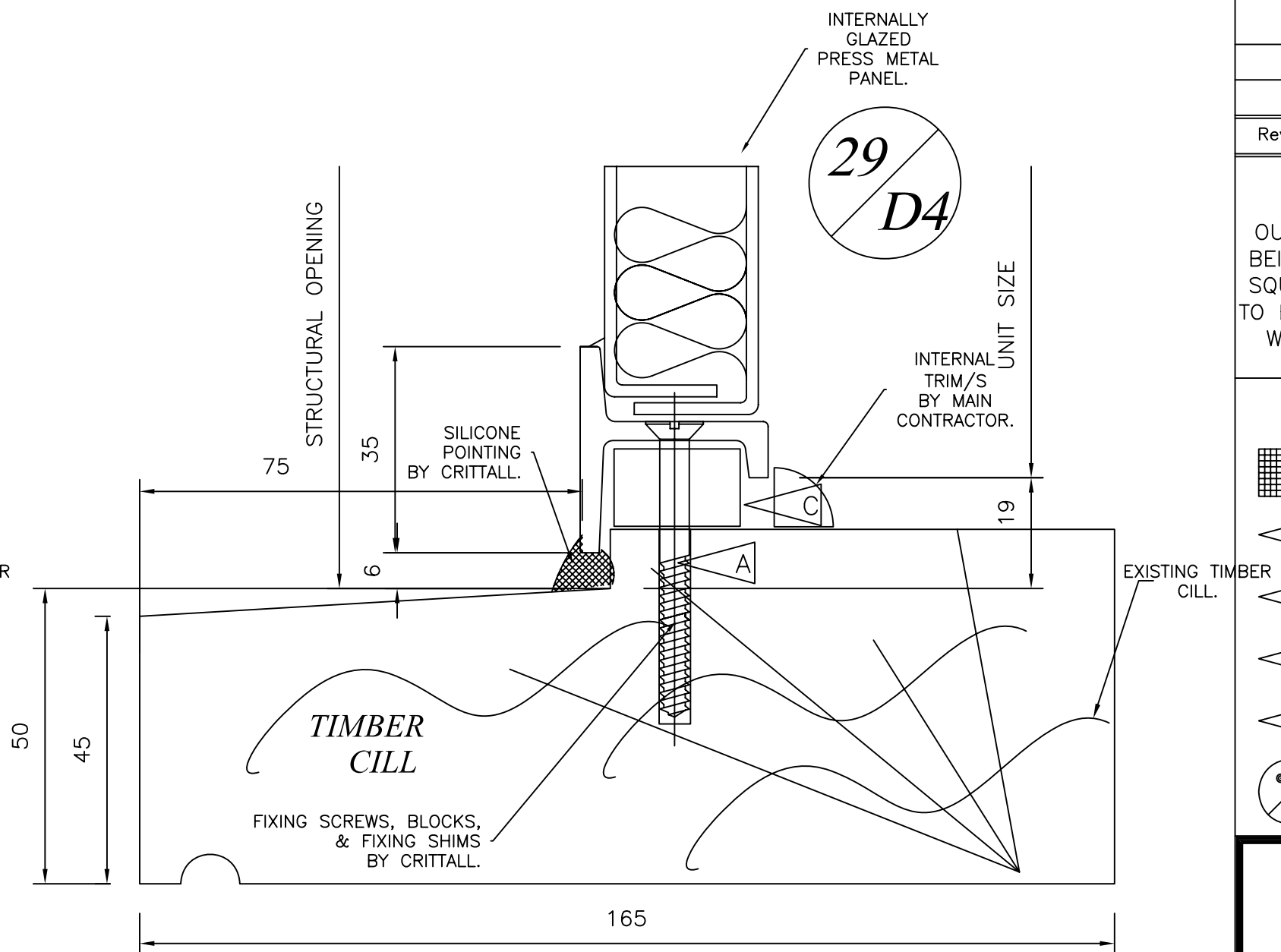
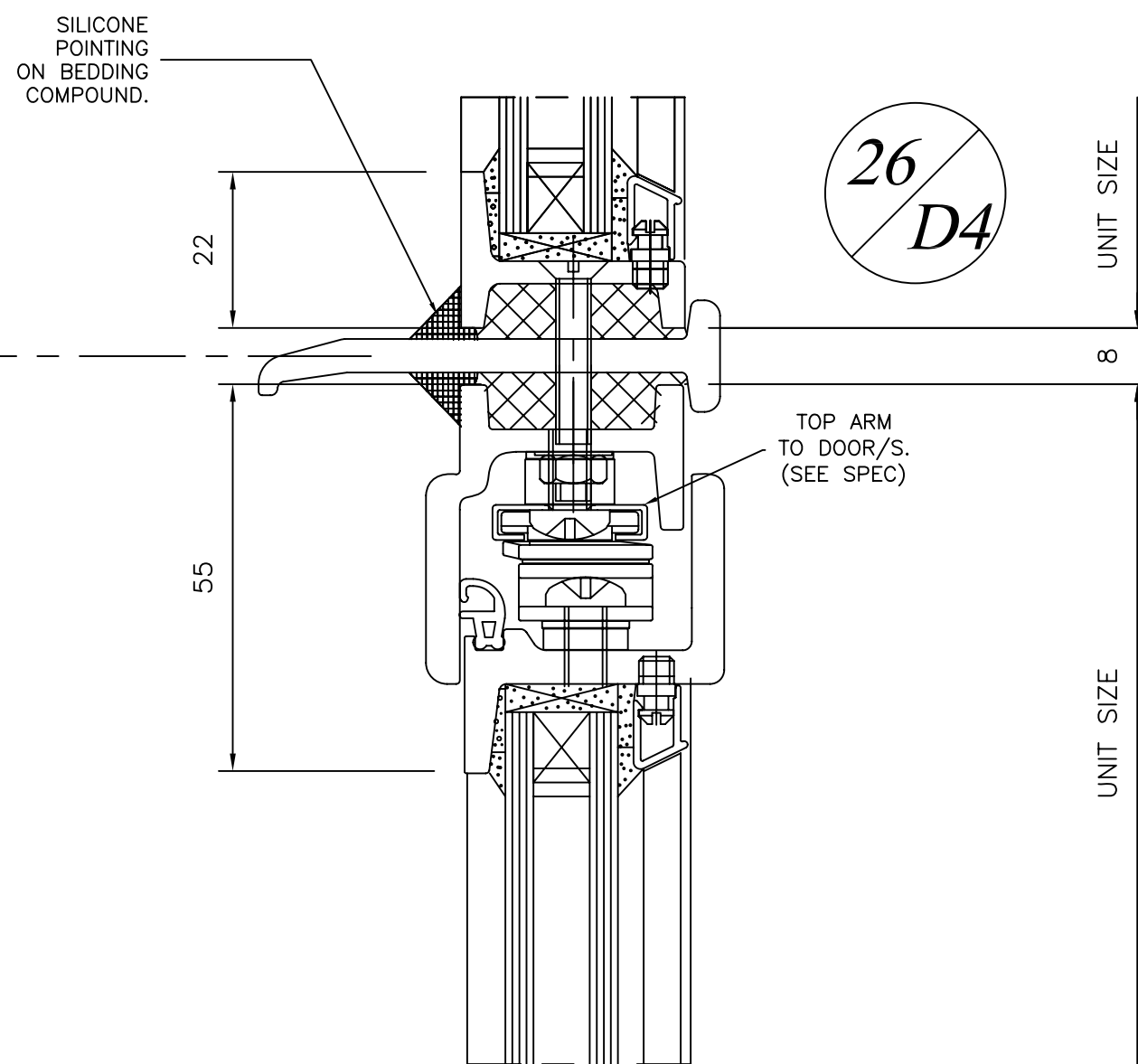

Reason For Issue									
ISSUE FOR APPROVAL.									
DRAWN B. SIDHU				DATE JAN 2014					
Examined by				SCALES		1:1		© A1	
EST./CONTRACT/DRWG.N ^o				Sht.N ^o		ITEMS			
9227G2B				D4					
Latest Amendment as Last Letter									
Detail DO issue No.									
Detailed by				Date		Dist.			
Finish				Fix Region					

DO NOT SCALE

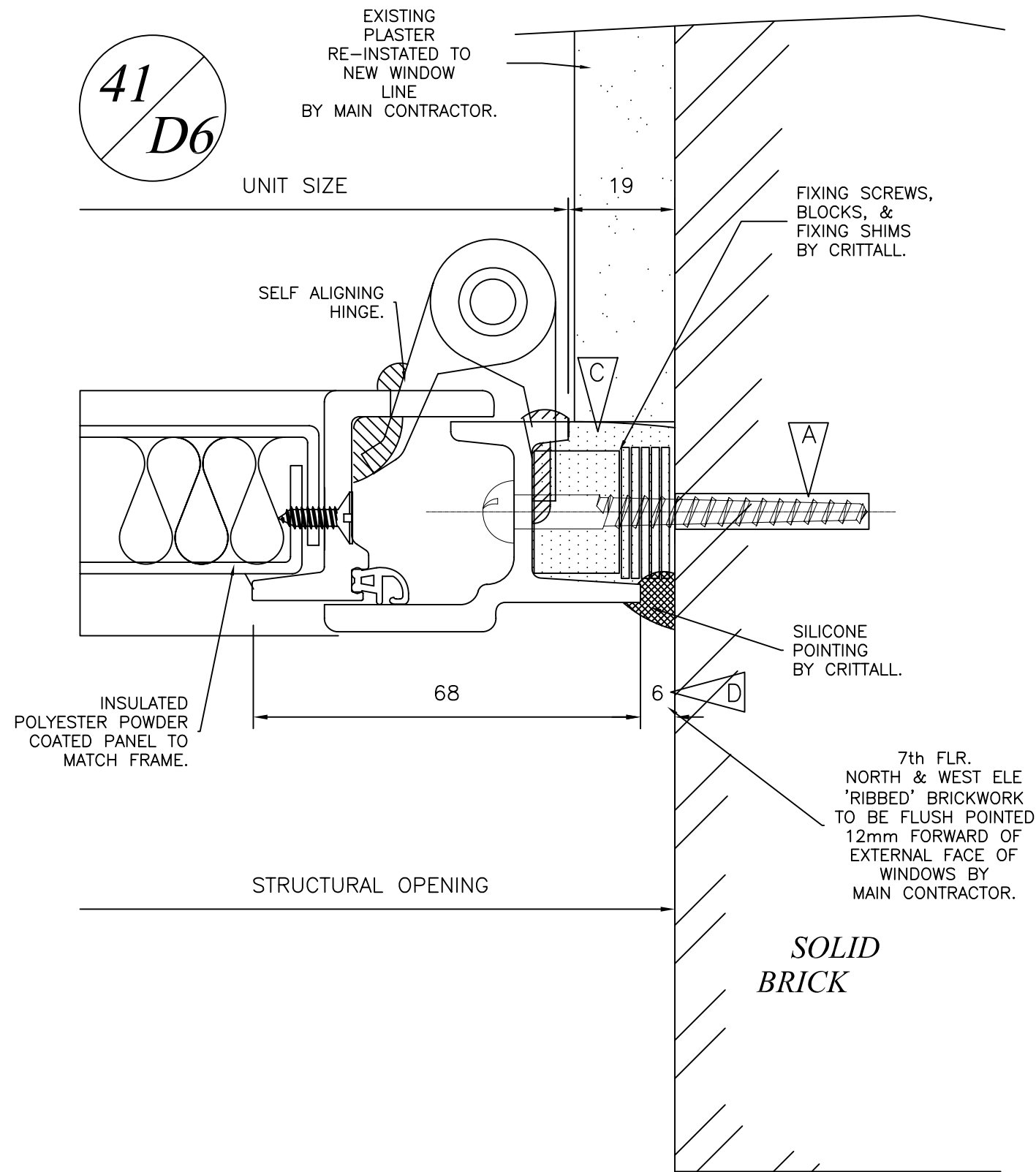
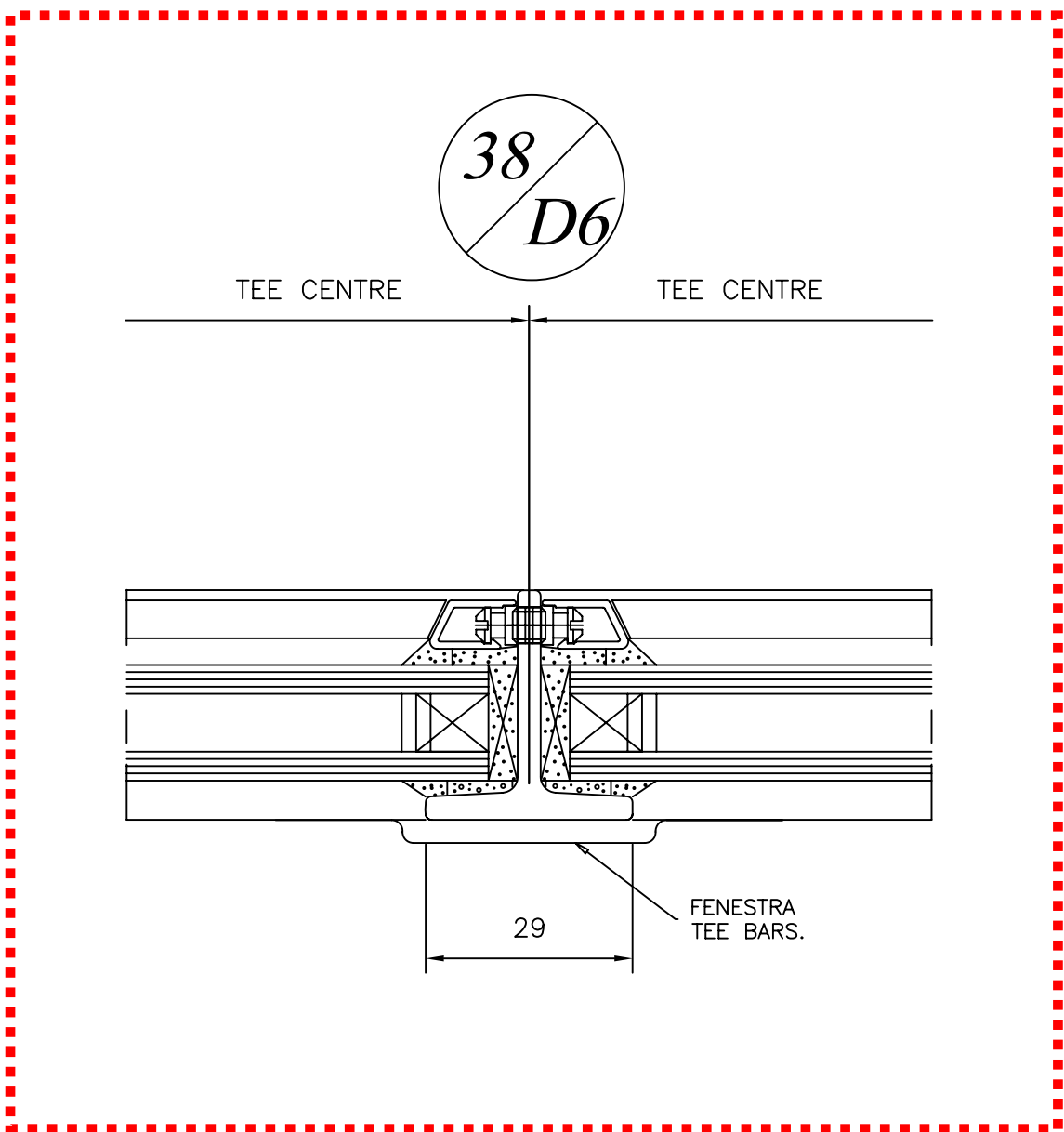

<p>VARIATIONS TO CONTRACT</p> <p>Final approval of this drawing by the specifier will be deemed to accept payment liability for any time and/or cost variation in accordance with the contract</p> <p>© CRITTALL WINDOWS LTD. 2001</p>	<p>'BI-METALLIC CORROSION'</p> <p>The content of this design has taken into consideration bi-metallic corrosion (Galvanic action) effects for the materials used therein and by following the advice given in PD 6484 : 1979 published by B.S.I.</p>
--	--

DO NOT SCALE

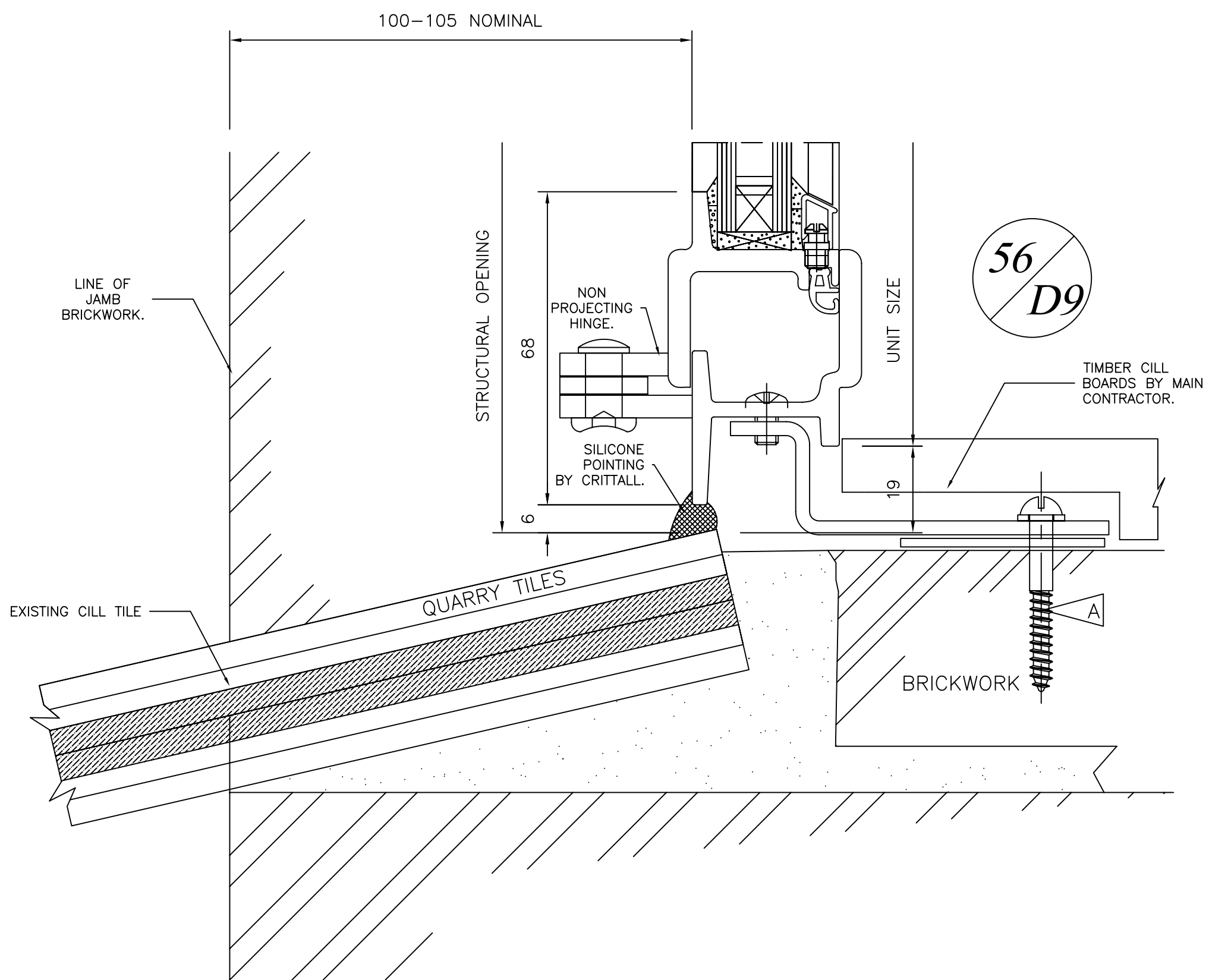
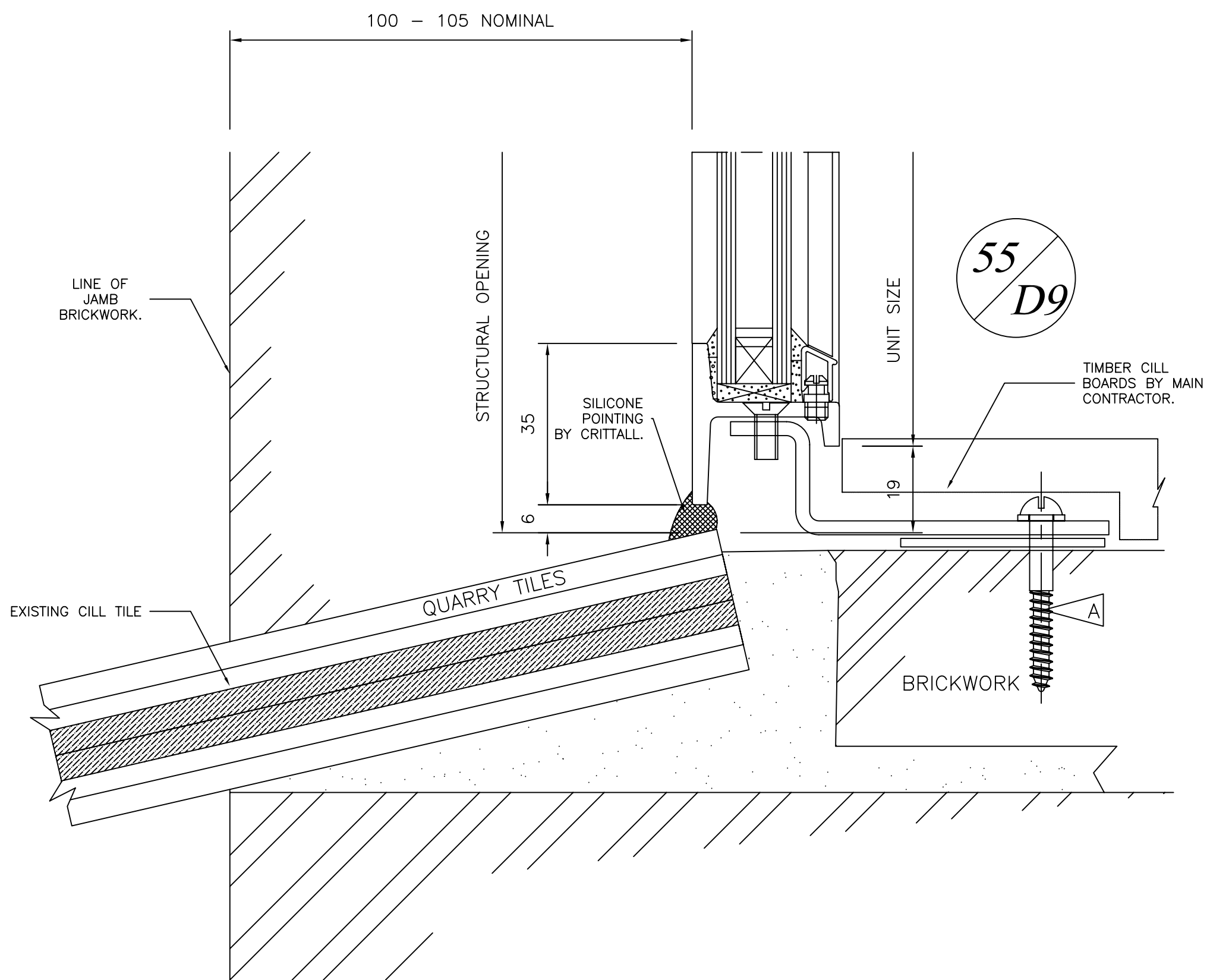
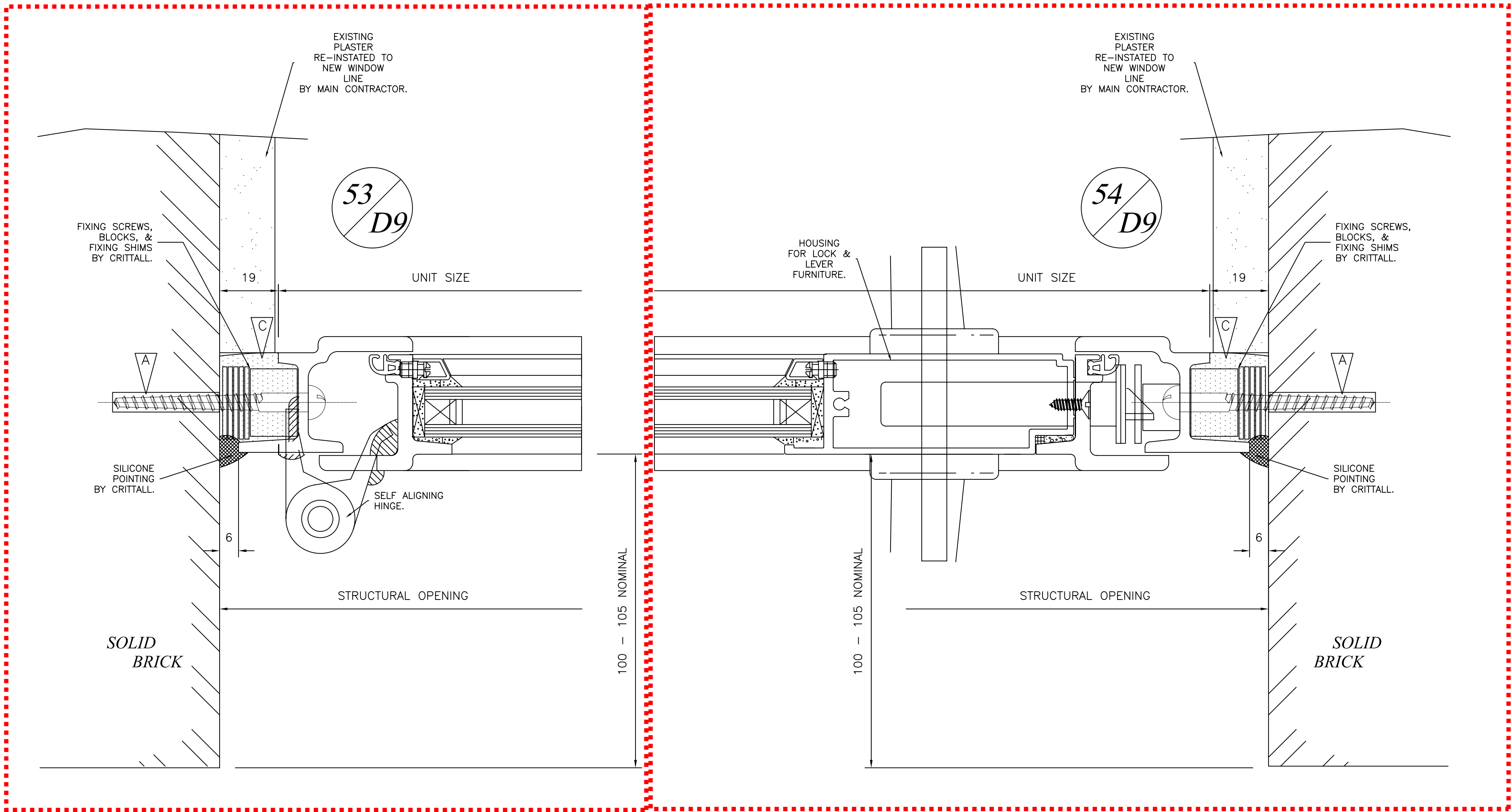

SPECIFICATION

* DETAILER'S SIGNATURE AUTHORIZES RELEASE FOR PRODUCTION/INSTALLATION *

Rev	REVISIONS TO ESTIMATE	Date

[illegible]

TOLERANCES.

OUR PRICES ARE BASED ON OPENINGS FOR WINDOWS BEING SUFFICIENTLY ACCURATE IN SIZE, POSITION SQUARENESS AND STRAIGHTNESS TO ENABLE WINDOWS TO BE FIXED WITH A MAXIMUM 6mm CLEARANCE BETWEEN WINDOWS, FIXING BRACKETS AND BUILDERS WORK

LEGEND ON SPECIAL DETAILS

 External pointing by CRITTALL/others

 _____plugs by CRITTALL

 Holes by General Contractor/CRITTALL.

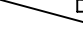
 Polyurethane foam infill by CRITTALL

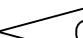
 Polyurethane foam/waterproof cement infill NOT WITHIN CRITTALL SCOPE OF WORKS

 Brickwork etc. to be flush pointed 12mm. (1/2") forward of external face of windows

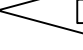
 Detail Number

 Drawing Number

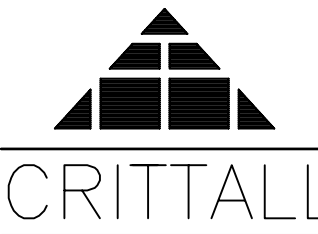

Job Title

HAINES HOUSE

Drawing Title

DETAILS

Contractor JASPAR MANAGEMENT LTD
15-19 CHURCH ROAD
STANMORE, MIDDLESEX

Architect N/A

Reason For Issue

ISSUE FOR APPROVAL.

DRAWN	B. SIDHU	DATE	JAN 2014
Examined by		SCALES	1:1 @ A1

EST./CONTRACT/DRWG.N °	Sht.N°	ITEMS
9227G2B	D9	

[illegible]

Detailed by	Date	Dist.
Finish	Fix Region	

VARIATIONS TO CONTRACT

Final approval of this drawing by the specifier will be deemed to accept payment liability for any time and/or cost variation in accordance with the contract

'BI-METALLIC CORROSION'

The content of this design has taken into consideration bi-metallic corrosion (Galvanic action) effects for the materials used therein and by following the advice given in PD 6484 : 1979 published by B.S.I.