

- G**
- General Notes:**
- G1 For Site and GIS setting out refer to AMRH000
 - G2 All dimensions to be checked on site
 - G3 Any discrepancies between drawings to be reported to the Architect immediately.
 - G4 All levels are above Ordnance datum (AOD)

New Levels are shown thus:	(20) 345
Existing Levels are shown thus:	(20) 345
Retained Existing Levels:	EX-20 345
 - G5 Use figured dimensions only. Do not scale from drawings. IF IN DOUBT, ASK.
 - G6 Refer to Structural Engineers drawings for all structural and services information.
 - G7 For tolerances see the Design Drawings and Specifications
 - G8 For elements of work subject to Contractor's Design, this drawing is indicative of the visual & performance requirements only. The Contractor is responsible for the detailed design and coordination of the installation within the parameters defined in the specification, design drawings, contract terms and contract documents.
 - G9 Room numbers are shown thus:

(15)

 - G10 Door(D) & Window (W) References are shown thus:

(15)

 - G11 Clear height is shown thus (Finished floor to finished soffit)

(270)

 - G12 T-Sheet Reference shown thus:

(270)

 - G13 Finishes are shown thus:

(270)

- G14 Setting Out Points shown thus:

(270)

- G15 Refer to AMRH000 for T-Sheet references, and to AMRH000 for Architectural Specifications.

- W** Wheelchair Accessible Unit
- Proposed Location of Abatement Tank
- Consented scheme outline

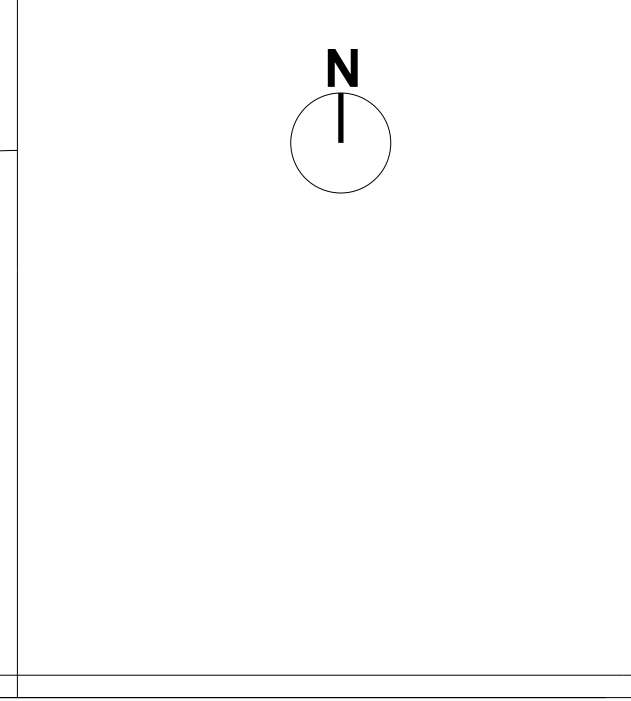

Work Package	Cost Check	Info/Noting	Tender	Contract	Construction	Date	Revision	Description
						05/06/2014		Building footprint from planning stage overlaid on existing plan

Approved by	Date	Revision	Description	Approved by	Date	Rev.	Revision
ST							

Approved by	Project	Subject
	Maygrove Road Housing	Proposed Ground Floor Plan GA Plan

Sort Code	Drawing Number	Rev.
AMRH	SK_115	-

Architects: Hopkins Architects Partnership LLP
27 Broadway Terrace, London, NW1 6LG
T: 020 7724 1751 E: mail@hopkins.co.uk

Date: 05/06/2014 Scale: 1:200 at A2