

Project:
277a Grays Inn Road
Drawing:
Proposed
Ground Floor Plan
Scale:
1:200@A2
Drawing Number:
1101
Date:
June 2014
Status:
PLANNING
Revisions:
A: 00.00.00 - Revisions

Proposed Use

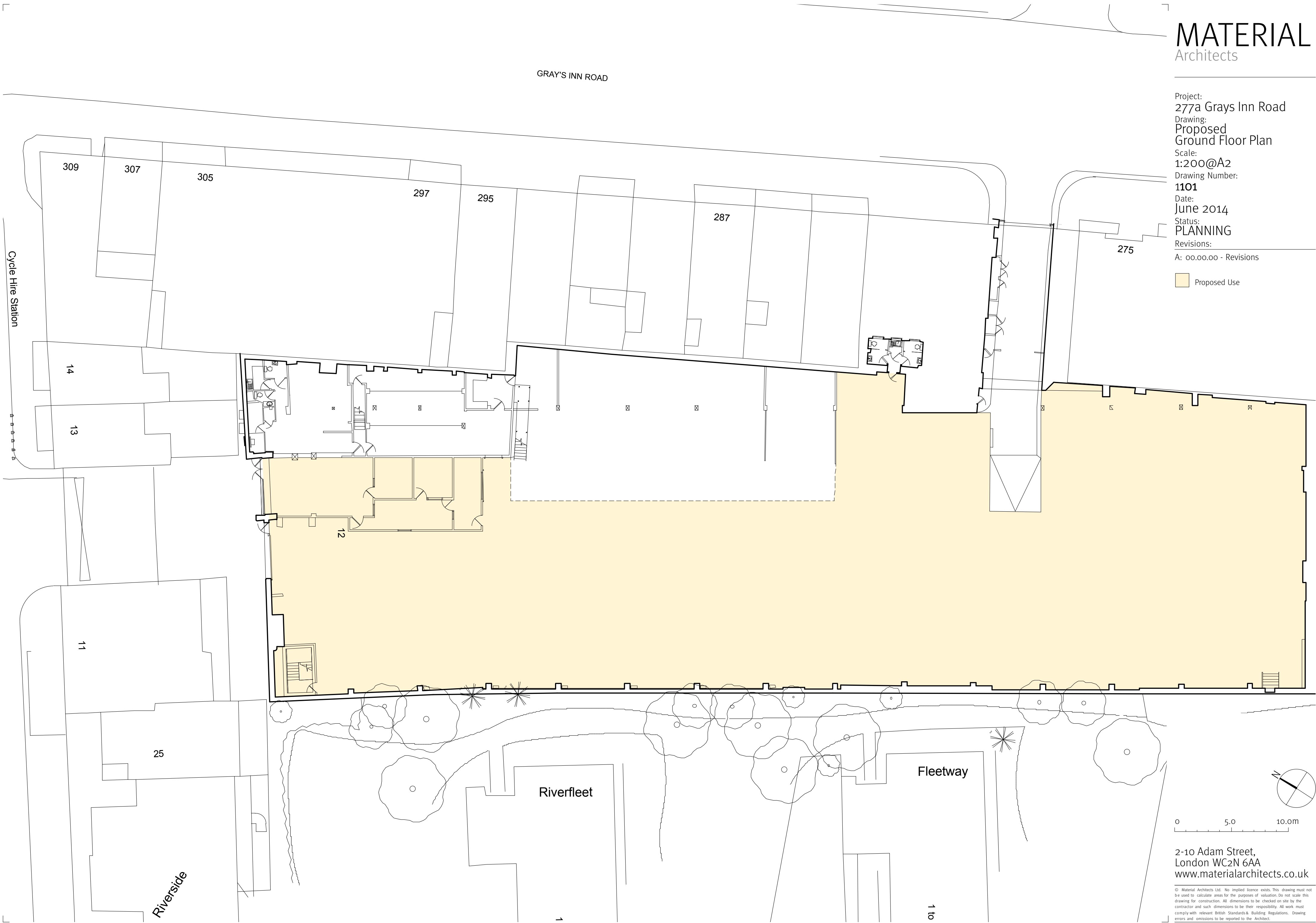

2-10 Adam Street,
London WC2N 6AA
www.materialarchitects.co.uk

© Material Architects Ltd. No implied licence exists. This drawing must not be used to calculate areas for the purposes of valuation. Do not scale this drawing for construction. All dimensions to be checked on site by the contractor and such dimensions to be their responsibility. All work must comply with relevant British Standards & Building Regulations. Drawing errors and omissions to be reported to the Architect.