

Project:  
277a Grays Inn Road  
Drawing:  
Existing  
Ground Floor Plan  
Scale:  
1:200@A2  
Drawing Number:  
**0101**  
Date:  
June 2014  
Status:  
**PLANNING**  
Revisions:  
A: 00.00.00 - Revisions

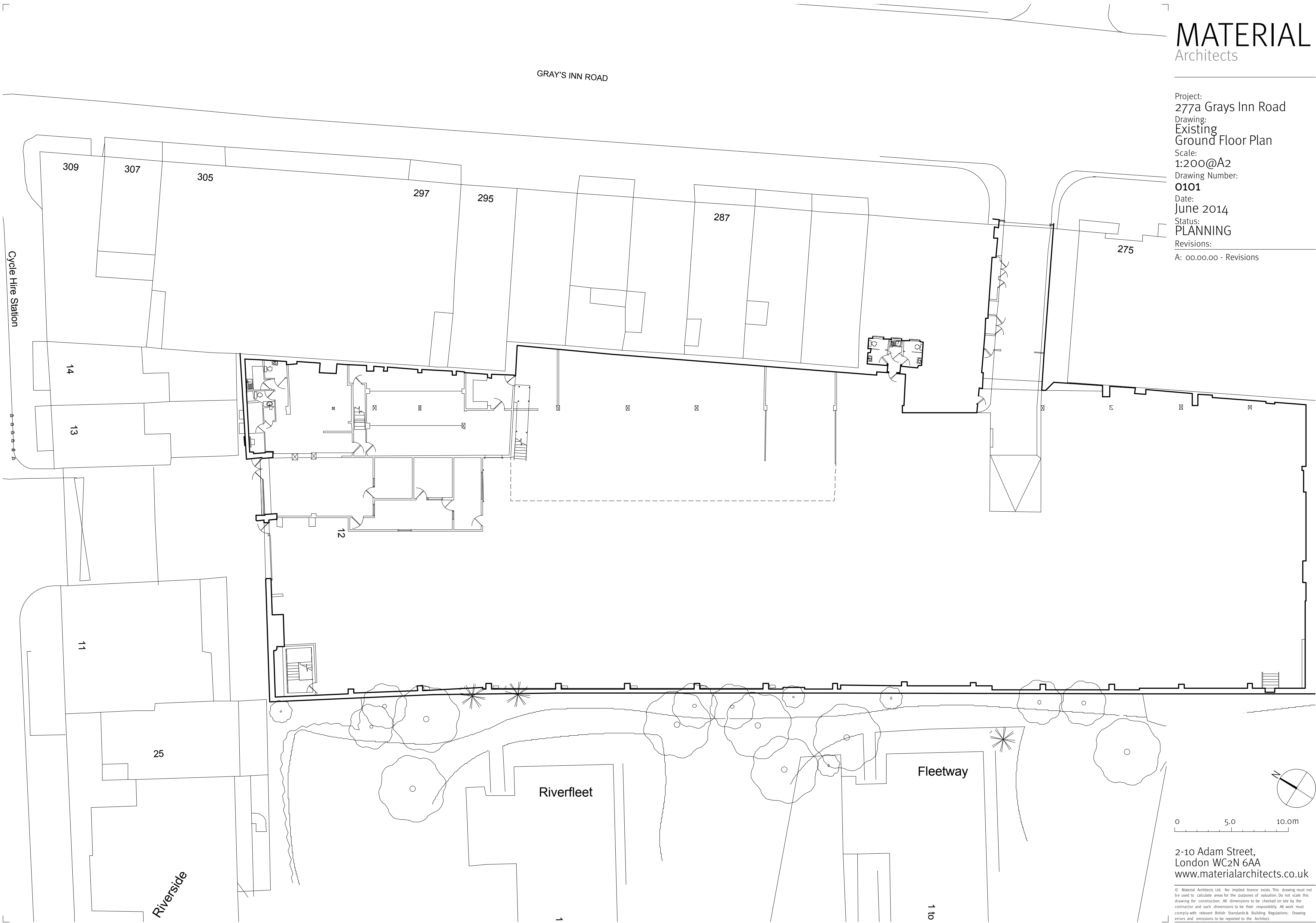

2-10 Adam Street,  
London WC2N 6AA  
[www.materialarchitects.co.uk](http://www.materialarchitects.co.uk)

© Material Architects Ltd. No implied licence exists. This drawing must not be used to calculate areas for the purposes of valuation. Do not scale this drawing for construction. All dimensions to be checked on site by the contractor and such dimensions to be their responsibility. All work must comply with relevant British Standards & Building Regulations. Drawing errors and omissions to be reported to the Architect.