

# BS5837 Method Statement



8 Clarkson Row, Camden, NW1 7RA

Client: S Lepper

Job Reference: 02086R

Consultant: Keiron Hart (BSc Hons, C.Env, F.Arbor.A, MICFor, MEWI)

## June 2014

## Contents

<b>1. Executive Summary .....</b>	<b>2</b>
<b>2. Statutory Protection .....</b>	<b>3</b>
<b>3. Project Contact List.....</b>	<b>4</b>
<b>4.0 Arboricultural Method Statement.....</b>	<b>5</b>
<b>4.1 Service Location .....</b>	<b>5</b>
<b>4.2 Hand Excavation &amp; Root Protection .....</b>	<b>5</b>
<b>4.3 Arboricultural Project Supervision .....</b>	<b>7</b>
<b>Appendix 1 – BS5837 Survey Key .....</b>	<b>9</b>
<b>Appendix 2 – BS5837 Survey Data.....</b>	<b>10</b>
<b>Appendix 3 – Tree Works Schedule .....</b>	<b>11</b>
<b>Appendix 4 - Tree Constraints Plan .....</b>	<b>12</b>
<b>Appendix 5 - Tree Protection Plan.....</b>	<b>14</b>
<b>Appendix 6 – Site Photographs .....</b>	<b>17</b>
<b>Appendix 7 – Limitations .....</b>	<b>19</b>

## 1. Executive Summary

- 1.1 Tamla Trees Ltd has been appointed by S Lepper/ Garden2office LTD to compile a method statement following a request from the Council regarding installation of a proposed garden room within the Root Protection Area of 2 offsite trees
- 1.2 The Method Statement seeks to provide information on:
  - 1.2.1 *Location and installation of services/ utilities*
  - 1.2.2 *Hand excavation method for excavation within the retained trees root protection area (RPA as defined in BS5837 :2012)*
  - 1.2.3 *Root protection following exposure*
  - 1.2.4 *Details of root pruning, assessment of what is appropriate and method.*
- 1.3 This method statement seeks to provide site specific information as it relates to the above.
- 1.4 We have not been advised whether the site is within a Conservation Area or whether the trees are subject to a TPO.
- 1.5 This method statement is based upon Garden2office LTD drawing ref: Client: S Lepper, 8 Clarkson Row, Camden,NW1 7RA, Scale 1:50 @ A3

## 2. Statutory Protection

- 2.1 The site is located Conservation Area, but is not affected by a TPO. Permission has been granted to reduce back the canopies of T1 & T2. Works over and above this would require further permission.

Conservation Area Status	
Is the site located within a Conservation Area?	Unknown
<b>Notes:</b> All trees larger than 7.5cm diameter at 1.5m above ground level are subject to regulations within a Conservation Area. Exemptions apply for trees which are dead and dangerous but clarification before any tree works is advised. A <a href="#">notification</a> is required in many circumstances.	
Tree Preservation Order Status	
Are inspected trees subject to a TPO?	Unknown

### 3. Project Contact List

3.1 The following people are identified as relevant project contacts:

Name	Role	Contact Details
S Lepper	Client/ Homeowner	NA
Mark Chisholm	Architect/ Construction Company Garden2office LTD	<a href="mailto:markschisholm@gmail.com">markschisholm@gmail.com</a> 07906 754244
Keiron Hart Tamla Trees Ltd	Arboricultural Consultant	<a href="mailto:keiron@tamlatrees.com">keiron@tamlatrees.com</a> 07845249396
Tree Office Camden Council	Tree Preservation Officer	TBC

## 4.0 Arboricultural Method Statement

### 4.1 Service Location

- 4.1.1 The proposal will be serviced by an electrical feed delivered from the main house. This will be buried below ground to a depth no greater than 500mm and will run down the eastern edge of the garden to limit any possible impact to T2 (through which RPA it cuts transversely). There is no likely impact to T1 given the distance from the tree and the fact that it tracts directly towards the tree.
- 4.1.2 The proposal has a rainwater downpipe that gathers the water in a 'butt' rainwater collector. This will operate on a manual overflow discharging directly on to the ground below so there is not considered to be any issues associated with such service provision.

### 4.2 Hand Excavation & Root Protection

- 4.2.1 The foundation area indicated on the supporting plan will be excavated by hand. This excavation will be undertaken by briefed operatives using narrow pointed shovels. The excavations take the form of 400mm x 400mm x 400mm 'pads'. As these are hand dug, and given the form of the proposal (lightweight structure) there is scope to flex the exact positions in relation to any roots that may be encountered. Whilst the pads for the rear elevation are close to T1 even at quite short distances the trees root system will have sub-divided to a level where roots >25mm are not expected.

- 4.2.4 In all instances the threshold root size is >25mm. Any uncovered root will be carefully exposed and noted before further excavation continues. The timing of excavations is such that no night frosts are envisaged. However, in the event the build is delayed for any reason and exposed roots will be at risk of frost contact they must be covered (by way of hessian or light soil covering) at the end of each working day.
- 4.2.5 Once the pad locations have been excavated to 400mm images should be provided to Tamla Trees Ltd. In the event no roots >25mm are uncovered this will be confirmed to Camden Council and the proposed pad foundations can proceed.
- 4.2.6 Should roots >25mm the dig will be extended to ascertain a suitable location for the alternative foundation location. If no suitable location can be uncovered works will stop and a site meeting to discuss the alternative foundation design will be arranged.
- 4.2.7 Roots <25mm can be cut but should be cut with a clean hand saw to give them the greatest opportunity to occlude (heal). Under no circumstances should roots >10mm by <25mm be left with a flailed (spade) severed end.
- 4.2.8 It is expected that surface fibrous roots will be encountered and to minimise the chance of any inadvertent contamination each excavated pad location will be lined with a plastic membrane prior to the pour of concrete.

## 4.3 Construction

- 4.3.1 Most damage to trees on developments sites is caused inadvertently and to ensure the risk of any compaction is limited we have advised that the existing flag stones/ patio area remain in place during construction. The nature of the site (rear garden with access through the property) is such that materials can only be transported in small sizes and low volumes, the risk of ground compaction is very low.
- 4.3.2 No specific tree protection measures are proposed as the trees are located behind boundary fencing.



## 4.4 Arboricultural Site Supervision

4.4.1 We do not propose a cycle of supervision given the low impact of the proposal and subject to the following processes being adhered to:

### Site Set Up

- All operatives briefed of tree protection measures
- Existing patio areas remain in place for duration of construction

### Hand Excavation

- Hand digging of all pad locations
- Excavation to show all exposed roots and clean cuts where relevant on roots 10-25mm
- Pad locations moved if roots >25mm encountered

### Completion

- Pad excavations lined with non permeable membrane prior to concrete pours

**Fig 1 – Advised process for implementation**

## Appendix 1 – BS5837 Survey Key

BS 5837 Cat	Description
<b>A</b>	Those of high quality and value: in such a condition as to be able to make a substantial contribution (> 40 years)
<b>B</b>	Those trees of moderate quality and value: those in such a condition as to make a significant contribution (> 20 years)
<b>C</b>	Those trees of low quality and value: currently in an adequate condition to remain until new planting could be established (> 10 years)
<b>U</b>	Those in such a condition that any existing value would be lost within 10 years and which should, in the current context, be removed regardless of development (< 10 years)

**Note:** Sub categories are denoted in the tree survey data (A1, B1, C2 etc.). You are referred to BS5837 for further detail if required.

<b>Tree No.</b>	T (tree), G (group), H (hedge), W (woodland) + Ref No.
<b>Species</b>	Common Name
<b>Ht (m)</b>	Measured height in metres
<b>DBH (m)</b>	Diameter at 1.5m above ground level
<b>No of stems</b>	An indication of the trees form @1.5m (1 = single stem, m/s = multi-stemmed)
<b>Branch Spread</b>	In m to cardinal points
<b>Cr Ht Clearance (m)</b>	Overall height of lowest branches from the ground level on side of proposed development
<b>Life Stage</b>	Young, Semi-Mature, Early-Mature, Mature, Over-Mature
<b>General Observations</b>	Observations on the condition of the tree(s)
<b>Tree Work Specification</b>	Proposed tree works in accordance with BS3998
<b>BS Cat</b>	See above
<b>Life Exp</b>	Estimated remaining contribution in years.
<b>RPA Radius(m)</b>	Radius of the trees Root Protection Area measured from the trunk to the edge of the RPA circle in metres

## Appendix 2 – BS5837 Survey Data

Tree No.	Species	DBH (m)	No of Stems	Ht (m)	Crown Spread				BS Cat	Age Class	Life Expect	Cr Ht (m)	Observation	Recommendations	RPR (m)
					N	E	S	W							
T1	Tree of Heaven	0.5	1	15	7	7	7	7	B1	Mature	20 to 40	3.5	Boundary tree with no access for full inspection. Previously reduced and no regrown. Species extremely tolerant of clay soil and ground disturbance.	No works	6
T2	Tree of Heaven	0.35	1	13.5	5	5	5	5	C1	Early-mature	20 to 40	3.5	3rd party and Ivy covered so full inspection not possible.	No works	4.2

## Appendix 3 – Tree Works Schedule

**NOTE:** All tree works to be undertaken in accordance with BS 3998:2010 'Tree work - Recommendations'.

### Tree Surgery

Tree No.	Species	Approved Tree Works	BS Cat
None			

### Proposed Removal

Tree No.	Species	Proposed Tree Works	Observations	BS Cat
None				

# Appendix 4 - Tree Constraints Plan

Tree No	Species	DBH	Age Class	Life Exp	Observations	BS Cat	RPA
T1	Tree of Heaven	0.5	Mature	20 to 40	Boundary tree with no access for full inspection. Previously reduced and no regrown. Species extremely tolerant of clay soil and ground disturbance.	B1	6
T2	Tree of Heaven	0.35	Early-mature	20 to 40	3rd party and Ivy covered so full inspection not possible.	C1	4.2



COPYRIGHT RESERVED  
DO NOT SCALE FROM THIS DRAWING

**Tree Survey Drawing Key**

See Tamla Trees, Tree Survey for Individual Tree Details

KEY

Please refer to Tamla Trees report for details

- Category B - moderate quality and value
- Category C - low quality and value

RPA - root protection area as defined by Table 2 BS 5837:2012

15  
14

T1 Tree of Heaven  
B1

T2 Tree of Heaven  
C1

10

REV    AMENDMENTS    DRAWN DATE AUTH'D

PROJECT

8 Clarkson Row,  
Camden, NW1 7RA

CLIENT

S Lepper

TITLE  
Tree Constraint Plan (TCP)

Job	02086R	Scale	1:100 @ A3	DRG NO		Revision	
Date	10/06/2014	Type	a		02086P_TCP_01		-

**Tamla Trees**  
consulting arborists

# Appendix 5 - Tree Protection Plan

Tree protection is essential to successfully integrate the proposal into the surrounding trees. It is designed to manage the impact on the underlying soil and rooting environment. It must therefore be installed prior to any further site activity. Even apparently minimal tracking of the soil near trees has the capacity to irretrievably modify the soil environment to the detriment of tree health and stability.

The location of trees is such that no protective fencing is required as protection is provided by way of the existing boundary fencing

- The existing patio (shown right) remains in place during construction to limit any possible risk of compaction.



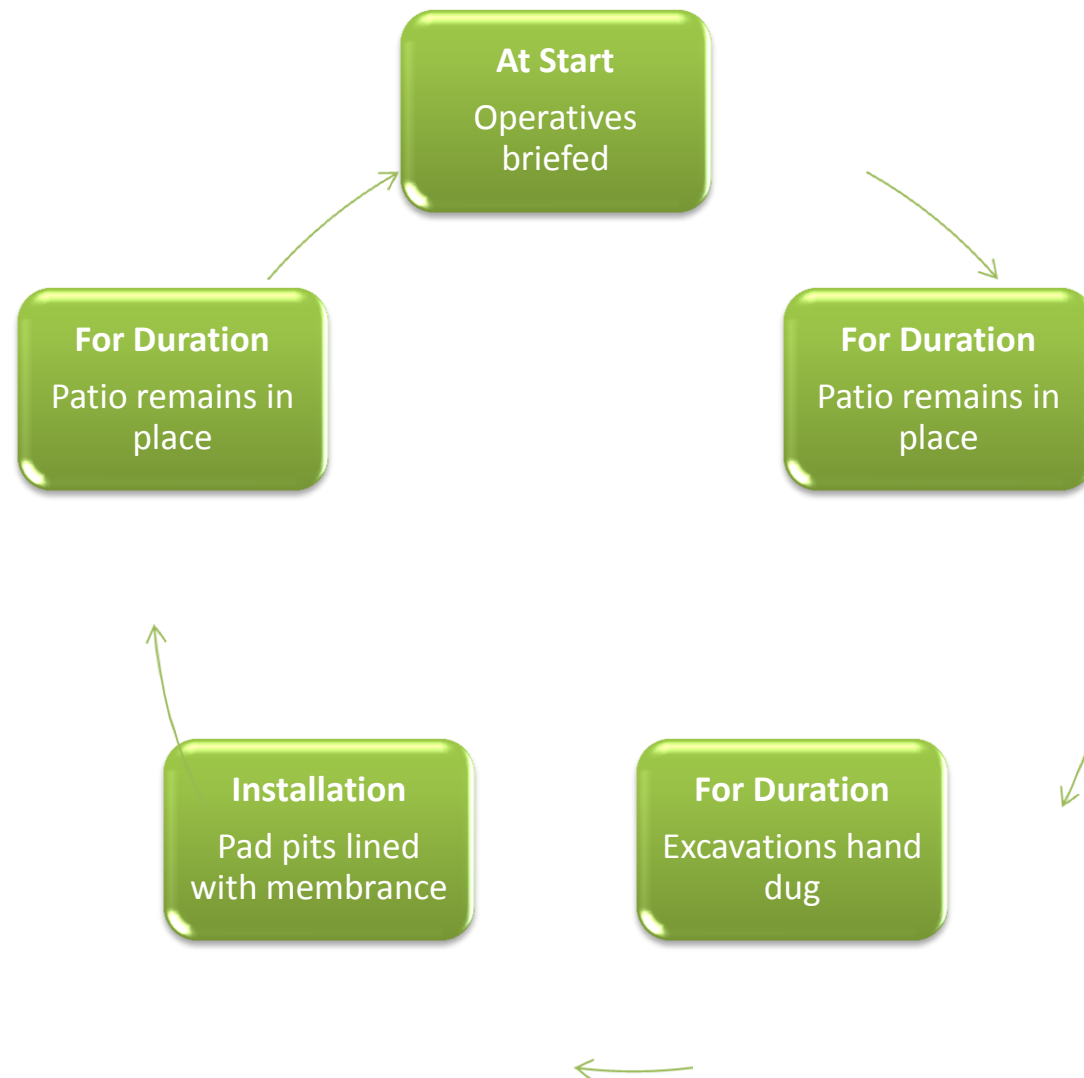



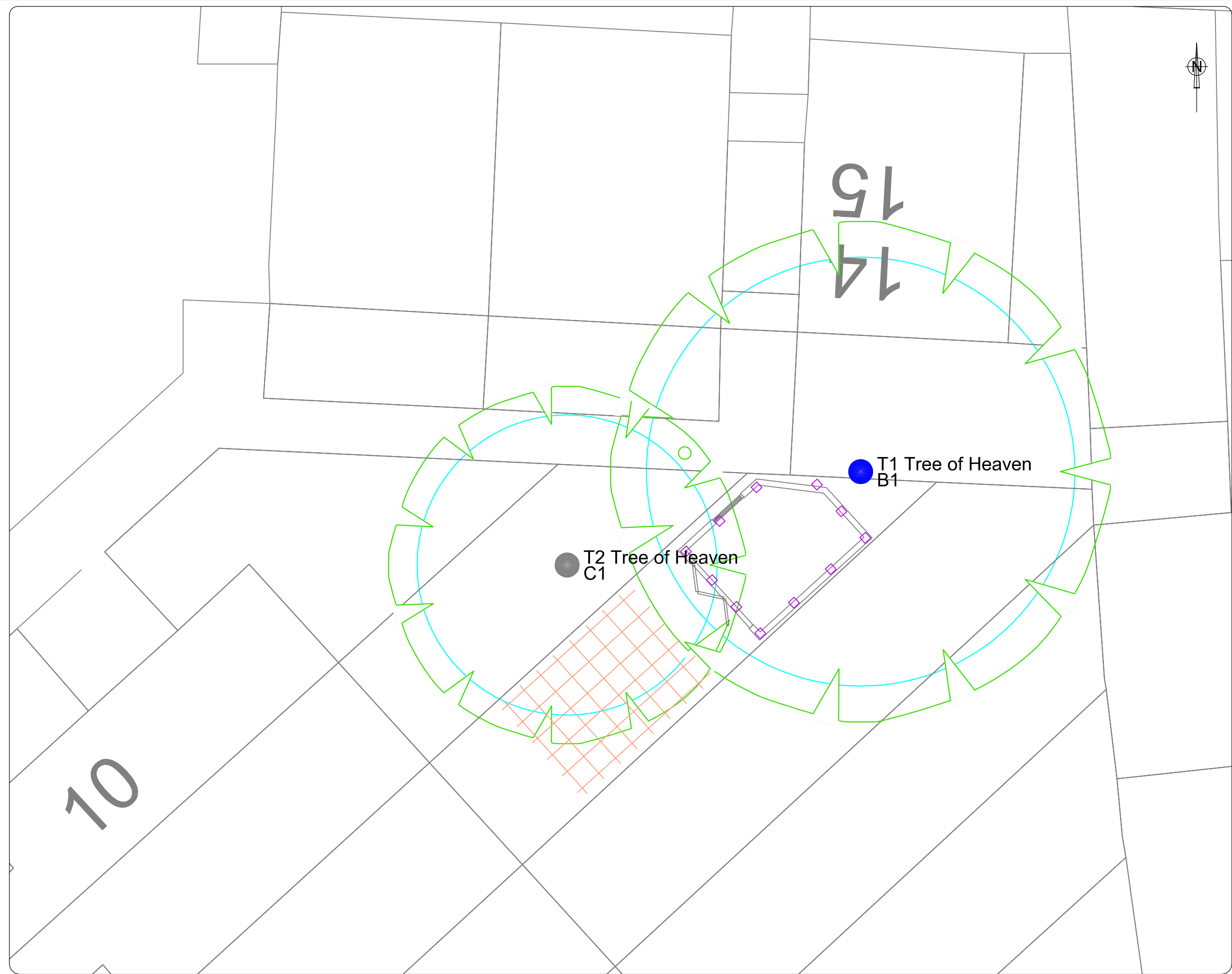

COPYRIGHT RESERVED  
DO NOT SCALE FROM THIS DRAWING

**Tree Survey Drawing Key**

Root Protection Area m2  
Tree Canopy Extent  
Stem Location / Coloured disc denotes BS: 5837 Category  
Tree Number

See Tamla Trees, Tree Survey for Individual Tree Details

**KEY**

Please refer to Tamla Trees report for details

- Category B - moderate quality and value
- Category C - low quality and value

RPA - root protection area as defined by Table 2 BS 5837:2012

Pads 400mm x 400mm x 400mm hand dug and lined prior to concrete pour. Any roots larger than 25mm lead to pad repositioning.

Existing Patio Stones - to remain in place for the duration of the project to remove risk of compaction

REV	AMENDMENTS	DRAWN DATE	AUTH'D
-----	------------	------------	--------

PROJECT  
**8 Clarkson Row,  
Camden, NW1 7RA**

CLIENT  
**S Lepper**

TITLE  
**Tree Protection Plan (TPP)**

Job 02086R	Scale 1:100 @ A3	DRG NO	Revision
Date 10/06/2014	Type a	02086P_TPP_01	-

**Tamla Trees**  
consulting arborists

## Appendix 6 – Site Photographs



**Image 1** – T1 showing location, high canopy and boundary fence

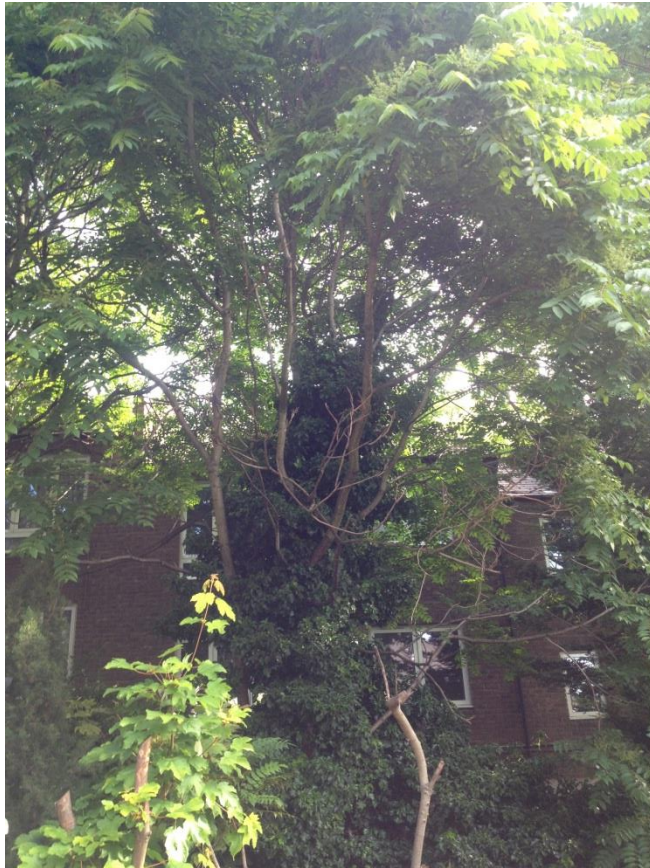

**Image 2 – T2**



**Image 3 – All ground to be cleared by hand and pads hand dug and lined prior to concrete pour**



## Appendix 7 – Limitations

### **Full Legal Disclaimer**

*This report was prepared as a report of work instructed by client (as specified). Neither Tamla Trees Ltd nor any associated company, nor any of their employees, nor any of their contractors, subcontractors or their employees, makes any warranty, express or implied, or assumes any legal liability or responsibility for the accuracy, completeness, or any third party's use or the report and its findings. Reference herein to any specific commercial product, process, or service by trade name, trademark, manufacturer, or otherwise, does not necessarily constitute or imply its endorsement, recommendation, or favouring by Tamla Trees Ltd or any associated company. The views and opinions of authors expressed herein do not necessarily state or reflect those of Tamla Trees Ltd or any associated company.*

### **Copyright & Non-Disclosure Notice**

*The content, layout and any supporting digital files associated with this report are subject to copyright owned by Tamla Trees Ltd. Exceptions to this are present where that copyright has been legally assigned to Tamla Trees Ltd by another party/ organisation. In addition Tamla Trees Ltd may utilise content generated under license. Reproduction, scanning, copying or distribution of this report in any form is prohibited without prior written agreement.*

### **Third Party Disclaimer**

*Tamla Trees Ltd, sub-contractors or suppliers will not be responsible or liable for any claim of loss or damage resulting from the third party use of the information contained within this report.*

### **Specific - Trees**

*All tree inspections, unless specified, have been undertaken from ground level and using non-invasive techniques. Comments contained within the report on the condition and risk associated with any tree relate to the condition of the tree at the date and time of survey. Please note that the condition of trees is subject to change. This change may occur, but is not limited to biological and non-biological factors as well as mechanical/ physical changes to conditions in the proximity of the tree. Trees should be inspected at intervals relative to risk/ target areas and in accordance with relevant [HSE guidance](#). Tamla Trees Ltd can provide further information on this matter if required. Where full access to trees (Ivy, materials at base, location on 3<sup>rd</sup> party land) was not possible Tamla Trees Ltd accept no liability for issues that arise. Please note that this report should not be considered a full health and safety inspection of surveyed trees.*

*Please note no statutory control checks have been undertaken (unless specified). Where tree surgery works have been identified these works are based on the assumption that planning is approved, no tree works should be undertaken prior to determination of this application without up to date confirmation of the Tree Preservation Order / Conservation Area Status of the vegetation. All works should be undertaken in accordance with the appropriate Duty of Care. This should include, for example, site specific risk assessments and due diligence inspections for the presence of protected species.*

*Any comment/ measurements relating to 3<sup>rd</sup> party trees have been made without full access to the tree(s). Should these trees have any impact on the proposed development we would advise you to instruct us to contact the 3<sup>rd</sup> party and undertake further detailed inspection work.*

**A legal Duty of Care requires that any tree works specified in this report should be performed by qualified, arboricultural contractors who have been competency tested to determine their suitability for such works in line with Health & Safety Executive Guidelines. Additionally all works should be carried out according to British Standard 3998 (2010) Recommendations for Tree Work.**