

ROOF PIN SPOTS TO BE RETAINED (SEE DRAWING E877) ZONE DX-24

ROOF PIN SPOTS TO BE RETAINED (SEE DRAWING E877) ZONE DX-23

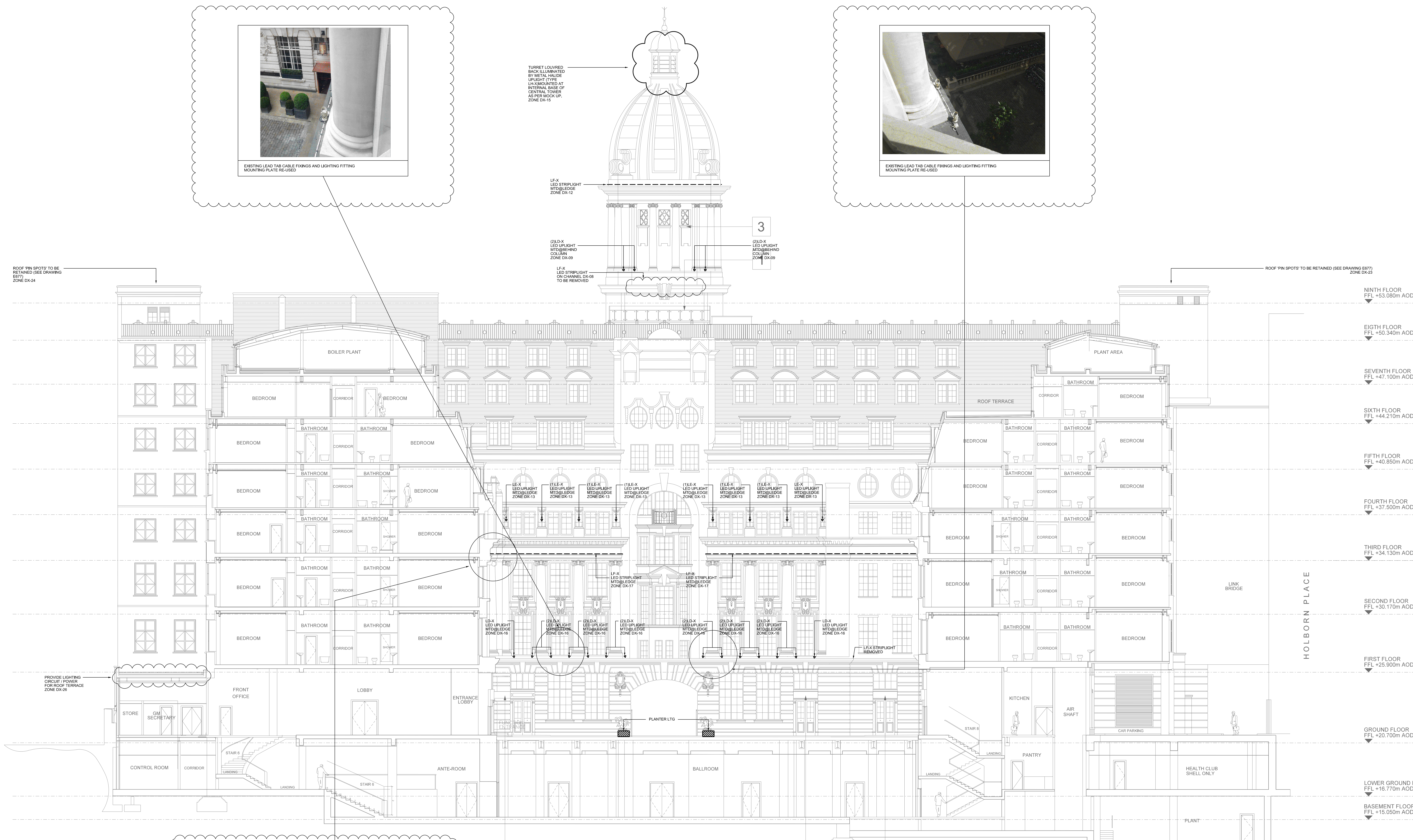

C7	MAY '14	TYPICAL CABLE FIXING DETAIL (PHOTOS) ADDED	AS	MSW	DAW
C6	AUG '13	REVISED FOLLOWING MOCK UP REVIEW	ATK	MSW	DAW
C5	JUL '13	REVISED FOLLOWING CONTROL GROUPS	ATK	MSW	DAW
C4	JUN '13	REVISED - ADDING CONTROL GROUPS	KL	MSW	DAW
C3	MAY '13	REVISED FOLLOWING DESIGN REVIEW	XF	MSW	DAW
C2	APR '13	REVISED FOLLOWING MOCK UP REVIEW	XF	MSW	DAW
C1	AUG '12	CONTRACT ISSUE	XF	MSW	DAW
T1	APR '12	TENDER ISSUE	XF	MSW	DAW

Architect: **EPR**  
Client: **HPI**  
Project: **CHANCERY COURT HOTEL**

Title: **EXTERNAL LIGHTING COURTYARD NORTH ELEVATION**  
Eng: XF  
CADD: XF  
ChkG: mech, elec, ph  
Appr: DAW  
Date: APR. 12  
Scale: 1:100