

**1** Proposed Aluminium Framed Sliding Door Jamb Detail  
 072 Scale: 1:2@A1

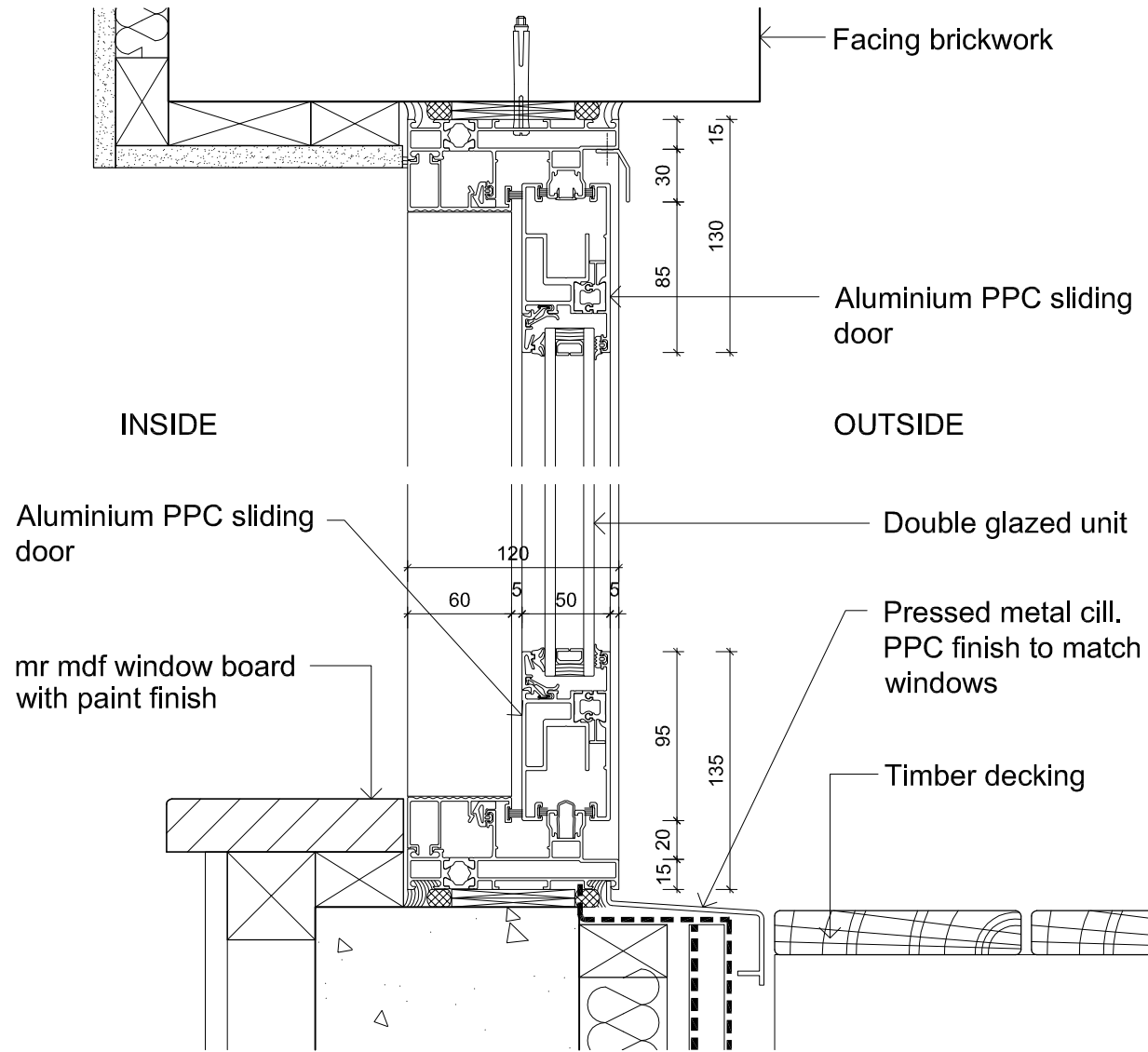

**2** Proposed Aluminium Framed Sliding Door Head & Cill Details  
 072 Scale: 1:2@A1

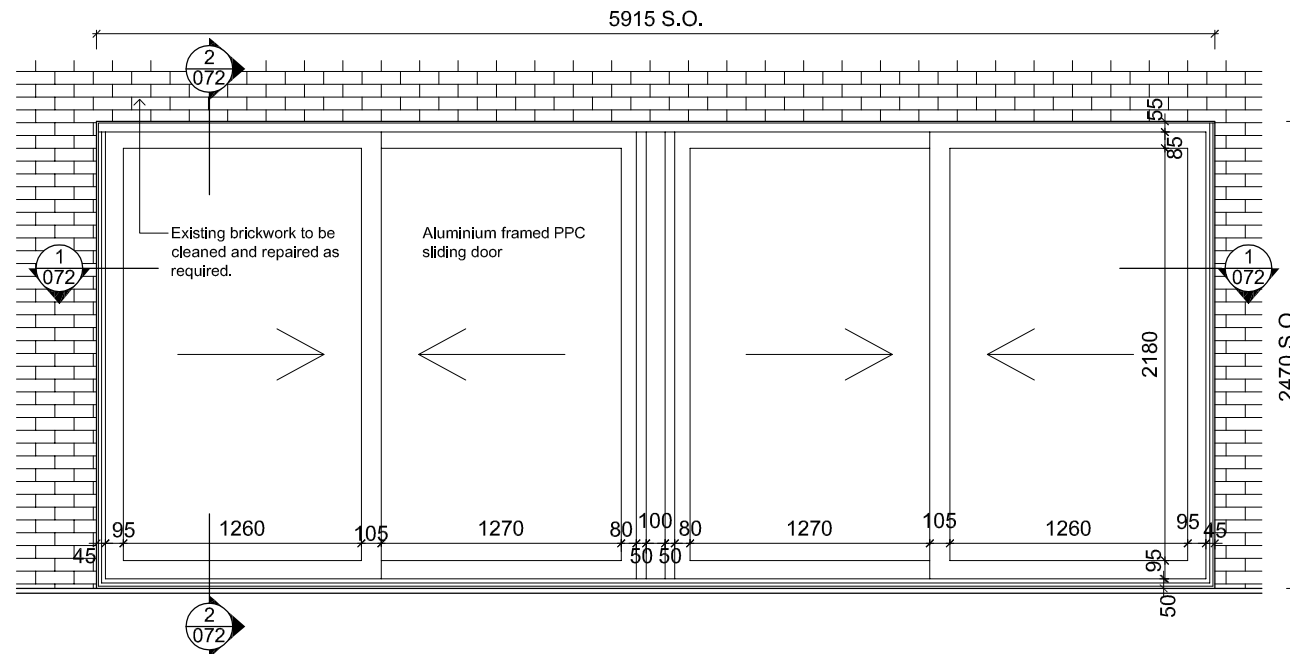

**3** Proposed Aluminium Framed Sliding Door Elevation 6th floor  
 072 Scale: 1:20@A1

**PLANNING APPLICATION**

23.06.2014	Issued for Planning	-
DATE	REVISION	NO.
<small>THIS DRAWING IS NOT TO BE SCALED. ONLY FIGURED DIMENSIONS ARE TO BE FOLLOWED (UNLESS THE DRAWING IS PART OF A PLANNING APPLICATION). CONTRACTORS ARE TO CHECK ALL DIMENSIONS BEFORE WORK COMMENCES, AND REFER ANY APPARENT DISCREPANCY TO THE ARCHITECT.          THIS DRAWING IS THE SOLE PROPERTY OF M.R PARTNERSHIP LIMITED, AND MAY NOT BE COPIED OR REPRODUCED IN ANY MANNER WHATSOEVER WITHOUT THE OWNERS WRITTEN CONSENT. (c) COPYRIGHT.</small>		
PROJECT	137 EUSTON ROAD LONDON NW1 2AA	
DRAWING	PROPOSED ALUMINIUM FRAMED SLIDING DOORS DETAILS - 6th FLOOR	
DATE:	APR 14	
DRAWN:		
SCALE:	41 FOLEY STREET TEL: (020) 7631 5405 LONDON W1W 7TS FAX: (020) 7631 5186	
DWG FILE:	DRAWING NUMBER: 2925072	REV. NO. <input type="checkbox"/>