

# Appendix 7.17: Bat Assessment of Kenwood Ladies' Changing Room

# BATS IN BUILDINGS RECORDING FORM

ATKINS

<b>LOCATION</b>	Ladies Bathing Changing Rooms	<b>SURVEYORS</b>	S. Boswell
<b>SITE NAME</b>	Hampstead Heath	<b>WEATHER CONDITIONS</b> (Note recent weather if known; e.g. recent heavy rain may wash away droppings)	100% cloud cover, 11°C, overcast, dry with light breeze
<b>DATE OF SURVEY</b>	27.03.14		

## BUILDING TYPE (circle choices where appropriate)

Residential building	Church	Barn	Warehouse	Farm building	Ruin	Mine
Cave	Tunnel	Other: Changing Room				

## EXTERNAL BUILDING DESCRIPTION (circle choices where appropriate)

<b>Age</b>	Est 1970's	<b>Roof type</b>	<u>Pitched</u> / Hipped / Flat
<b>Building fabric</b>	Cavity wall / Solid / <u>unsure</u>	<b>Cellar</b>	Yes / <u>No</u> / unsure
<b>External wall construction</b>	Brick / Stone / <u>Block</u> / Wood / Other (specify) =		
<b>Cladding</b>	None / Wood / Tile / Slate / <u>Other</u> (specify) concrete outer layer		
<b>Hanging tiles</b>	Yes / <u>No</u> If Yes, describe where:		
<b>Roof covering (external)</b>	Tile / Slate / Shingle / Stone / Thatch / Corrugated iron / Asbestos / <u>Other (specify)</u> Bitumen felt roofing Comment on condition: Generally good condition		
<b>Chimney(s)</b>	Yes / <u>No</u> - If Yes, state where and comment on condition:		
<b>Lead flashing present</b>	Yes / <u>No</u> If Yes, where:		
<b>Skylight/windows</b>	Yes / <u>No</u> If Yes, where:		
<b>Soffit / boxed eave</b>	Yes / <u>No</u>		

## SKETCH MAP OF BUILDING AND NOTES ON SURROUNDINGS

Map roof voids, numbering them and marking any that were not accessed internally. Describe habitats immediately surrounding structure, as well as wider landscape (stating if there are any woodlands, rivers, hedgerows and major roads nearby)

Pre-fab structure adjacent bathing pond with wooden soffits and fascias all round, bitumen felt roofing and bitumen lined internally

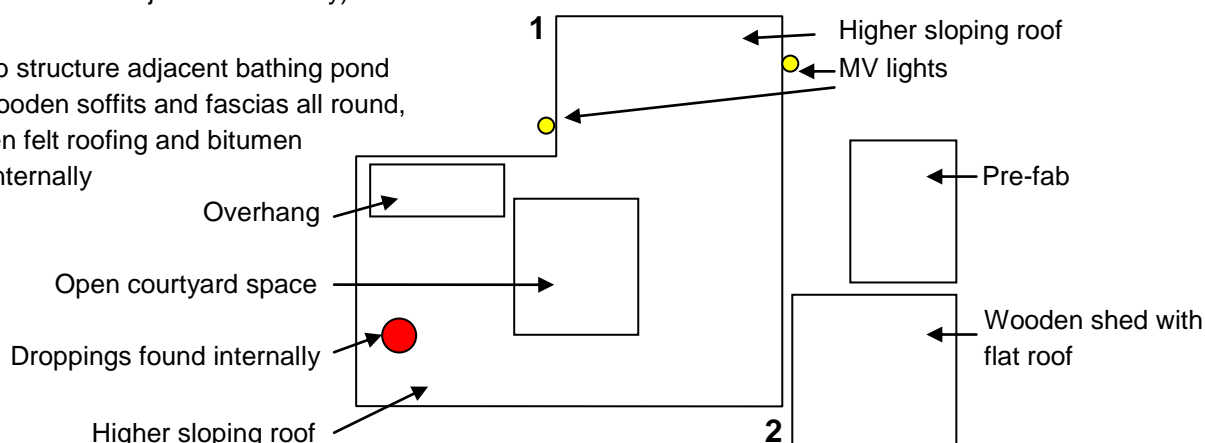

## EXTERNAL ASSESSMENT

Feature no.	Feature description <sup>1</sup> / Comments	Size (cm) of potential access points	Height of feature (m) & Orientation (eg NW)	Uncluttered drop zone (Y/N)	Photo Ref.
1	Small gap under bitumen	1 x 50 cm	2m N	Y	Ladies 1
2	Small gap where roof meets adjacent shed	20x5 cm	1.5m SE	Y	Ladies 2

<sup>1</sup> Example of features to think about / check: gaps under roof tiles/felt, loose flashing, cavity in wall, grille or air brick, access to soffit box, gap between door / window frame and brick work. **Remember to check window sills for droppings!**

***Fill in one sheet per roof void inspected***

**INTERNAL ASSESSMENT** *(circle choices where appropriate)*

**Dynamic risk assessment before entering each void:** update to written R.A. needed? Y / N

<b>Roof Lining</b>	Wood framed, plywood with breeze blocks				
<b>Insulation</b>	Roof insulation (between rafters) Y / <u>N</u> Floor insulation Y / <u>N</u> (if yes, specify if fibreglass or vermiculite)				
<b>Internal conditions</b>	Temperature (°C) and humidity (%) inside void = 15°C				
<b>Height (floor to ridge beam)</b>	Roof 1m at highest point	<b>Width (m)</b>		<b>Length (m)</b>	
<b>Evidence indicating use by bats</b>					
<b>Droppings</b>	Concentrated / Scattered <u>Old</u> / fresh / mixture of both Quantity:	<b>Describe size and shape</b>	Only 2 located, almost completely disintegrated. Possibly long-eared type.		
<b>Sample(s) taken for DNA analysis</b>	Y / <u>N</u> (remember to note location of sample taken) Droppings heavily degraded				
<b>Feeding remains</b>	Y / <u>N</u> (if Yes describe)				
<b>Bats in-situ</b>	Y / <u>N</u>				
<b>Staining/scratch marks</b>	Y / <u>N</u> (if Yes say where)	<b>Smooth / clean surfaces</b>	Y / N (if Yes say where)		
<b>Likely species (based on evidence found)</b>	Possible long-eared bat.				
<b>Further comments / sketch</b>	<i>(e.g. location of any droppings, access points with daylight visible, presence of open water tank, nesting bird material, wasp's nest, cobwebs etc)</i>  See Sketch Map above.				

**RECOMMENDATIONS BASED ON THIS INTERNAL & EXTERNAL BUILDING ASSESSMENT**

<b>OVERALL BAT ROOSTING POTENTIAL</b> <i>(circle choice)</i>	<b>NEGLIGIBLE</b>	<b>LOW</b>	<b>MODERATE</b>	<b>HIGH</b>	<b><u>CONFIRMED ROOST</u></b>
<b><i>If Confirmed Roost, a licenced surveyor will be required for any future internal checks</i></b>					
<b>Additional surveys required</b>	<u>YES</u>		NO		
<b>Number of surveys recommended &amp; timing</b>	Two surveys to be undertaken between May and August				
<b>Number of surveyors needed to cover building for emergence/re-entry surveys</b>	Two surveyors required				