

# Appendix 7.18: Bat Assessment of Toilet Block

# BATS IN BUILDINGS RECORDING FORM

ATKINS

LOCATION	Toilet Block off Millfield Lane	SURVEYORS	R. Chilcott
SITE NAME	Hampstead Heath	WEATHER CONDITIONS (Note recent weather if known; e.g. recent heavy rain may wash away droppings)	80% cloud cover, 15°C, still with rain earlier in the day
DATE OF SURVEY	28.03.14		

## BUILDING TYPE (circle choices where appropriate)

Residential building	Church	Barn	Warehouse	Farm building	Ruin	Mine
Cave	Tunnel	Other: Toilet Block				

## EXTERNAL BUILDING DESCRIPTION (circle choices where appropriate)

Age	Est 1980's	Roof type	Pitched / Hipped / <u>Flat</u>
Building fabric	Cavity wall / Solid / <u>unsure</u>	Cellar	Yes / <u>No</u> / unsure
External wall construction	<u>Brick</u> / Stone / Block / Wood / Other (specify)		
Cladding	<u>None</u> / Wood / Tile / Slate / Other (specify)		
Hanging tiles	Yes / <u>No</u> If Yes, describe where:		
Roof covering (external)	Tile / Slate / Shingle / Stone / Thatch / Corrugated iron / Asbestos / Other (specify) Comment on condition: Felt, good condition		
Chimney(s)	Yes / <u>No</u> - If Yes, state where and comment on condition:		
Lead flashing present	Yes / <u>No</u> If Yes, where:		
Skylight/windows	<u>Yes</u> / No If Yes, where: On all aspects		
Soffit / boxed eave	<u>Yes</u> / No		

## SKETCH MAP OF BUILDING AND NOTES ON SURROUNDINGS

Map roof voids, numbering them and marking any that were not accessed internally. Describe habitats immediately surrounding structure, as well as wider landscape (stating if there are any woodlands, rivers, hedgerows and major roads nearby)

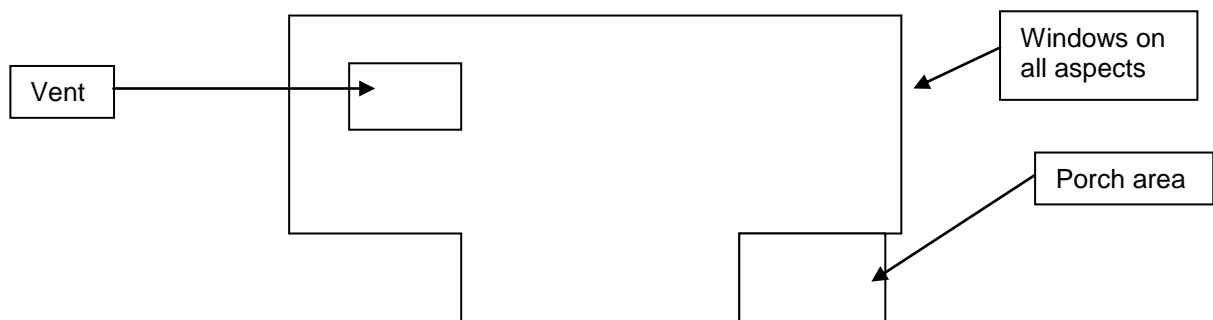

Building surrounded by areas of amenity grassland, ponds, woodland blocks and mature trees.

## EXTERNAL ASSESSMENT

[illegible]

<sup>1</sup> Example of features to think about / check: gaps under roof tiles/felt, loose flashing, cavity in wall, grille or air brick, access to soffit box, gap between door / window frame and brick work. **Remember to check window sills for droppings!**

***Fill in one sheet per roof void inspected***

**INTERNAL ASSESSMENT** *(circle choices where appropriate)*

**Dynamic risk assessment before entering each void: update to written R.A. needed? Y / N**

<b>Roof Lining</b>	Bitumen felt / sarking boards / roofing membrane – Flat roof no roof void present				
<b>Insulation</b>	Roof insulation (between rafters) Y / N Floor insulation Y / N (if yes, specify if fibreglass or vermiculite)				
<b>Internal conditions</b>	Temperature (°C) and humidity (%) inside void =				
<b>Height (floor to ridge beam)</b>		<b>Width (m)</b>		<b>Length (m)</b>	
<b>Evidence indicating use by bats</b>					
<b>Droppings</b>	Concentrated / Scattered Old / fresh / mixture of both Quantity:		<b>Describe size and shape</b>		
<b>Sample(s) taken for DNA analysis</b>	Y / N (remember to note location of sample taken)				
<b>Feeding remains</b>	Y / N (if Yes describe)				
<b>Bats in-situ</b>	Y / N				
<b>Staining/scratch marks</b>	Y / N (if Yes say where)		<b>Smooth / clean surfaces</b>	Y / N (if Yes say where)	
<b>Likely species (based on evidence found)</b>					
<b>Further comments / sketch</b>	<i>(e.g. location of any droppings, access points with daylight visible, presence of open water tank, nesting bird material, wasp's nest, cobwebs etc)</i>				

**RECOMMENDATIONS BASED ON THIS INTERNAL & EXTERNAL BUILDING ASSESSMENT**

<b>OVERALL BAT ROOSTING POTENTIAL</b> <i>(circle choice)</i>	<b>NEGLIGIBLE</b>	<b>LOW</b>	<b>MODERATE</b>	<b>HIGH</b>	<b>CONFIRMED ROOST</b>
<b><i>If Confirmed Roost, a licenced surveyor will be required for any future internal checks</i></b>					
<b>Additional surveys required</b>	YES		NO		
<b>Number of surveys recommended &amp; timing</b>					
<b>Number of surveyors needed to cover building for emergence/re-entry surveys</b>					