

7-9 POND STREET NW3 - PROPOSALS

1:50 @ A2

Areas/items for removal shown dotted in blue

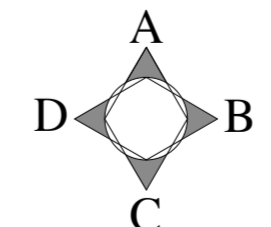
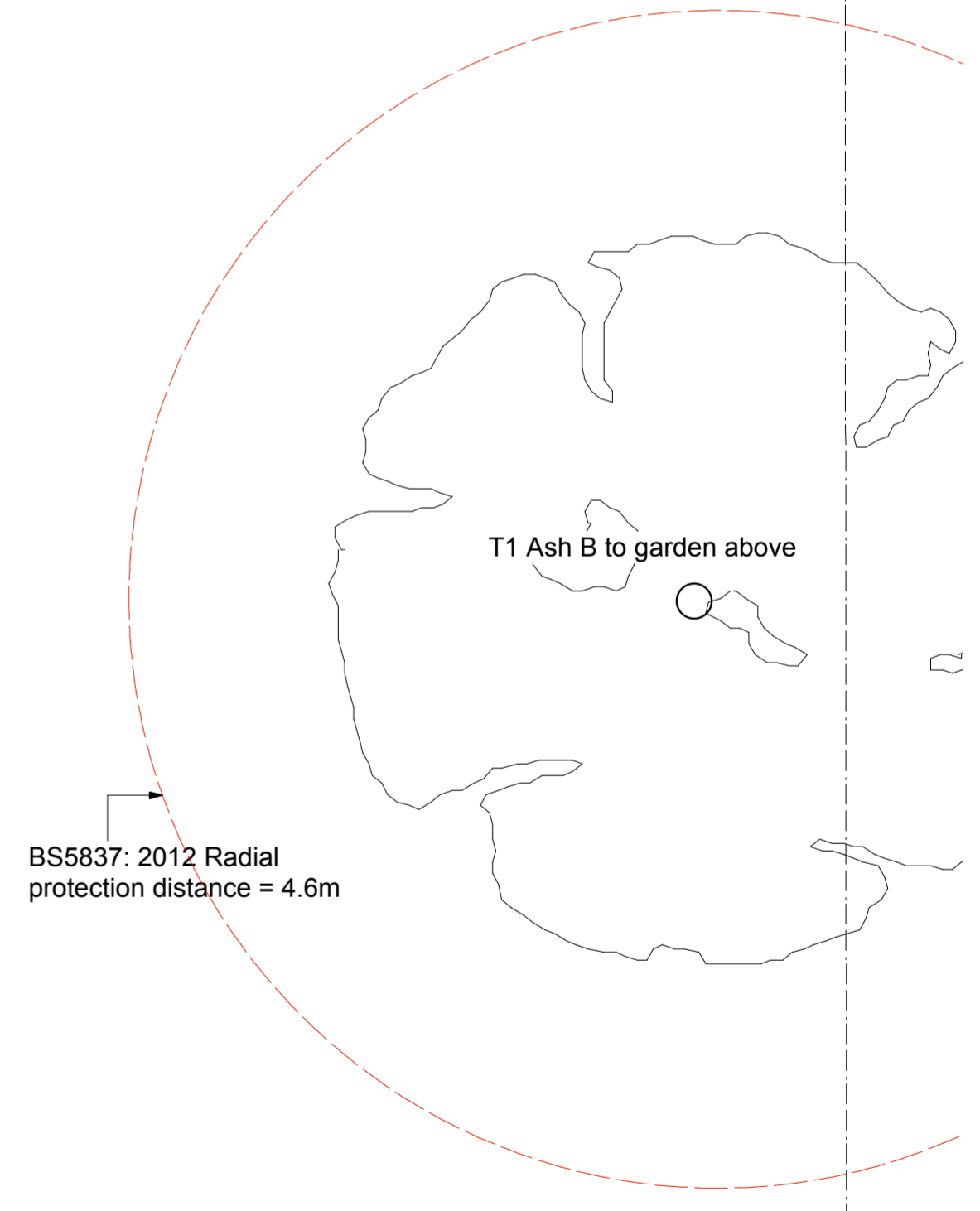
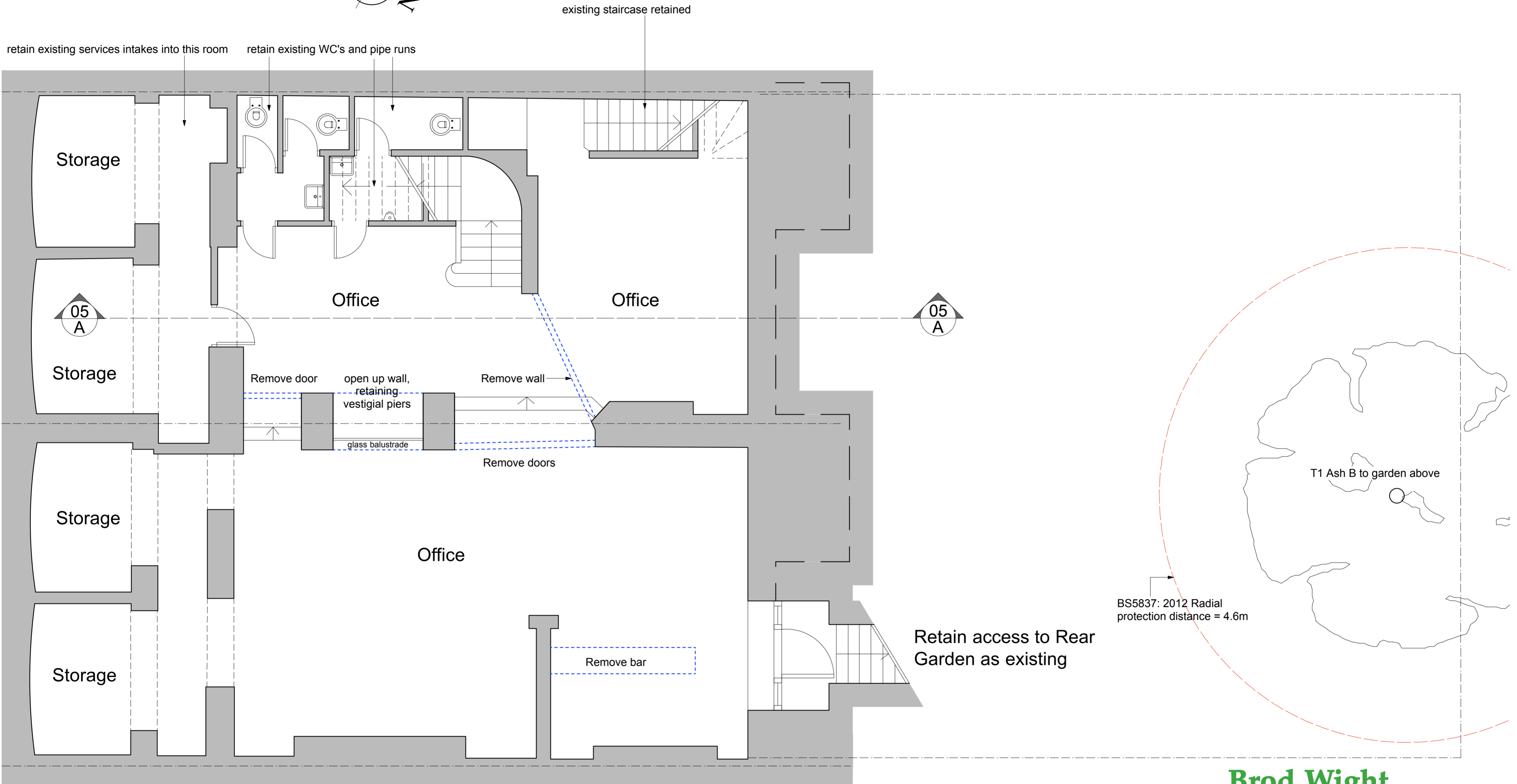
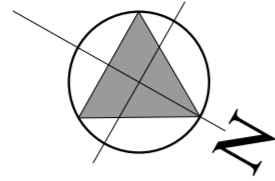
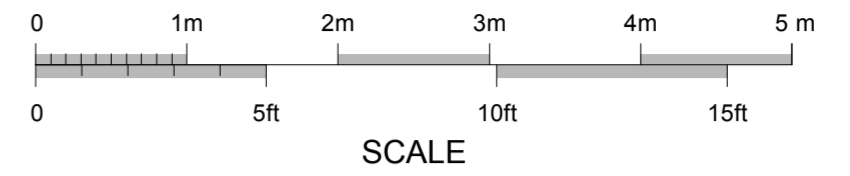

KEY TO INTERNAL ELEVATIONS

Brod Wight
ARCHITECTS

TEL 020 7722 0810 FAX 020 7722 0939 E MAIL office@brodwight.co.uk WEB www.brodwight.co.uk
75 Haverstock Hill London NW3 4SL

7/9 POND STREET, LONDON NW3
BASEMENT PLAN - PROPOSALS

1036-AP1-01

Date May 2014 Scale 1:50@A2 This drawing is copyright

Revisions