

Notes
Do not scale from this drawing.
All dimensions are to be checked on site and any discrepancies noted in writing to the Project Manager.
All dimensions are in millimeters unless noted otherwise.

Rev.	Date	Description	Drawn	Checked
-	14.05.13	Construction Issue	JMP	JMP
01	08.07.14	Construction Issue	JMP	JMP

KEY
All existing floor finishes and skirtings for removal to be carefully removed, substrate to be made good, primed and prepared suitable for new floor finish, and all to be installed in accordance with manufacturer instructions, New FFLs to match existing FFLs unless specified.

- FLOOR FINISHES:
- Existing floor finish. To match existing condition prior to works
 - New floor finish to match existing. Contractor to agree with architect and sample to be agreed. Skirtings to match existing as required
 - Existing vinyl and (assumed) terrazzo substrate removed and substrate made good and prepared as required for application of new floor finish, as Forbo Maroleum Concrete, colour as '18R 3709, Pattern as indicated on drawings, set out to be agreed with architect.
 - Existing vinyl and (assumed) terrazzo substrate removed and substrate made good and prepared as required for application of new 75mm width profiled strip, as Forbo Maroleum Concrete, colour as 'black edge' 3707, Pattern as indicated on drawings, set out to be agreed with architect.
 - Newway Connected 22mm entrance mat by Forbo. In brass. to be 'handle only closed', colour 'Anthracite'. Sample to be approved by architect. Mat to be recessed in new material to be level with floor finish level. New material formed with Gradus FRB22 20 x 31 x 5mm brass trim to match existing detail
 - Existing carpet to be removed and substrate to be made good and prepared as required for new Forbo 600x600mm Tessera Arran carpet tiles in Olive (to match carpet specification in offices above)
 - 20mm plyboard. In place of oak, with floor make up to match main floor. Painted black in suitable grade for heavy use. FFL of storage areas, under-sealing cavities and LMH to be level
 - New screed floor finish (as required) with white painted finish. Paint to be suitable grade for heavy duty use
 - 20mm engineered oak flooring to be DP EUR Oak 20 x 180 Serenity Colour Line or similar approved with 6mm solid oak top layer bonded to tongue and groove plyboard. Sample to be supplied by joinery specialist and agreed with architect. Flooring on 6mm hardboard fixed to 18mm plyboard on 25x50mm timber joists at 400mm centres with 100mm batt insulation on clips between joists - refer to structural engineer drawings for structure
 - 20mm engineered oak flooring to be DP EUR Oak 20 x 180 Serenity Colour Line or similar approved with 6mm solid oak top layer bonded to tongue and groove plyboard. Sample to be supplied by joinery specialist and agreed with architect. Flooring on 6mm hardboard fixed to 18mm plyboard on 75x50mm timber joists at 400mm centres with 50mm batt insulation on clips between joists - refer to structural engineer drawings for structure
 - Existing tiles removed and substrate made good and prepared as required for application of new vinyl flooring, as 2mm vinyl floor finish, as Forbo Surestep R11, colour - 82252
 - Existing tiles removed and substrate levelled as required for new 2mm vinyl floor finish, as Forbo Surestep original, colour - 171252 matk.
 - Steel grid deck to roof void.
- TRIMS:
- Joint between existing and new floor finish at door thresholds to be formed with Gradus FT3030327 6.5 x 22.5mm brass floor trim or similar approved
 - Joint between floor finishes to be formed with Gradus TP290CH1 14 x 8mm brass floor trim - to be confirmed by sealing subcontractor to be suitable for rolling wagons over and heavy use
 - Joint under door threshold to be formed with Gradus Clep-Top FX AF73312 for expansion seal and housing for Gradus Clep-Top FX FX121 Black (22mm) to allow 3mm rise over FFL to maintain acoustic seal at door threshold
- SKIRTINGS:
- SK01 - Existing skirting retained and floor finished to walls to match existing
 - SK02 - 100mm vinyl skirting using Forbo PR vinyl coving strip with 10mm shadow gap
 - SK03 - 150mm surface mounted 15mm MDF skirting finished in eggshell white
 - SK04 - 150mm flush mounted 15mm MDF skirting on 15mm plywood backing as required finished in eggshell white with 10mm shadow gap to wall finish above formed with proprietary trim as required
 - SK05 - 175mm flush mounted 20mm oak skirting to match floor finish and batten paneling finish. fixed to frame with 10mm shadow gap at junction with floor and with wall finish and 3mm chamfered edges - sample to be agreed
 - SK06 - 200mm flush mounted 15mm MDF skirting on 15mm plywood backing as required finished in eggshell white with 10mm shadow gap to wall finish above formed with proprietary trim as required
 - SK07 - 200mm surface mounted 15mm MDF skirting finished in eggshell white
 - SK08 - Forbo proprietary Cove skirting to match floor finish and sealed to wall finish
 - SK09 - New skirting to match existing. Contractor to agree proposals with architect
 - SK10 - 100mm vinyl skirting using Forbo PR vinyl coving strip

ENDSLEIGH GARDENS

2130 2130

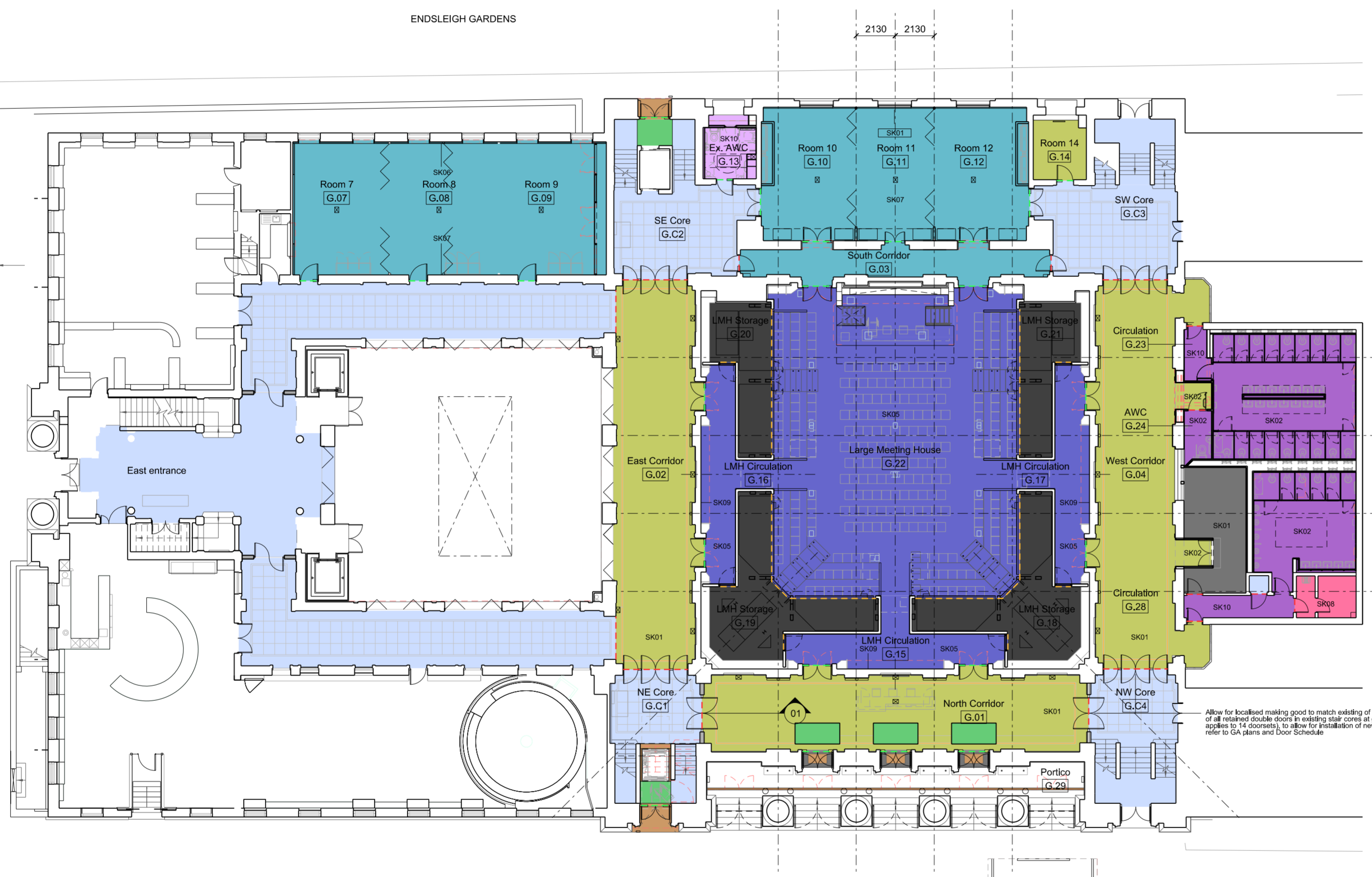

Allow for localised making good to match existing of existing floor finish at base of all retained double doors in existing stair cores at ground and first (assume applies to 14 doors), to allow for installation of new floor covers as specified - refer to GA plans and Door Schedule

EUSTON ROAD

Skirting Details 1:5

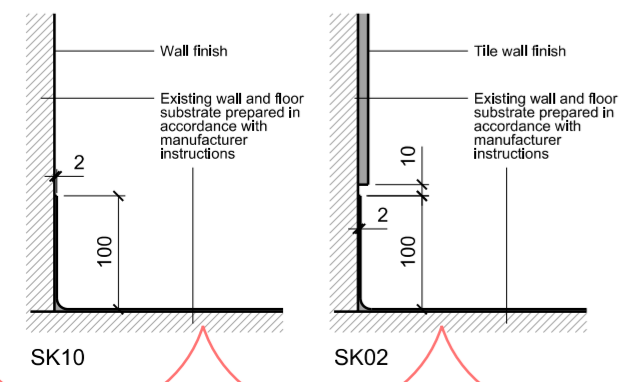

JOHN MCASLAN + PARTNERS
 7-9 William Road
 London NW1 3ER
 T +44 (0)20 7313 6000
 F +44 (0)20 7313 6001
 www.mcaslan.co.uk

Architect
 Landscape

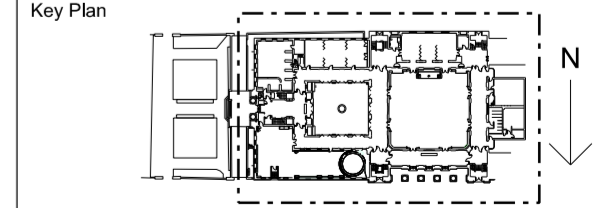

Friends House, 173 Euston Road.
 Ground Floor Plan - Floor Finishes
 Proposed

Scale at A2:	1:200	Job Number:	1371
Date:	04/09/12	Drawing:	JMP
Status:	CONSTRUCTION	Checked:	JMP
Drawing No:	1371-G331-P-00	Revision:	01