

28 LOVERIDGE ROAD

THIS DRAWING IS TO BE READ IN CONJUNCTION WITH ALL OTHER PLANNING APPLICATION DRAWINGS & DOCUMENTATION, AND IS TO BE USED FOR PLANNING APPLICATION PURPOSES ONLY

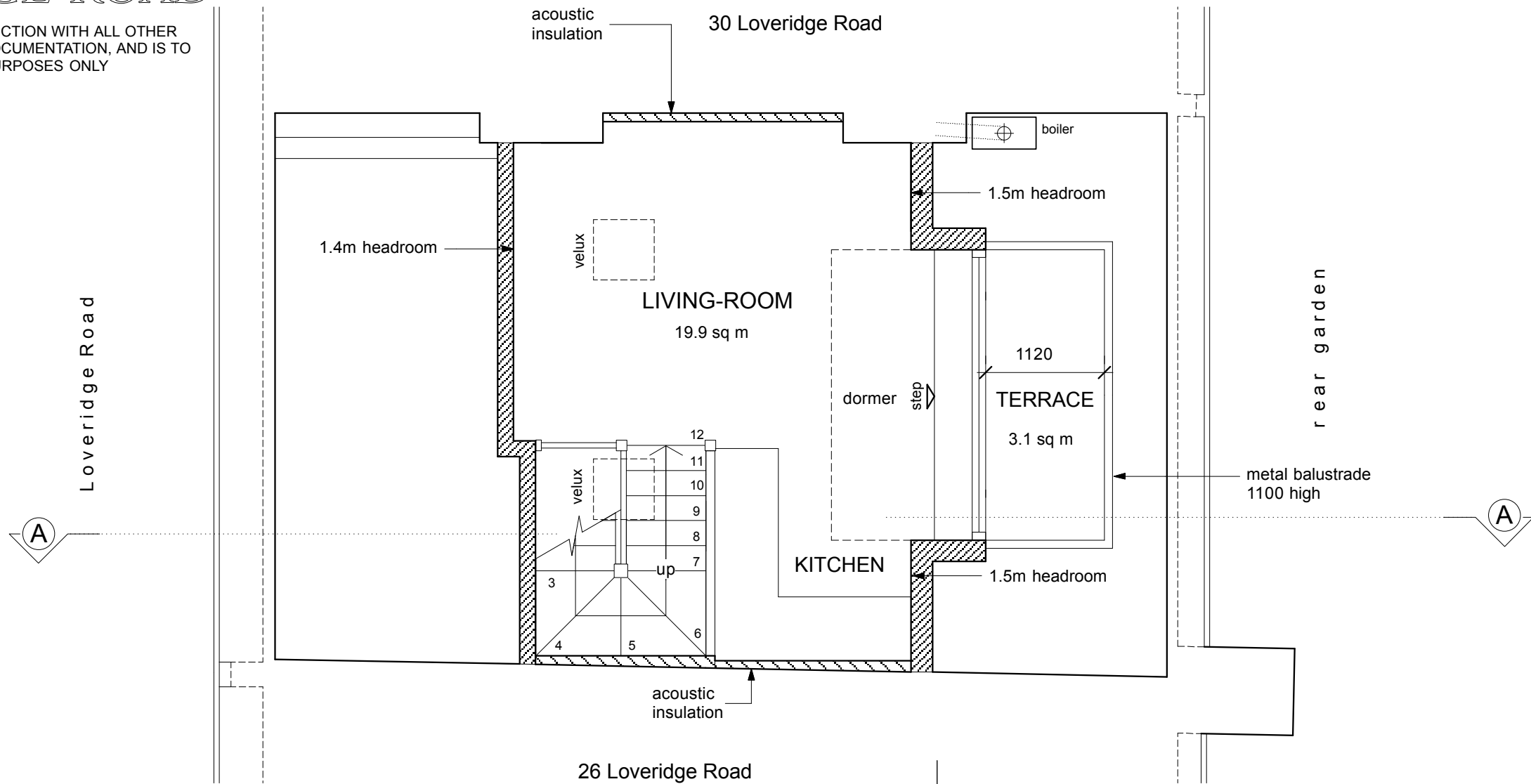

LOFT PLAN - PROPOSED
FLAT 3 UPPER FLOOR

19.9 sq m + 32.7 sq m (lower floor) - 53.75 sq m total

SCHEDULE OF ACCOMMODATION		TOTAL AREA	ROOM FLOOR AREAS 1 sq m = 10.764 sq ft			
FLAT NUMBER	TYPE	sq m including storage	LIVING/ KITCHEN	BED 1	BED 2	STUDY
1	2P 1-bedroom garden flat Part M compliant - ambulant 1 bathroom	55.25	14.8	12.2	-----	9.1
2	2P 1-bedroom balcony flat 1 bathroom	45.40	19.85	8.3	-----	6.9
3	3P 2-bedroom twin balcony flat 2 bathrooms	53.75	19.90	8.2	8.45	-----
Existing house floor area (internal area) is 150.20 sq m			Existing site area (net) is 179 sq m			

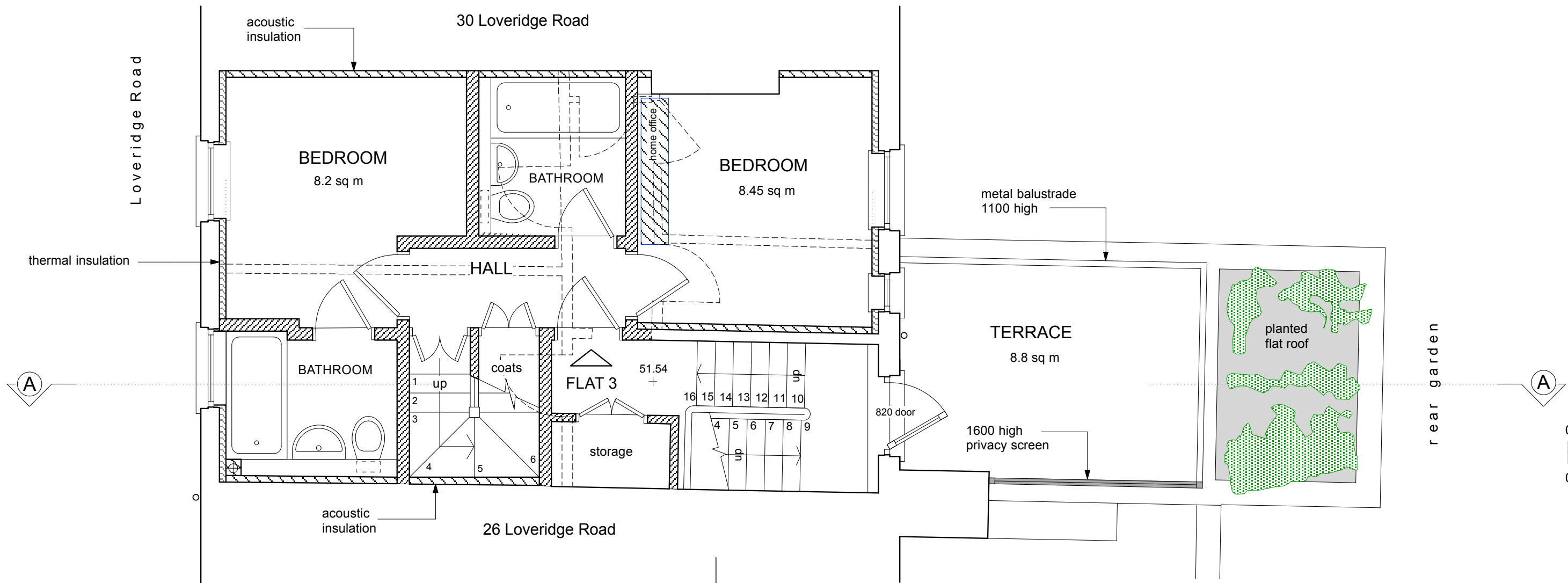

SECOND FLOOR PLAN - PROPOSED
FLAT 3 - 2-BEDROOM FLAT - LOWER FLOOR

32.7 sq m + 19.9 sq m (upper floor) - 53.75 sq m total

new (insulated) construction

acoustic insulation
Part E - Building Regulations

thermal insulation
Part L - Building Regulations

1.8m free wall space
for home office use -
including two double
sockets and double
phone points

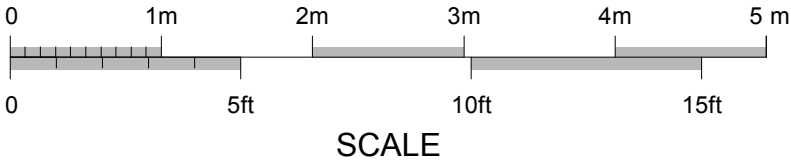

Brod Wight
ARCHITECTS

TEL 020 7722 0810 FAX 020 7722 0939 E MAIL office@brodwight.co.uk WEB www.brodwight.co.uk
75 Haverstock Hill London NW3 4SL

28 LOVERIDGE ROAD - LONDON NW6 - CONVERSION TO FLATS
SECOND FLOOR & LOFT PLANS - PROPOSED **1035AP1-02**

Date July 2104 Scale 1:50 (A2) This drawing is copyright Revisions

A2-size drawing
1:50 scale