

Drawing Number
SOU/129178/ECV/DRG/IAB/GOJ5/101

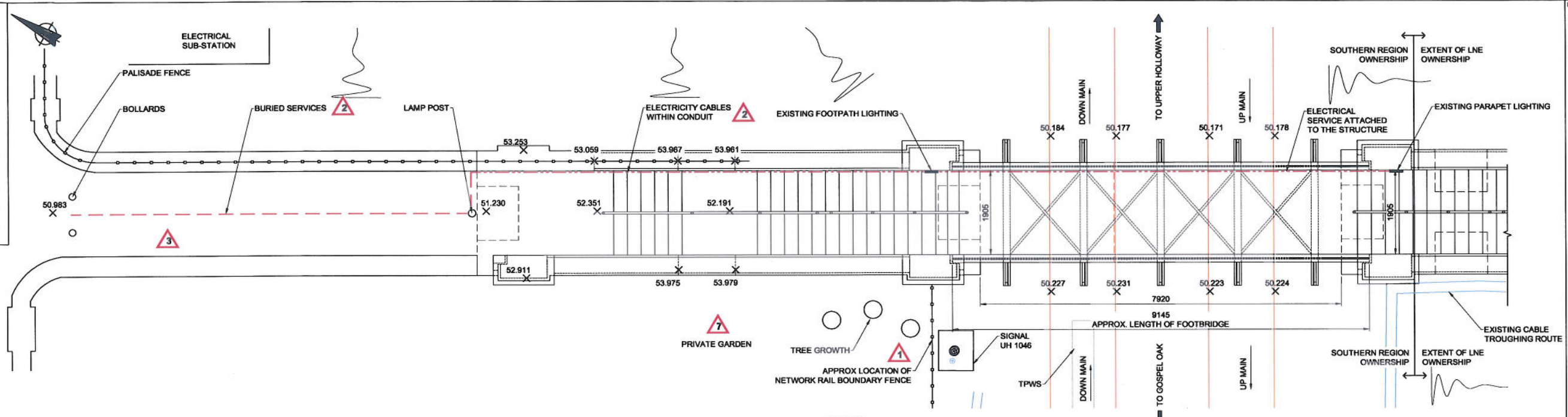

PLAN
SCALE 1:50

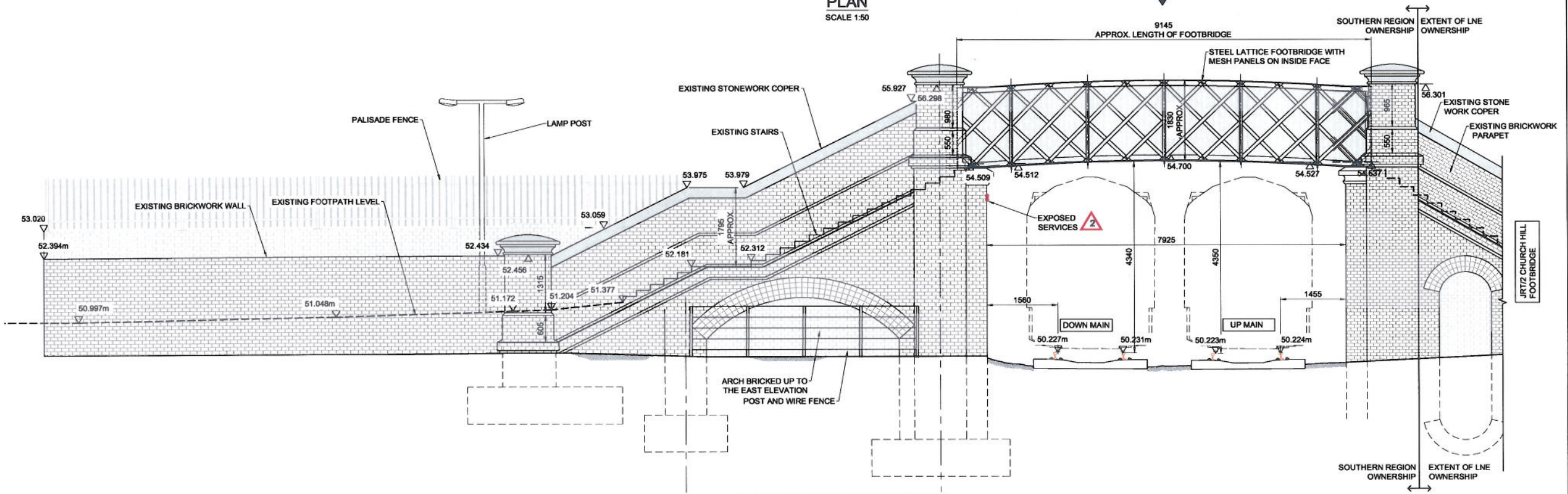

EXISTING WEST ELEVATION
(EAST ELEVATION SIMILAR BUT HANDED)
SCALE 1:50

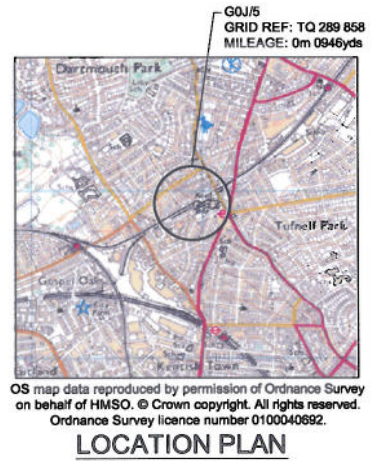

LOCATION PLAN

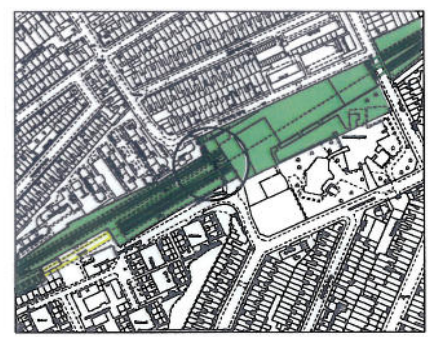

PLAN SHOWING NETWORK RAIL OWNERSHIP



PHOTO OF FOOTBRIDGE

- Legend/Notes**
- ALL DIMENSIONS ARE IN MILLIMETRES UNLESS STATED OTHERWISE.
 - DO NOT SCALE FROM THIS DRAWING.
 - THIS DRAWING IS BASED ON AVAILABLE NETWORK RAIL RECORD INFORMATION AND A TOPOGRAPHICAL SURVEY UNDERTAKEN BY BRIDGEWAYS LTD. ON 20/03/14.

- SCOPE OF WORKS**
- INSTALL NEW FOOTBRIDGE.
 - INFILL BRICK ARCH.
 - UNDERTAKE BRICKWORK REPAIRS.
 - AMEND APPROACH STAIRS.

- DOCUMENT LIST**
- SOU-129178-ECV-DRG-IAB-GOJ/5:
- 101 - EXISTING GENERAL ARRANGEMENT.
 - 102 - PROPOSED GENERAL ARRANGEMENT.
 - 103 - BRICKWORK REPAIRS

- SITE HAZARDS**
- WORKING IN A RAILWAY ENVIRONMENT.
 - BURIED AND EXPOSED SERVICES.
 - PEDESTRIAN TRAFFIC/INTERFACE.
 - SHARPS AND NEEDLES.
 - STEEP EMBANKMENTS.
 - ADJACENT SCHOOL PROPERTY.
 - RESIDENTIAL AREA.

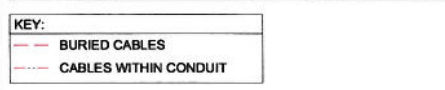

Rev	Date	Description of Revisions	Drawn	Chkd	Appr
A01	28/03/14	FIRST ISSUE	KH	RJ	RES

Status: F-001 APPROVAL IN PRINCIPLE

Designers
Infrastructure Projects
Buildings & Civils
Civils Design Group
Manchester
Square One
4 Travis Street
Manchester
M1 2NY
Tel: 0161 880 3936



Project: GOSPEL OAK - BARKING ELECTRIFICATION GOJ/5

Drawing Title: EXISTING GENERAL ARRANGEMENT

Designer	R. JAKEMAN	Signed	<i>[Signature]</i>	Date	23/3/14
Drawn	K. HODSON	Signed	<i>[Signature]</i>	Date	23/3/14
Checked	R. E. STANDRING	Signed	<i>[Signature]</i>	Date	23/3/14
Approved	R. E. STANDRING	Signed	<i>[Signature]</i>	Date	23/3/14

Scale(s) at A1 Sheet Size A1 594 x 841
ELR : GOJ 0m 0946yds
Drawing Number: SOU/129178/ECV/DRG/IAB/GOJ5/101
Revision: A01