

The trees vary in species, size, age, and landscape importance. All trees have been categorised in accordance with the British Standard Guide for trees in relation to design, demolition and construction BS 5837: 2012.

BS Categories have been entered in the tree schedule and are as follows:

- A - Trees whose retention is most desirable High Category
B - Trees whose retention is desirable Moderate Category
C - Trees, which would not usually be retained where they would impose a significant constraint on development Low Category
U- Trees for removal Fell Category

Root protection areas (RPAs) have been calculated using BS 5837:2012 Trees in Relation to Construction. The RPAs have been adjusted in shape to take into account the existing or past site conditions such as the presence of roads, structures and underground services. The trunk diameter circle shows the BS Category in the following colours:

- High Category (A) Light Green
Moderate Category (B) Mid Blue
Low Category (C) Grey
Fell Category (U) Red

BS Classification of Trees

Tree Grade	BS5837:2005	Number
A	High	
B	Moderate	5
C	Low	8
R	Fell	1
	total	14

Species Diversity

Species	Number
Lime	2
Bay Laurel	1
Ornamental Apple	1
Laburnum	1
Magnolia	3
Common Ash	1
Himalayan Birch	2
Purple Leaf Plum	2
Horse Chestnut	1
	14

Age Distribution

Tree Age	Number
Young	
Middle Aged	8
Mature	6
	14

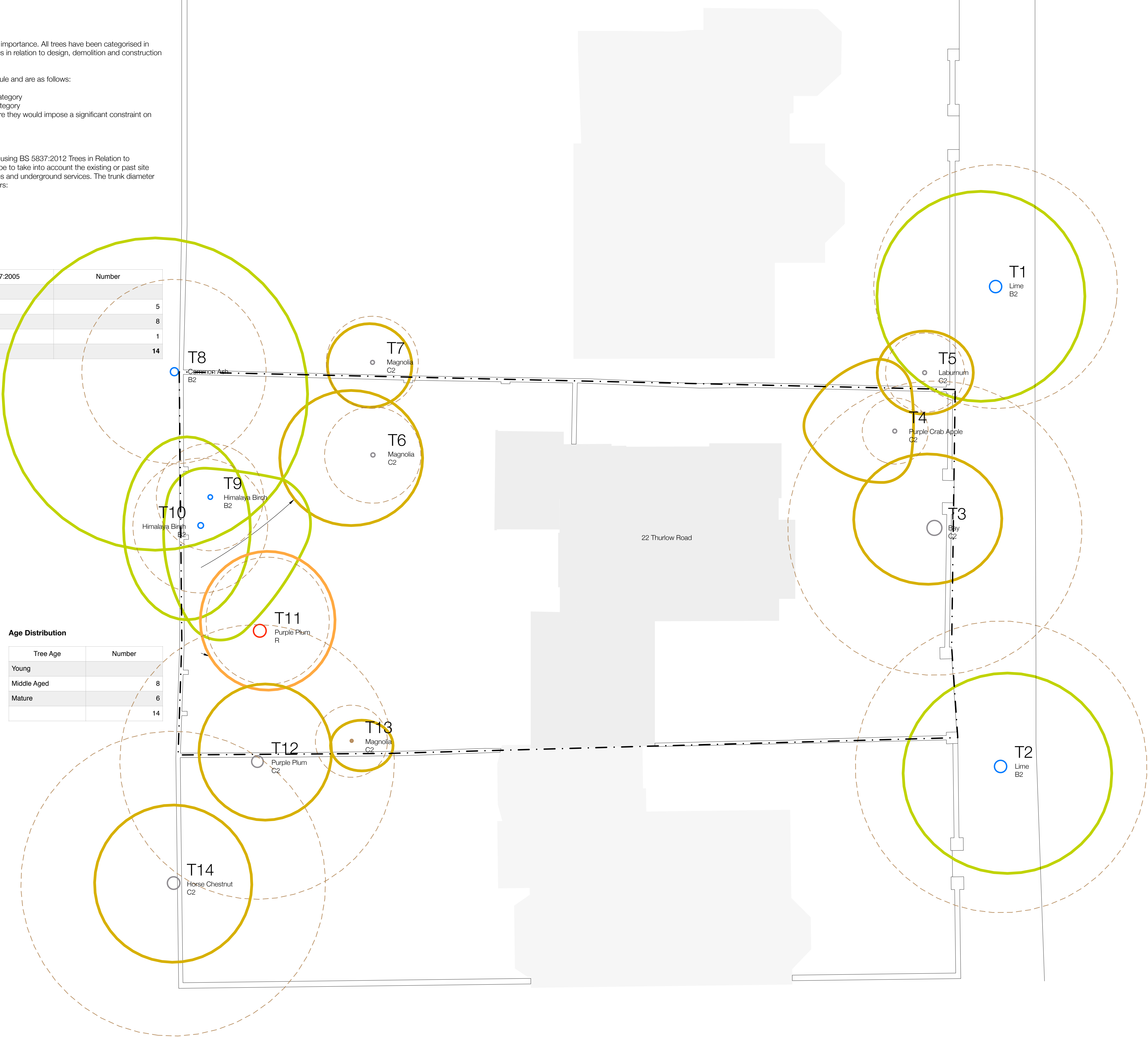

NOTES

- © This drawing copyright Barnaby Gunning 2013
Do not scale from this drawing.
Dimensions to be verified on site prior to construction.
Unless otherwise indicated, all dimensions are in millimetres.

KEY

- Canopy outline C
Canopy outline B
Canopy outline A
Canopy outline U

- Trunk Diameter C
Trunk Diameter B
Trunk Diameter A
Trunk Diameter U

- Root Protection Area (RPA)

revision description date

63 Loudoun Rd, London NW8 0DQ, UK
+44 20 73 72 24 24
bamabygunning.com

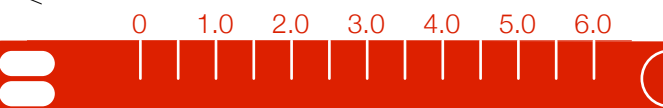

Architect
Barnaby Gunning
drawing no: 266_G_024 revision: B
date: 14 July 2014
site address: 22 Thurlow Road
London
NW3 5PP
title: Tree Constraints Plan
scale: 1:100@A1
purpose: PLANNING