

General Demolition Notes

1. Where walls / ceilings / floors demolished and doors / windows stripped out the contractor is to ensure all adjoining areas of structure are made good in preparation for new finishes / linings / structural elements etc.
2. Where Skirting / Architrave / Picture Rails / Doors / Windows are to be removed, Contractor is to retain samples of all types and mark original location in preparation for supply of new.

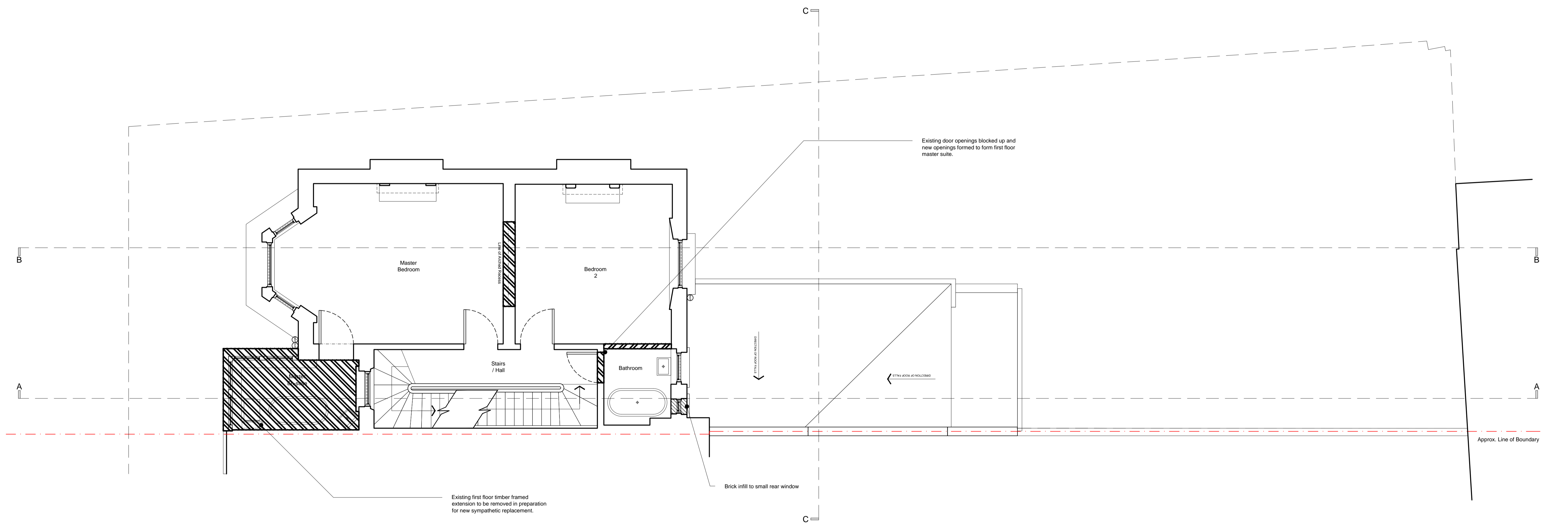

- Hatch thus denotes area to be excavated
- Hatch thus denotes area to be demolished

rev.	date	description	revised by
B	2014.07.03	Demolition notes and areas adjusted	CT
A	2014.04.09	Submitted for Planning Approval.	MR

stage	Planning	drawing title	Existing Demolitions First Floor Plan
-------	----------	---------------	---

Lipton Plant Architects

Seatem House
39 Moreland Street
London
EC2V 8BB

T +44 (0)20 7288 1333
E mail@lpaarchitects.co.uk
W www.lpaarchitects.co.uk

client
Mr Chris Clothier
and
Ms Mary Douglas-Home

project
48 Lady Margaret Road
London
NW5 2NR

scale	1:50 @ A1 1:100 @ A3	date issued	2014.03.31	drawn by	MR	drawing no	348.(1).0.003	revision	B
-------	-------------------------	-------------	------------	----------	----	------------	---------------	----------	----------