

**ARGENT ST GEORGE,
LCR AND EXEL**

**KING'S CROSS
CENTRAL
ILLUSTRATIVE
HIGHWAY PROPOSALS**

**DRAWING ALBUM
April 2004**

CONTENTS

<i>Drawing Number</i>	<i>Issue</i>	<i>Drawing Title</i>
7102	02	OPTION 1 [Non-Tram] HIGHWAY LAND
7105	03	OPTION 1 [Non-Tram] FRONTAGE PLAN
7111	06	OPTION 1 [Non-Tram] HIGHWAY LAYOUT YORK WAY [NORTH]
7112	06	OPTION 1 [Non-Tram] HIGHWAY LAYOUT YORK WAY [SOUTH]
7113	06	OPTION 1 [Non-Tram] HIGHWAY LAYOUT GOODS WAY
7131	02	OPTION 1 [Non-Tram] LONGSECTION GOODS WAY
7141	02	OPTION 1 [Non-Tram] CROSS SECTIONS GOODS WAY
7202	02	OPTION 2 [Tram] HIGHWAY LAND
7205	03	OPTION 2 [Tram] FRONTAGE PLAN
7211	05	OPTION 2 [Tram] HIGHWAY LAYOUT YORK WAY [NORTH]
7212	05	OPTION 2 [Tram] HIGHWAY LAYOUT YORK WAY [SOUTH]
7213	05	OPTION 2 [Tram] HIGHWAY LAYOUT GOODS WAY
7411	02	OPTION P1 [Prior to KX Station Enhancement] HIGHWAY LAYOUT PANCRAS ROAD [NORTH]
7412	02	OPTION P1 [Prior to KX Station Enhancement] HIGHWAY LAYOUT PANCRAS ROAD [SOUTH]
7311	03	OPTION P2 [With KX Station Enhancement] HIGHWAY LAYOUT PANCRAS ROAD [NORTH]
7312	03	OPTION P2 [With KX Station Enhancement] HIGHWAY LAYOUT PANCRAS ROAD [SOUTH]

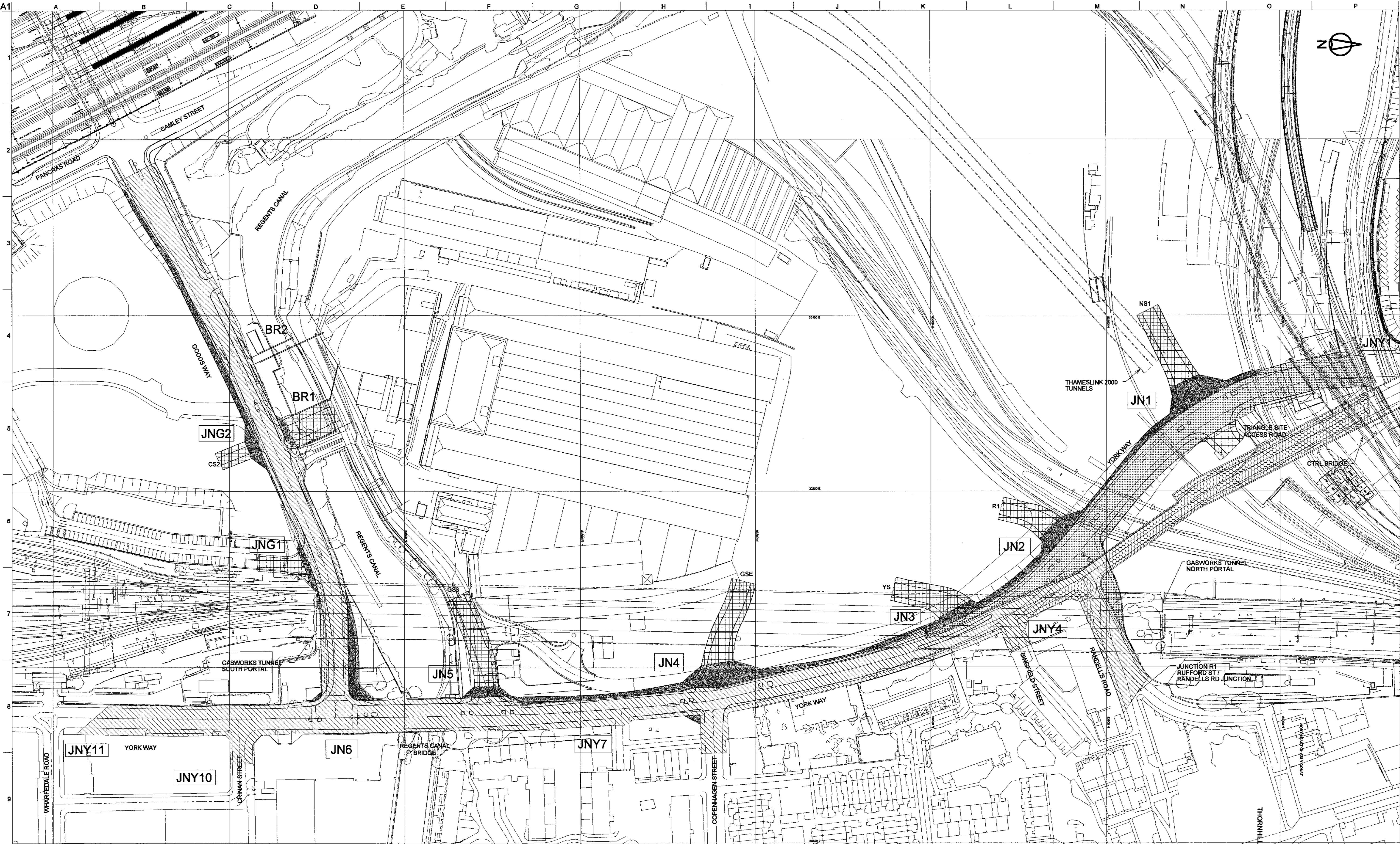

NOTES:
 1. CO-ORDINATES ARE TO TRUNCATED ORDNANCE SURVEY.
 2. THE DRAWING INCORPORATES THE ANTICIPATED YEAR 2007 (BASE YEAR) TOPOGRAPHICAL MAPPING.

KEY:

	BASE YEAR MAPPING AT 2007
	EXISTING HIGHWAY TO REMAIN
	HIGHWAY OR HIGHWAY IMPROVEMENT TO BE CONSTRUCTED AS PART OF CTRL
	EXISTING HIGHWAY TO BE STOPPED UP OR DIVERTED AS PART OF CTRL
	HIGHWAY OR HIGHWAY IMPROVEMENT ARISING AS PART OF KX CENTRAL UNDER THIS OPTION
	ESTATE ROAD TO BE CONSTRUCTED AS PART OF KX CENTRAL

02	29/04/04	JTO	JRT	JRT
TRIANGLE SITE ACCESS ROAD & KEY AMENDED				
01	06/04/04	DSc	DSc	JRT
FIRST ISSUE				
Issue	Date	By	Chkd	Appd

Client
**ARGENT ST GEORGE
 LCR AND EXEL**

Job Title
**KING'S CROSS CENTRAL
 ILLUSTRATIVE HIGHWAY
 PROPOSALS**

Drawing Title
**OPTION 1
 [Non-Tram]
 HIGHWAY LAND**

ARUP

13 Filary Street
 London W1T 4BQ
 T +44(0)20 7836 1531 F +44(0)20 7580 3924
 www.arup.com

Scale at A1 1:1000

Plot ID

Drawing Status
PRELIMINARY

Job No **67940-06** Drawing No **7102** Issue **02**

TABLE 1: DETAILS OF VEHICULAR ACCESSES

Access Reference Number	Type of Access		Alterations to Existing Access				Property or Land Use Served
	Existing	Proposed or Crossover	Bellmouth	None	Stopped up & not replaced	Changes to line &/or level	
100	✓		B				YARD
101	✓		B			✓	KXC TAXIS, SERVICE VEHICLES
102	✓		B		✓		CONSTRUCTION SITE
103	✓		B		✓		CONSTRUCTION SITE
104	✓		B			✓	CONSTRUCTION SITE
105		✓	B				KXC PRIMARY ROUTE ALL VEHICLES
106		✓	B				KXC SECONDARY ROUTE CARS, SMALL SERVICE VEHICLES
107		✓	B				KXC SECONDARY ROUTE CARS, TAXI, SMALL SERVICE VEHICLES
108		✓	B				KXC PRIMARY ROUTE ALL VEHICLES
109	✓		B			✓	CTRL ACCESS
110		✓	B				TRIANGLE SITE & CTRL
111	✓		B		✓		VARIOUS (RANDELL'S ROAD)
112	✓		B	✓			VARIOUS (BINGFIELD STREET)
There is no access 113							
114	✓		B			✓	VARIOUS (COPENHAGEN STREET)
115	✓		B	✓			SHOPS
116	✓		B	✓			YARD (82/96 YORK WAY)
117	✓		B	✓			VARIOUS (CRINAN STREET)
118	✓		B	✓			'YORK CENTRAL' BUILDING
201		✓	B				GAS GOVERNOR SITE
202	✓		C		✓		YARD
203	✓		B		✓		CTRL CONSTRUCTION SITE
204		✓	B				KXC PRIMARY ROUTE ALL VEHICLES
205	✓		B			✓	INDUSTRIAL ESTATE
206	✓		B		✓		PETROL FILLING STATION
207	✓		B		✓		PETROL FILLING STATION
208		✓	B				KXC ACCESS FOR BELOW GROUND SERVICE ROAD
209		✓	B				KXC PRIMARY ROUTE PUBLIC TRANSPORT & TAXIS NORTH BOUND ONLY
210	✓		C		✓		CTRL CONSTRUCTION SITE
211	✓		B		✓		CTRL CONSTRUCTION SITE
212		✓	C				KXC CARS, SMALL SERVICE VEHICLES

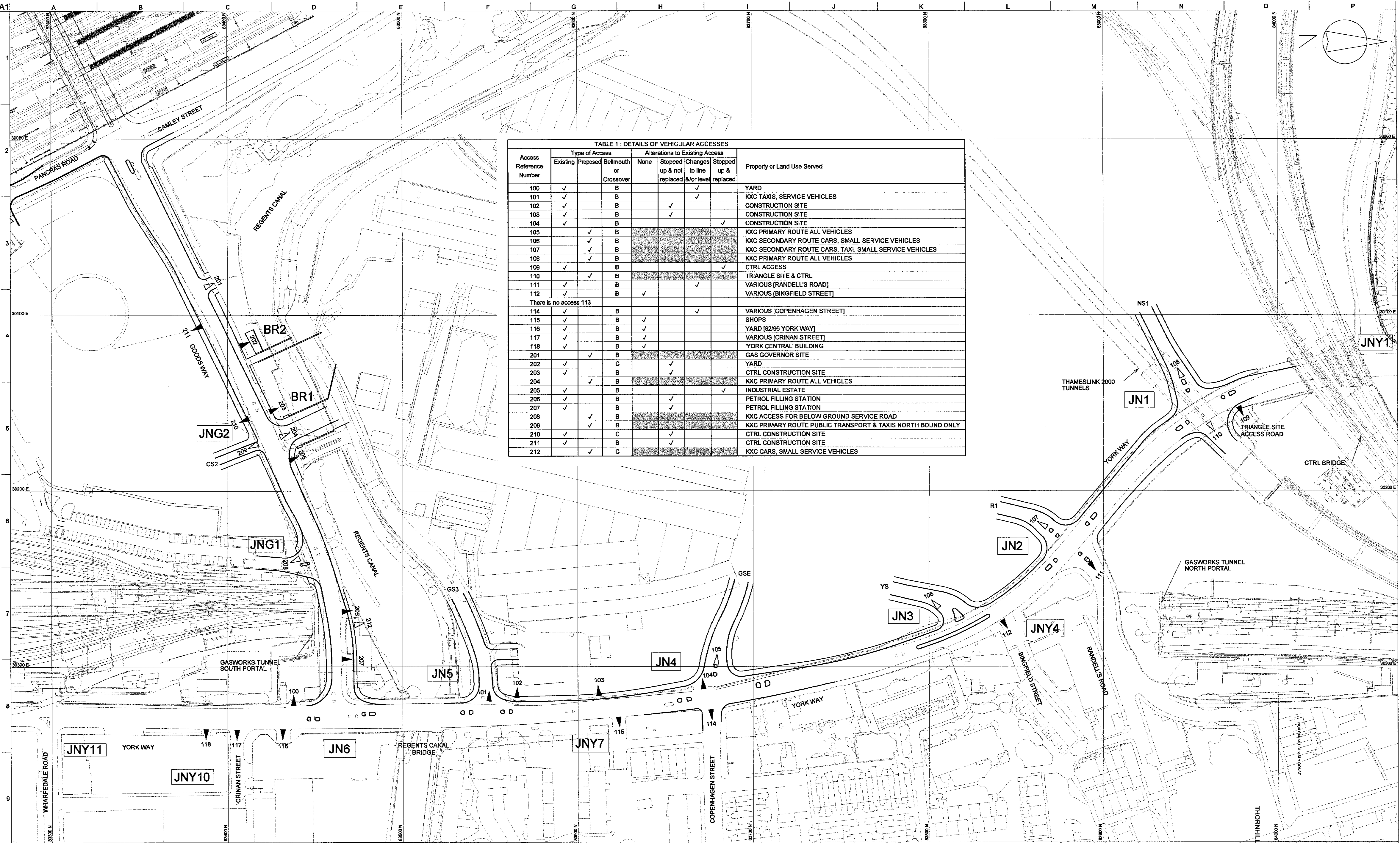

KEY:
 EXISTING ACCESS
 PROPOSED ACCESS

Issue	Date	By	Chkd	Appd
03	29/04/04	DSc	JRT	JRT
TRIANGLE SITE ACCESS ROAD & TABLE 1 AMENDED. ACCESS 113 DELETED.				
02	04/04/04	DSc	JRT	JRT
VARIOUS				
01	19/12/03	DPC	JTC	JRT
FIRST ISSUE				

Client
ARGENT ST GEORGE, LCR AND EXEL

Job Title
KING'S CROSS CENTRAL ILLUSTRATIVE HIGHWAY PROPOSALS

Drawing Title
OPTION 1 [Non-Tram] FRONTAGE PLAN

ARUP

13 Finsbury Street
 London W1T 4BQ
 Tel: +44(0)20 7636 1531 Fax: +44(0)20 7580 3624
 www.arup.com

Scale at A1: 1:1000
 Plot ID: _____
 Drawing Status: **PRELIMINARY**
 Job No: **67940-06** Drawing No: **7105** Issue: **03**

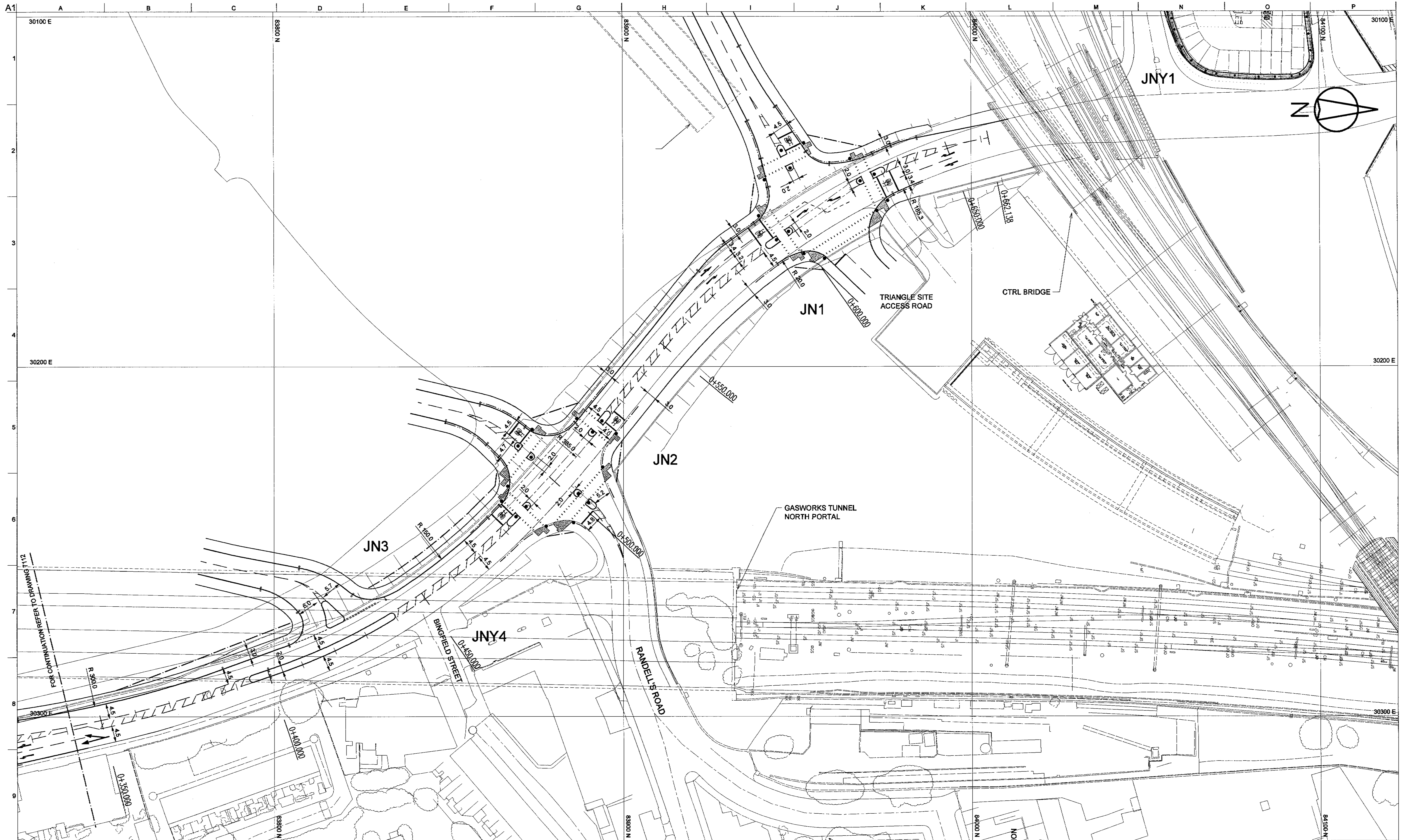

- NOTES:**
1. ALL DIMENSIONS ARE IN METRES.
 2. CO-ORDINATES ARE TO TRUNCATED ORDNANCE SURVEY.
 3. THE DRAWING INCORPORATES THE ANTICIPATED YEAR 2007 (BASE YEAR) TOPOGRAPHICAL MAPPING.
 4. TACTILE PAVING CONFIGURATIONS ARE NOTIONAL.

- KEY:**
- BASE MAPPING AT YEAR 2007
 - CARRIAGEWAY KERB
 - FOOTWAY/CYCLE TRACK EDGE
 - PEDESTRIAN CROSSING STUDS
 - VISIBILITY SPLAY [BEYOND FOOTWAY]
 - TRAFFIC SIGNAL POST
 - TACTILE PAVING
 - PEDESTRIAN GUARDRAIL

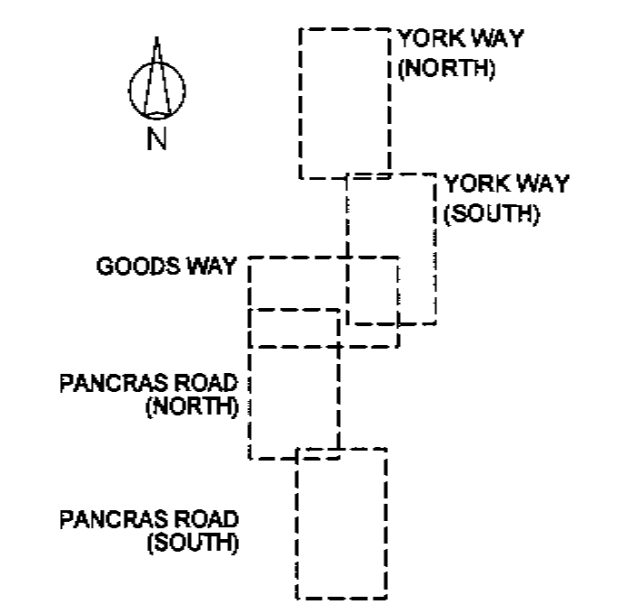

Issue	Date	By	Chkd	Appd
06	29/04/04	JTC	JRT	JRT
TRIANGLE SITE ACCESS ROAD AMENDED				
05	06/04/04	DPC	JRT	JRT
VARIOUS				
04	29/03/04	DPC	JTC	JRT
VARIOUS				
03	10/02/04	DPC	JTC	JRT
JOB TITLE REVISED				
02	19/12/03	JTC	JTC	JRT
VARIOUS REVISIONS				
01	14/11/03	JTC	JTC	JRT
FIRST ISSUE				

Client
**ARGENT ST GEORGE,
 LCR AND EXEL**

Job Title
**KING'S CROSS CENTRAL
 ILLUSTRATIVE HIGHWAY
 PROPOSALS**

Drawing Title
**OPTION 1 [NON-TRAM]
 HIGHWAY LAYOUT
 YORK WAY (NORTH)**

ARUP

13 Fitzroy Street
 London W1T 4EQ
 Tel +44(0)20 7636 1531 Fax +44(0)20 7580 3624
 www.arup.com

Scale of A1 1:500

Plot ID _____

Drawing Status
PRELIMINARY

Job No 67940-06	Drawing No 7111	Issue 06
---------------------------	---------------------------	--------------------

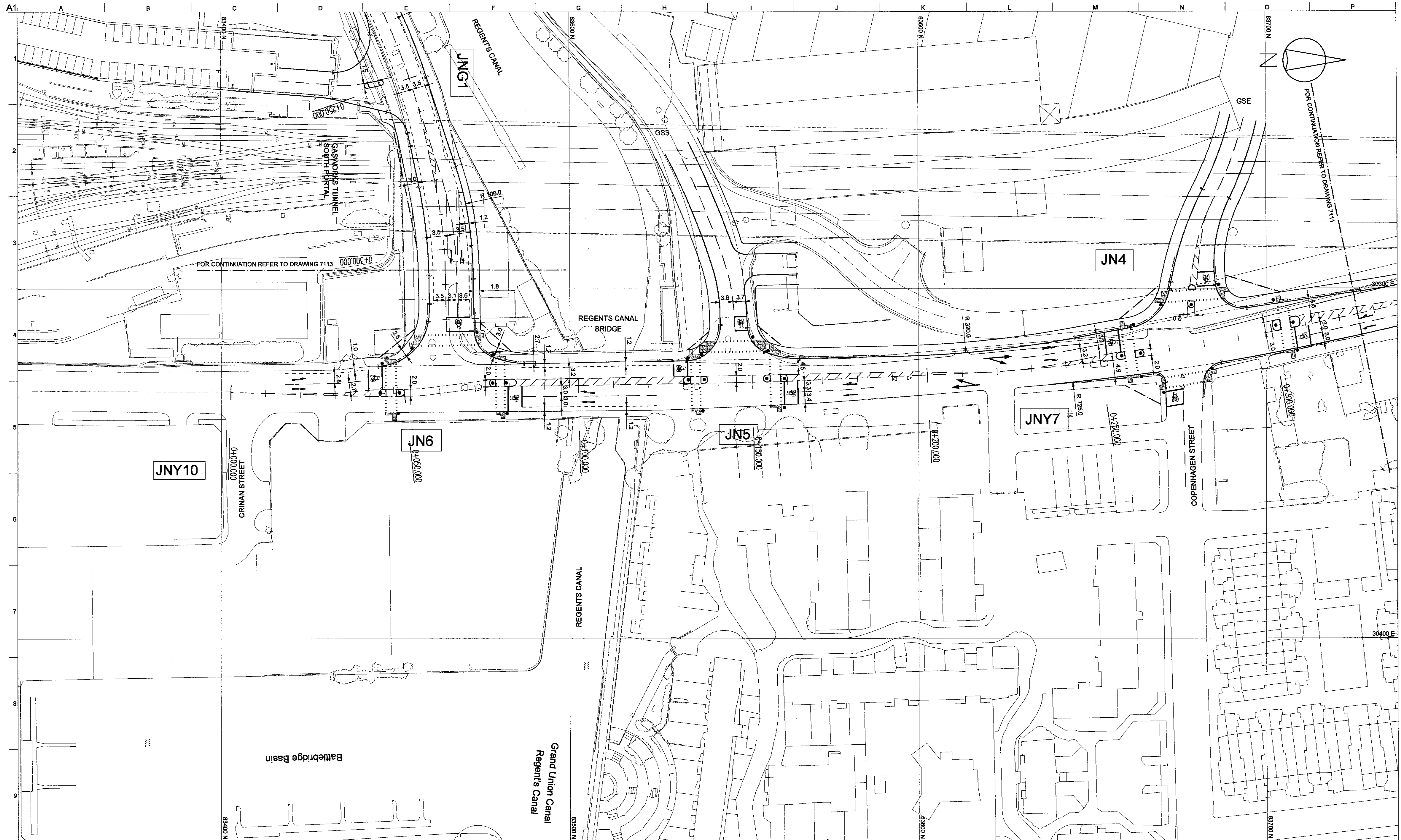

- NOTES:**
1. ALL DIMENSIONS ARE IN METRES.
 2. CO-ORDINATES ARE TO TRUNCATED ORDNANCE SURVEY.
 3. THE DRAWING INCORPORATES THE ANTICIPATED YEAR 2007 (BASE YEAR) TOPOGRAPHICAL MAPPING.
 4. TACTILE PAVING CONFIGURATIONS ARE NOTIONAL.

- KEY:**
- BASE MAPPING AT YEAR 2007
 - CARRIAGEWAY KERB
 - FOOTWAY/CYCLE TRACK EDGE
 - PEDESTRIAN CROSSING STUDS
 - VISIBILITY SPLAY [BEYOND FOOTWAY]
 - TRAFFIC SIGNAL POST
 - TACTILE PAVING
 - PEDESTRIAN GUARDRAIL

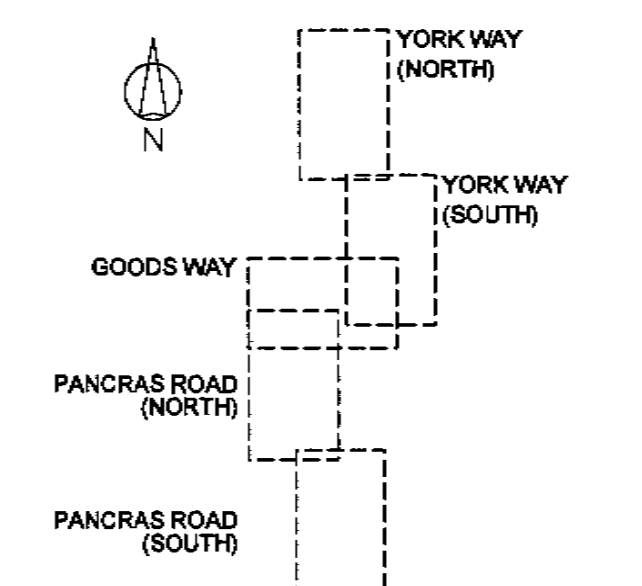

Issue	Date	By	Chkd	Appd
06	28/04/04	JTC	JRT	JRT
TITLE REVISED				
05	06/04/04	DPC	JRT	JRT
VARIOUS				
04	29/03/04	DPC	JTC	JRT
VARIOUS				
03	10/02/04	DPC	JTC	JRT
JOB TITLE REVISED				
02	19/12/03	JTC	JTC	JRT
VARIOUS REVISIONS				
01	14/11/03	JTC	JTC	JRT
FIRST ISSUE				

Client
**ARGENT ST GEORGE,
 LCR AND EXEL**

Job Title
**KING'S CROSS CENTRAL
 ILLUSTRATIVE HIGHWAY
 PROPOSALS**

Drawing Title
**OPTION 1 [NON-TRAM]
 HIGHWAY LAYOUT
 YORK WAY (SOUTH)**

ARUP

13 Fitzroy Street
 London W1T 4BQ
 Tel +44(0)20 7638 1531 Fax +44(0)20 7580 3924
 www.arup.com

Scale at A1 1:500

Plot ID _____

Drawing Status
PRELIMINARY

Job No 67940-06	Drawing No 7112	Issue 06
---------------------------	---------------------------	--------------------

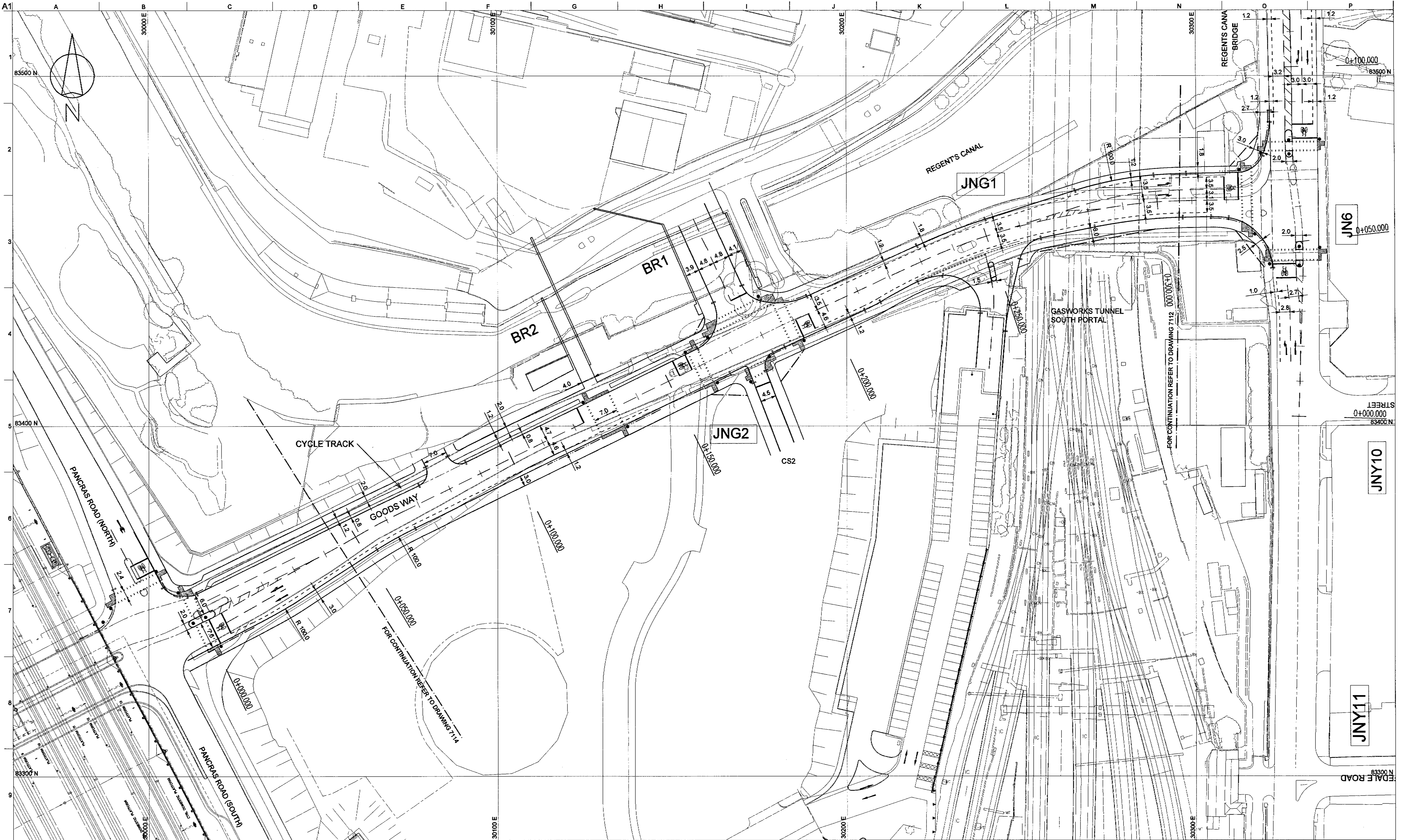

- NOTES:**
1. ALL DIMENSIONS ARE IN METRES.
 2. CO-ORDINATES ARE TO TRUNCATED ORDNANCE SURVEY.
 3. THE DRAWING INCORPORATES THE ANTICIPATED YEAR 2007 (BASE YEAR) TOPOGRAPHICAL MAPPING.
 4. TACTILE PAVING CONFIGURATIONS ARE NOTIONAL.

- KEY:**
- BASE MAPPING AT YEAR 2007
 - CARRIAGEWAY KERB
 - FOOTWAY/CYCLE TRACK EDGE
 - ⋯ PEDESTRIAN CROSSING STUDS
 - VISIBILITY SPLAY [BEYOND FOOTWAY]
 - TRAFFIC SIGNAL POST
 - ▬ TACTILE PAVING
 - PEDESTRIAN GUARDRAIL

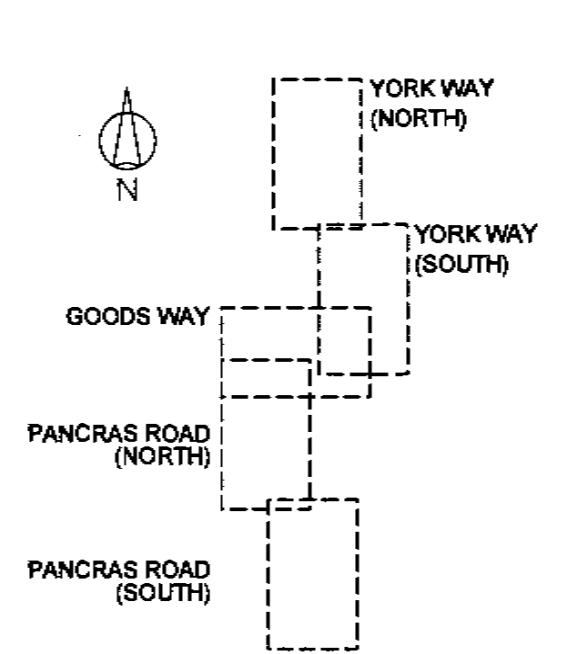

Issue	Date	By	Chkd	Appd
06	29/04/04	JTS	JRT	JRT
TITLE REVISED				
05	06/04/04	DPC	JRT	JRT
VARIOUS				
04	29/03/04	DPC	JTC	JRT
VARIOUS				
03	10/02/04	DPC	JTC	JRT
JOB TITLE REVISED				
02	09/12/03	JTC	JTC	JRT
VARIOUS REVISIONS				
01	14/11/03	JTC	JTC	JRT
FIRST ISSUE				

Client
**ARGENT ST GEORGE,
 LCR AND EXEL**

Job Title
**KING'S CROSS CENTRAL
 ILLUSTRATIVE HIGHWAY
 PROPOSALS**

Drawing Title
OPTION 1 [NON-TRAM]

**HIGHWAY LAYOUT
 GOODS WAY**

ARUP

15 Fitzroy Street
 London W1T 4BQ
 Tel +44(0)20 7636 1531 Fax +44(0)20 7680 3924
 www.arup.com

Scale at A1 1:500

Plot ID

Drawing Status
PRELIMINARY

Job No 67940-06	Drawing No 7113	Issue 06
---------------------------	---------------------------	--------------------

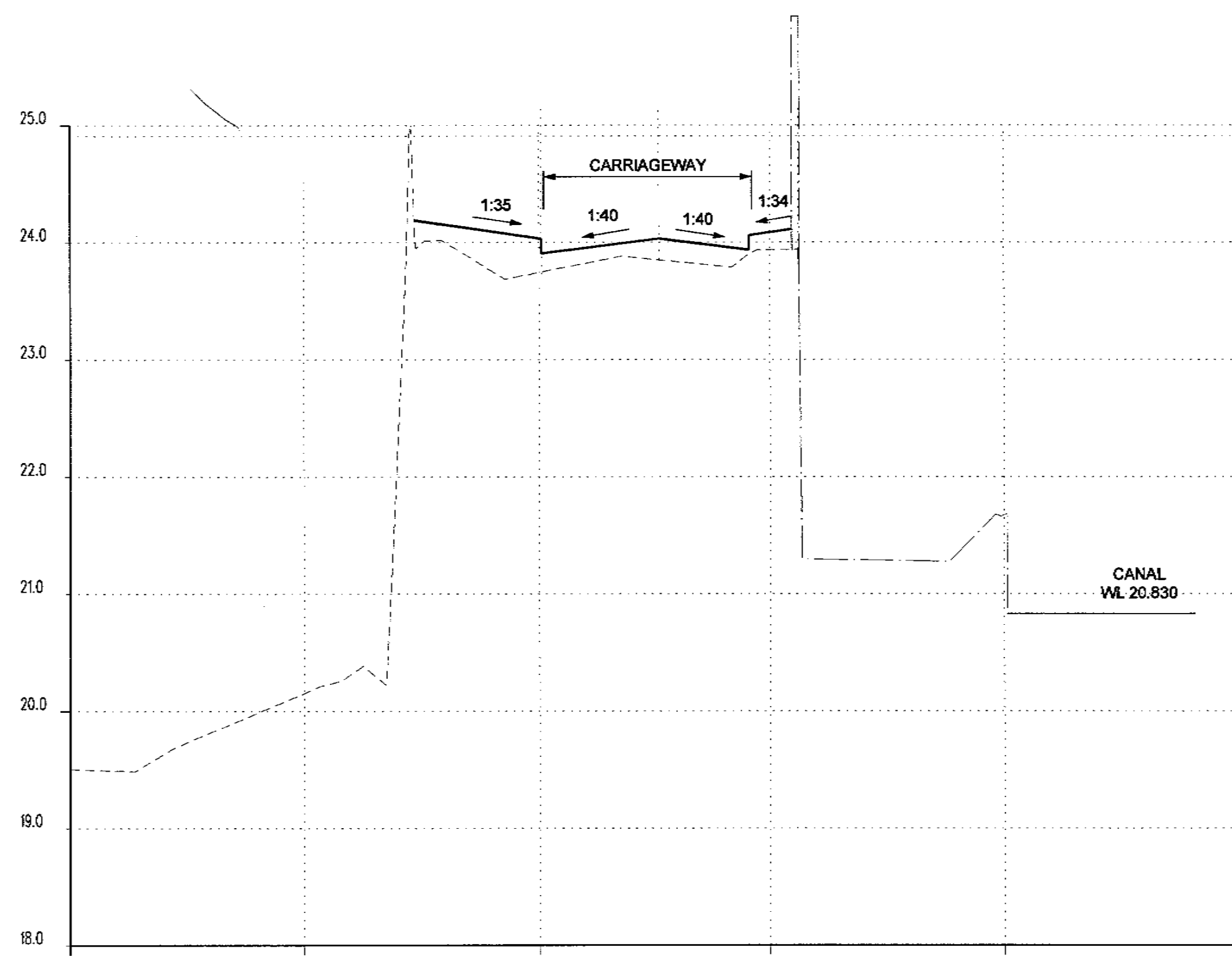

CHAINAGE 220.00

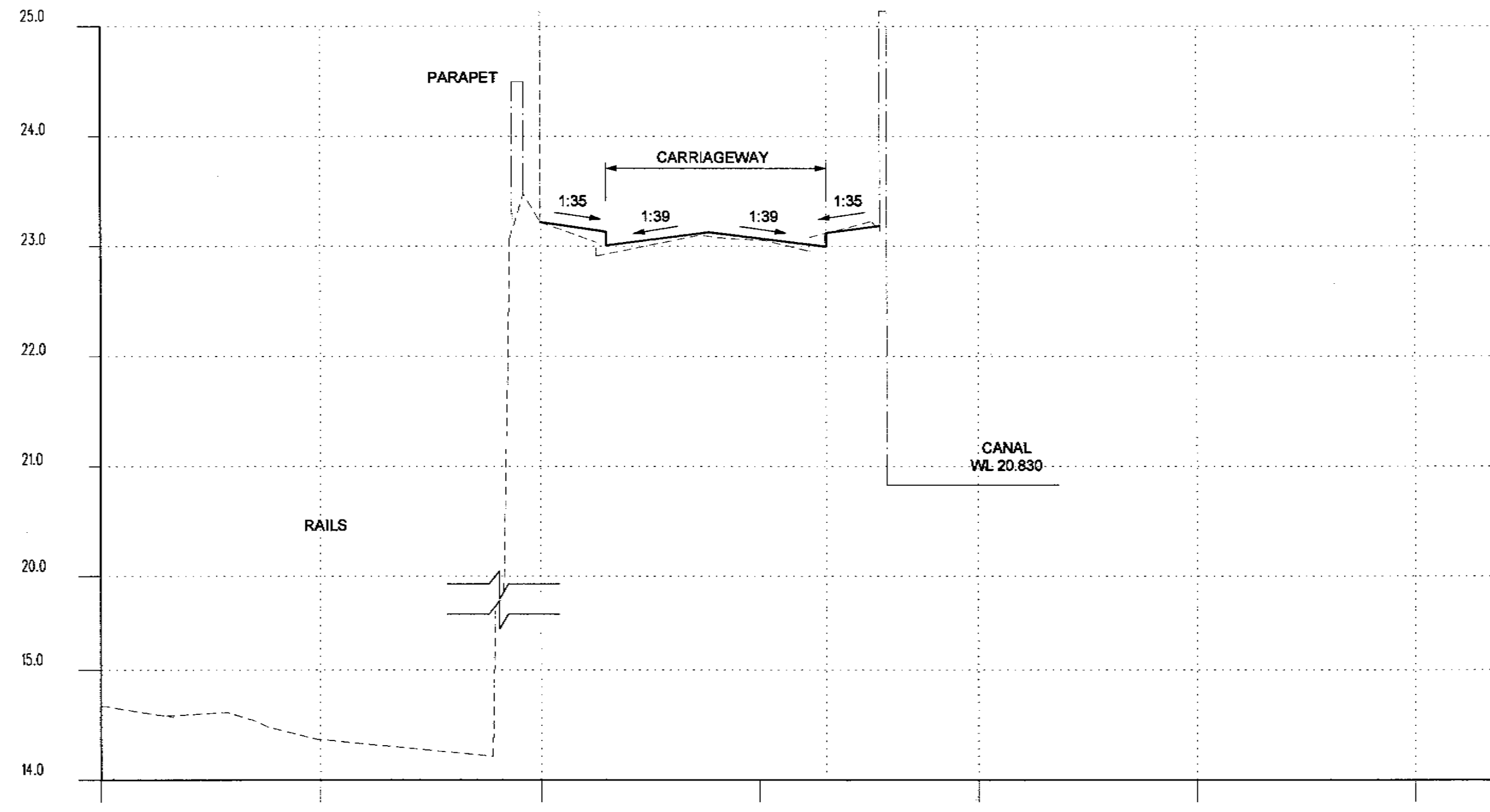

CHAINAGE 265.00

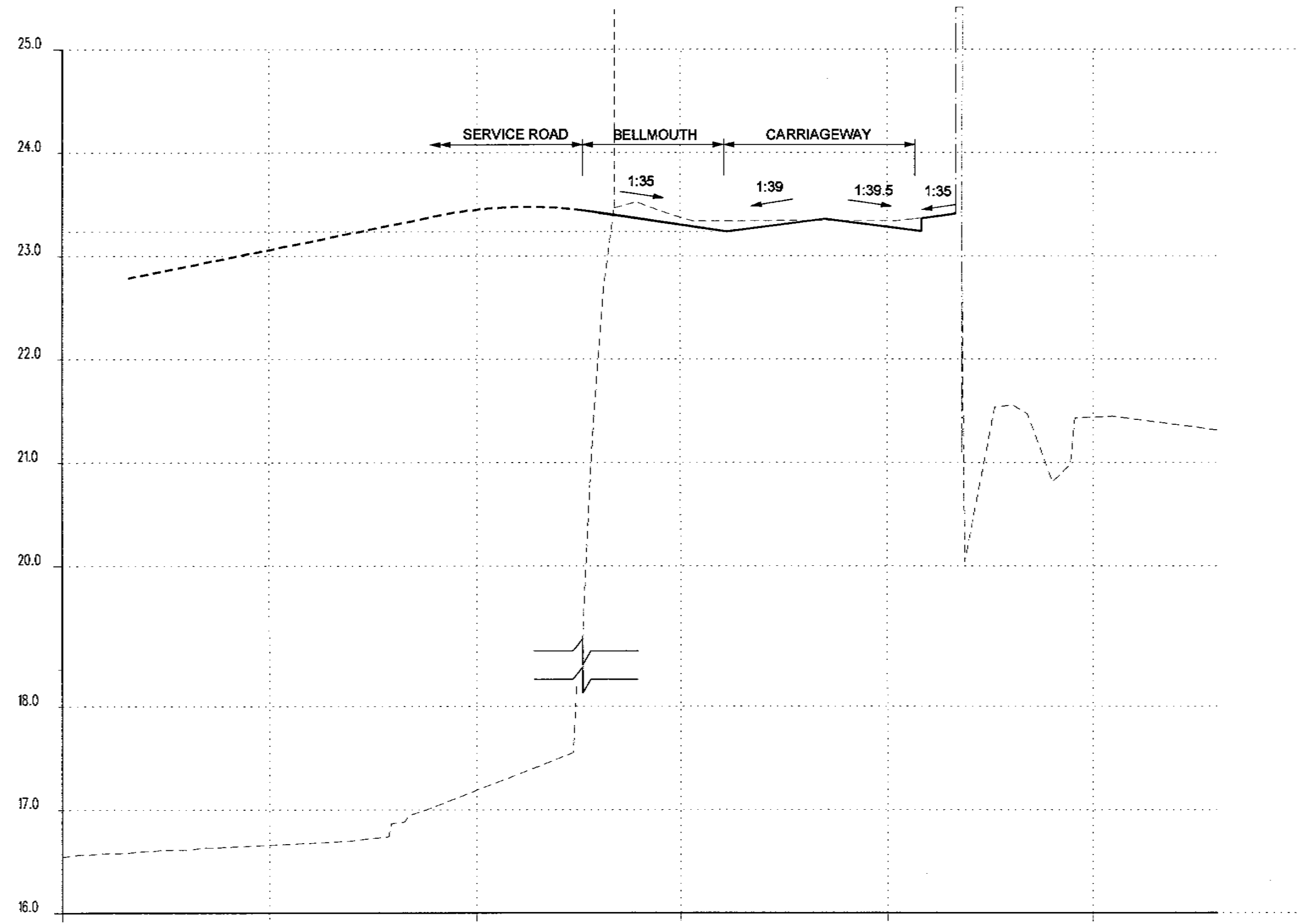

CHAINAGE 245.00

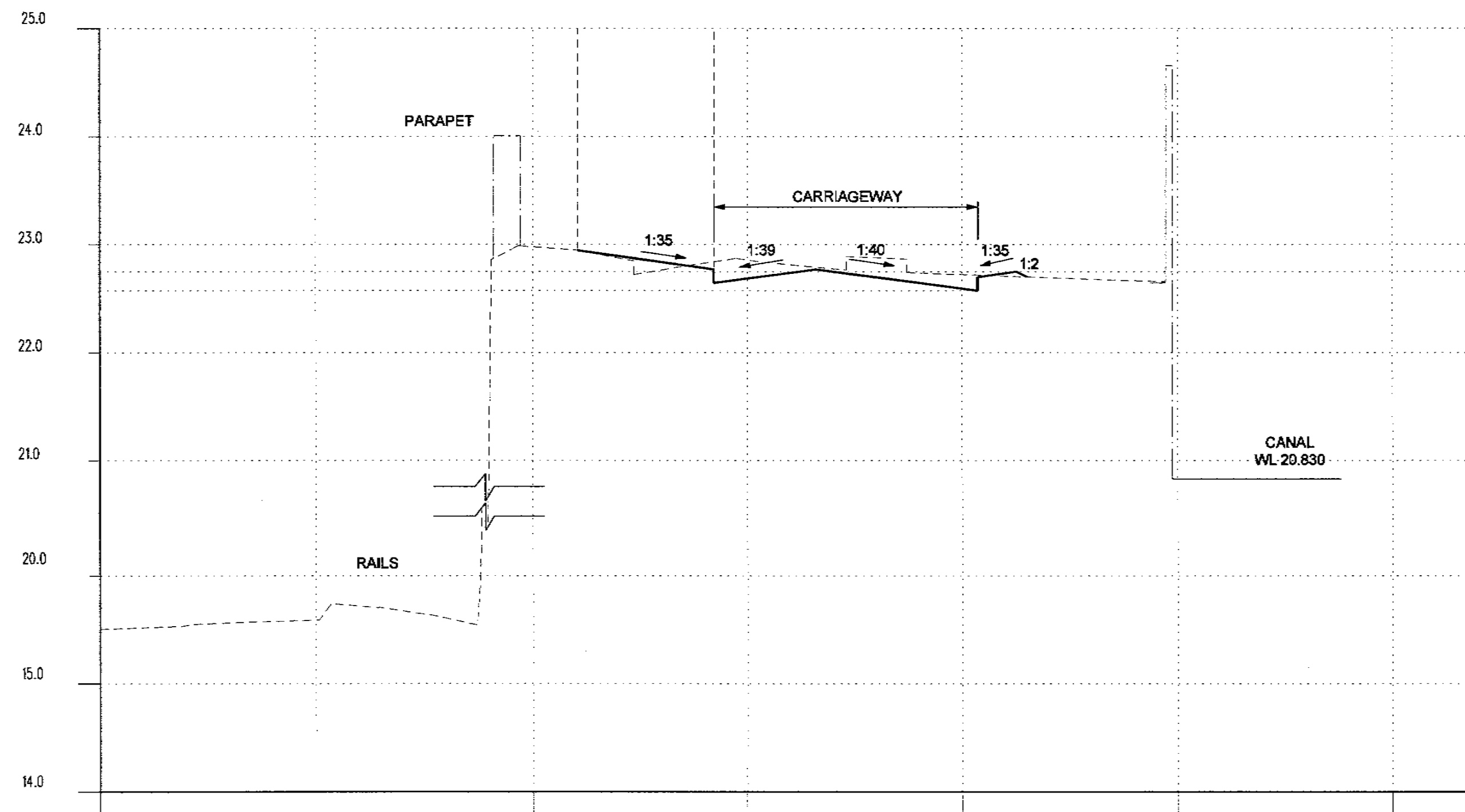

CHAINAGE 313.00

02	07/04/04	DPC	DPC	JRT
VARIOUS				
01	23/12/03	DSc	JTC	JRT
FIRST ISSUE				
Issue	Date	By	Chkd	Appd

ARUP

13 Fitzroy Street
London W1T 4BQ
T +44(0)20 7636 1531 F +44(0)20 7580 3524
www.arup.com

Client
**ARGENT ST GEORGE
LCR AND EXEL**

Job Title
**KING'S CROSS CENTRAL
ILLUSTRATIVE HIGHWAY
PROPOSALS**

Drawing Title
OPTION 1 [NO TRAM]

**CROSS SECTIONS
GOOD'S WAY**

Scale at A1 1:200 HORIZ 1:40 VERT

Plot ID PlotID

Drawing Status
PRELIMINARY

Job No	Drawing No	Issue
67940-06	7141	02

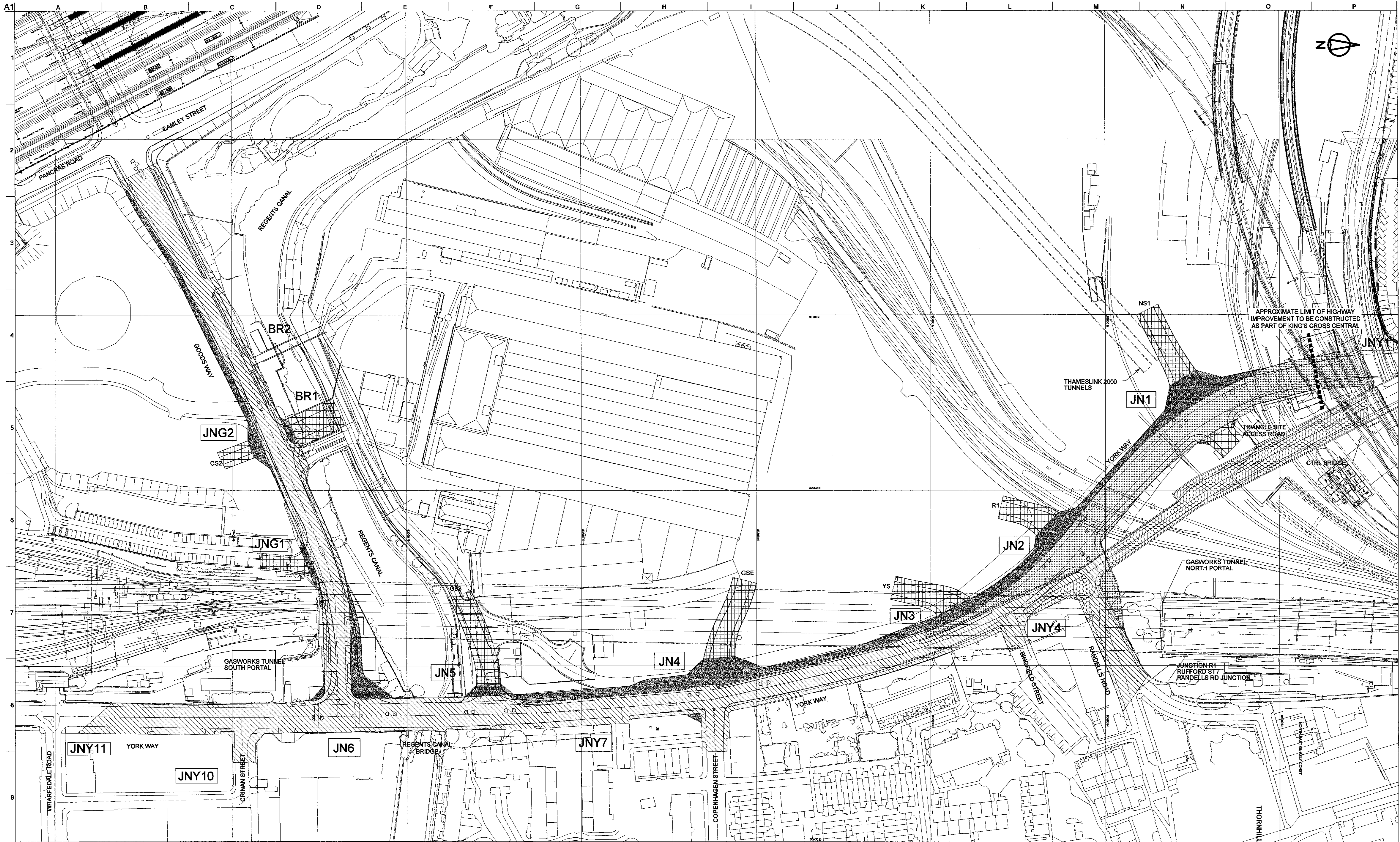

NOTES:
 1. CO-ORDINATES ARE TO TRUNCATED ORDNANCE SURVEY.
 2. THE DRAWING INCORPORATES THE ANTICIPATED YEAR 2007 (BASE YEAR) TOPOGRAPHICAL MAPPING.

- KEY:**
- BASE YEAR MAPPING AT 2007
 - [Hatched pattern] EXISTING HIGHWAY TO REMAIN
 - [Dotted pattern] HIGHWAY OR HIGHWAY IMPROVEMENT TO BE CONSTRUCTED AS PART OF CTRL
 - [Cross-hatched pattern] EXISTING HIGHWAY TO BE STOPPED UP OR DIVERTED AS PART OF CTRL
 - [Dark hatched pattern] HIGHWAY OR HIGHWAY IMPROVEMENT ARISING AS PART OF KX CENTRAL UNDER THIS OPTION
 - [Grid pattern] ESTATE ROAD TO BE CONSTRUCTED AS PART OF KX CENTRAL

02	29/04/04	JTC	JRT	JRT
TRIANGLE SITE ACCESS ROAD & KEY AMENDED				
01	06/04/04	DSc	DSc	JRT
FIRST ISSUE				
Issue	Date	By	Chkd	Appd

Client
**ARGENT ST GEORGE
 LCR AND EXEL**

Job Title
**KING'S CROSS CENTRAL
 ILLUSTRATIVE HIGHWAY
 PROPOSALS**

Drawing Title
**OPTION 2
 [Tram]**

HIGHWAY LAND

ARUP

13 Fitzroy Street
 London W1T 4BQ
 T +44(0)20 7838 1531 F +44(0)20 7880 3824
 www.arup.com

Scale at A1 1:1000

Plot ID

Drawing Status
PRELIMINARY

Job No 67940-06 Drawing No 7202 Issue 02

TABLE 1: DETAILS OF VEHICULAR ACCESSES

Access Reference Number	Type of Access		Alterations to Existing Access				Property or Land Use Served
	Existing	Proposed	Bellmouth or Crossover	None	Stopped up & not replaced	Changes to line &/or level	
100	✓		B			✓	YARD
101	✓		B			✓	KXC TAXIS, SERVICE VEHICLES
102	✓		B		✓		CONSTRUCTION SITE
103	✓		B		✓		CONSTRUCTION SITE
104	✓		B			✓	CONSTRUCTION SITE
105		✓	B				KXC PRIMARY ROUTE ALL VEHICLES
106		✓	B				KXC SECONDARY ROUTE CARS, SMALL SERVICE VEHICLES
107		✓	B				KXC SECONDARY ROUTE CARS, TAXI, SMALL SERVICE VEHICLES
108		✓	B				KXC PRIMARY ROUTE ALL VEHICLES
109	✓		B			✓	CTRL ACCESS
110		✓	B				TRIANGLE SITE & CTRL
111	✓		B			✓	VARIOUS [RANDELL'S ROAD]
112	✓		B	✓			VARIOUS [BINGFIELD STREET]
There is no access 113							
114	✓		B			✓	VARIOUS [COPENHAGEN STREET]
115	✓		B	✓			SHOPS
116	✓		B	✓			YARD [82/86 YORK WAY]
117	✓		B	✓			VARIOUS [CRINAN STREET]
118	✓		B	✓			'YORK CENTRAL' BUILDING
201		✓	B				GAS GOVERNOR SITE
202	✓		C		✓		YARD
203	✓		B		✓		CTRL CONSTRUCTION SITE
204		✓	B				KXC PRIMARY ROUTE ALL VEHICLES
205	✓		B			✓	INDUSTRIAL ESTATE
206	✓		B		✓		PETROL FILLING STATION
207	✓		B		✓		PETROL FILLING STATION
208		✓	B				KXC ACCESS FOR BELOW GROUND SERVICE ROAD
209		✓	B				KXC PRIMARY ROUTE PUBLIC TRANSPORT & TAXIS NORTH BOUND ONLY
210	✓		C		✓		CTRL CONSTRUCTION SITE
211	✓		B		✓		CTRL CONSTRUCTION SITE
212		✓	C		✓		KXC CARS, SMALL SERVICE VEHICLES

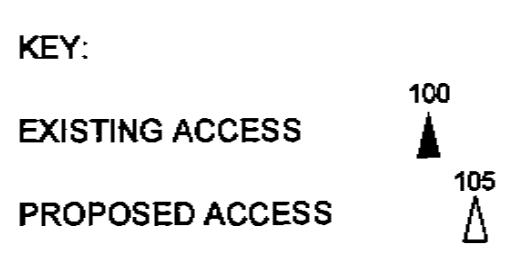
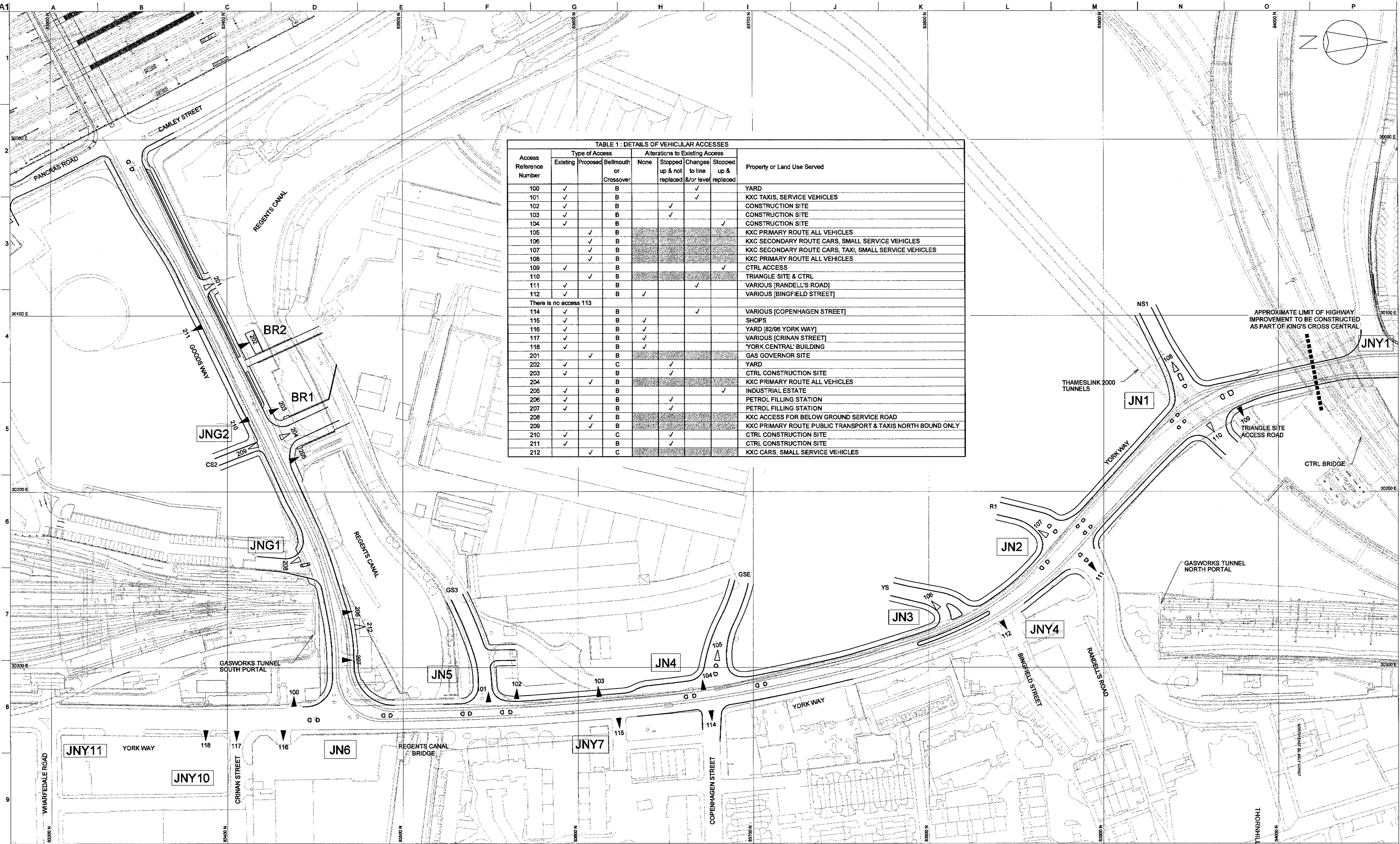

03	29/04/04	DSc	JRT	JRT
TRIANGLE SITE ACCESS ROAD & TABLE 1 AMENDED ACCESS 113 DELETED				
02	06/04/04	DSc	JRT	JRT
VARIOUS				
01	19/12/03	DPC	JTC	JRT
FIRST ISSUE				
Issue	Date	By	Chkd	Appd

Client
**ARGENT ST GEORGE,
 LCR AND EXEL**

Job Title
**KING'S CROSS CENTRAL
 ILLUSTRATIVE HIGHWAY
 PROPOSALS**

Drawing Title
**OPTION 2
 [Tram]**

Drawing Status
PRELIMINARY

FRONTAGE PLAN

ARUP

15 Fitzroy Street
 London W1T 4SQ
 Tel +44(0)20 7836 1531 Fax +44(0)20 7850 3924
 www.arup.com

Scale at A1
 1:1000

Plot ID

Drawing Status
PRELIMINARY

Job No
67940-06

Drawing No
7205

Issue
03

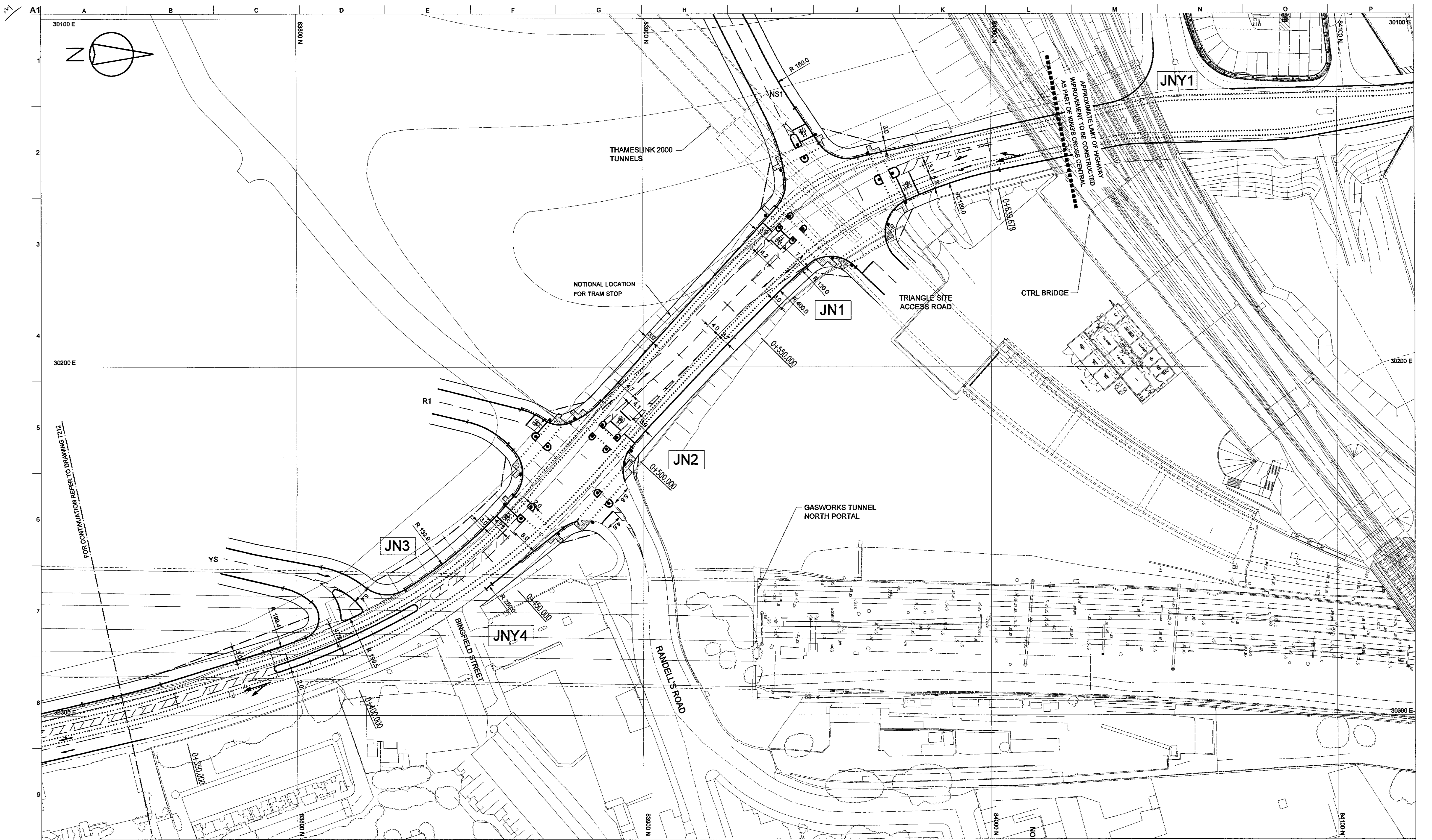

NOTES:

1. ALL DIMENSIONS ARE IN METRES.
2. CO-ORDINATES ARE TO TRUNCATED ORDNANCE SURVEY.
3. THE DRAWING INCORPORATES THE ANTICIPATED YEAR 2007 (BASE YEAR) TOPOGRAPHICAL MAPPING.
4. TACTILE PAVING CONFIGURATIONS ARE NOTIONAL.

KEY:

- BASE YEAR MAPPING AT 2007
- CARRIAGEWAY KERB
- FOOTWAY/CYCLE TRACK EDGE
- PEDESTRIAN CROSSING STUDS
- VISIBILITY SPLAY [BEYOND FOOTWAY]
- TRAFFIC SIGNAL POST
- TACTILE PAVING
- PEDESTRIAN GUARDRAIL
- TRAM TRACKS

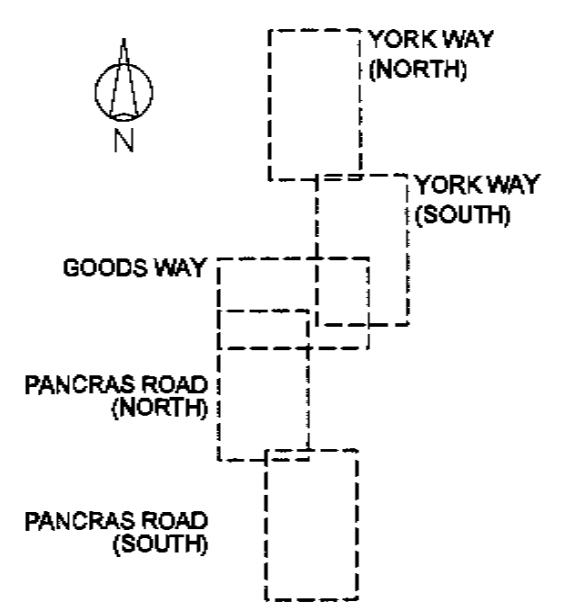

Issue	Date	By	Chkd	Appd
05	29/04/04	JTC	JRT	JRT
TRIANGLE SITE ACCESS ROAD AMENDED				
04	06/04/04	DSc	JRT	JRT
VARIOUS				
03	02/04/04	DPC	JTC	JRT
VARIOUS				
02	19/12/03	DPC	JTC	JRT
VARIOUS				
01	14/11/03	DPC	JTC	JRT
FIRST ISSUE				

Client
**ARGENT ST GEORGE,
 LCR AND EXEL**

Job Title
**KING'S CROSS CENTRAL
 ILLUSTRATIVE
 HIGHWAY PROPOSALS**

Drawing Title
**OPTION 2 (TRAMS)
 HIGHWAY LAYOUT
 YORK WAY (NORTH)**

ARUP

13 Fitzroy Street
 London W1T 4BQ
 Tel +44(0)20 7536 1531 Fax +44(0)20 7560 3924
 www.arup.com

Scale at A1 1:500

Plot ID _____

Drawing Status
PRELIMINARY

Job No **67940-06** Drawing No **7211** Issue **05**

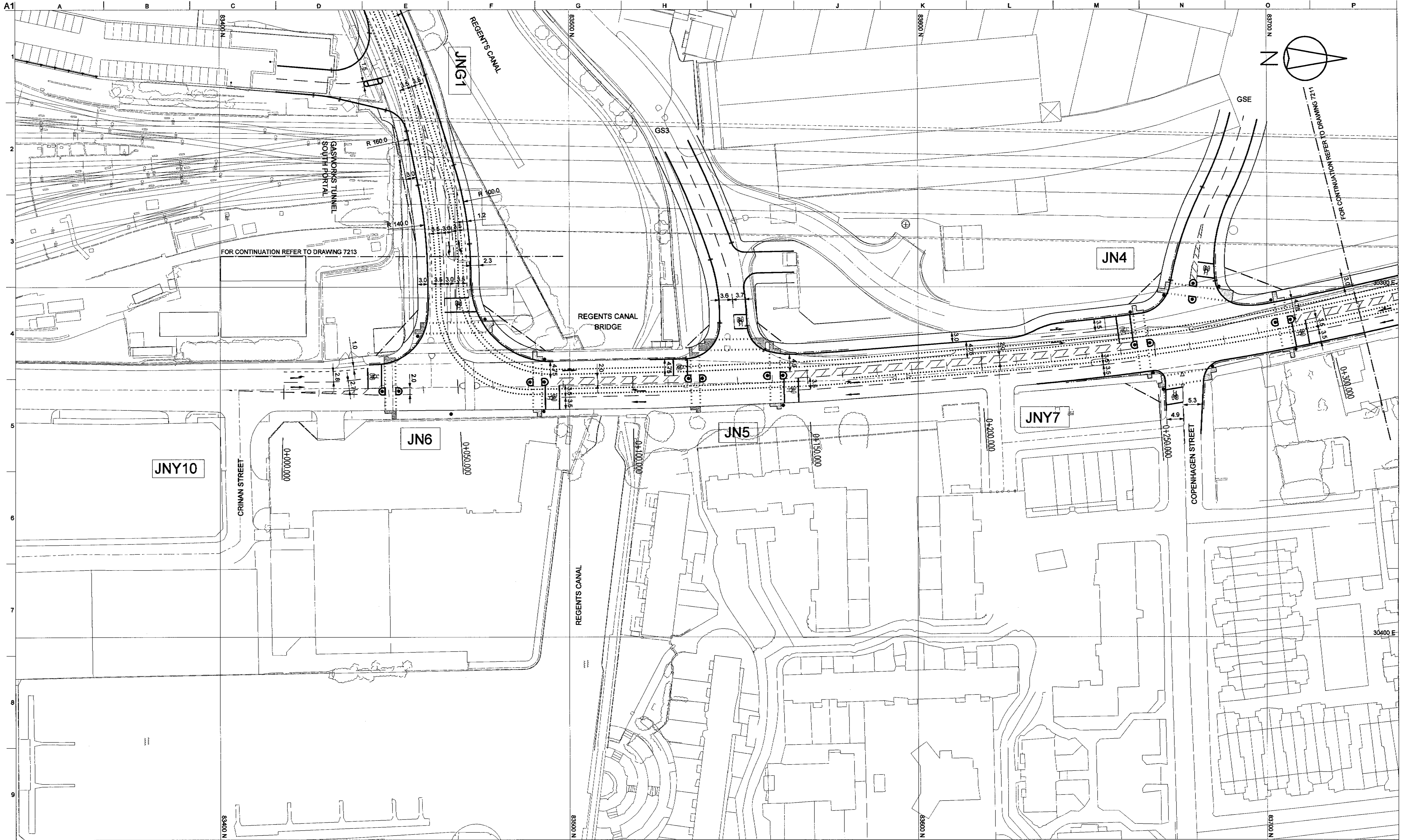

- NOTES:**
- ALL DIMENSIONS ARE IN METRES.
 - CO-ORDINATES ARE TO TRUNCATED ORDNANCE SURVEY.
 - THE DRAWING INCORPORATES THE ANTICIPATED YEAR 2007 (BASE YEAR) TOPOGRAPHICAL MAPPING.
 - TACTILE PAVING CONFIGURATIONS ARE NOTIONAL.

- KEY:**
- BASE MAPPING AT YEAR (2007)
 - CARRIAGEWAY KERB
 - FOOTWAY/CYCLE TRACK EDGE
 - ⋯ PEDESTRIAN CROSSING STUDS
 - VISIBILITY SPLAY (BEYOND FOOTWAY)
 - TRAFFIC SIGNAL POST
 - TACTILE PAVING
 - PEDESTRIAN GUARDRAIL
 - ⋯ TRAM TRACKS

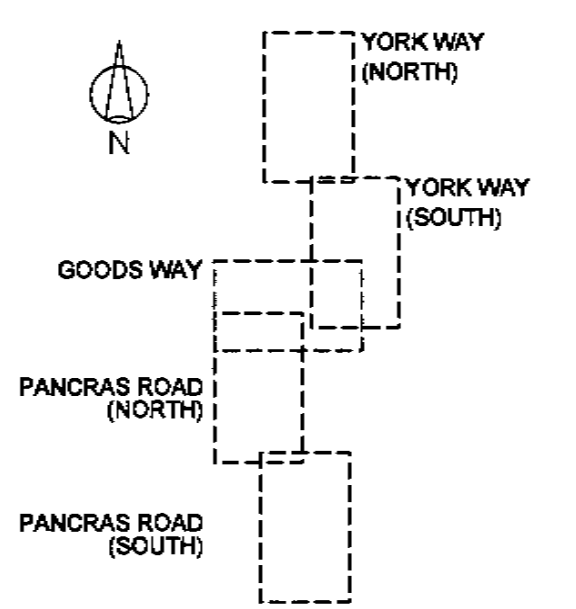

Issue	Date	By	Chkd	Appd
05	29/04/04	JTC	JRT	JRT
TITLE REVISED				
04	06/04/04	DSc	JRT	JRT
VARIOUS				
03	02/04/04	DPC	JTC	JRT
VARIOUS				
02	18/12/03	DPC	JTC	JRT
VARIOUS				
01	14/11/03	DPC	JTC	JRT
FIRST ISSUE				

Client
**ARGENT ST GEORGE,
 LCR AND EXEL**

Job Title
**KING'S CROSS CENTRAL
 ILLUSTRATIVE
 HIGHWAY PROPOSALS**

Drawing Title
**OPTION 2 (TRAMS)
 HIGHWAY LAYOUT
 YORK WAY (SOUTH)**

ARUP

15 Fitzroy Street
 London: W1T 4BQ
 Tel +44(0)20 7836 1531 Fax +44(0)20 7580 3924
 www.arup.com

Scale at A1 1:500

Plot ID

Drawing Status
PRELIMINARY

Job No 67940-06	Drawing No 7212	Issue 05
---------------------------	---------------------------	--------------------

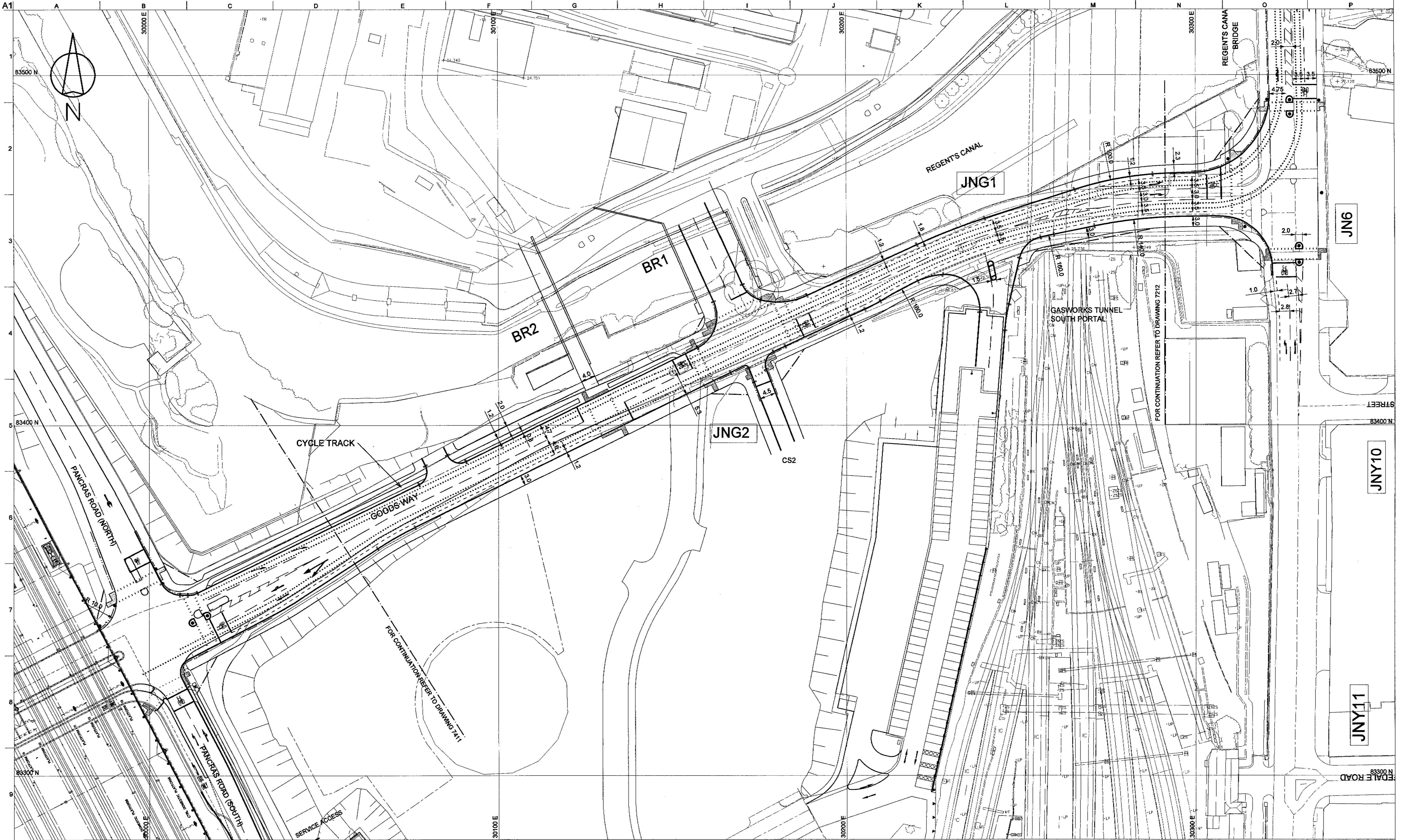

- NOTES:**
1. ALL DIMENSIONS ARE IN METRES.
 2. CO-ORDINATES ARE TO TRUNCATED ORDNANCE SURVEY.
 3. THE DRAWING INCORPORATES THE ANTICIPATED YEAR 2007 (BASE YEAR) TOPOGRAPHICAL MAPPING.
 4. TACTILE PAVING CONFIGURATIONS ARE NOTIONAL.

- KEY:**
- BASE MAPPING AT YEAR 2007
 - CARRIAGEWAY KERB
 - FOOTWAY/CYCLE TRACK EDGE
 - PEDESTRIAN CROSSING STUDS
 - VISIBILITY SPLAY (BEYOND FOOTWAY)
 - TRAFFIC SIGNAL POST
 - ▭ TACTILE PAVING
 - PEDESTRIAN GUARDRAIL
 - TRAM TRACKS

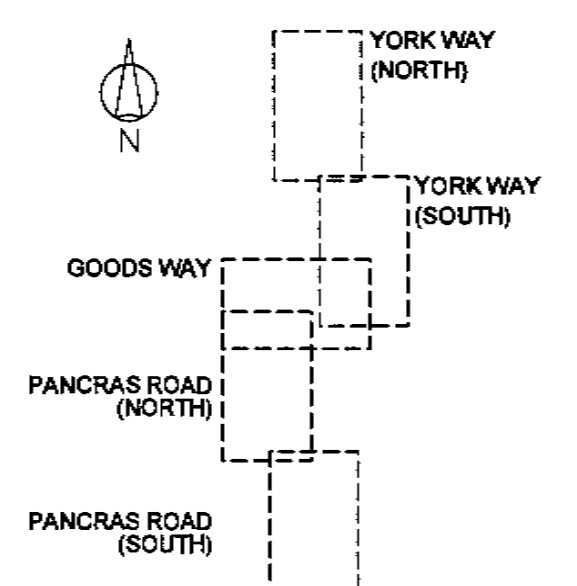

Issue	Date	By	Chkd	Appd
05	29/04/04	JTC	JRT	JRT
TITLE REVISED				
04	06/04/04	DSc	JRT	JRT
GUARDRAIL DELETED (SOUTH SIDE)				
VARIOUS				
03	29/03/04	VAR	JTC	JRT
VARIOUS				
02	19/12/03	DPC	JTC	JRT
VARIOUS				
01	14/11/03	DPC	JTC	JRT
FIRST ISSUE				

Client
**ARGENT ST GEORGE,
 LCR AND EXEL**

Job Title
**KING'S CROSS CENTRAL
 ILLUSTRATIVE
 HIGHWAY PROPOSALS**

Drawing Title
**OPTION 2 (TRAMS)
 HIGHWAY LAYOUT
 GOODS WAY**

ARUP

13 Fitzroy Street
 London W1T 4BQ
 Tel +44(0)20 7636 1531 Fax +44(0)20 7580 3924
 www.arup.com

Scale at A1 1:500

Plot ID

Drawing Status
PRELIMINARY

Job No **67940-06** Drawing No **7213** Issue **05**



NOTES:
 1. ALL DIMENSIONS ARE IN METRES.
 2. CO-ORDINATES ARE TO TRUNCATED ORDNANCE SURVEY.
 3. THE DRAWING INCORPORATES THE ANTICIPATED YEAR 2007 (BASE YEAR) TOPOGRAPHICAL MAPPING.

KEY:

	EXISTING MAPPING AT 2007
	CARRIAGEWAY KERB
	FOOTWAY/CYCLE TRACK EDGE
	PEDESTRIAN CROSSING STUDS
	VISIBILITY SPLAY [BEYOND FOOTWAY]
	TRAFFIC SIGNAL POST
	TACTILE PAVING
	PEDESTRIAN GUARDRAIL
	BRIDGE PARAPET

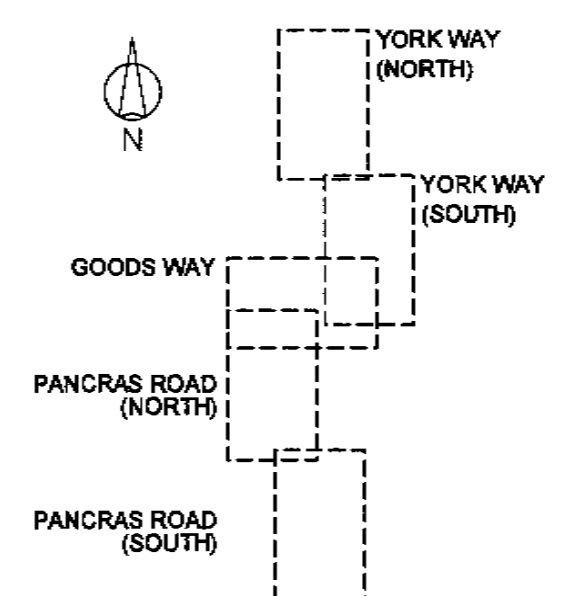

02	29/04/04	JTG	IF		
TITLE REVISED					
01	02/04/04	DSc	IF	IF	
FIRST ISSUE					
Issue	Date	By	Chkd	Appl	

Client
**ARGENT ST GEORGE
 LCR AND EXEL**

Job Title
**KING'S CROSS CENTRAL
 ILLUSTRATIVE HIGHWAY
 PROPOSALS**

Drawing Title
**OPTION P1
 [Prior to KX Station enhancement]
 HIGHWAY LAYOUT
 PANCRAS ROAD (NORTH)**

ARUP

13 Fitzroy Street
 London W1T 4BQ
 T +44(0)20 7636 1531 F +44(0)20 7590 3924
 www.arup.com

Scale at A1 1:500

Plot ID

Drawing Status
PRELIMINARY

Job No **67940-06** Drawing No **7411** Issue **02**

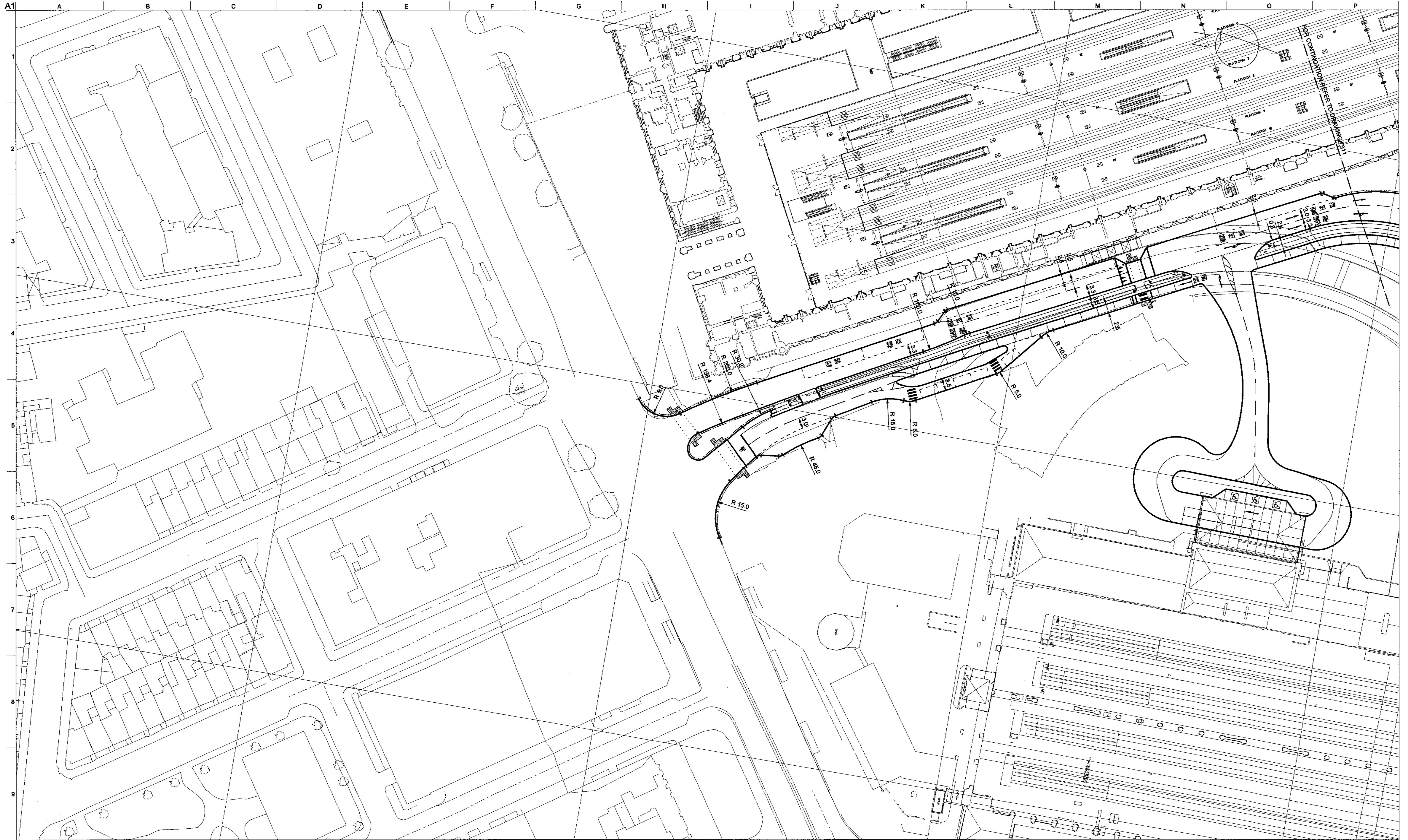

NOTES:
 1. ALL DIMENSIONS ARE IN METRES.
 2. CO-ORDINATES ARE TO TRUNCATED ORDNANCE SURVEY.
 3. THE DRAWING INCORPORATES THE ANTICIPATED YEAR 2007 (BASE YEAR) TOPOGRAPHICAL MAPPING.

- KEY:**
- EXISTING MAPPING AT 2007
 - CARRIAGEWAY KERB
 - FOOTWAY/CYCLE TRACK EDGE
 - PEDESTRIAN CROSSING STUDS
 - VISIBILITY SPLAY [BEYOND FOOTWAY]
 - TRAFFIC SIGNAL POST
 - TACTILE PAVING
 - PEDESTRIAN GUARDRAIL

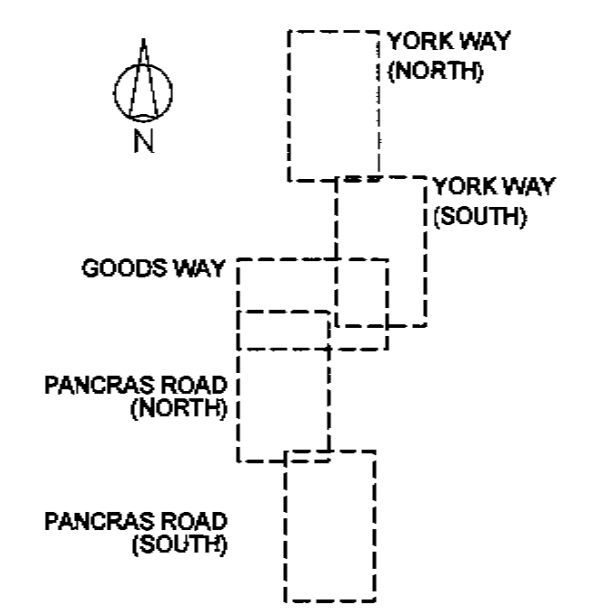

Issue	Date	By	Chkd	Appd
02	29/04/04	JTC	IF	IF
TITLE REVISED				
01	02/04/04	DSc	IF	IF
FIRST ISSUE				

Client
**ARGENT ST GEORGE
 LCR AND EXEL**

Job Title
**KING'S CROSS CENTRAL
 ILLUSTRATIVE HIGHWAY
 PROPOSALS**

Drawing Title
**OPTION P1
 [Prior to KX Station enhancement]
 HIGHWAY LAYOUT
 PANCRAS ROAD (SOUTH)**

ARUP

13 Fitzroy Street
 London W1T 4EQ
 T +44(0)20 7836 1531 F +44(0)20 7560 3824
 www.arup.com

Scale at A1 1:500

Plot ID

Drawing Status
PRELIMINARY

Job No 67940-06 Drawing No 7412 Issue 02

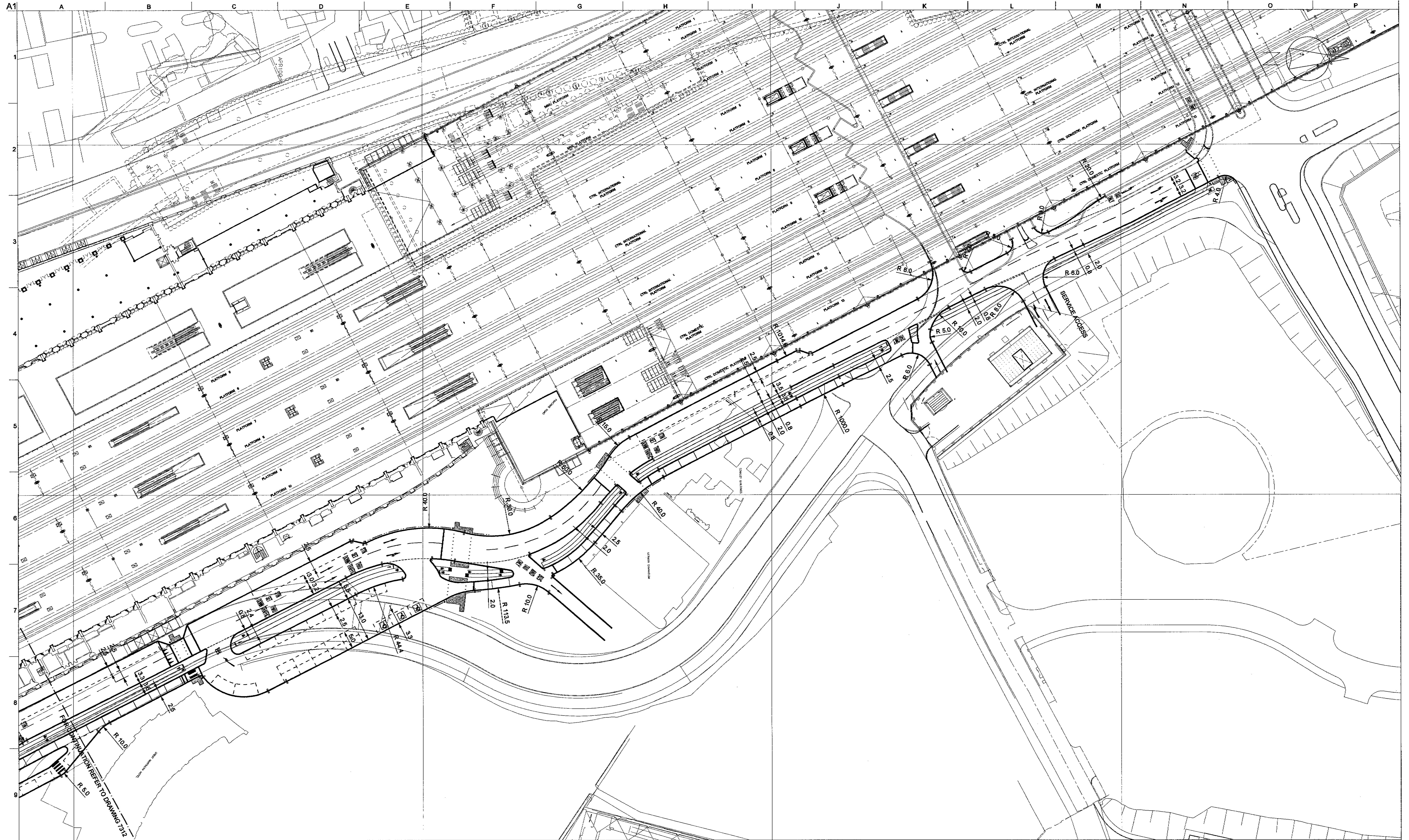

NOTES:
 1. ALL DIMENSIONS ARE IN METRES.
 2. CO-ORDINATES ARE TO TRUNCATED ORDNANCE SURVEY.
 3. THE DRAWING INCORPORATES THE ANTICIPATED YEAR 2007 (BASE YEAR) TOPOGRAPHICAL MAPPING.

KEY:

	EXISTING MAPPING AT 2007
	CARRIAGEWAY KERB
	FOOTWAY/CYCLE TRACK EDGE
	PEDESTRIAN CROSSING STUDS
	VISIBILITY SPLAY [BEYOND FOOTWAY]
	TRAFFIC SIGNAL POST
	TACTILE PAVING
	PEDESTRIAN GUARDRAIL
	BRIDGE PARAPET

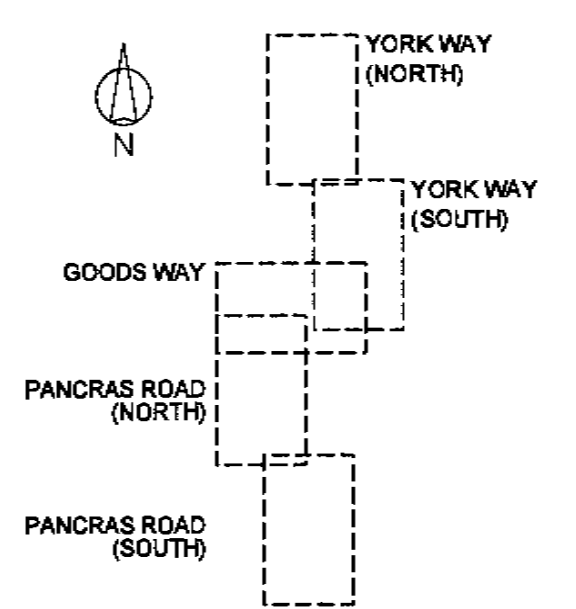

03	29/04/04	JTC	IF	IF
TITLE REVISED				
02	02/04/04	DSc	IF	IF
VARIOUS				
01	19/12/03	JTC	JTC	JRT
FIRST ISSUE				
Issue	Date	By	Chkd	Appd

Client
**ARGENT ST GEORGE,
 LCR AND EXEL**

Job Title
**KING'S CROSS CENTRAL
 ILLUSTRATIVE HIGHWAY
 PROPOSALS**

Drawing Title
**OPTION P2
 [With KX Station enhancement]
 HIGHWAY LAYOUT
 PANCRAS ROAD (NORTH)**

ARUP

13 Fitzroy Street
 London W1T 4BQ
 Tel +44(0)20 7836 1531 Fax +44(0)20 7580 3924
 www.arup.com

Scale at A1 1:500

Plot ID

Drawing Status
PRELIMINARY

Job No	Drawing No	Issue
67940-06	7311	03



NOTES:
 1. ALL DIMENSIONS ARE IN METRES.
 2. CO-ORDINATES ARE TO TRUNCATED ORDNANCE SURVEY.
 3. THE DRAWING INCORPORATES THE ANTICIPATED YEAR 2007 (BASE YEAR) TOPOGRAPHICAL MAPPING.

- KEY:**
- EXISTING MAPPING AT 2007
 - CARRIAGEWAY KERB
 - FOOTWAY/CYCLE TRACK EDGE
 - ⋯ PEDESTRIAN CROSSING STUDS
 - VISIBILITY SPLAY [BEYOND FOOTWAY]
 - TRAFFIC SIGNAL POST
 - TACTILE PAVING
 - PEDESTRIAN GUARDRAIL

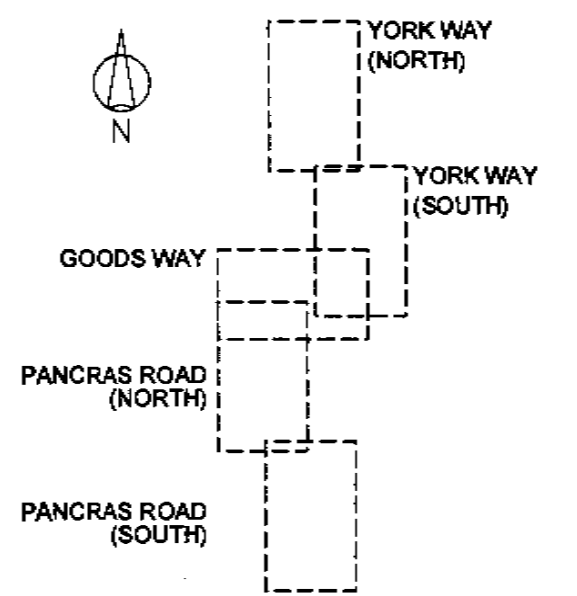

03	29/04/04	JTC	IF	IF
TITLE REVISED				
02	02/04/04	DSc	IF	IF
VARIOUS				
01	19/12/03	JTC	JTC	JRT
FIRST ISSUE				
Issue	Date	By	Chkd	Appd

Client:
**ARGENT ST GEORGE,
 LCR AND EXEL**

Job Title:
**KING'S CROSS CENTRAL
 ILLUSTRATIVE HIGHWAY
 PROPOSALS**

Drawing Title:
**OPTION P2
 [With KX Station enhancement]**

**HIGHWAY LAYOUT
 PANCRAS ROAD (NORTH)**

ARUP

13 Finsbury Street
 London W1T 4BQ
 Tel: +44(0)20 7836 1531 Fax: +44(0)20 7580 3824
 www.arup.com

Scale of A1: 1:500

Plot ID: _____

Drawing Status:
PRELIMINARY

Job No: 67940-06	Drawing No: 7312	Issue: 03
----------------------------	----------------------------	---------------------