

Re: 32 HILFIELD ROAD

Notes to accompany Dwgs No;

- SS050206/4
- SS 050206/5
- SS050206/6
- SS050206/7

1. This is a 'tree-friendly' scheme to improve conditions within the root zone of the existing tree and to keep the impact of work associated with the replacement fence works to a minimum.
2. The area of soft landscape under the tree has been extended
3. It is proposed to relocate the existing gate further away from the base of the tree
4. The steps and path leading to the gate will be constructed from large stone flags laid on the consolidated soil (i.e. no foundation works)
5. The proposed replacement fence is a post and panel construction; posts fixed in excavated pits approx 750 x 750 x 600mm deep starting at a depth of approx 600mm below existing ground level on the garden side (i.e. the principal root zone)

Sean Swallow
11/2/05

32 HILLFIELD ROAD, NW6 1PZ

EXISTING

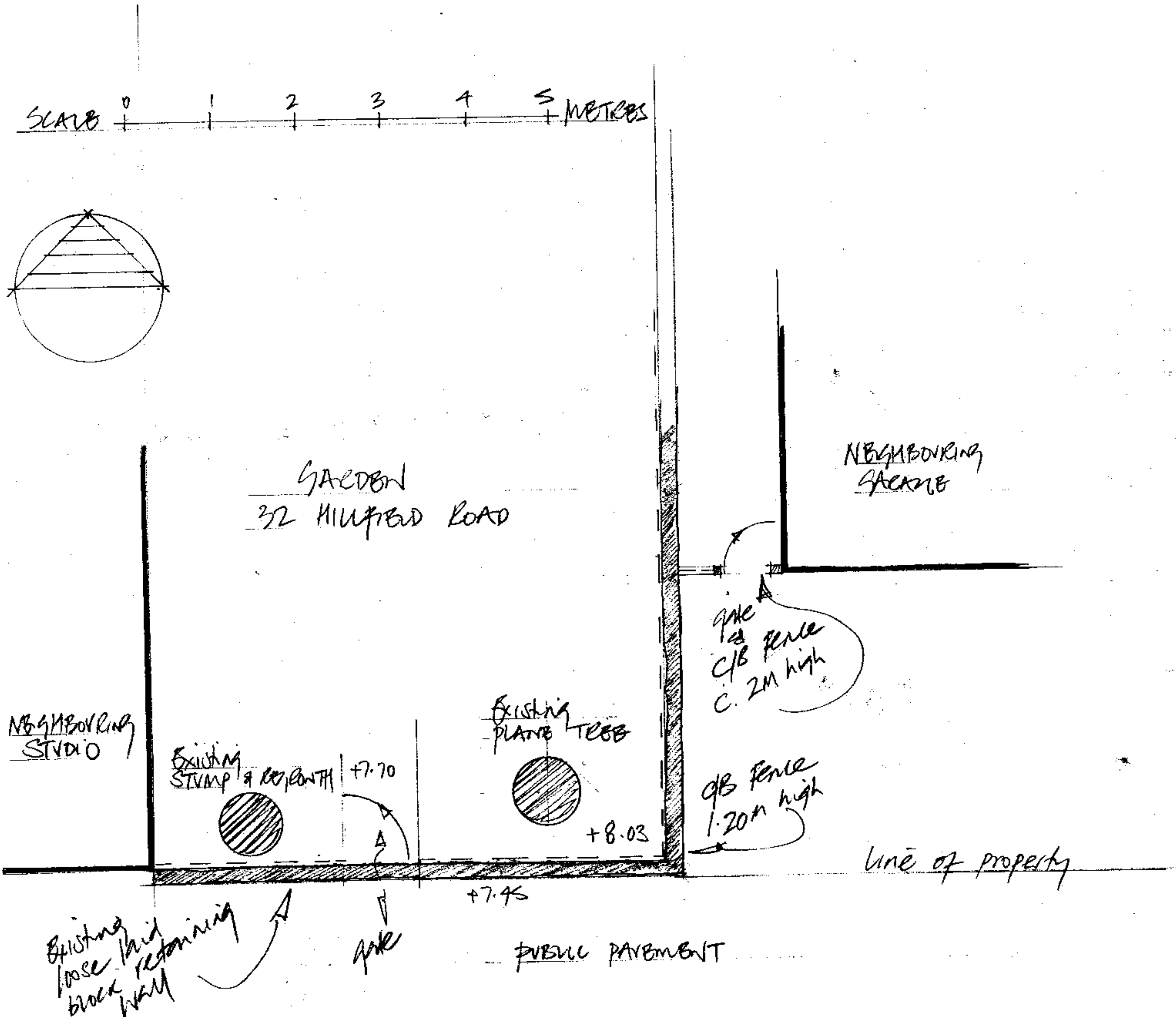

SS 050206/4

Client's Name: Mr and Mrs J Hodder-Williams,
Address: 32 Hillfield Road, West Hampstead, London, NW6 1PZ

Application Reference: 2004/4458/P
Drawing 1: Plan of Existing Site
Date: 27 January 2005

Sean Swallow Garden Design,
Unit 10, 81 Southern Row, London, W10 5AL
Tel: 0208 968 8555 Fax: 0208 969 4184
Mob: 07970 811 479

32 HILLFIELD ROAD, NW6 1PZ

PROPOSED

SCALE 0 1 2 3 4 5 METRES

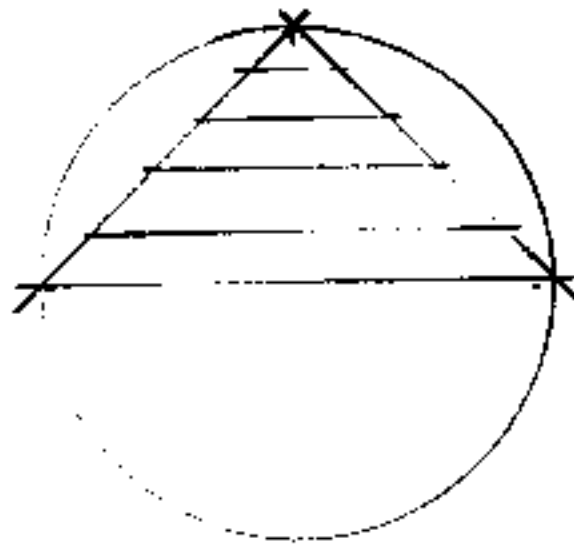

GARDEN
32 HILLFIELD ROAD

SHED
1.5 x 1.2

NEIGHBOURING
STUDIO

+7.95

2 steps
UP

+7.65

retain
existing
soil levels

existing
plane trees

+8.03

posts 2m
at C. center

gate
C/B fence
C. 2m high

proposed
C/B fence
1.8m high

line of property

+7.95

PUBLIC PAVEMENT

gate
retaining
wall

gate

proposed
close board
fence 1.8m ht

1.8m

NEIGHBOURING
GARDEN

post
100 x 100

BA
plane
tree

posts
approx 2m
centre

+8.03

BA
rose
retaining wall

+7.45

1.8m

Client's Name: Mr and Mrs J. Hodder-Williams,
Address: 32 Hillfield Road, West Hampstead, London, NW6 1PZ

Application Reference: 2004/4458/P
Drawing 1: Proposed Plan and Axonometric Sketch
Date: 27 January 2005

Sean Swallow Garden Design,
Unit 10, 81 Southern Row, London, W10 5AL
Tel: 0208 968 8555 Fax: 0208 969 4184
Mob: 07970 811 479

SS050206/5

32 HILLFIELD ROAD

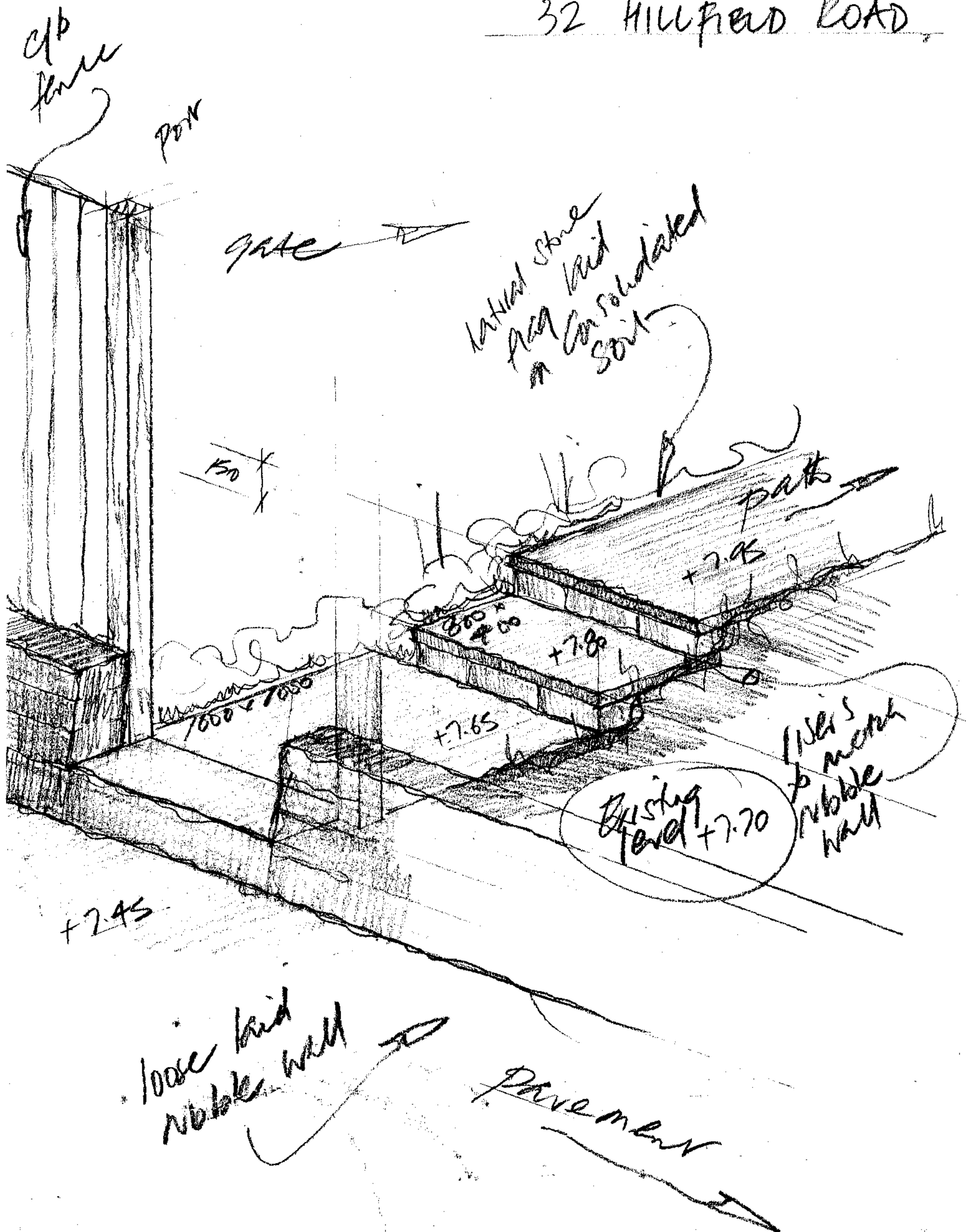

STEPS & FENCE AT GATE. (1:20) 45 030206/6

32 HILLFIELD ROAD

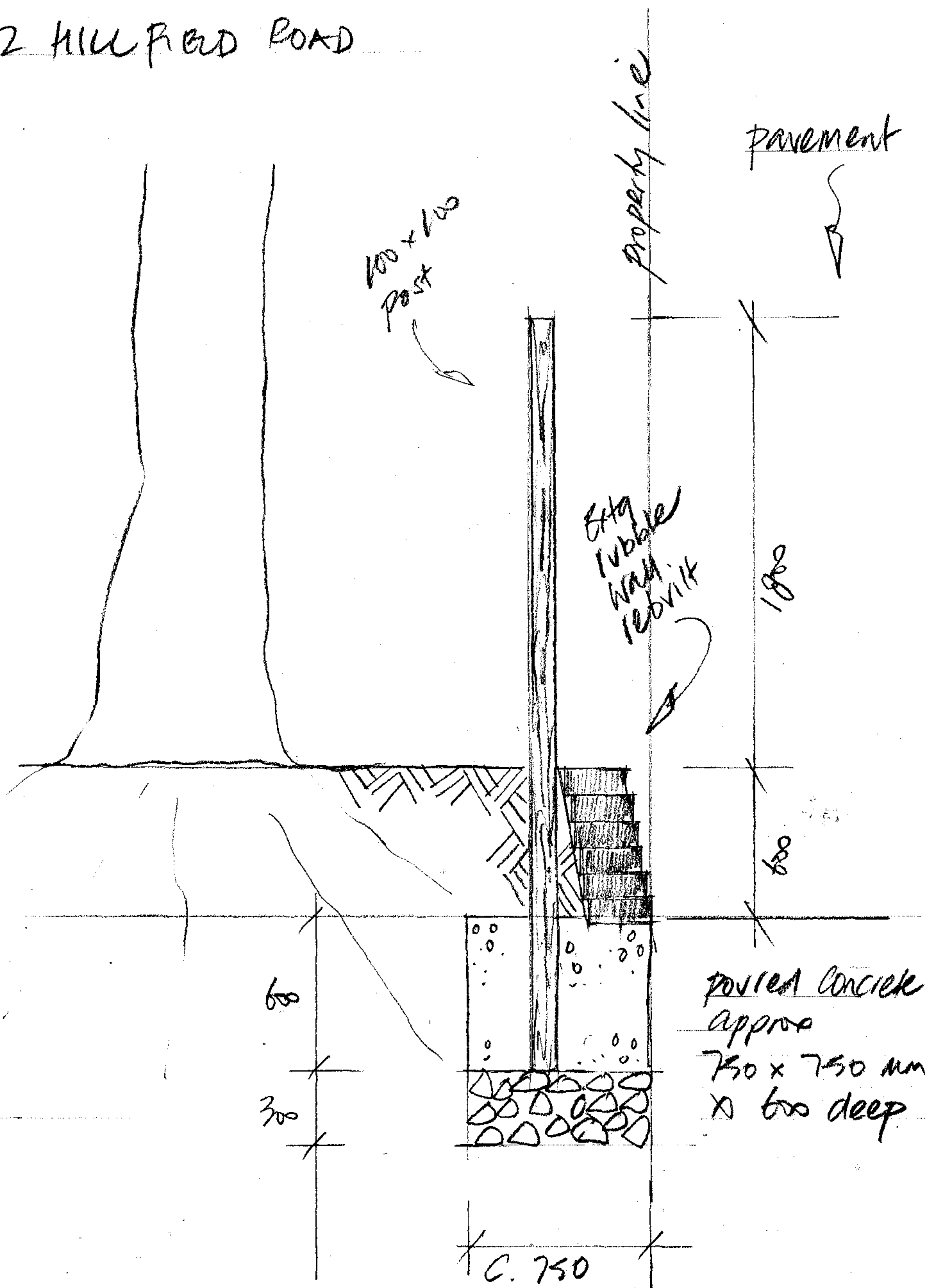

SECTION THROUGH PROPOSED FENCE & RETAINING WALL.
SS 050206/7 (1:20)