

CONSULTANCY, SITE INVESTIGATION  
CONSTRUCTION MATERIALS TESTING,  
CONTAMINATED LAND SURVEYS, DESK  
STUDIES, RISK ASSESSMENT.



**CONTAMINATION TEST REPORT**

**FOR**

**CROWN PLACE MEWS,**

**LONDON NW5**

**Report No: 22180**

**Date: November 2002**

# CONTAMINATION STUDY FOR CROWN PLACE MEWS, LONDON NW5

## 1 INTRODUCTION

- 1.1 Following instructions from Ing ealtoir, Chartered Structural Engineers, on behalf of Ashchurch Developments, a visit was made to the above site on the 24th October 2002, during which two soil samples were taken at the positions indicated in appendix A.
- 1.2 The samples were taken from two boreholes, at depths of 0.40m to 0.50m, corresponding to the Made Ground which covers the upper levels of the site.
- 1.3 The samples were tested for the full range of contaminants in accordance with ICRCL 59/83 guidelines.

## 2 OBSERVATIONS

- 2.1 With regard to the above and reference to the test results tabulated in appendix B, the following observations can be made in accordance with the current guidelines:-
- 2.2 Of the Group A contaminants (those which may pose a hazard to health), values of Arsenic marginally exceeded the CLEA Guideline Values for residential use.
- 2.3 The Group B contaminants are those which are phytotoxic but not normally hazardous to health. Of these, none were found to exceed the Dutch Intervention Values.
- 2.4 Of the 'other' contaminants, none were found to exceed the Dutch Intervention Values, or in their absence, the ICRCL Action Values for domestic usage.

## 3 CONCLUSIONS

- 3.1 We understand that the proposed site development does not include any garden areas. We therefore consider that the material tested is suitable for use on the site.

## 4 REFERENCES

- 1) ICRCL 59/83 (1987).
- 2) Current Dutch Limits (1994).
- 3) Recycling Derelict Land (ICE 1991).
- 4) CLEA Soil Guideline Values (2002)



Sarah Corrigan MSc.  
MRH Geotechnical Limited

**APPENDIX A**

**CONTAMINATION SAMPLE LOCATION PLAN**

# CONTAMINATION SAMPLE LOCATION PLAN

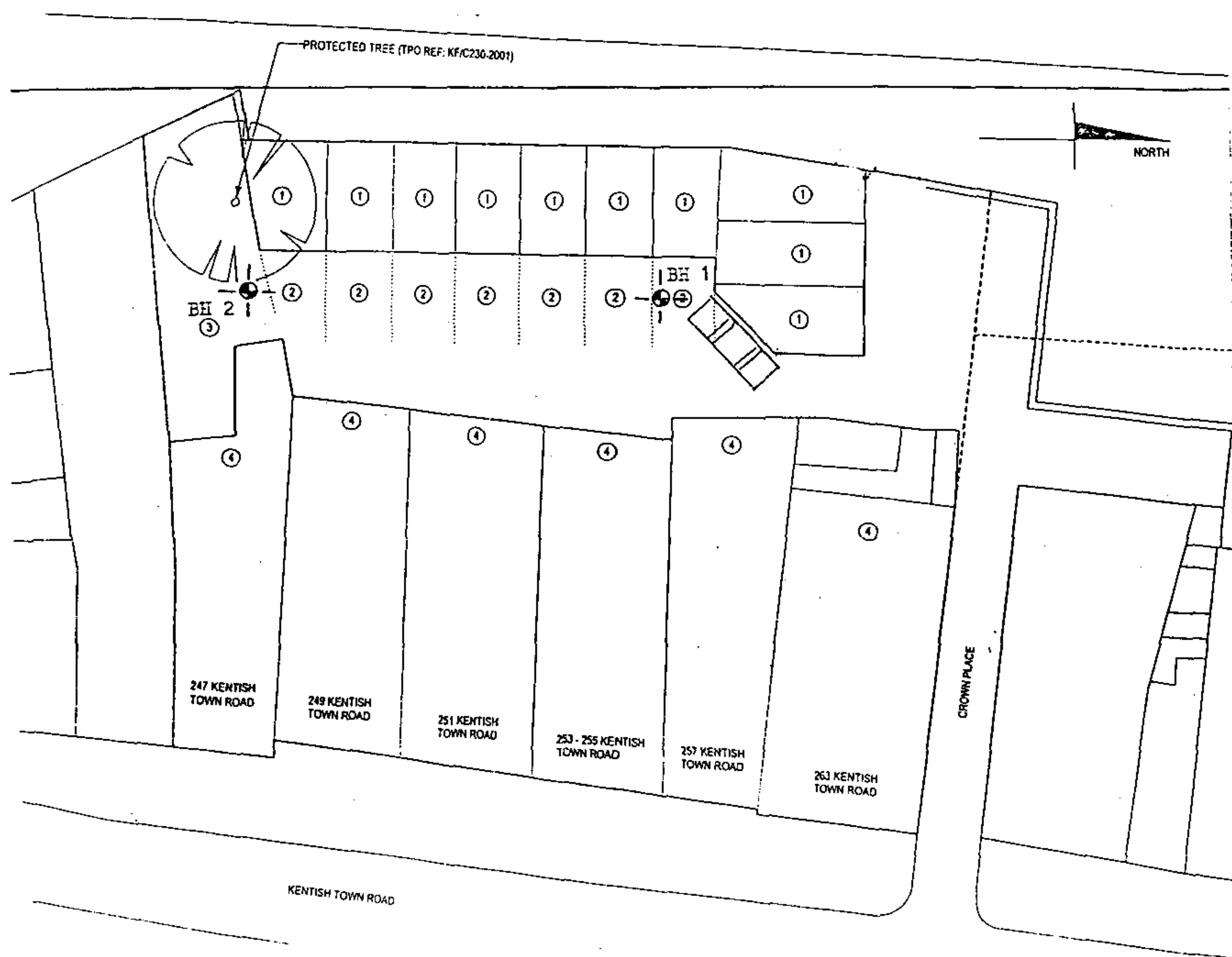

N.T.S.

**Location:**

Crown Place Mews,  
London  
NW5

**Appendix: A**

**Job No:** 22180

**Date:** November 2002

**APPENDIX B**  
**CONTAMINATION TEST RESULTS**

# Contamination Results For Crown Place Mews, London NW5

Job Ref: 22180

Lab. Mark S0233578 S0233580  
Depth (m) BH1 0.40 BH2 0.50  
Sample No C1 C2

## Contaminant:-

### Group A

Arsenic	20.8	20.2	(mg/kg)
Cadmium	2.1	2.5	(mg/kg)
Chromium (Hexavalent)	1.7	<1.0	(mg/kg)
Chromium (Total)	48.2	60.1	(mg/kg)
Lead	311.5	306.8	(mg/kg)
Mercury	2.0	<1.0	(mg/kg)
Selenium	<1.0	<1.0	(mg/kg)

### Group B

Boron (Water Soluble)	0.5	<0.5	(mg/kg)
Copper	97.8	69.8	(mg/kg)
Nickel	29.7	30.4	(mg/kg)
Zinc	183.8	306.8	(mg/kg)

### Other

Cyanide (Total)	<2.0	<2.0	(mg/kg)
Phenols *	<1.0	<1.0	(mg/kg)
Sulphide *	<2.0	11.9	(mg/kg)
Sulphur (Total) *	607	2506	(mg/kg)
pH *	7.5	9.3	n/a
PAH (Total) *	8.7	42.7	(mg/kg)
Cyanide (Free)	<2.0	<2.0	(mg/kg)
Total Sulphate (SO4)	953	5737	(mg/kg)
Thiocyanate	<10	<10	(mg/kg)
Total Petroleum Hydrocarbons (TPH) **	87.5	1370.6	(mg/kg)

## ICRCL Guidelines

Non Domestic Threshold Value Action Value  
Domestic Threshold Value Action Value

40	10
15	3
25	25
1000	600
2000	500
20	1
6	3
3	3
130	130
70	70
300	300
100	500
5	1000
250	1000
5000	20000
<5	<3
1000	10000
100	500
100	500

## Dutch Values

Target Intervention

29	55
0.6	12
100	380
85	530
0.3	10
36	190
35	210
140	720
5	50
0.05	40
1	100
100	5000

## CLEA SGV's

Residential with plant uptake Residential without plant uptake Commercial/Industrial Allotments

20	20	500	
1/2/8*	30	1400	
130	200	5000	130
450	450	750	
8	15	480	8
18	100	100	80\$
54	100	100	41\$

\$ Assumes consumption of homegrown veg.  
\* Values at pH of 6/7/8 respectively

n/d = Not detected  
< = Less than  
Domestic = Domestic gardens and allotments  
Non Domestic = Landscape areas, parks, playing fields, public open space \* Includes buildings and hard cover  
Group A = Contaminants which may pose a hazard to health  
Group B = Contaminants which are phytotoxic but not normally hazards to health  
\*\* = Assessed against Dutch values for Mineral Oils  
Trigger Values taken from ICRCL 59/83 (second edition)

Report Date: 15/11/02

Samples taken: 24/10/02

File No: 22180