

Use figured dimensions only and report any discrepancies in writing to the architect

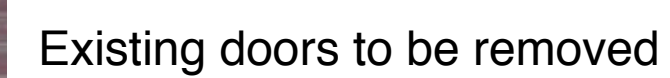

EXISTING DOORWAY - 15-17 EMERALD ST

-	Issued for information only	CW	14/07/06
P	Issued for planning	CW	24/08/06

Rev	Description	Drawn	Date
-----	-------------	-------	------

August 2006

Draw N° 116-PH-01		Rev P
Drawn by CW	Checked by Ak	Size A3

**HUGHBROUGHTONARCHITECTS**  
4 Addison Bridge Place London W14 8XP  
T 020 7602 8840 F 020 7602 5254 E info@hbachitects.co.uk