

- MAIN VERTICAL BUILDERS WORK HOLES
- HORIZONTAL HOLES
TO FORM PART OF THE ENABLING WORKS CONTRACT

PRIOR TO COMMENCEMENT OF WORK ON SITE THE
CONTRACTOR SHALL SUBMIT A METHOD
STATEMENT FOR APPROVAL BY THE DESIGN TEAM

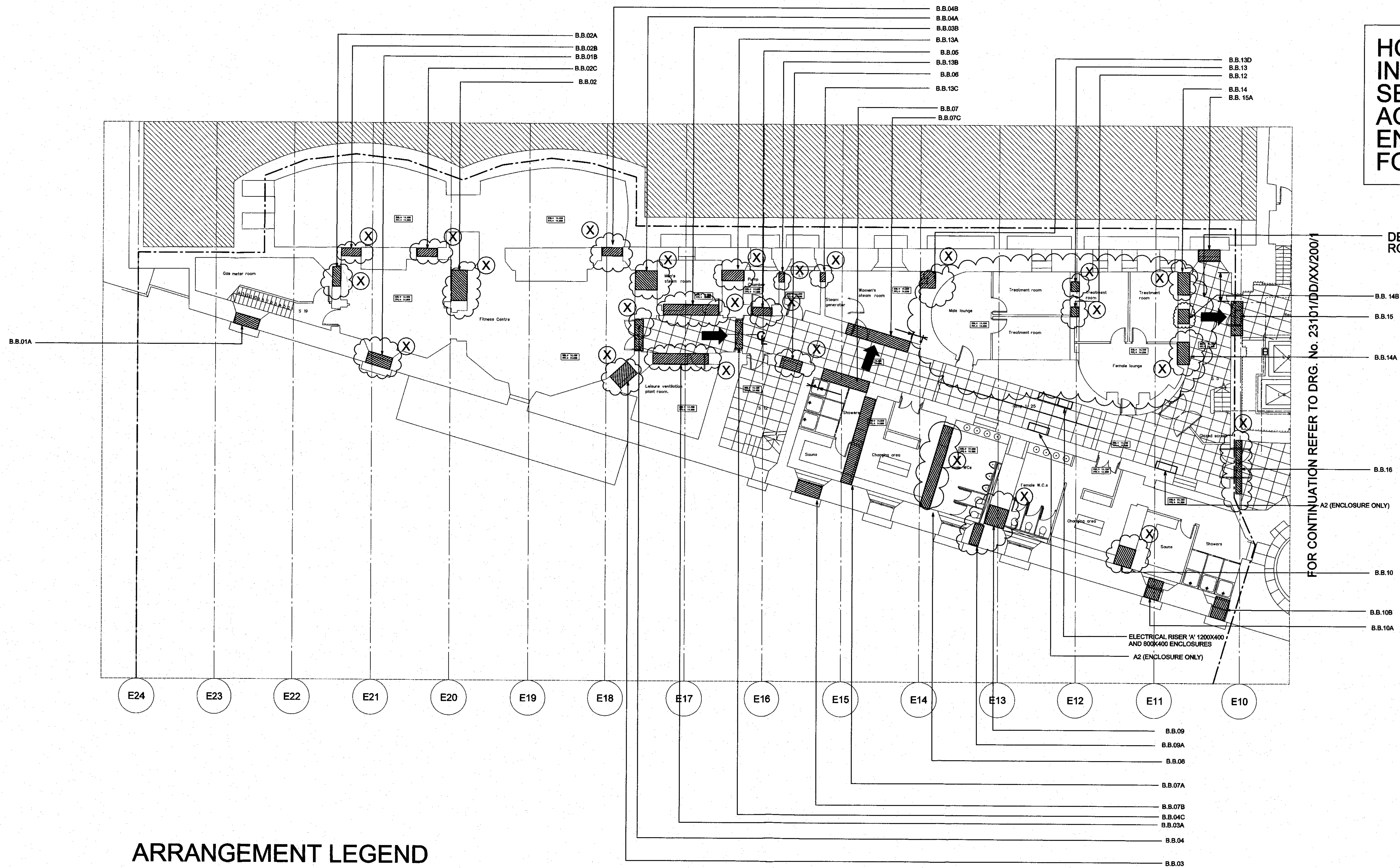

HOLE ARRANGEMENT IS
INDICATIVE ONLY. FINAL
SETTING OUT TO BE
AGREED WITH RESIDENT
ENGINEER ON SITE BEFORE
FORMING HOLE

DEPENDANT ON TREATMENT
ROOM LAYOUT

FOR CONTINUATION REFER TO DRG. No. 23101/DD/XX/200/1

Horizontal Reference	Builderswork Hole Size(s) (WxH)	Arrangement	Setting Out Horizontal	Setting Out Vertical
B.B.01	Omitted			
B.B.01A	Within existing window opening			
B.B.01B	Within existing window opening			
B.B.02	4 No. @ 200 Dia 4 No. @ 150 Dia 1 No. @ 50 Dia 1000x450 700x350			
B.B.02A	Omitted			
B.B.02B	350 Dia			
B.B.02C	5 No. @ 150 Dia 350 Dia			
B.B.03	1000x450 4 No. @ 200 Dia			
B.B.03A	2 No. @ 1000x450			
B.B.03B	2 No. @ 1000x450			
B.B.04	1 No. @ 50 Dia 1 No. @ 200 Dia 3 No. @ 150 Dia			
B.B.04A	2 No. @ 700x400			
B.B.04B	350 Dia			
B.B.04C	9 No. @ 150 Dia 1 No. @ 1000 Dia 150 Dia	1B 1C 1D 1E 2A 2B 2C 2D 2E 1A	Centre Line of Arch	Above arch
B.B.05	2 No. @ 150 Dia			
B.B.06	6 No. @ 200 Dia	N/A	400	Top of hole 150 below corridor spring point (as ARUP's detail)
B.B.07B	Within existing window opening			
B.B.07C	4 No. @ 200 Dia 4 No. @ 150 Dia 1000x350 2 No. @ 700x350 600x300 3 No. @ 150 Dia 2 No. @ 700x350 600x300 5 No. @ 150 Dia 2 No. @ 200 Dia	1G 1F 1G 1H 1A 1B 1C 1D	600	Top of hole 150 below corridor spring point (as ARUP's detail)
B.B.08	2 No. @ 700x350 600x300 3 No. @ 150 Dia 2 No. @ 700x350 600x300 5 No. @ 150 Dia 2 No. @ 200 Dia			
B.B.09	200 Dia 600x300 2 No. @ 700x350 1000x350 2 No. @ 150 Dia			
B.B.09A	2 No. @ 700x350 1000x350 2 No. @ 150 Dia			
B.B.10	Within existing window opening			
B.B.10B	Within existing window opening			
B.B.11	Omitted			
B.B.12	1 No. @ 250 Dia 1 No. @ 150 Dia			
B.B.13	250 Dia 2 No. @ 150 Dia			
B.B.13A	2 No. @ 500x400 3 No. @ 150 Dia			
B.B.13B	2 No. @ 500x400 1 No. @ 100 Dia			
B.B.13C	2 No. @ 500x400 1 No. @ 100 Dia			
B.B.13D	2 No. @ 500x400 1 No. @ 50 Dia			
B.B.14	2 No. @ 250 Dia 4 No. @ 150 Dia			
B.B.14A	4 No. @ 150 Dia			
B.B.14B	1 No. @ 150 Dia			
B.B.15	2 No. @ 250 Dia		1650	Bottom of Hole 2450 AFFL (Based on 2300 Ceiling)
B.B.15A	In Existing Window Opening			
B.B.16	4 No. @ 200 Dia 13 No. @ 200 Dia 300x300			

ARRANGEMENT LEGEND

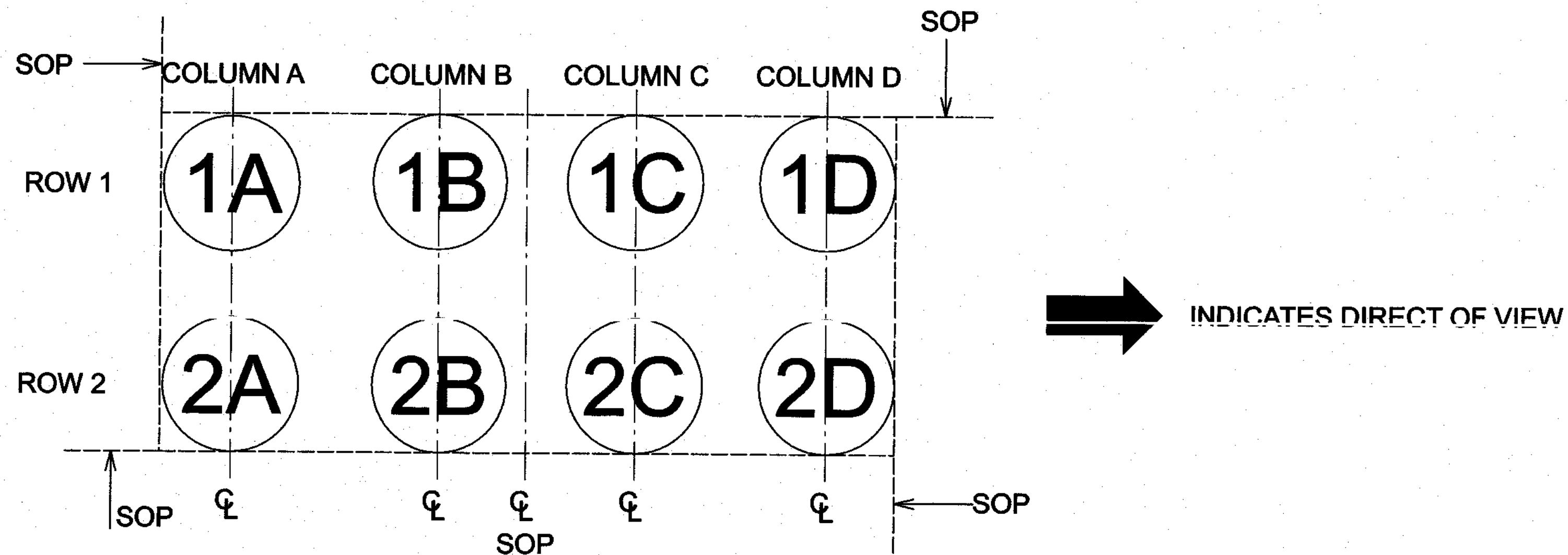

BASE DRAWINGS USED IN COMPLETION OF THIS DRG

NOTES
1. WORK TO FIGURED DIMENSIONS ONLY.
2. THIS DRAWING TO BE READ IN CONJUNCTION WITH ALL RELEVANT ARCHITECTS AND STRUCTURAL ENGINEERS DRAWINGS.
3. THIS DRAWING TO BE READ IN CONJUNCTION WITH ALL RELEVANT FABER MAUNSELL DRAWINGS.

4. REFER TO STRUCTURAL ENGINEERS DRAWING FOR FURTHER DETAILS OF THE FORMATION FOR THE BUILDING WORKS.
5. ALL DIMENSIONS SHOWN ARE CLEAR INTERNAL.

6. A1, A2, B1 & B2 - SEE DRAWINGS NO. 23101/DD/XX/200/1, 23101/DD/XX/200/2, 23101/DD/XX/200/3, 23101/DD/XX/200/4, 23101/DD/XX/200/5 & 23101/DD/XX/200/6 FOR RISER DETAILS.

7. QUALIFICATIONS
- EXCLUDES WORK ASSOCIATED WITH LINING CHIMNEY FLUES / BREAKING IN, REPAIR, RUBBISH REMOVAL, SUPPLEMENTARY OPENINGS TO FACILITATE LINING WORKS.

LEGEND

HORIZONTAL BUILDERSWORK HOLE

VERTICAL BUILDERSWORK HOLE

ENCLOSURE

EXISTING FLOOR TRENCH

PROPOSED FLOOR TRENCH

LOCATION OF FLOOR STEEL

ON HOLD SUBJECT TO STRUCTURAL AGREEMENT

ON HOLD SUBJECT TO FINAL ROOM LAYOUT

ON HOLD SUBJECT TO FINAL ROOM LAYOUT

ON HOLD SUBJECT TO FINAL ROOM LAYOUT

ON HOLD SUBJECT TO FINAL ROOM LAYOUT

ON HOLD SUBJECT TO FINAL ROOM LAYOUT

ON HOLD SUBJECT TO FINAL ROOM LAYOUT

ON HOLD SUBJECT TO FINAL ROOM LAYOUT

ON HOLD SUBJECT TO FINAL ROOM LAYOUT

ON HOLD SUBJECT TO FINAL ROOM LAYOUT

ON HOLD SUBJECT TO FINAL ROOM LAYOUT

ON HOLD SUBJECT TO FINAL ROOM LAYOUT

ON HOLD SUBJECT TO FINAL ROOM LAYOUT

ON HOLD SUBJECT TO FINAL ROOM LAYOUT

ON HOLD SUBJECT TO FINAL ROOM LAYOUT

ON HOLD SUBJECT TO FINAL ROOM LAYOUT

ON HOLD SUBJECT TO FINAL ROOM LAYOUT

ON HOLD SUBJECT TO FINAL ROOM LAYOUT

ON HOLD SUBJECT TO FINAL ROOM LAYOUT

ON HOLD SUBJECT TO FINAL ROOM LAYOUT

ON HOLD SUBJECT TO FINAL ROOM LAYOUT

ON HOLD SUBJECT TO FINAL ROOM LAYOUT

ON HOLD SUBJECT TO FINAL ROOM LAYOUT

ON HOLD SUBJECT TO FINAL ROOM LAYOUT

ON HOLD SUBJECT TO FINAL ROOM LAYOUT

ON HOLD SUBJECT TO FINAL ROOM LAYOUT

ON HOLD SUBJECT TO FINAL ROOM LAYOUT

ON HOLD SUBJECT TO FINAL ROOM LAYOUT

ON HOLD SUBJECT TO FINAL ROOM LAYOUT

ON HOLD SUBJECT TO FINAL ROOM LAYOUT

ON HOLD SUBJECT TO FINAL ROOM LAYOUT

ON HOLD SUBJECT TO FINAL ROOM LAYOUT

ON HOLD SUBJECT TO FINAL ROOM LAYOUT

ON HOLD SUBJECT TO FINAL ROOM LAYOUT

ON HOLD SUBJECT TO FINAL ROOM LAYOUT

ON HOLD SUBJECT TO FINAL ROOM LAYOUT

ON HOLD SUBJECT TO FINAL ROOM LAYOUT

ON HOLD SUBJECT TO FINAL ROOM LAYOUT

ON HOLD SUBJECT TO FINAL ROOM LAYOUT

ON HOLD SUBJECT TO FINAL ROOM LAYOUT

ON HOLD SUBJECT TO FINAL ROOM LAYOUT

ON HOLD SUBJECT TO FINAL ROOM LAYOUT

ON HOLD SUBJECT TO FINAL ROOM LAYOUT

ON HOLD SUBJECT TO FINAL ROOM LAYOUT

ON HOLD SUBJECT TO FINAL ROOM LAYOUT

ON HOLD SUBJECT TO FINAL ROOM LAYOUT

ON HOLD SUBJECT TO FINAL ROOM LAYOUT

ON HOLD SUBJECT TO FINAL ROOM LAYOUT

ON HOLD SUBJECT TO FINAL ROOM LAYOUT

ON HOLD SUBJECT TO FINAL ROOM LAYOUT

ON HOLD SUBJECT TO FINAL ROOM LAYOUT

ON HOLD SUBJECT TO FINAL ROOM LAYOUT

ON HOLD SUBJECT TO FINAL ROOM LAYOUT

ON HOLD SUBJECT TO FINAL ROOM LAYOUT

ON HOLD SUBJECT TO FINAL ROOM LAYOUT

ON HOLD SUBJECT TO FINAL ROOM LAYOUT

ON HOLD SUBJECT TO FINAL ROOM LAYOUT

ON HOLD SUBJECT TO FINAL ROOM LAYOUT

ON HOLD SUBJECT TO FINAL ROOM LAYOUT

ON HOLD SUBJECT TO FINAL ROOM LAYOUT

ON HOLD SUBJECT TO FINAL ROOM LAYOUT

ON HOLD SUBJECT TO FINAL ROOM LAYOUT

ON HOLD SUBJECT TO FINAL ROOM LAYOUT

ON HOLD SUBJECT TO FINAL ROOM LAYOUT

ON HOLD SUBJECT TO FINAL ROOM LAYOUT

ON HOLD SUBJECT TO FINAL ROOM LAYOUT

ON HOLD SUBJECT TO FINAL ROOM LAYOUT

ON HOLD SUBJECT TO FINAL ROOM LAYOUT

ON HOLD SUBJECT TO FINAL ROOM LAYOUT

ON HOLD SUBJECT TO FINAL ROOM LAYOUT

ON HOLD SUBJECT TO FINAL ROOM LAYOUT

ON HOLD SUBJECT TO FINAL ROOM LAYOUT

ON HOLD SUBJECT TO FINAL ROOM LAYOUT