

Access

As previously noted, there is stepped access into the existing property, with access to the rear garden via lower ground floor level before ascending external steps which offers limited accessibility for disabled persons.

The proposal aims to improve the accessibility to rear garden private amenity space though offering residents and visitors to the property access to rear garden from principle storey level, whether fully able bodied or disabled, which will improve current arrangements.

No alterations are intended to current access into the property from street level.

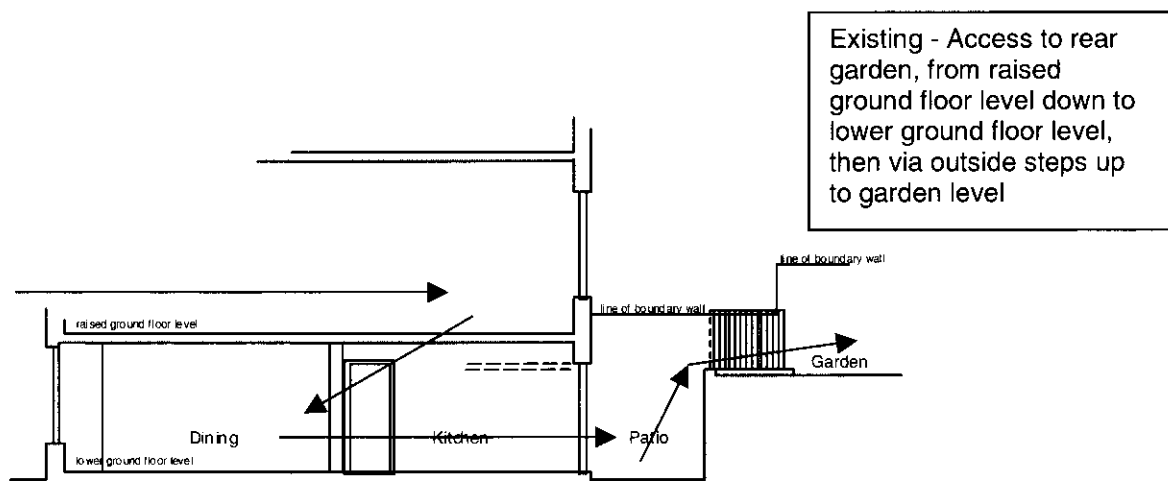

Section A - A
Existing Section

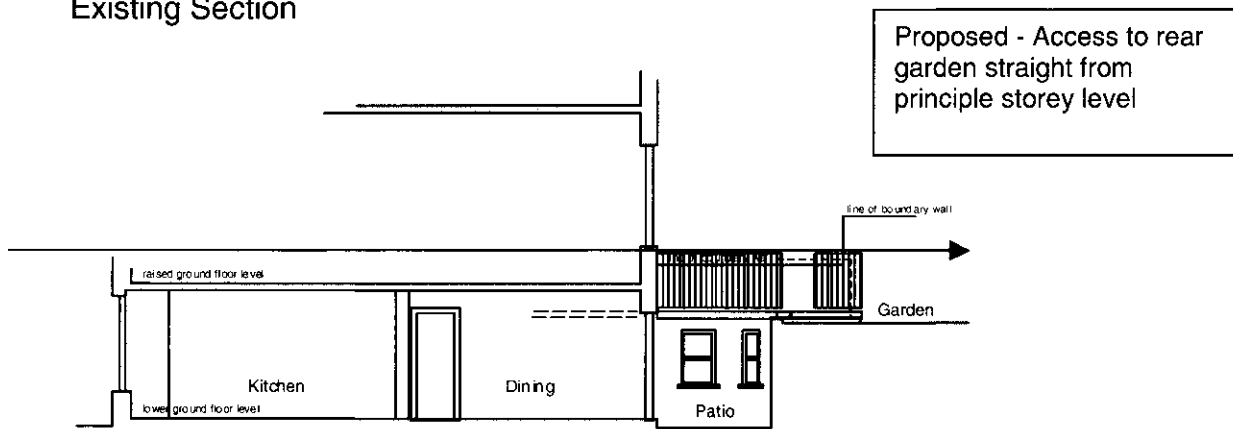

Section A - A
Proposed Section

