

**RECEIVED**  
12 MAY 2007

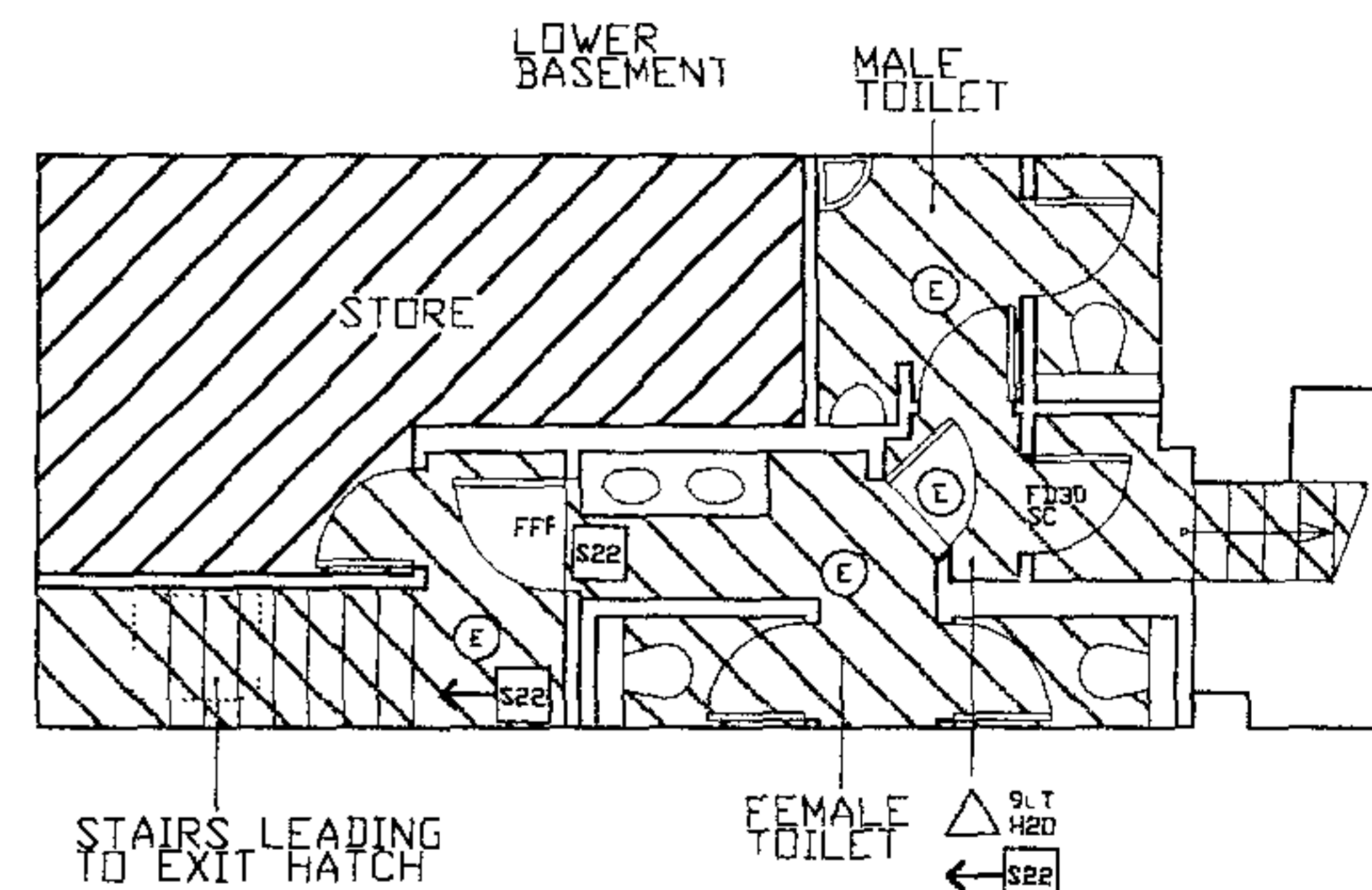

# NOTES

1. HATCH TO EMERGENCY EXIT STAIRS FROM BASEMENT BELOW

## KEY

(SD) SMOKE DETECTOR

(HD) HEAT DETECTOR

(E) MAINTAINED EMERGENCY LIGHTS TO BS 5499

△ 2KG CO2 CARBON DIOXIDE EXTINGUISHER

△ 9LT H2O WATER EXTINGUISHER

△ 4KG POW POWDER EXTINGUISHER

S22 → FIRE EXIT, EXIT, OR EMERGENCY EXIT NOTICE WITH DIRECTION INDICATED

S22 FIRE EXIT, EXIT, OR EMERGENCY EXIT NOTICE

△ FIRE ALARM CALL POINT

FFT DOOR FREE FROM FASTENINGS

🔊 FIRE ALARM SOUNDER

FD30 SC SELF SING DOOR WITH 30 MIN FIRE AND SMOKE RESISTANCE

▨ AREA FOR CONSUMPTION OF INTOXICATING LIQUOR

▨ AREA FOR STORAGE OF LIQUOR AND BAR COUNTER

□ KITCHEN AND STAFF AREAS

▨ TOILETS AND PASSAGEWAYS

— AMBIT OF LICENSED PREMISES

TITLE  
GROUND FLOOR, MEZZANINE LEVEL AND LOWER BASEMENT

PROJECT  
COTTONS

DRAWING NUMBER  
05-09-01

DATE  
07/07/05

SCALE  
1:100

DRAWN BY  
T TAYLOR