

Drg. Ref. : 886-MS-103

Notes :

Revisions :

A - - - - -07 TENDER ISSUE.

Design Consultant :

Fowler Martin
Chartered Building Services Engineers

Fowler Martin Ltd
First Floor
132 Station Road
Chingford
London E4 6AB

Tel: 020 8524 8848
Fax: 020 8524 8858
E-mail: mail@fowlermartin.com
http://www.fowlermartin.com

Client :

UNIVERSITY COLLEGE LONDON
ESTATES AND FACILITIES DIVISION
GOWER STREET
LONDON
WC1E 6BT

Project :

WILKINS BUILDING

LIBRARY REFURBISHMENT- PHASE 1B

Title :

PART ROOF PLAN

NEW ROOF MOUNTED MECHANICAL
SERVICES PLANT AND SYSTEMS

Designed by :	IM	Approved by :	
Drawn by :	SH	Date :	12-03-07
Dr. Ref. :	886-MS-103	A	

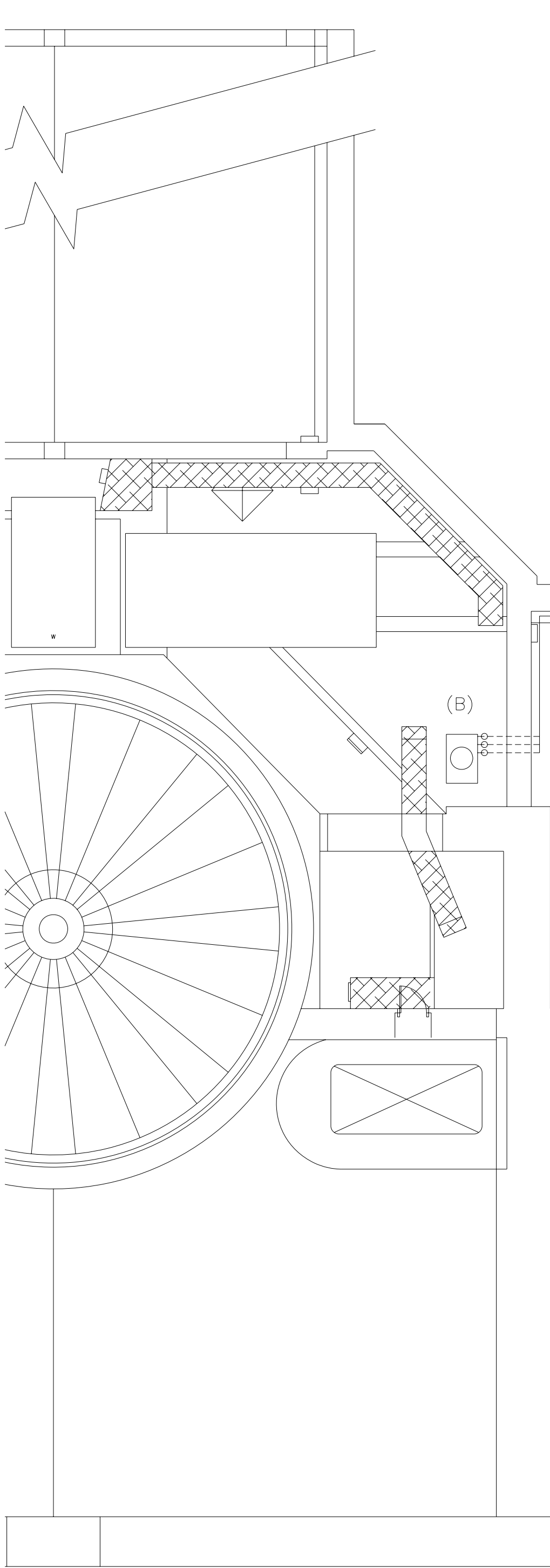

TOILET EXTRACT FAN (A)

Unit Code		MID OCTAVE BANDS								dBA @
		63	125	250	500	1k	2k	4k	8k	3m
ACQ500-34C	Inlet	79	71	66	60	57	58	54	51	45
	Outlet	76	72	71	71	74	69	70	66	57
	Breakout	74	73	67	62	57	55	54	50	45

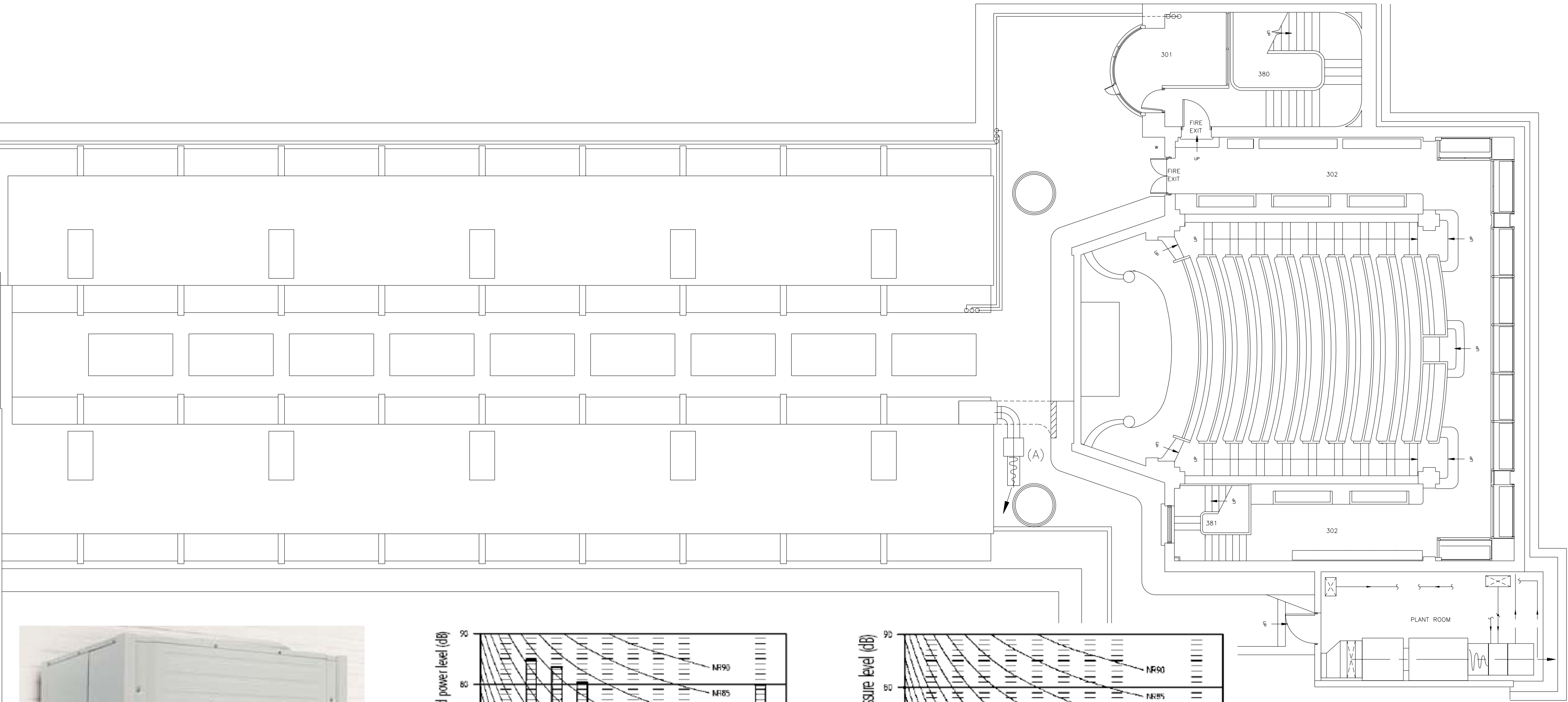

DAIKIN HEAT RECOVERY CONDENSING UNIT (B)

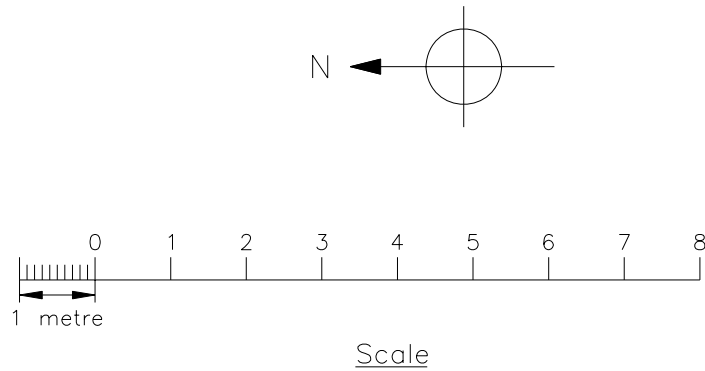
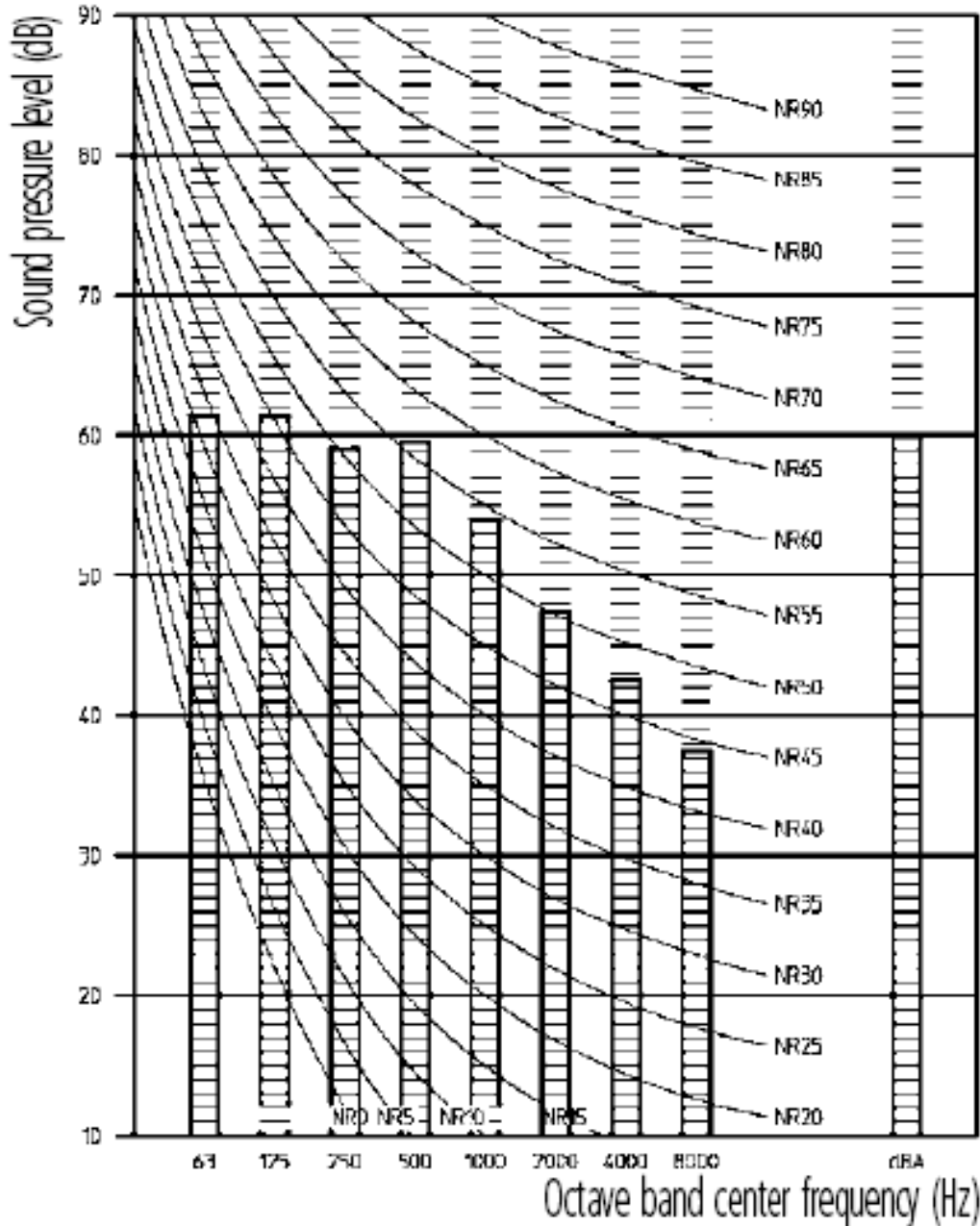
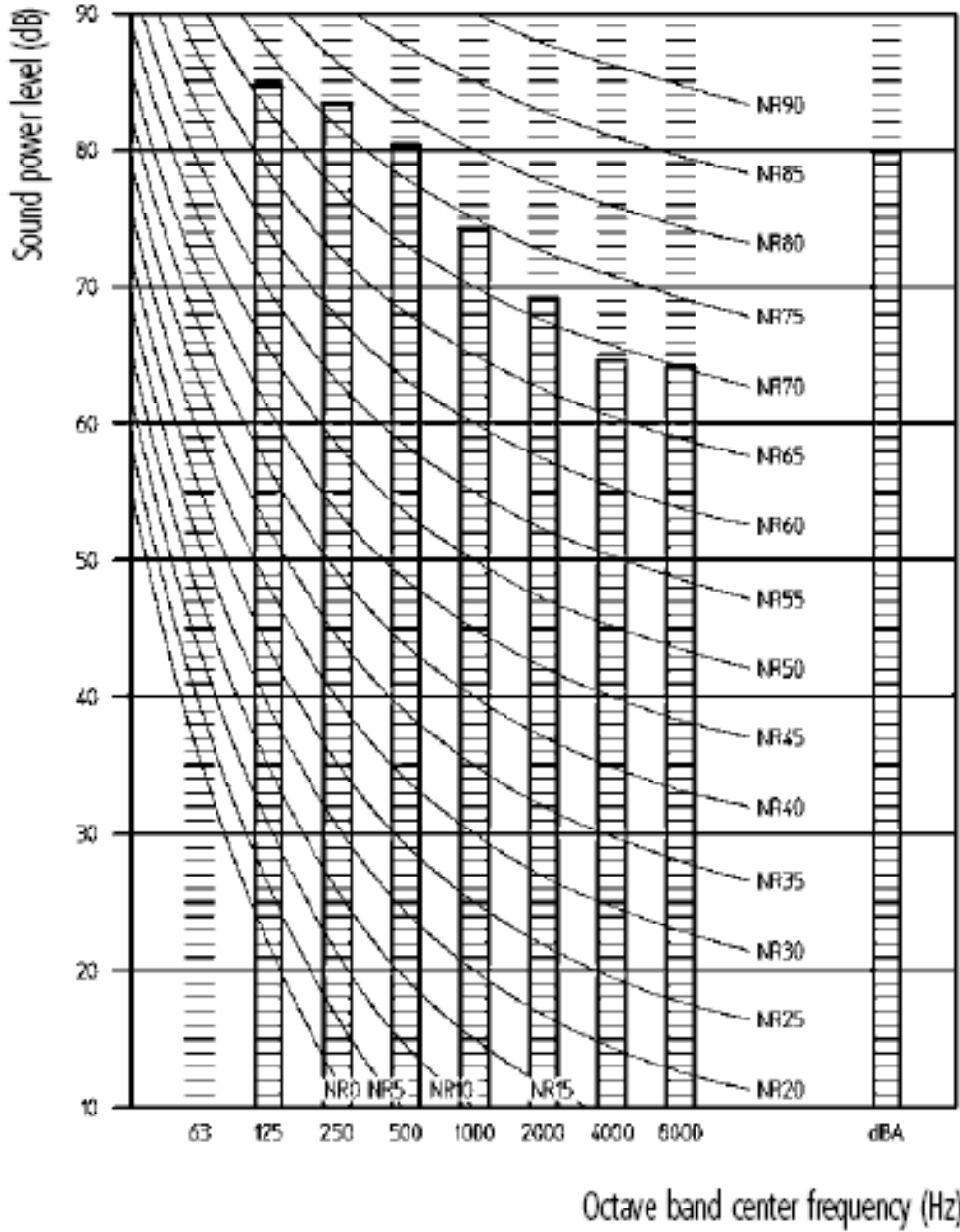

Dwg. Ref. : 886-MS-106

Notes :

Revisions :

Design Consultant :

Fowler Martin
Chartered Building Services Engineers

Fowler Martin Ltd
First Floor
132 Station Road
Chingford
London E4 6AB
Tel: 020 8524 8848
Fax: 020 8524 8858
E-mail: mail@fowlermartin.com
http://www.fowlermartin.com

Client :

UNIVERSITY COLLEGE LONDON
ESTATES AND FACILITIES DIVISION
GOWER STREET
LONDON
WC1E 6BT

Project :

WILKINS BUILDING

LIBRARY REFURBISHMENT- PHASE 1B

Title :

PART ROOF PLAN

NEW ROOF MOUNTED MECHANICAL
SERVICES PLANT AND SYSTEMS WITH
NOISE CRITERIA AND PLANT PHOTOGRAPHS

Designed by : IM Approved by :

Drawn by : SH Date : 12-03-07

Dwg. Ref. : 886-MS-106 A