

PLAN

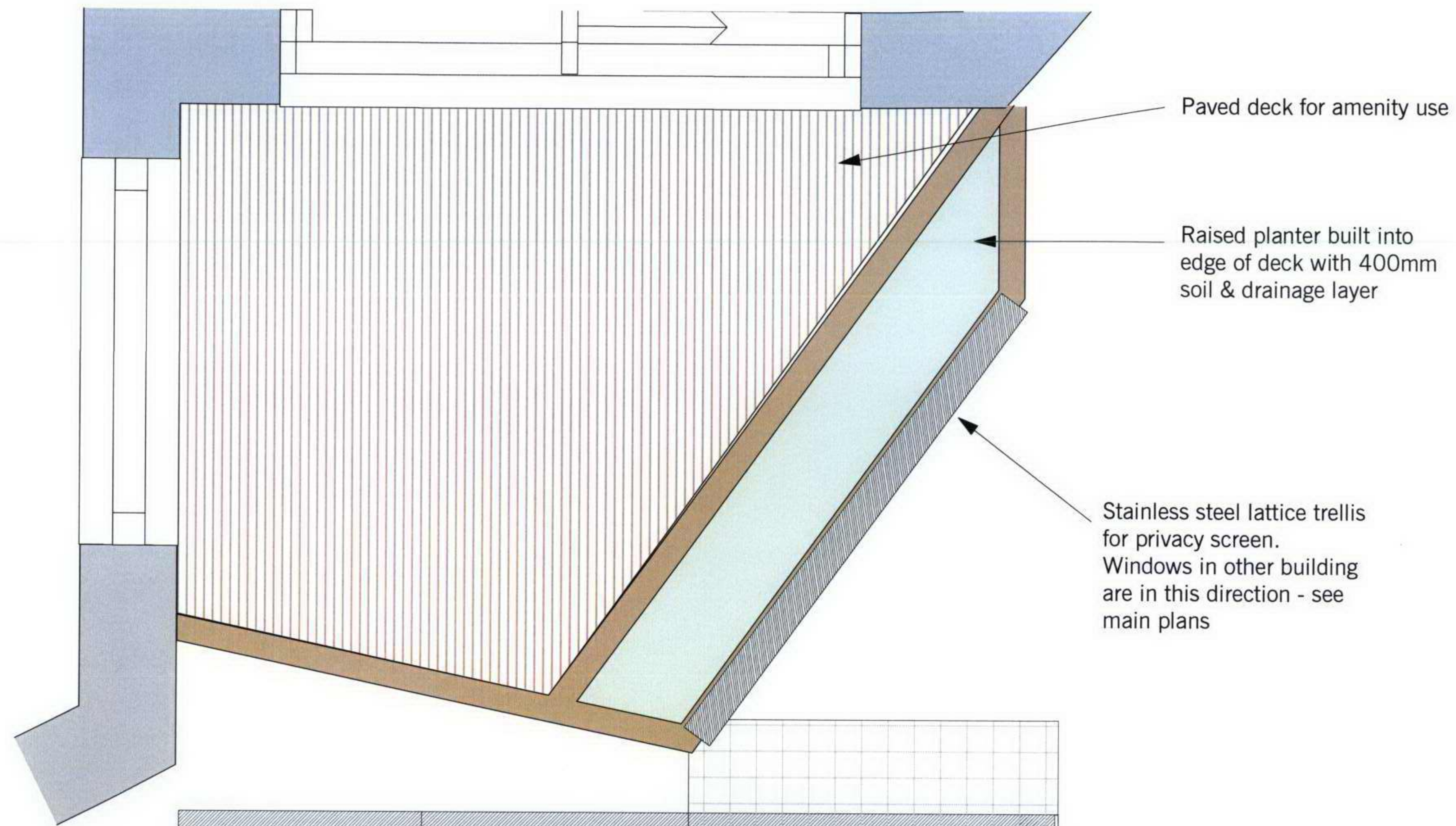

PHOTO

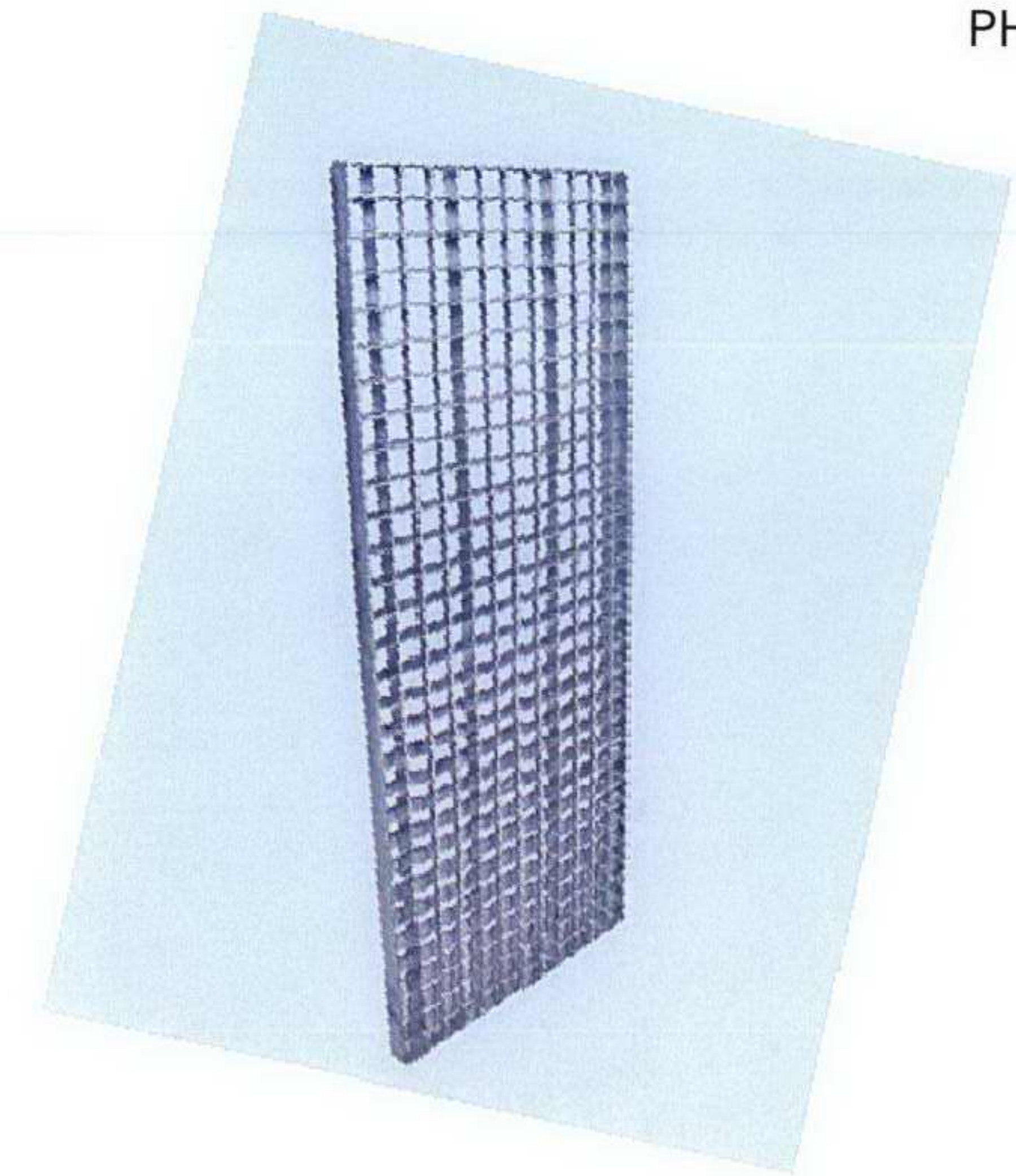

Elefant® welded stainless steel gratings are very strong relative to their light construction. The grid of flat bars allows light through while preventing views through at an oblique angle. The open nature prevents excessive wind load.

ELEVATION

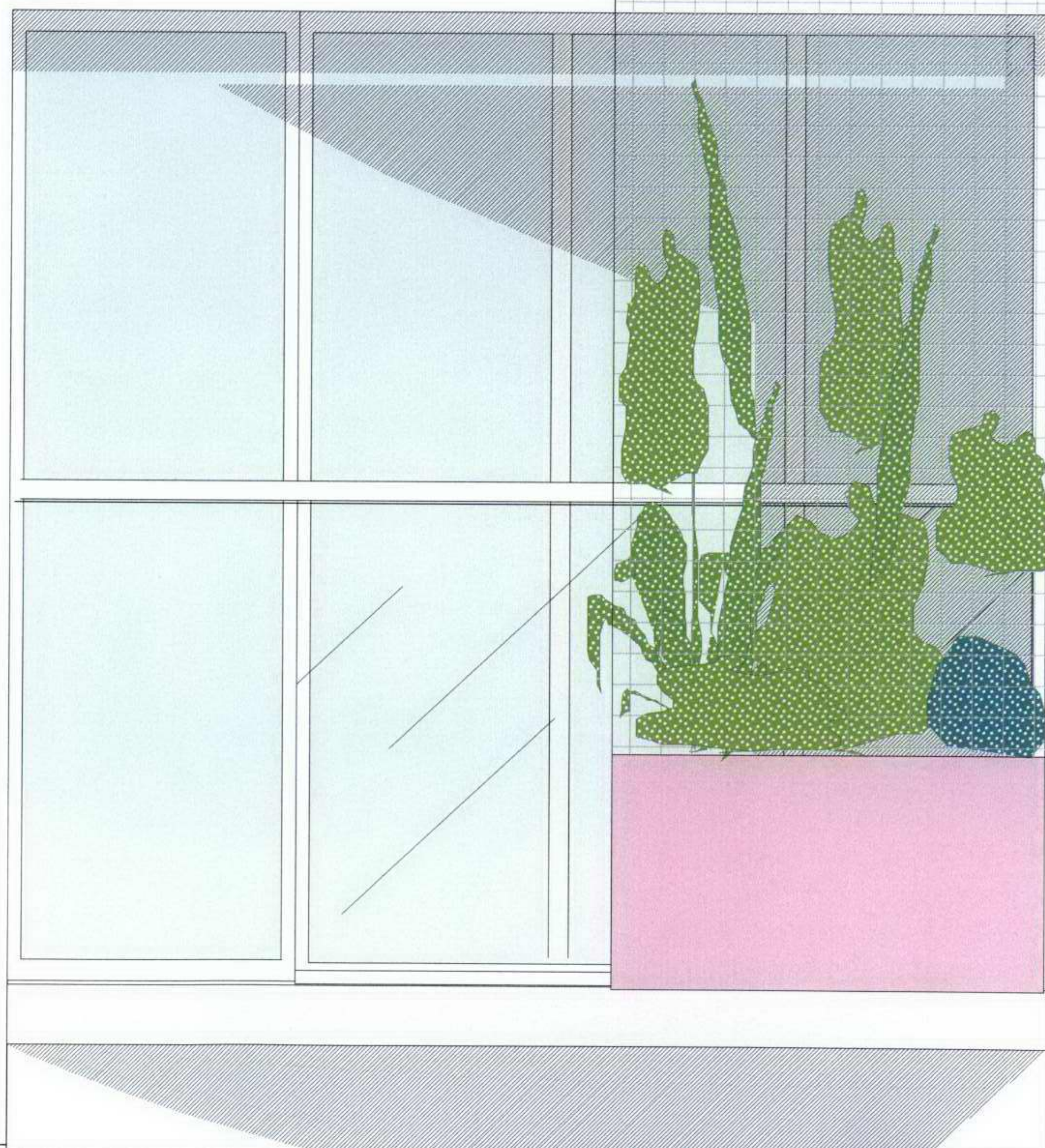

Stainless steel lattice privacy screen fixed beside window frame to packing-piece so that window opening is unobstructed

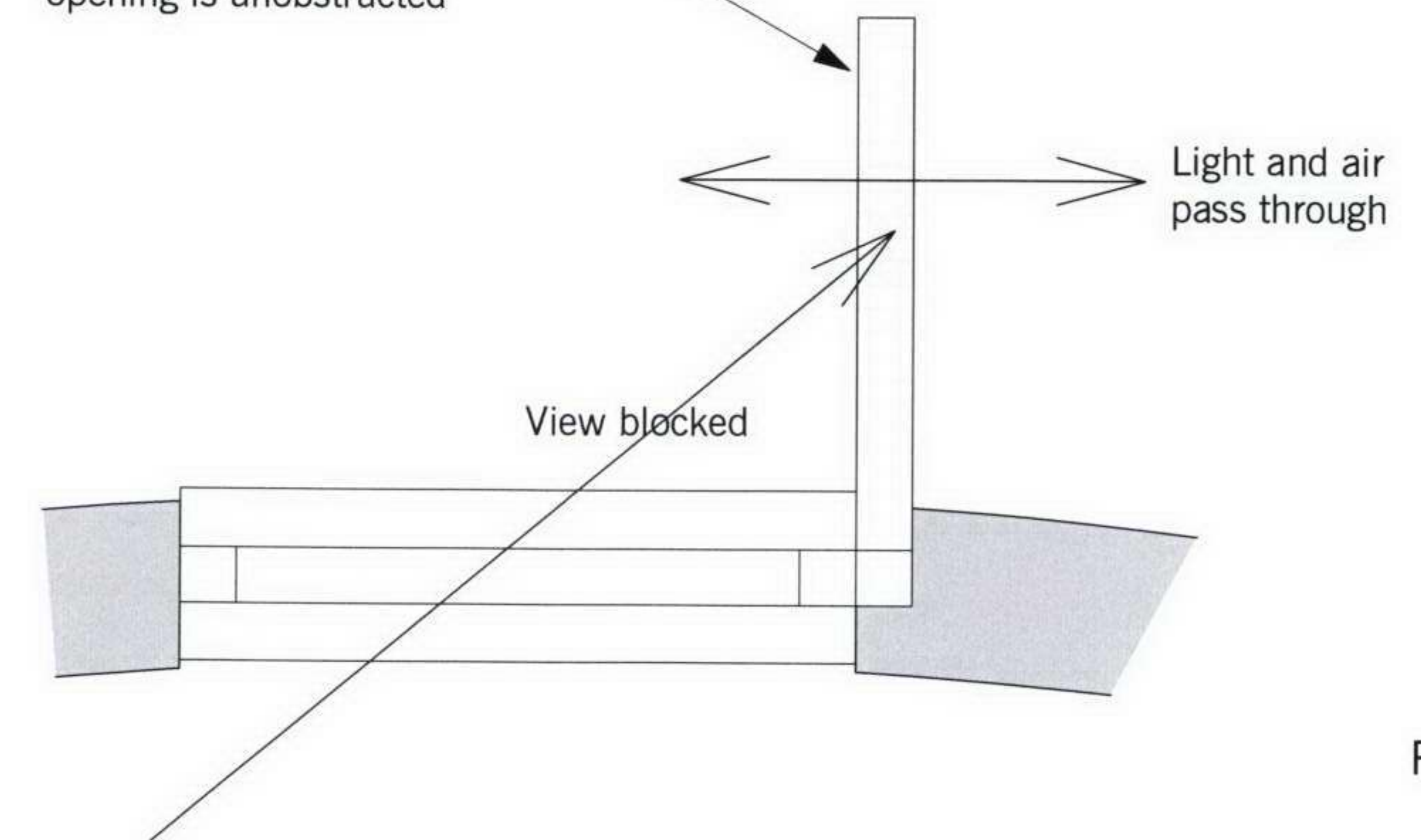

PLAN



Garden planting is notional -  
subject to biodiversity optimization  
by consultant ecologist

Nest boxes from <http://www.bioquip.net/>

PLAN 1:100 scale

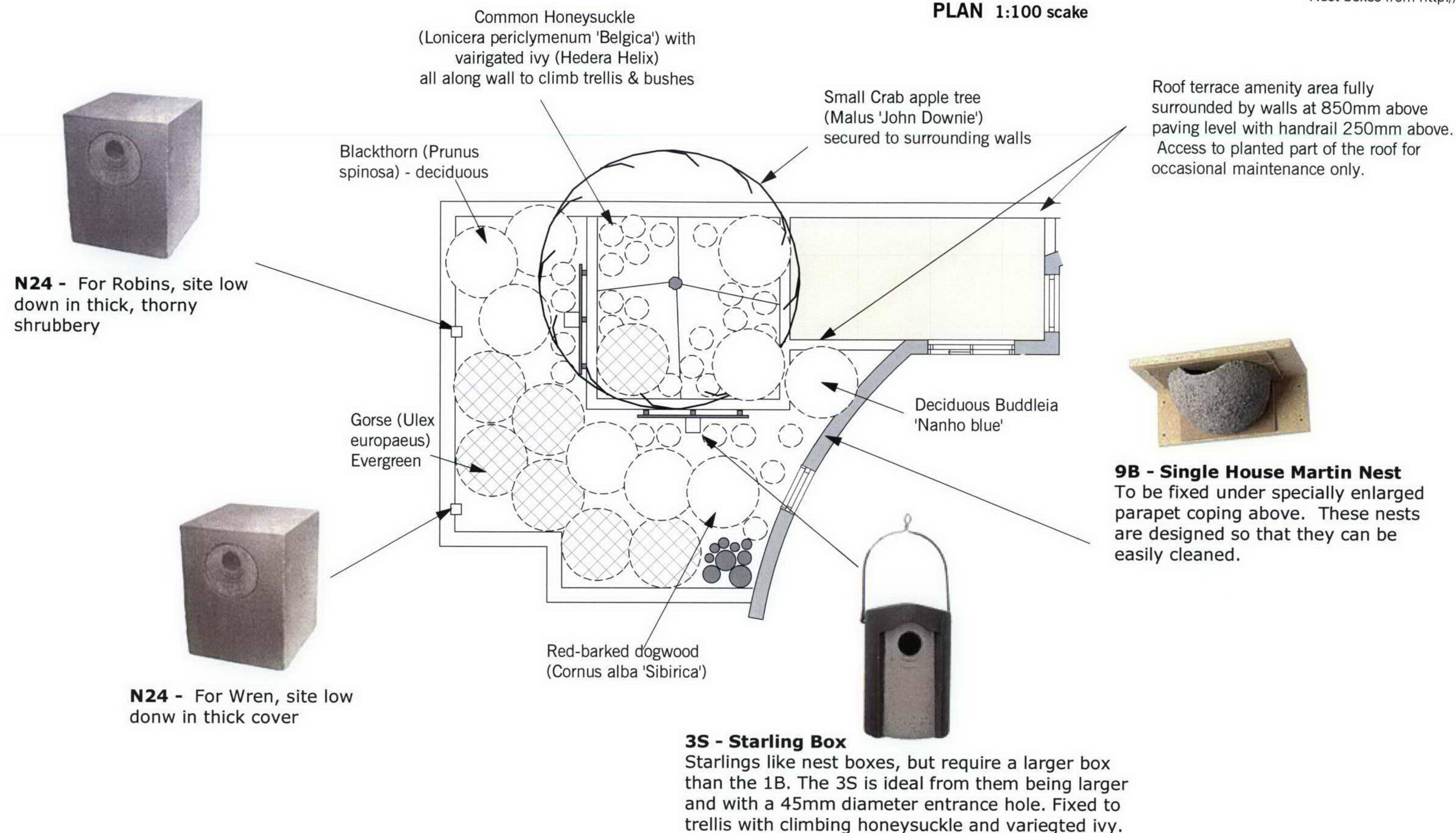

The build up should always consist of:

- \* Moisture retention/ protection layer
- \* Drainage layer
- \* Filter layer
- \* Manufactured/ Recyled Growing medium
- \* Low maintenance does NOT mean NO maintenance!  
Even an Ecological landscape will require a twice-yearly inspection.

<http://www.livingroofs.org/>



Roof terrace amenity area fully surrounded by walls at 850mm above paving level with handrail 250mm above. Access to planted part of the roof for occasional maintenance only.

Small Crab apple tree (Malus 'John Downie') secured to surrounding walls

Common Honeysuckle (Lonicera periclymenum 'Belgica') with variegated ivy (Hedera Helix) all along wall to climb trellis & bushes

Blackthorn (Prunus spinosa) - deciduous

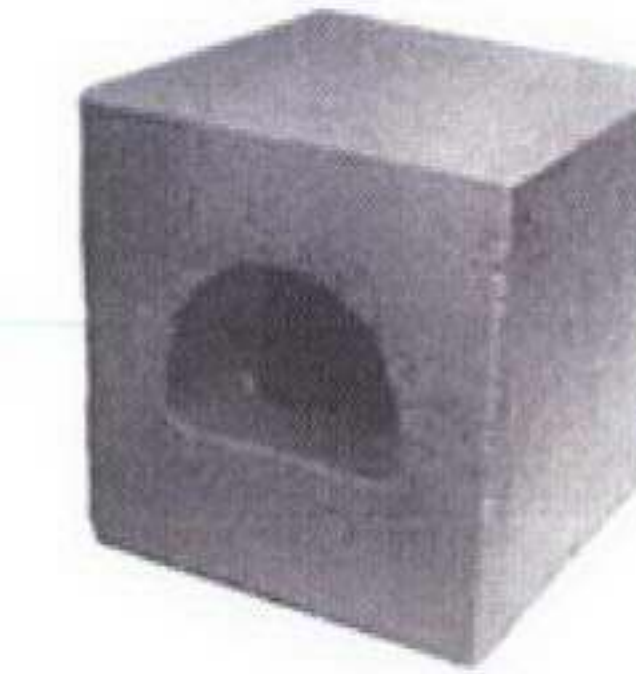

**N26 - Wagtail Box**  
Designed for installation into the fabric of a building, this box is suitable for pied wagtail, spotted flycatcher. Site in thick ivy or honeysuckle.

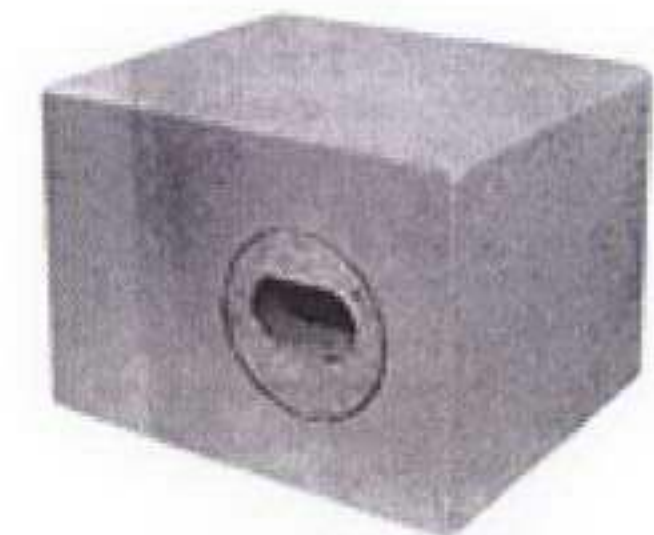

**N25 - Swift Box**  
Designed for installation into the fabric of a building, this box is suitable for swifts. Site under eaves.

Deciduous Buddleia 'Nanho blue'

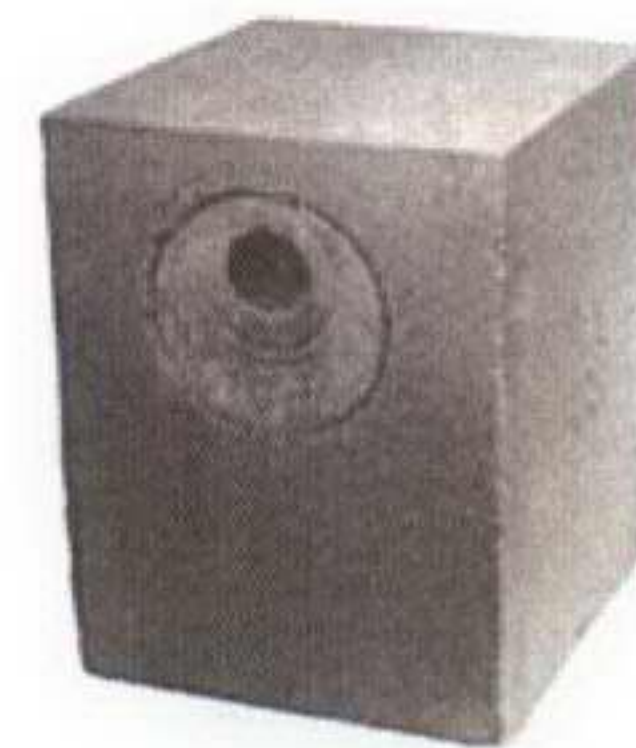

**N24 - Tit Box**  
Designed for installation into the fabric of a building, this box is suitable for tits. Site 2 to 5m above ground.

Gorse (Ulex europaeus) Evergreen

Red-barked dogwood (Cornus alba 'Sibirica')



**3S - Starling Box**  
Starlings like nest boxes, but require a larger box than the 1B. The 3S is ideal from them being larger and with a 45mm diameter entrance hole. Fixed to trellis with climbing honeysuckle and variegated ivy.



The term BROWNROOF or ECOROOF is often used in conservation circles in London to refer to this particular model as they are mitigation for the loss of brownfield land. This uses a substrate material, laid down on a flat roof and allowed to colonise naturally. The research in Switzerland has demonstrated that such roofing systems can be modified to increase their positive impact on biodiversity, specifically for many of the issues associated with brownfield land. They are a significant benefit for black redstarts.

PLAN 1:100 scale

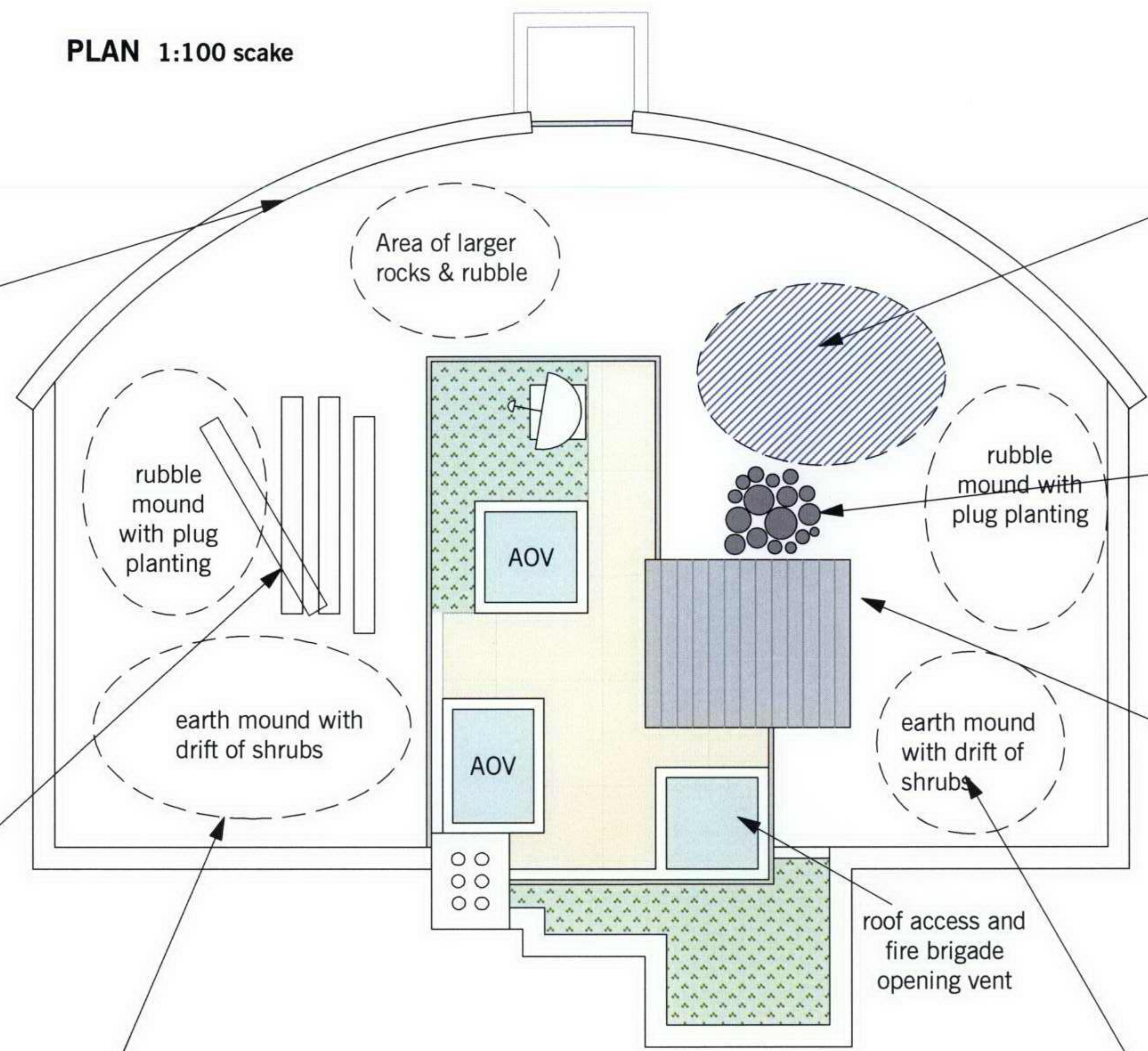

**Wet Area**  
Earth dips down below reservoir layer to provide wet area

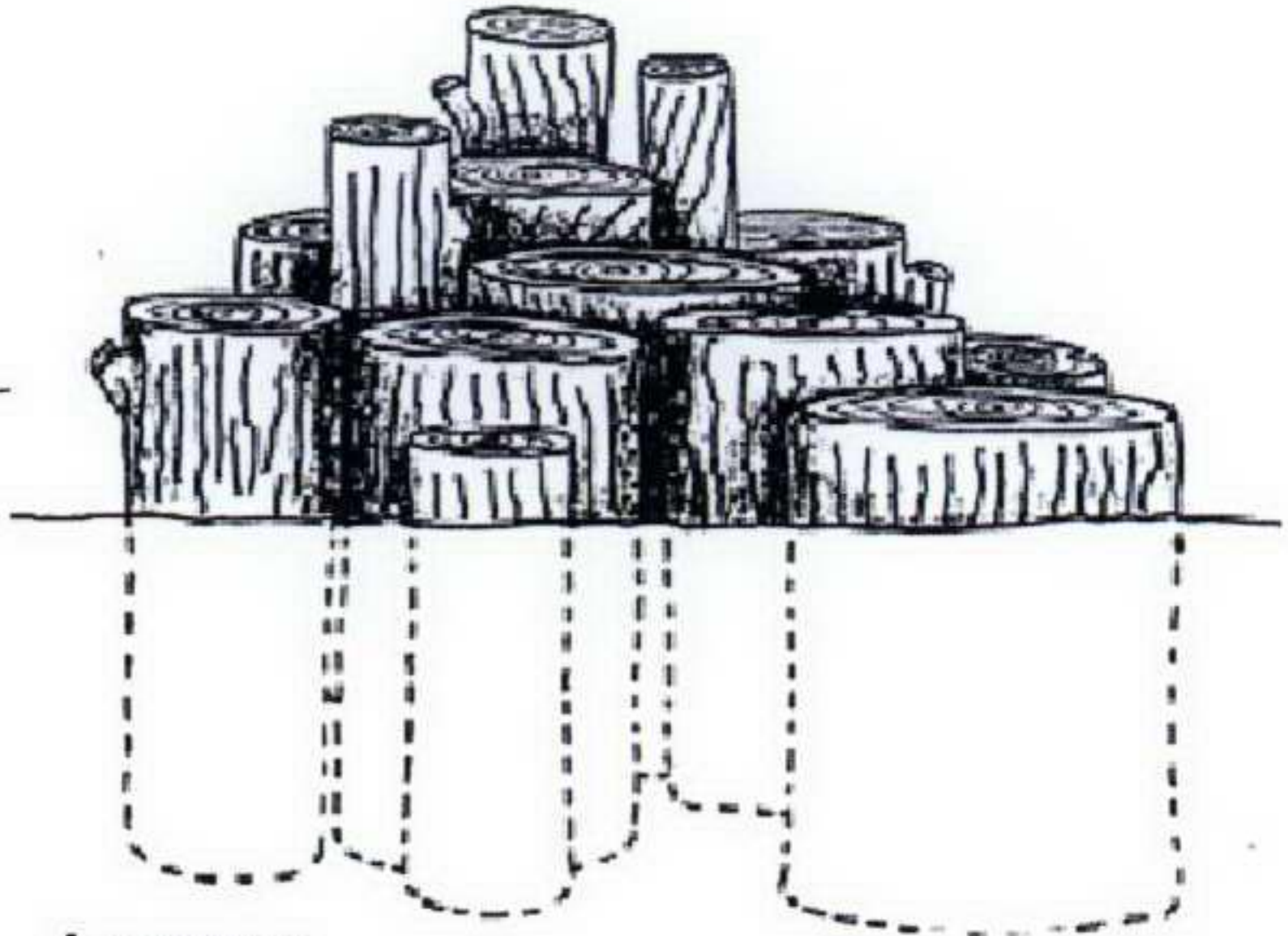

**Loggersy**  
For Stag Beetles - Large logs (10-50cm diameter) of hardwood (eg oak, beech, sycamore, ash) with bark still attached sunk into the ground in partially shaded areas

**N27 - Bat Brick**  
Designed to be incorporated into brick structures and includes a removable front for inspection. Installed at points around the inside of raised parapet

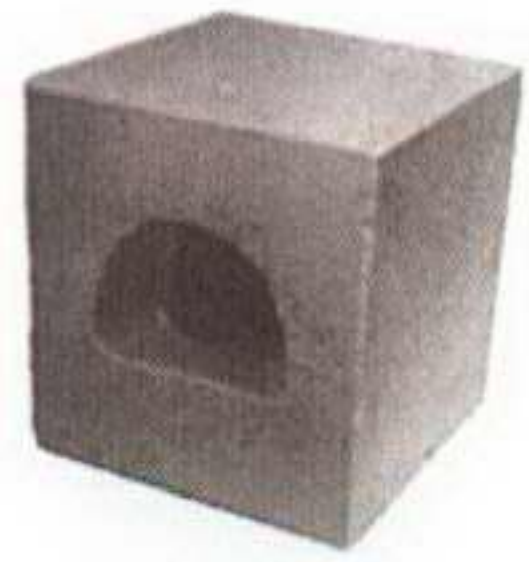

**N26 - Redstart**  
Designed for installation into the fabric of a building, this box is suitable for the redstart. Site under the roof.

TYPICAL SECTIONS

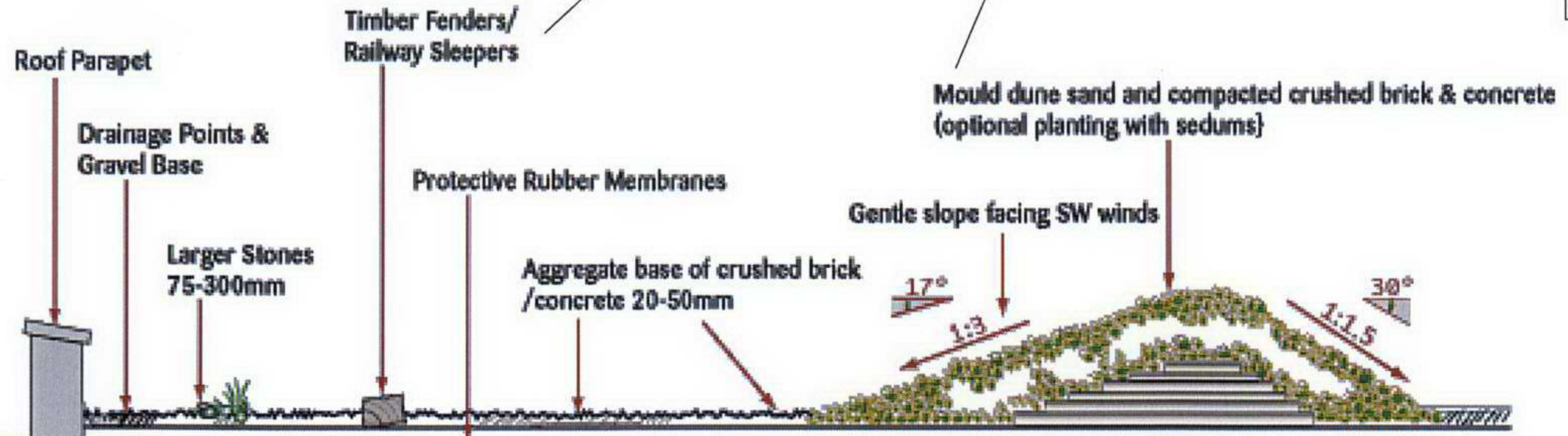

<http://www.blackredstarts.org.uk/>

Use a mixture of crushed brick and concrete graded from 25mm to dust.

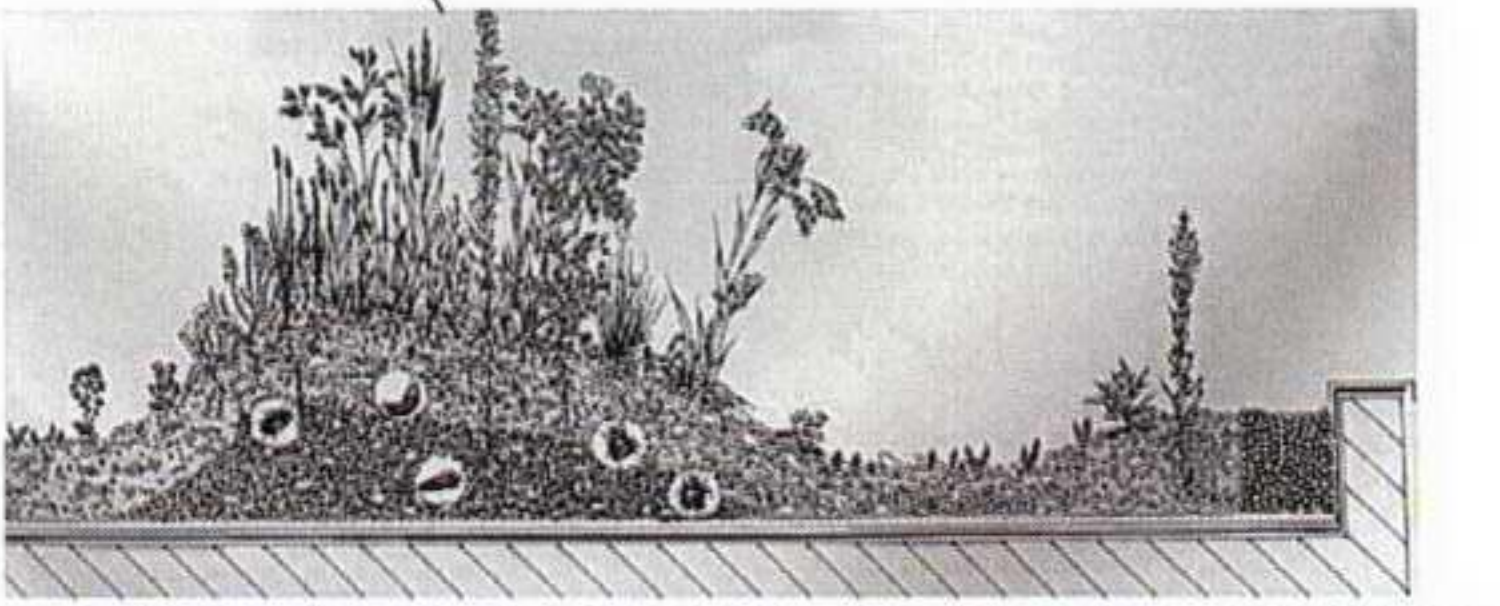

2. Be contoured from heights of at least 5cm to 15cm

