

Ventilation
Mechanical ventilation to Part F, Building Regulations in all cloakrooms and tea point. Minimum 6 litres per second in cloakrooms with 15 minute overrun. 30 litres per second in tea point.

Fire Safety
Existing fire alarm consists of battery operated smoke detectors. These are to be removed and a new fire alarm installation is to be installed. New automatic security locks on inner landing doors are to be linked to the fire alarm and are opened when alarm is triggered or by release button beside each door. Emergency lighting is to be provided as marked.

Central Heating
Existing electric storage heaters are to be removed. A new system with gas fired room-sealed balanced flue condensing boiler fitted within basement store.

BASEMENT

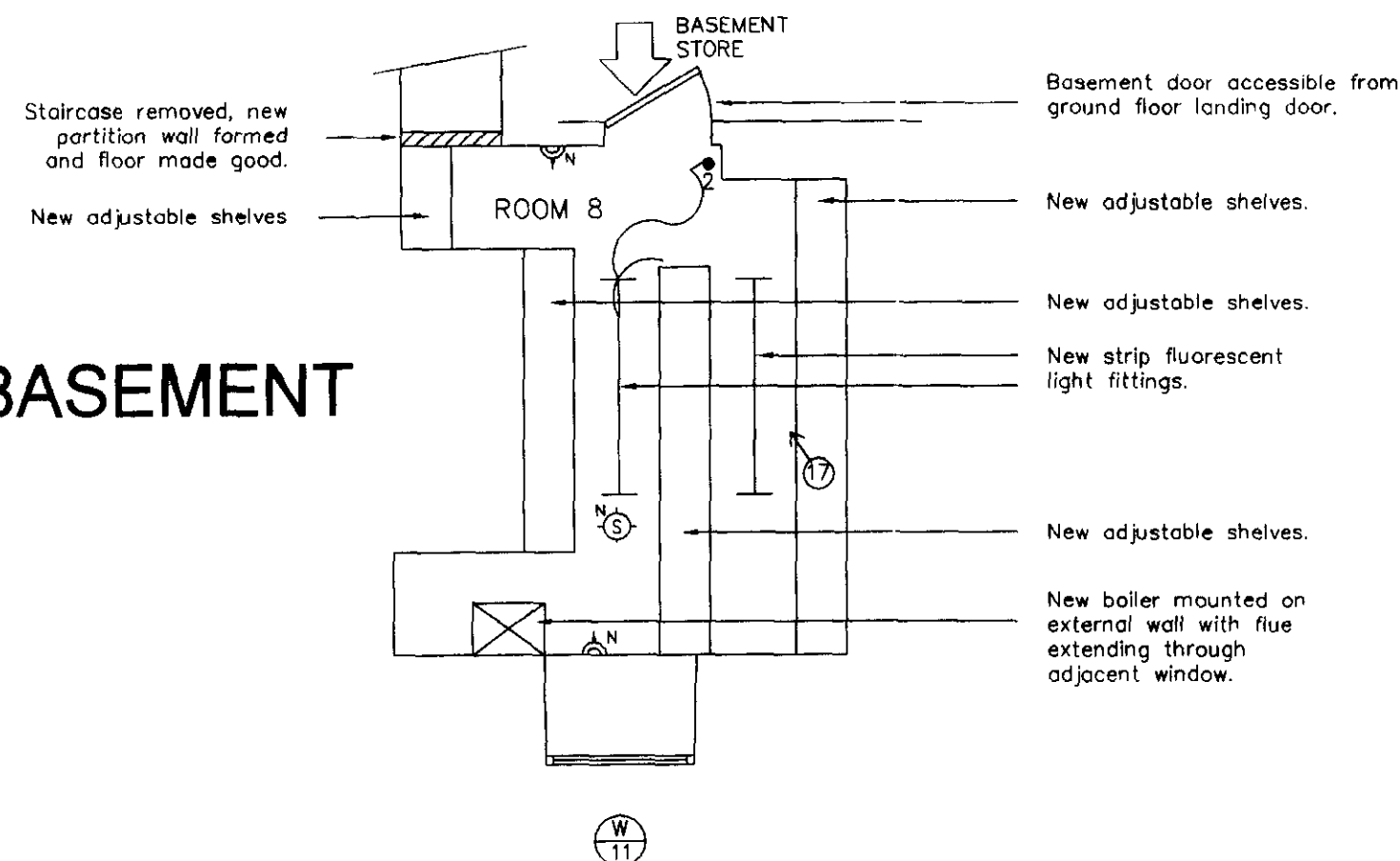

Symbol	Description
	EMERGENCY LIGHT
	NO. & DIRECTION OF PHOTOGRAPH
	SMOKE DETECTOR
	HEAT DETECTOR
	WINDOW NUMBERING
	DOOR NUMBERING
'N' next to any of these symbols indicates a new item.	

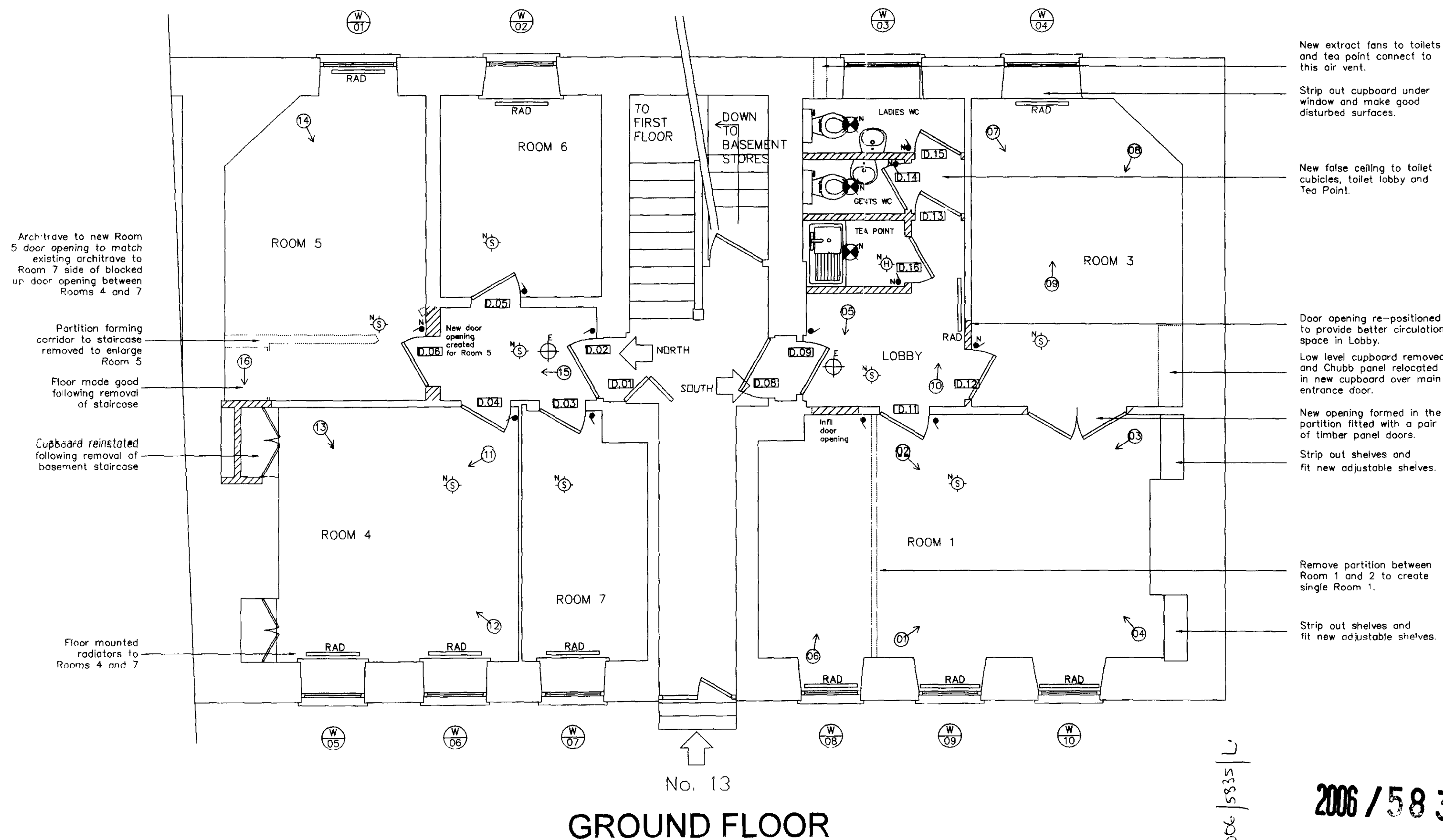

Notes
Do not scale from drawing.

Symbol	Description
	TWIN SOCKET OUTLET
	SWITCHED SPUR
	HAND-DRYER
	LIGHT SWITCH
	RADIATOR
	EXTRACT FAN

No.	Date	Revisions
B	06/01/07	Annotation amendments.
A	14/12/06	Layout amended & noted added

Title
13 GRAY'S INN SQUARE,
GRAY'S INN, LONDON WC1

INTERNAL REFURBISHMENT
PROPOSED GROUND FLOOR
& BASEMENT PLANS

Client
J A KEMP & CO.
14 SOUTH SQUARE,
GRAY'S INN,
LONDON WC1R 5JJ

File No 13/21600/036

Scale 1:50

Date DECEMBER 2006

Drawn by JMM

Drawing No.
06003/02B

CUTHBERT LAKE
Chartered Surveyors

Founded before 1773

10 GRAY'S INN SQUARE, GRAY'S INN, LONDON WC1R 5JD
TELEPHONE 0171-405 1953
FAX 0171-405 7553

2006/5835/LR1

2006/5835/L