

- NOTES**
1. Do not scale from drawing, use figured dimensions only after checking. Report any discrepancies or omissions to architect before ordering materials or putting work in hand.
 2. Where any drawing is to be read in conjunction with any other drawing, including a specialist's drawing, the two drawings shall be cross-checked and any discrepancies in the work shown, including the dimensions, reported to the architect before the work is put in hand.
 3. Where work to an existing building is involved, figured dimensions shown on drawings including those of specialists, shall be verified by measurement of the building and any discrepancy reported to the architect before the work is put in hand.

ELECTRICAL SYMBOL KEY	
	RECESSED LIGHT FITTING
	LIGHT FITTING, PENDANT
	COMPACT FLUORESCENT LIGHT FITTING
	WATER RESISTANT LIGHT FITTING
	LIGHT FITTING, SPECIAL
	FLUORESCENT BATTEN LIGHT FITTING
	SINGLE POWER SOCKET
	DOUBLE POWER SOCKET
	SHAVESOCKET
	SWITCH
	PULL SWITCH
	CEILING MOUNTED COVERED LIGHT
	CEILING MOUNTED FLUORESCENT LIGHT
	PHONE POINT
	COVERED CEILING / WALL MOUNTED LIGHT FITTING
	COVERED C/W LIGHT FITTING WITH EMERGENCY LIGHTING
	BELL PUSH
	BELL SOUNDER
	FIRE ALARM CALL POINT
	Emergency light fitting
	SMOKE DETECTOR

REV C DRAWING SPLIT INTO 2 (314 & 315); MINOR REVISIONS TO PH2 WORK; DOOR NOS ADDED; LIGHTING LAYOUT INDICATED (SUBJECT TO ME SPEC & DWGS) 21.12.06

REV B ACCESS HATCH REMOVED; HEATING INDICATED 19.10.06

REV A ACCESS HATCH TO UC SERVICES VOID ADDED 02.10.06

ST STEPHENS, ROSSLYN HILL, HAMPSTEAD LONDON NW3 2PP

PROPOSED GF LAYOUT SHEET 1

Scale 1: 50 @ A1

Drawn CW/EP

Check NOV/06

Drawing number 2828 / 314

Client ST STEPHENS RESTORATION & PRESERVATION TRUST

ARP

ANTHONY RICHARDSON AND PARTNERS TEL: 020 7485 0991 ARCHITECTS AND QUANTITY SURVEYORS FAX: 020 7482 4622 31 OVAL ROAD CAMDEN TOWN LONDON NW1 7EA EMAIL: mail@arparchitects.co.uk

This drawing is the property of ARP Anthony Richardson & Partners Ltd. Copyright is reserved on this and the drawing is issued on the condition that it is not copied, reproduced, retained or disclosed to any unauthorised person either wholly or in part without the written consent of the Company.

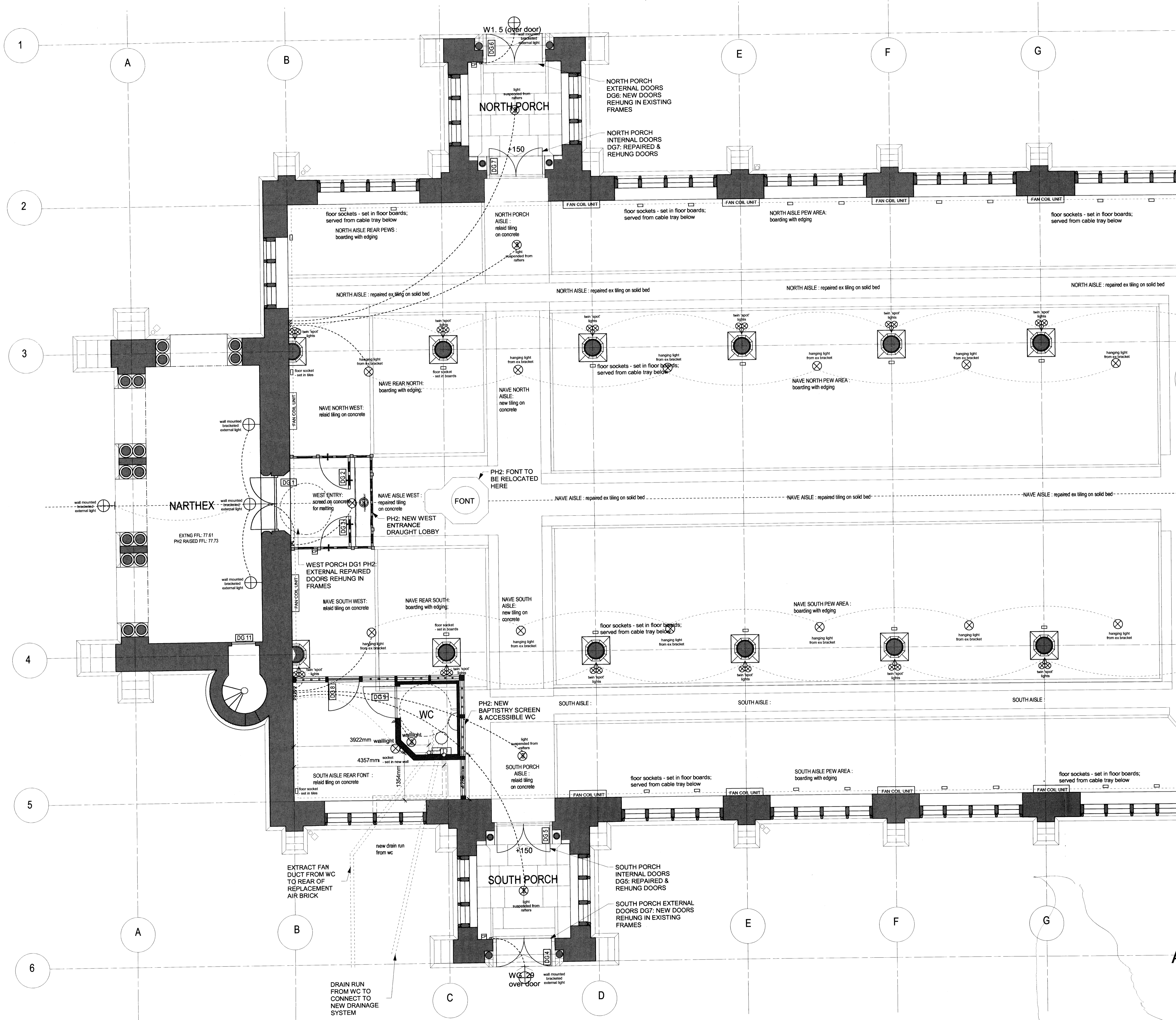

- NOTES**
1. Do not scale from drawing, use figured dimensions only after checking. Report any discrepancies or omissions to architect before ordering materials or putting work in hand.
 2. Where any drawing is to be read in conjunction with any other drawing, including a specialist's drawing, the two drawings shall be cross-checked and any discrepancies in the work shown, including the dimensions, reported to the architect before the work is put in hand.
 3. Where work to an existing building is involved, figured dimensions shown on drawings including those of specialists, shall be verified by measurement of the building and any discrepancy reported to the architect before the work is put in hand.

ELECTRICAL SYMBOL KEY	
	RECESSED LIGHT FITTING
	LIGHT FITTING, PENDANT
	COMPACT FLUORESCENT LIGHT FITTING
	WATER RESISTANT LIGHT FITTING
	LIGHT FITTING, SPECIAL
	FLUORESCENT BATTEN LIGHT FITTING
	SINGLE POWER SOCKET
	DOUBLE POWER SOCKET
	SHAVESOCKET
	SWITCH
	PULL SWITCH
	CEILING MOUNTED COVERED LIGHT
	CEILING MOUNTED FLUORESCENT LIGHT
	PHONE POINT
	COVERED CEILING / WALL MOUNTED LIGHT FITTING
	COVERED C/W LIGHT FITTING WITH EMERGENCY LIGHTING
	BELL PUSH
	BELL SOUNDER
	FIRE ALARM CALL POINT
	Emergency light fitting
	SMOKE DETECTOR

RECEIVED
26 MAR 2007

REV C	DRAWING SPLIT INTO 2 (314 & 315); MINOR REVISIONS TO PH2 WORK; DOOR W/NO'S ADDED; LIGHTING LAYOUT INDICATED (SUBJECT TO ME SPEC & DWGS)	21.12.06
REV B	ACCESS HATCH REMOVED; HEATING INDICATED	19.10.06
REV A	ACCESS HATCH TO UC SERVICES VOID ADDED	02.10.06
PS	ST STEPHENS, ROSSLYN HILL, HAMPSTEAD LONDON NW3 2PP	
Drawing		
PROPOSED GF LAYOUT SHEET 2		
Scale	Drawn	Date
1:50 @ A1	CW/EP	NOV/06
Drawing number	Rev	
2828 / 315	C	
Client	ST STEPHENS RESTORATION & PRESERVATION TRUST	

ANTHONY RICHARDSON AND PARTNERS
ARCHITECTS AND QUANTITY SURVEYORS
31 OVAL ROAD CAMDEN TOWN LONDON NW1 7EA
TEL: 020 7485 0991
FAX: 020 7482 4622
EMAIL: mail@arpartners.co.uk

This drawing is the property of ARP Anthony Richardson & Partners Ltd. Copyright is reserved on them and the drawing is issued on the condition that it is not copied, reproduced, retained or distributed to any unauthorised person either wholly or in part without the written consent of the Company.

ARP

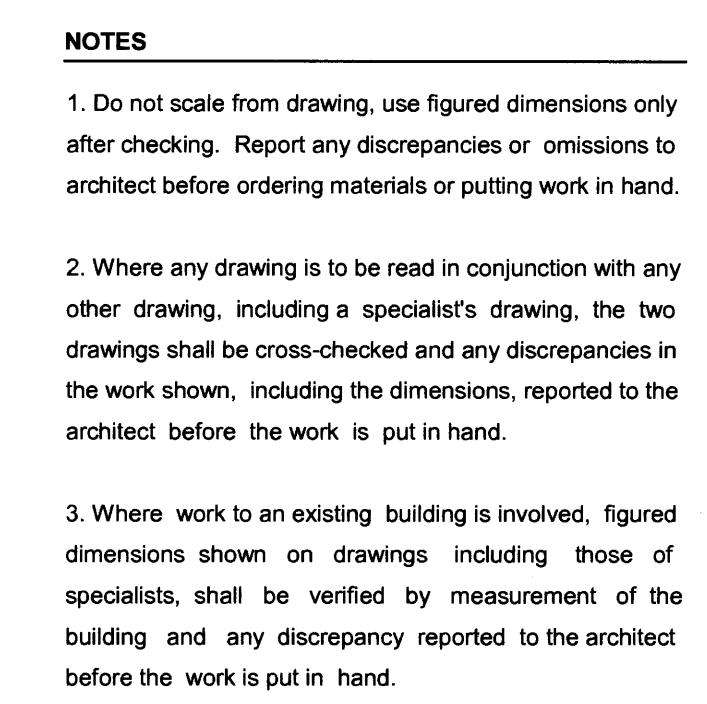

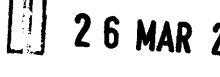
1	37.000		 26 MAR 2007
	REV F	GENERAL REVISIONS	
	REV E	REDRAWN TO ILLUSTRATE STEWELL & EXT. WALL, NEW TITLE BLOCK	23.11.06
job ST STEPHENS, ROSSLYN HILL, HAMPSTEAD LONDON NW2 5PP			
drawing PROPOSED SECTION NORTH ELEVATION DRAWING C			
scale		drawn	date
1:20 @ A1		EP	OCT/06
drawing number		rev	
2828 / 317		F	
client ST STEPHENS RESTORATION & PRESERVATION TRUST			

This drawing is the property of ARP Anthony Richardson & Partners Ltd. Copyright is reserved on them and the drawing is issued on the condition that it is not copied, reproduced, retained or disclosed to any unauthorised person either wholly or in part without the written consent of the Company.