

THIS DRAWING HAS BEEN PREPARED SOLELY FOR THE CLIENT AND PROJECT LISTED BELOW AND IS NOT TO BE REPRODUCED IN PART OR IN WHOLE WITHOUT WRITTEN PERMISSION.
 THE DRAWING IS THE PROPERTY OF NOALE & NORDEN LTD. THE DRAWING MAY NOT BE REPRODUCED IN PART OR IN WHOLE WITHOUT WRITTEN PERMISSION.
 DRAWING RELATING TO FOUNDATIONS, STRUCTURAL, PARTY WALLS & RIGHTS OF LIGHT TO BE FULLY VALIDATED BY SPECIALIST CONSULTANTS.
 THE LOCATION AND SIZE OF EXISTING FEATURES ARE INDICATIVE ONLY. SURVEY DRAWINGS MUST BE RELIED UPON FOR DIMENSIONS.



61 - 63 ROCHESTER PLACE

PROPOSED FRONT ELEVATION (NORTH EAST)

RECEIVED
15 MAY 2007

THIS DRAWING HAS BEEN PREPARED BY NEALE & NORDEN LTD. FOR THE CLIENT AND PROJECT LISTED BELOW AND IS SUBMITTED AS PART OF A PLANNING APPLICATION AND IS NOT INTENDED FOR USE BY ANY OTHER PERSON OR FOR ANY OTHER PURPOSE.

OTHERS MUST SATISFY THEMSELVES WITH RESPECT TO THE ACCURACY OR SUITABILITY OF THE DRAWING OR FOR ANY OTHER REASON.

© THIS DESIGN IS THE COPYRIGHT OF NEALE & NORDEN LTD. THE DRAWING MAY NOT BE REPRODUCED IN PART OR IN WHOLE WITHOUT PRIOR PERMISSION.

ISSUES RELATING TO FOUNDATIONS, STRUCTURES, PARTY WALLS & RIGHTS OF LIGHT TO BE FULLY EVALUATED BY SPECIALIST CONSULTANTS.

THE LOCATION AND SIZE OF EXISTING FEATURES ARE INDICATIVE ONLY. SURVEY DRAWINGS MUST BE REPLIED UPON FOR DIMENSIONS.

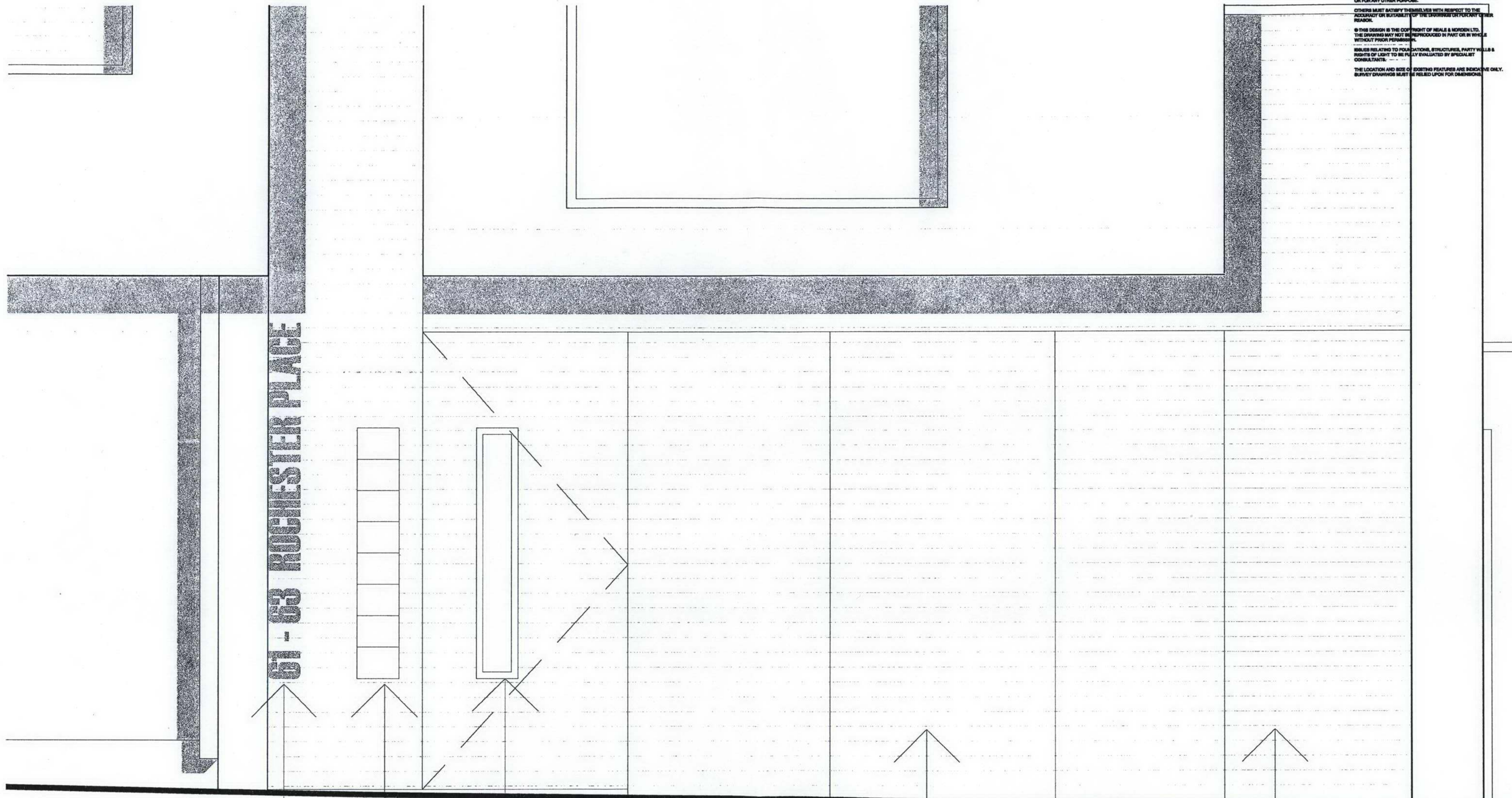

BUILDING
NUMBER

LETTER
BOXES/
INTERCOM

RESIDENTIAL
ENTRY DOOR
WITH VISION
PANEL

REFUSE
ENCLOSURE
DOOR

CYCLE
ENCLOSURE
DOOR

RECEIVED
15 MAY 2007

61 - 63 ROCHESTER PLACE